

Typical Overburden Cut Slope and Pit Bench Details

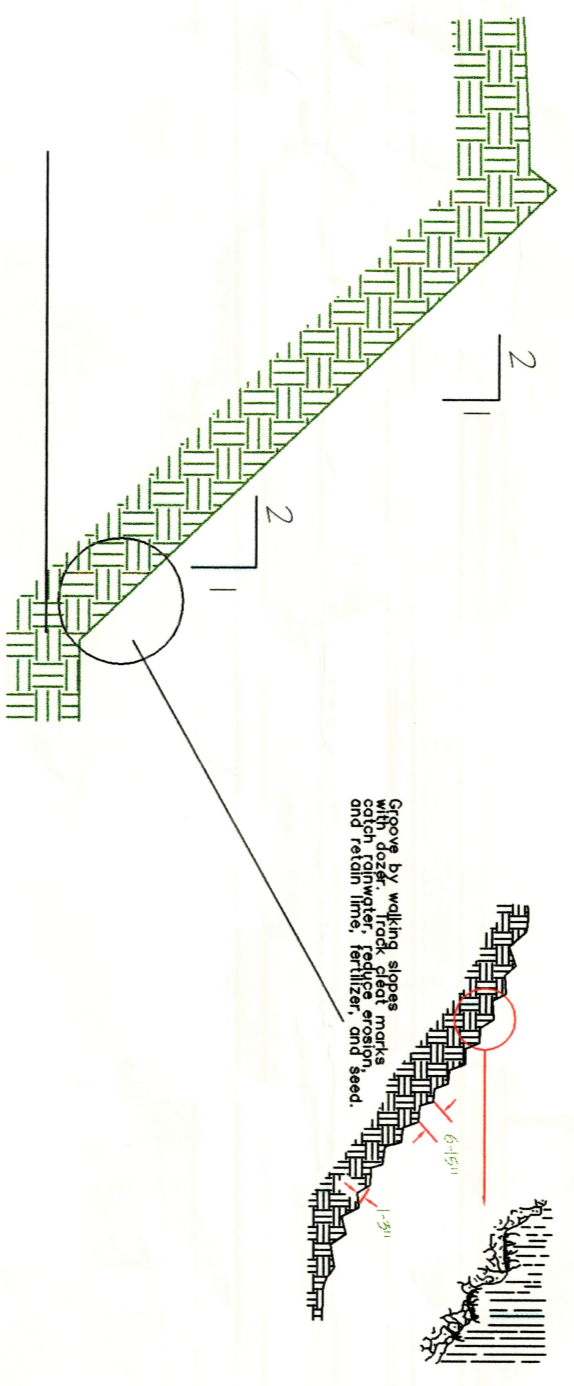

Typical Fill Slope Details

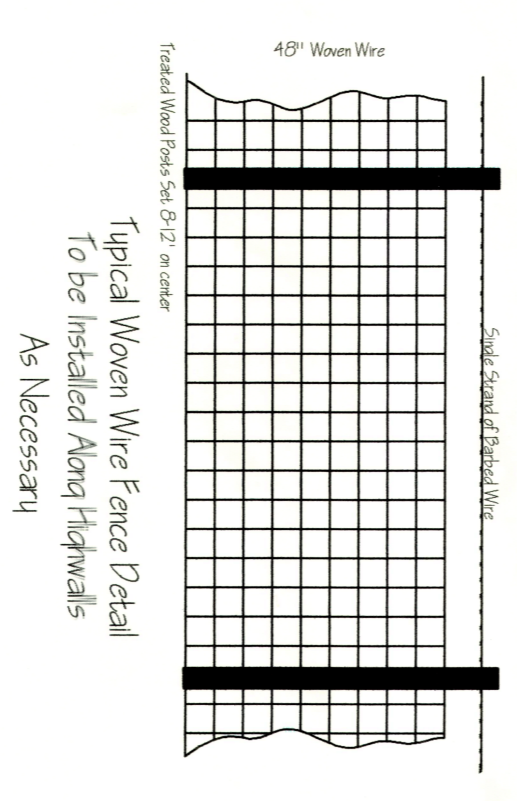

Typical Women Wire Fence Detail To be Installed Along Highways As Necessary

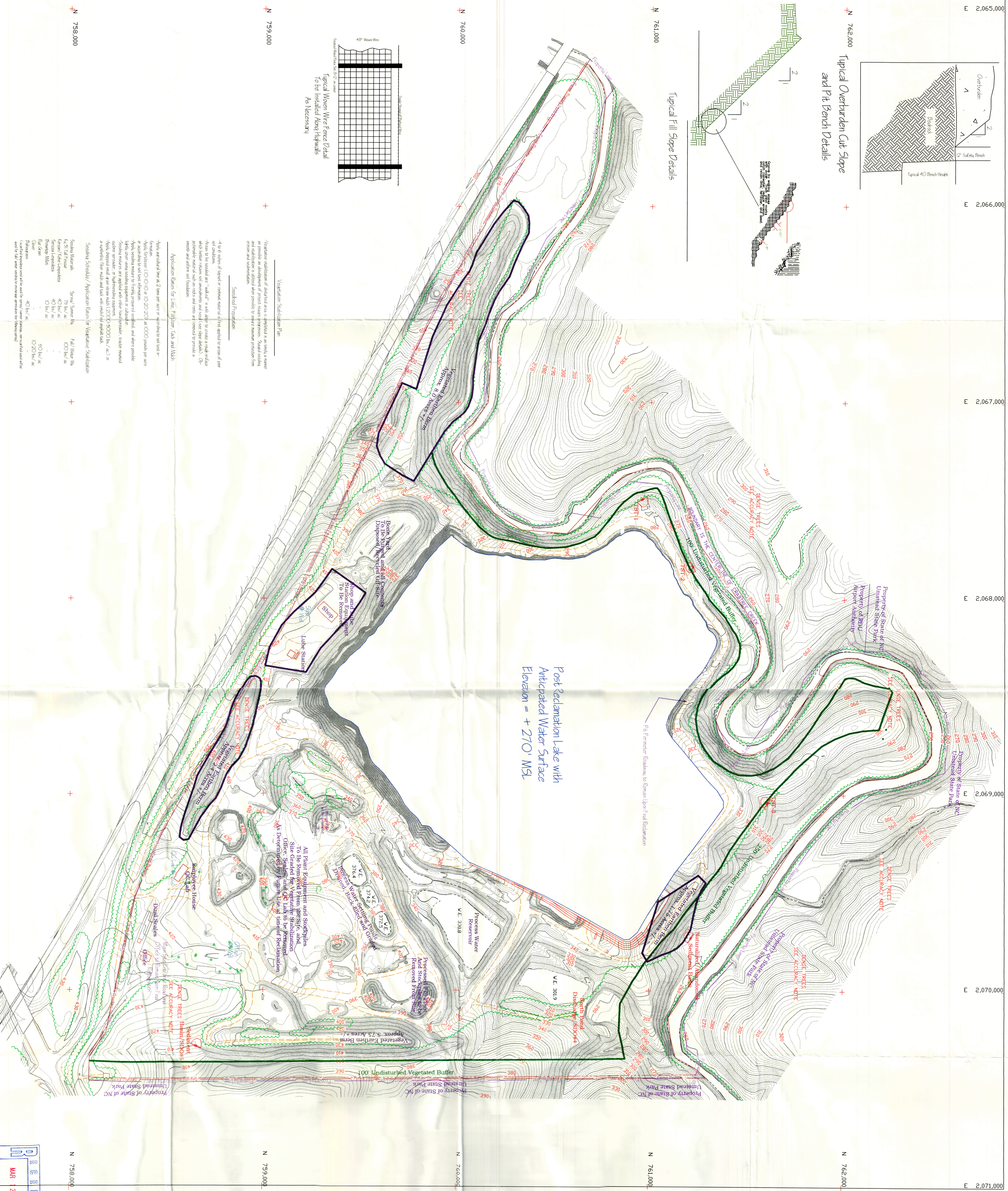

Vegetation Stabilization Plan

Vegetation stabilization of disturbed areas is provided in a final water resource management plan. The plan includes a detailed site plan showing the location and extent of the stabilization areas. The plan also includes a detailed description of the stabilization measures to be implemented, including the types of vegetation to be planted, the spacing and density of the plants, and the methods to be used for planting and maintenance.

Standard Planting

4-4 ft. x 6 ft. x 8 ft. top or round natural type applied to areas of poor soil or in areas where the soil is thin or where the soil is eroding. The plants shall be spaced at 8 ft. x 8 ft. in a grid pattern. The plants shall be planted in rows that are 10 ft. apart. The plants shall be planted in rows that are 10 ft. apart. The plants shall be planted in rows that are 10 ft. apart.

Standard Planting

4-4 ft. x 6 ft. x 8 ft. top or round natural type applied to areas of poor soil or in areas where the soil is thin or where the soil is eroding. The plants shall be spaced at 8 ft. x 8 ft. in a grid pattern. The plants shall be planted in rows that are 10 ft. apart. The plants shall be planted in rows that are 10 ft. apart. The plants shall be planted in rows that are 10 ft. apart.

Standard Planting

4-4 ft. x 6 ft. x 8 ft. top or round natural type applied to areas of poor soil or in areas where the soil is thin or where the soil is eroding. The plants shall be spaced at 8 ft. x 8 ft. in a grid pattern. The plants shall be planted in rows that are 10 ft. apart. The plants shall be planted in rows that are 10 ft. apart. The plants shall be planted in rows that are 10 ft. apart.

Standard Planting

4-4 ft. x 6 ft. x 8 ft. top or round natural type applied to areas of poor soil or in areas where the soil is thin or where the soil is eroding. The plants shall be spaced at 8 ft. x 8 ft. in a grid pattern. The plants shall be planted in rows that are 10 ft. apart. The plants shall be planted in rows that are 10 ft. apart. The plants shall be planted in rows that are 10 ft. apart.

LEGEND

- FRIDGE LINE
- WATER CORSE
- TREE LINE
- SINGLE LINE Y BOUNDARY
- PAVED ROAD W/O CURB
- UNPAVED ROAD
- GRAVEL RAIL
- RAILROAD
- BUILDING
- HEADWALL/CULVERT
- CATCH BASIN
- DRIP INLET
- HANDLE INLET
- LIGHT POLE
- STREET LAMP
- GUY WIRE
- TRANSFORMER
- SIGNS 1 & 2 POST
- HERBICIDE TREATMENT
- INTERMEDIATE CONTROL
- SPOT ELEVATION
- G.P.S. SURVEY POINT
- STANDING WATER
- GROUND CONTROL

NOTES:

1. Accuracy of elevations is based on the elevations determined from the spot heights of the benchmark markers in accordance with the contract documents. The contractor shall be responsible for maintaining the accuracy of the elevations throughout the project. The contractor shall be responsible for maintaining the accuracy of the elevations throughout the project.
2. The area was occupied by the State of North Carolina. The contractor shall be responsible for obtaining all necessary permits and approvals from the State of North Carolina. The contractor shall be responsible for obtaining all necessary permits and approvals from the State of North Carolina.
3. All plant equipment and supplies to be removed from the site. The contractor shall be responsible for removing all plant equipment and supplies from the site. The contractor shall be responsible for removing all plant equipment and supplies from the site.

SCALE: 1" = 200'

COMPILED BY PHOTODIAGRAMMETRIC METHODS

WAKE STONE CORPORATION
 Triangle Quarry
 Mining Permit No. 92-10
 Wake Stone Corporation

LANDAIR SURVEYING, INC.
 ONE ALABAMA AVE. SUITE 200, ATLANTA, GA 30309
 (404) 525-7999 FAX: (404) 525-7999 TEL: (404) 525-7999

RECEIVED
 MAR 12 2011
 LAND QUALITY SECTION

LATE OF PHOTOGRAPHY: 02-05-99
 REVISION NO.
 JOB NO. 1-01-43019-02
 SHEET NO.