

Typical Overburden Cut Slope and Pit Bench Details

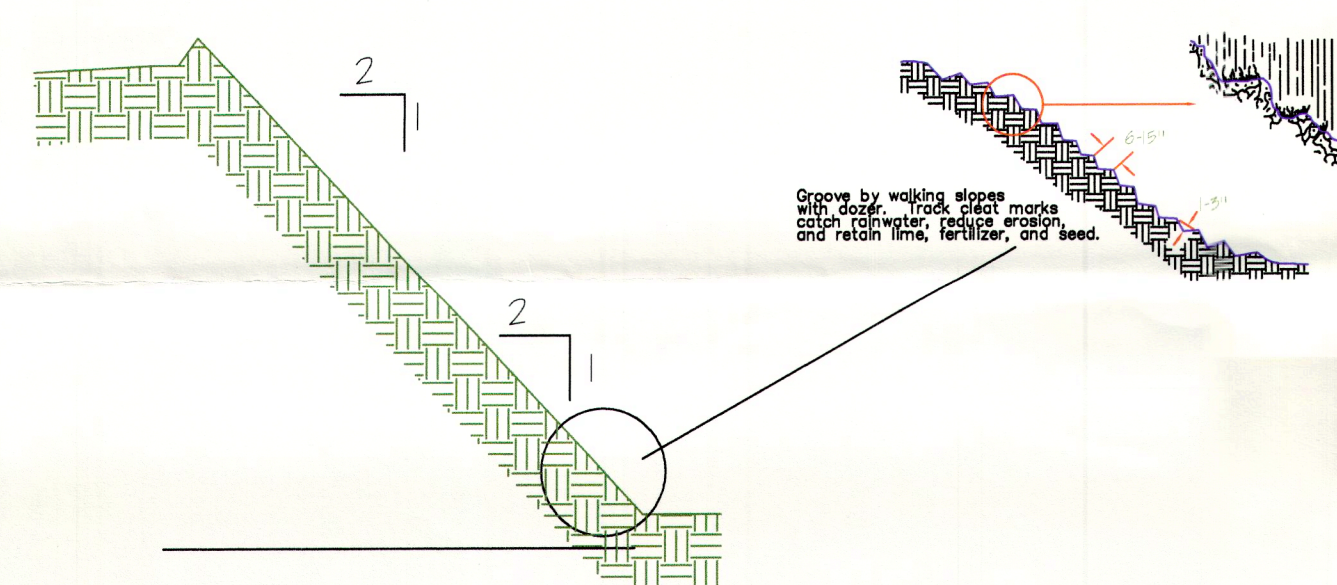

Typical Fill Slope Details

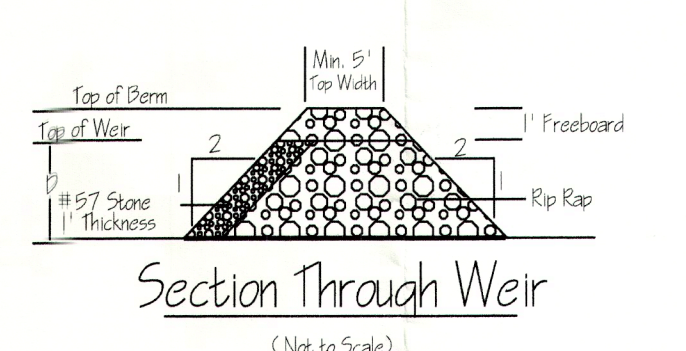
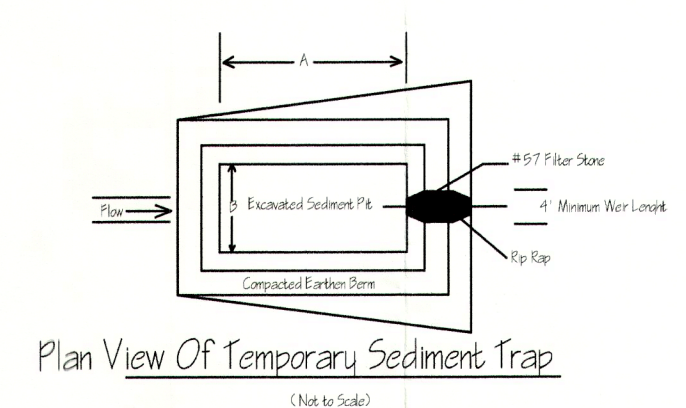

Section Through Weir

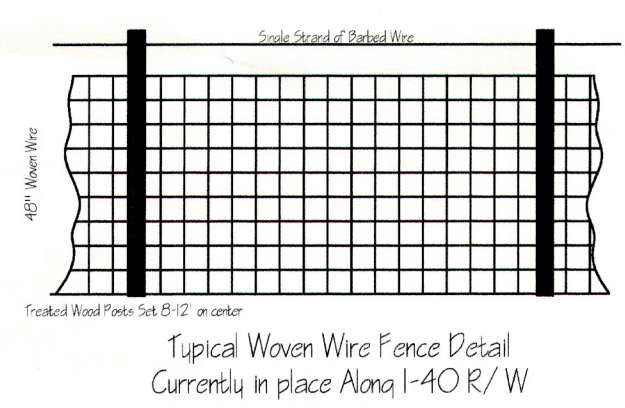

Typical Woven Wire Fence Detail Currently in place Along I-40 R/W

Vegetation Stabilization Plan

*Vegetative stabilization of disturbed areas is completed in as timely a manner as possible as development of project stages progresses. Staked seedling and stabilization is utilized when possible to assure maximum protection from erosion and sedimentation.

Seedbed Preparation

*4 to 6 inches of topsoil or rootstock material is first applied to areas of poor soil conditions.
 *Areas to be seeded are "walked" in with discs to create a rough surface which helps retain soil amendments and seed (see slope details). Objectionable material such as rocks and roots are removed to provide a smooth and uniform soil foundation.

Application Rates for Lime, Fertilizer, Tack and Mulch

*Apply agricultural lime at 2 tons per acre or according to soil test information.
 *Apply fertilizer (10-10-10 or 10-20-20) at 1000 pounds per acre or according to soil test information.
 *Apply seeding mixture to freshly prepared seedbed, and where possible lightly cover using seeding equipment or airspreader.
 *Seeding mixtures are applied with either hand spreader, tractor mounted cyclone spreader, or hydroseeding equipment.
 *Apply chopped small grain straw mulch (2000-5000 lbs./ac.) or a synthetic fiber mulch and tack with emulsified asphalt tack.

Seeding Schedule / Application Rates for Vegetative Stabilization

Seeding Materials	Spring / Summer Mix	Fall / Winter Mix
Kc 51 Tall Fescue	75 lbs/ ac	100 lbs/ ac
Kentucky / Coker Lespedeza	40 lbs/ ac	-
Sorrel Lespedeza	40 lbs/ ac	-
Browtop Millet	10 lbs/ ac	-
Rye Grass	-	90 lbs/ ac
Clover	-	10-20 lbs/ ac
Diakawara	40 lbs/ ac	-

(Certain species need to be used for spring/summer conditions, non-fall seed will be used for fall/winter seeding to encourage germination the following spring)

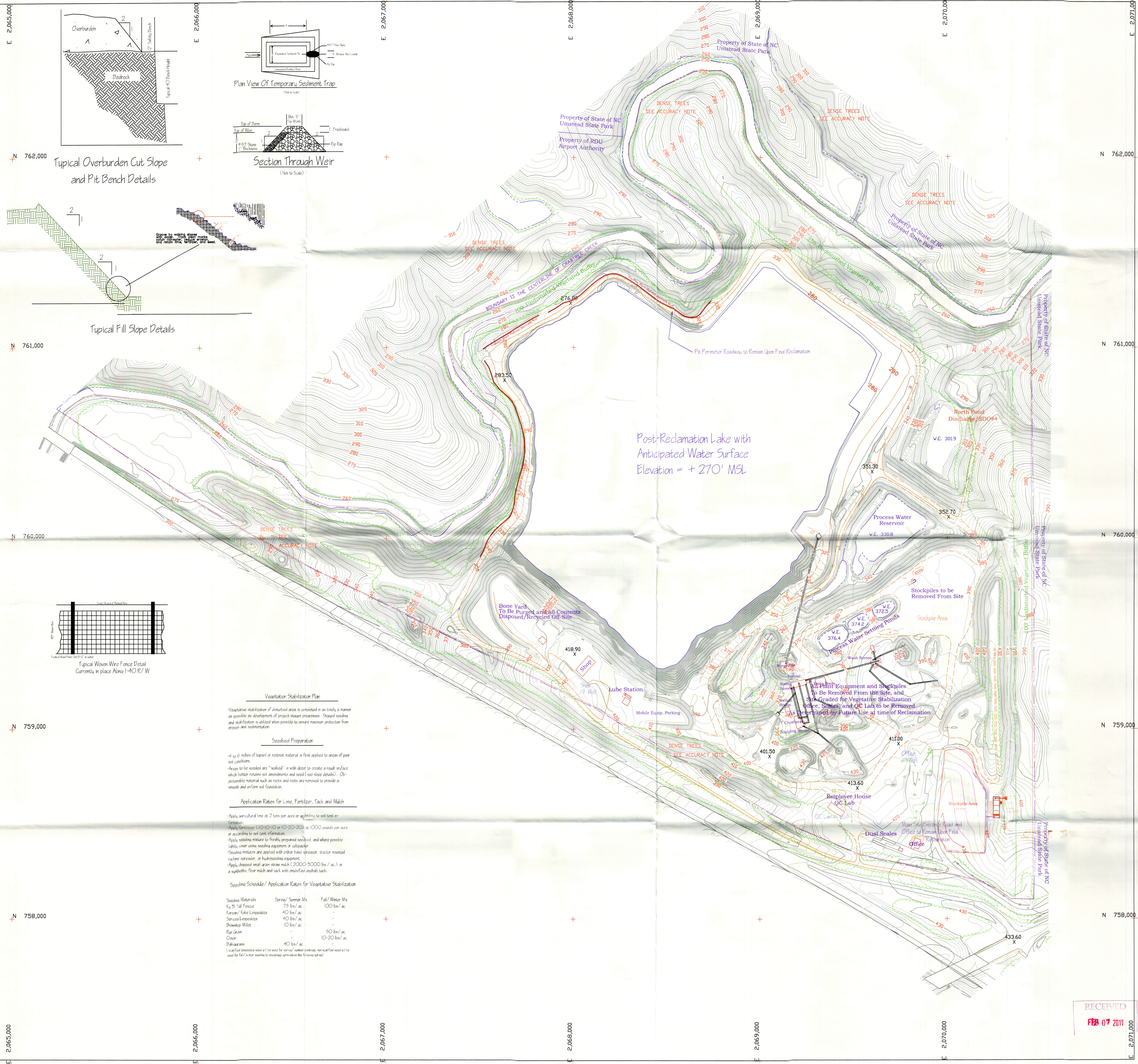

RECEIVED
 FEB 07 2011