

I, DAVID S. TURNER, AS A DULY REGISTERED PROFESSIONAL LAND SURVEYOR IN THE STATE OF NORTH CAROLINA, HEREBY CERTIFY THAT THE DATA SHOWN ON THIS DRAWING, WAS OBTAINED UNDER MY SUPERVISION, IS AN ACCURATE AND COMPLETE REPRESENTATION OF WHAT WAS CONSTRUCTED IN THE FIELD, AND THAT THE PHYSICAL DIMENSIONS OR ELEVATIONS SHOWN THUS ARE AS-BUILT CONDITIONS EXCEPT WHERE OTHERWISE NOTED HERON. WITNESS MY ORIGINAL SIGNATURE, REGISTRATION NUMBER, AND SEAL THIS _____ DAY OF _____, 2010.

DAVID S. TURNER, P.L.S. #L-4551

I, DAVID S. TURNER, CERTIFY THAT THESE PLANS WERE DRAWN UNDER MY SUPERVISION FROM AN ACTUAL SURVEY MADE UNDER MY SUPERVISION AND THAT THE RATIO OF PRECISION AS CALCULATED IS 1: 10,000 +. WITNESS MY ORIGINAL SIGNATURE, REGISTRATION NUMBER, AND SEAL THIS _____ DAY OF _____, 2010.

DAVID S. TURNER, P.L.S. #L-4551

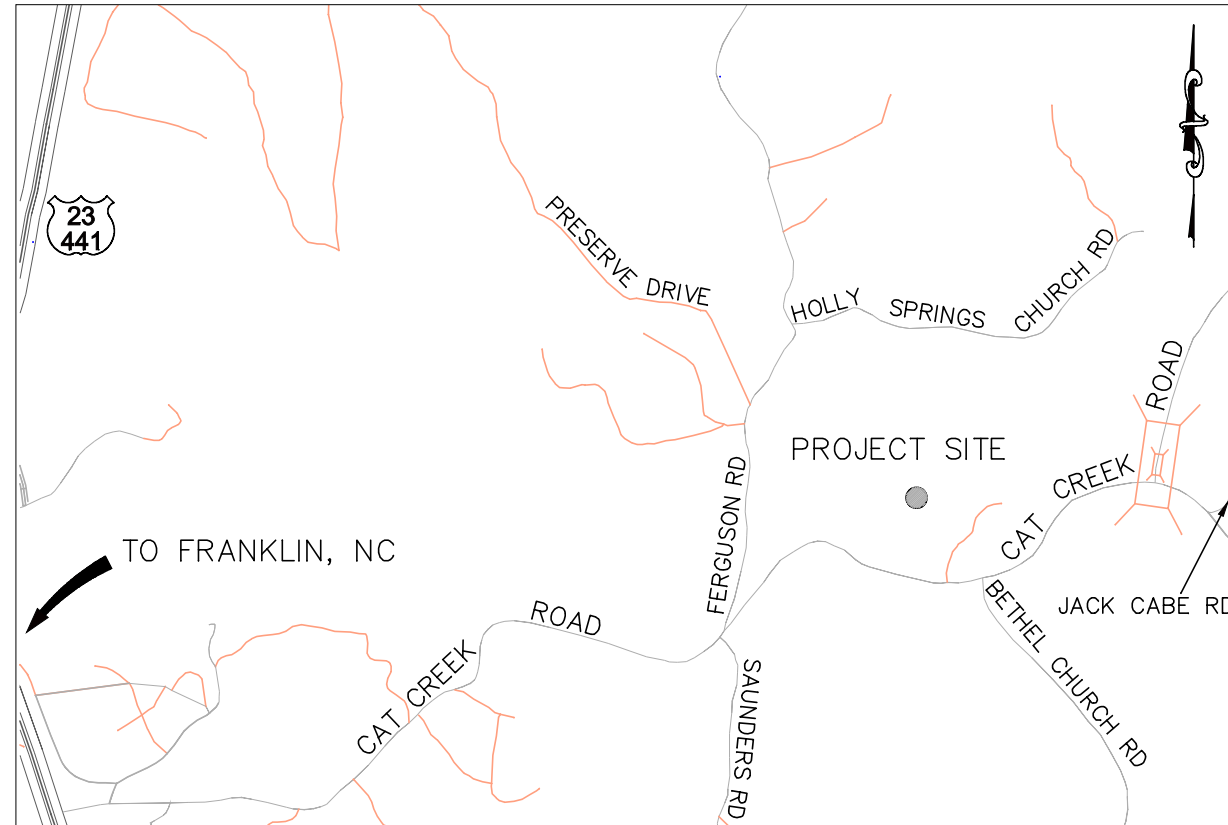

VICINITY MAP
NOT TO SCALE

GENERAL NOTES

1. ALL DISTANCES ARE HORIZONTAL UNLESS OTHERWISE NOTED.
2. THE VERTICAL DATUM IS NGVD 29.
3. THE BASIS OF BEARINGS IS NCGS STATE PLANE GRID COORDINATES NAD83 DATUM.
4. THIS MAP IS NOT FOR RECORDATION, SALES, OR CONVEYENCES AND DOES NOT COMPLY WITH G.S. 47-30 MAPPING REQUIREMENTS.
5. SEE SHEETS 3, 7, 8, AND 9 FOR LONGITUDINAL PROFILE DATA.
6. REPRESENTATIVE CROSS-SECTIONS ARE PRESENTED ON THE SHEET WHERE THE CROSS-SECTION WAS TAKEN. ALL CROSS-SECTIONS ARE SHOWN FROM LEFT BANK TO RIGHT BANK.

REFERENCES:

DEVELOPER/OWNER:
NORTH CAROLINA ECOSYSTEM ENHANCEMENT PROGRAM
1652 MAIL SERVICE CENTER
RALEIGH, NC 27099-1652
(919)715-0476
SCO#: 050657901

CONSTRUCTION BY:
FLUVIAL SOLUTIONS, INC
RALEIGH, NC
(919)821-4300

EXISTING CONDITIONS INFORMATION PROVIDED BY:
EARTH TECH
RALEIGH, NC
(919)854-8210

LEGEND:

- THALWEG
- TOP OF BANK
- BOTTOM OF BANK
- CENTERLINE FLOW
- OPEN WATER AREA
- EDGE OF WATER
- SPOT ELEVATION
- BENCH MARK/CONTROL

SHEET INDEX

- SHEET 1 - TITLE
- SHEET 2 - SWARTOUT TRACT
- SHEET 3 - LONGITUDINAL PROFILES 1 & 2
- SHEET 4 - WALDROOP TRACT
- SHEET 5 - PARKER TRACT
- SHEET 6 - PARKER TRACT
- SHEET 7 - LONGITUDINAL PROFILE 3
- SHEET 8 - LONGITUDINAL PROFILES 4 & 5
- SHEET 9 - EXISTING PRESERVE TRACT
- SHEET 10 - EXISTING PRESERVE TRACT

REVISIONS, DATE AND INITIAL:

TURNER LAND SURVEYING, PLLC
3201 Glenridge Drive, Raleigh, NC 27604 - (919)975-1378
Lturner@tlandsurveying.com - Dturner119@tlandsurveying.com
WWW.TURNERLANDSURVEYING.COM

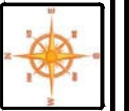

TITLE
AS-BUILT SURVEY OF CAT CREEK STREAM & WETLAND RESTORATION
SCO# 050657901
NORTH CAROLINA
FRANKLIN
MACON COUNTY

DATE:	06/01/2010
SURVEYED BY:	DST/EGT
DRAWN BY:	DST/EGT
REVIEWED BY:	DST/EGT
PROJECT:	TLS-09-003
FILE:	RICHLAND CREEK FINAL AS-BUILT 080110.DWG
SCALE:	NOT TO SCALE
SHEET:	1 of 10



SR1513 CAT CREEK RD BST

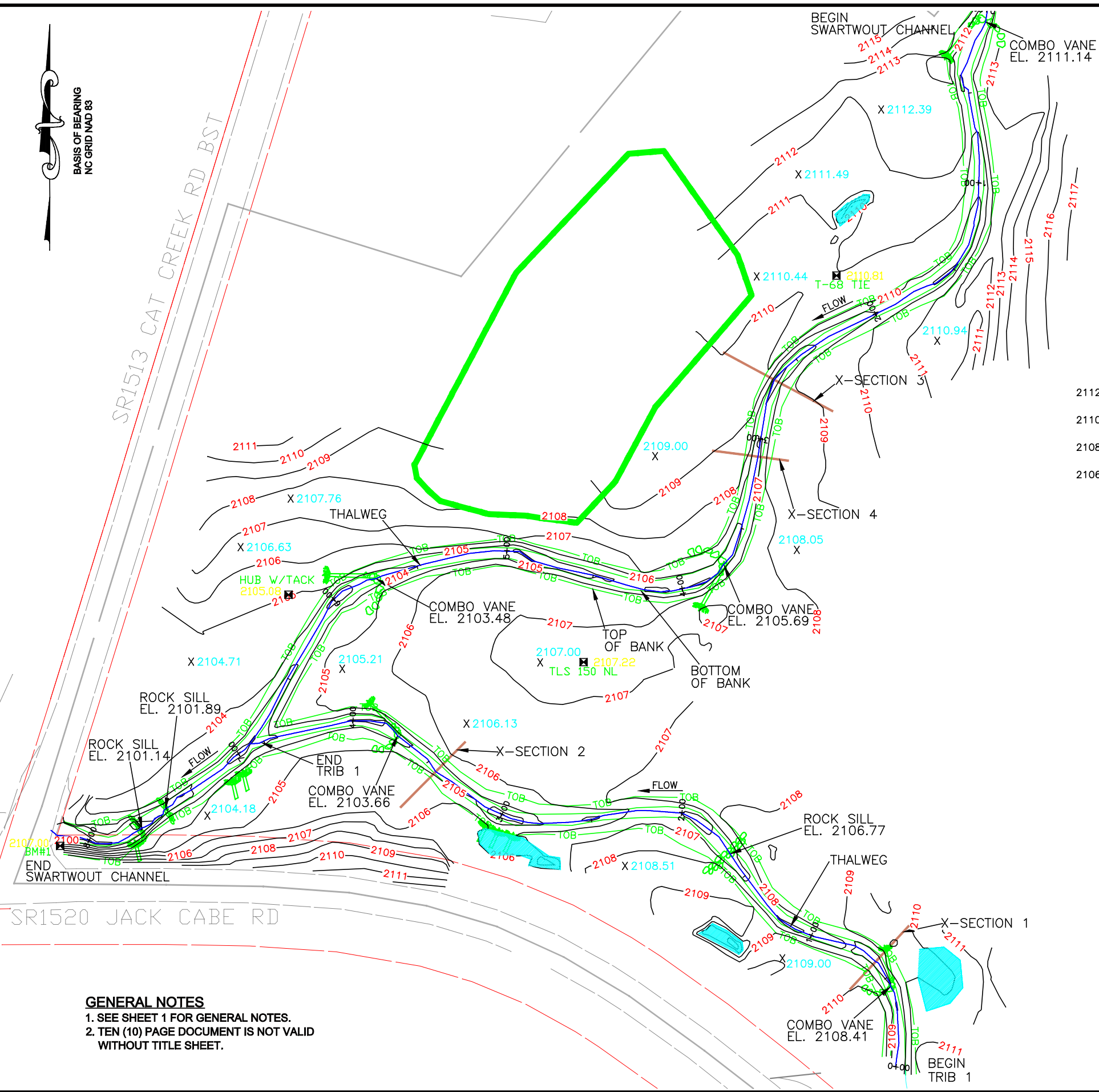

GENERAL NOTES
 1. SEE SHEET 1 FOR GENERAL NOTES.
 2. TEN (10) PAGE DOCUMENT IS NOT VALID WITHOUT TITLE SHEET.

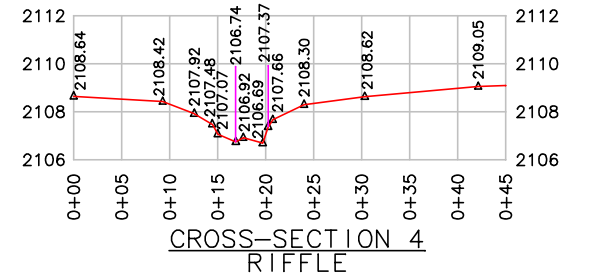
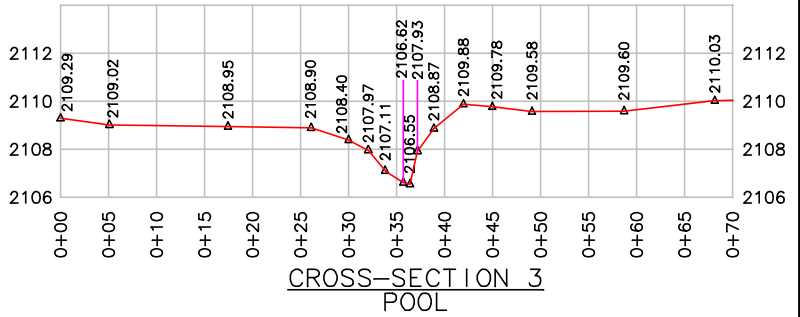
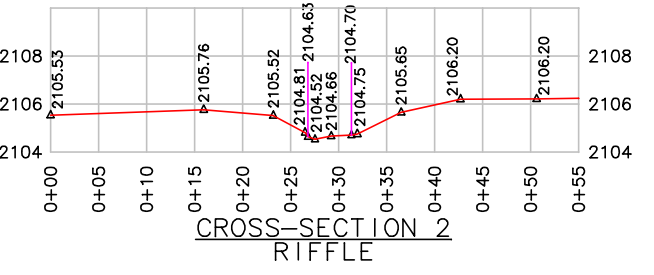
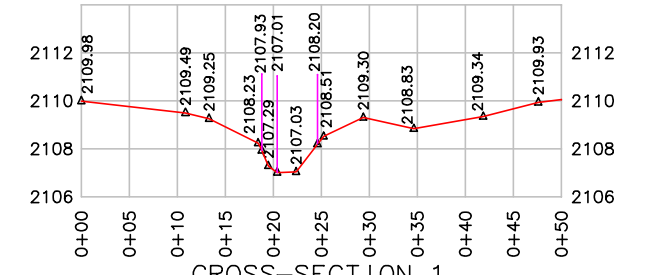

- LEGEND:**
- THALWEG
 - TOP OF BANK
 - BOTTOM OF BANK
 - CENTERLINE FLOW
 - OPEN WATER AREA
 - EDGE OF WATER
 - 2060.57 - SPOT ELEVATION
 - BENCH MARK/CONTROL



SCALE 1"=60'
 1' CONTOUR INTERVAL

REVISIONS, DATE AND INITIAL:

TURNER LAND SURVEYING, PLLC
 3201 Glenridge Drive, Raleigh, NC 27604 - (919)75-1378
 Lturner@tnc.com - Dturner119@tnc.com
 www.TURNERLANDSURVEYING.com



SWARTWOUT TRACT
AS-BUILT SURVEY OF
CAT CREEK STREAM & WETLAND RESTORATION
SCO# 050657901
 NORTH CAROLINA
 FRANKLIN
 MACON COUNTY

DATE:	06/01/2010
SURVEYED BY:	DST/EGT
DRAWN BY:	EGT
REVIEWED BY:	DST/EGT
PROJECT:	TLS-09-003
FILE:	CAT CREEK AS-BUILT FINAL 080410.DWG
SCALE:	1" = 60'
SHEET:	2 of 10

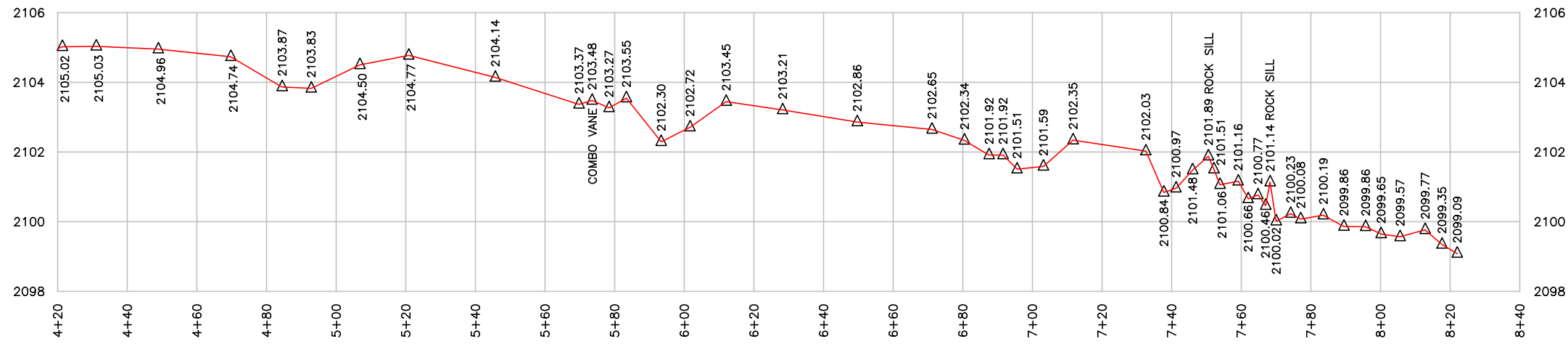
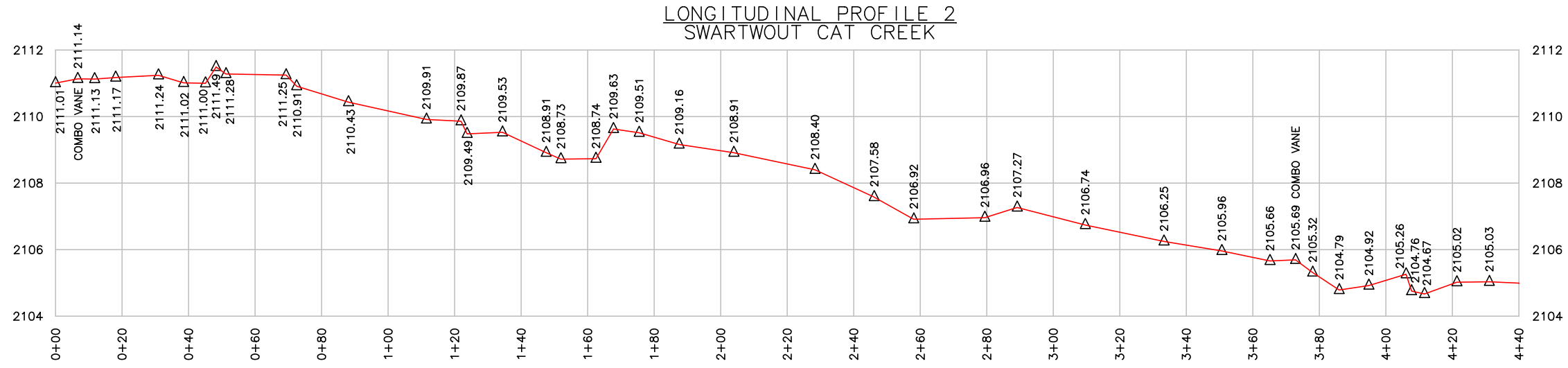
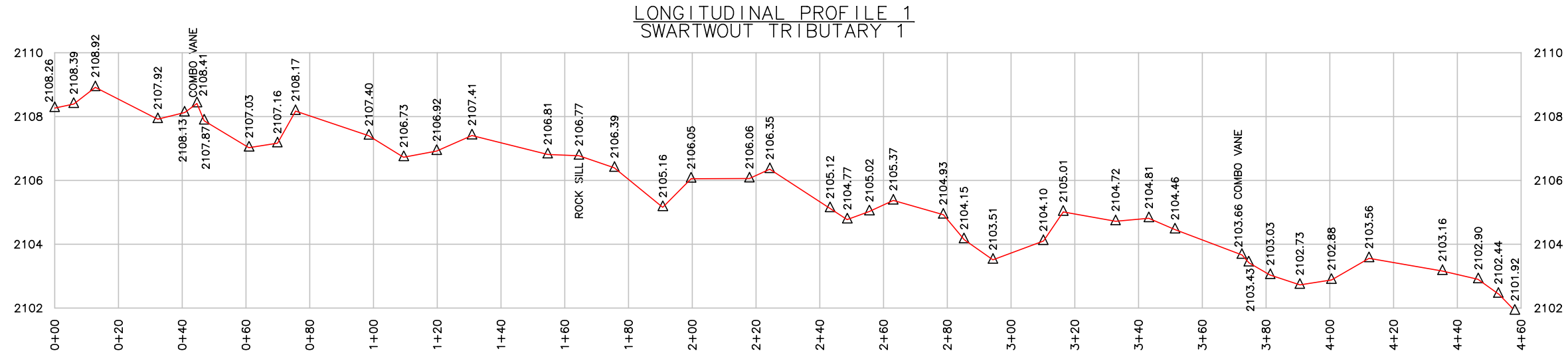

REVISIONS, DATE AND INITIAL:



TURNER LAND SURVEYING, PLLC
 3201 Glenridge Drive, Raleigh, NC 27604 - (919)875-1378
 Lturner@tnc.sr.com - Dturner119@tnc.sr.com
 WWW.TURNERLANDSURVEYING.COM

LONGITUDINAL PROFILES 1 & 2
AS-BUILT SURVEY OF
CAT CREEK STREAM & WETLAND RESTORATION
 SCO# 050657901

FRANKLIN MACON COUNTY NORTH CAROLINA

DATE:	06/01/2010
SURVEYED BY:	DST/EGT
DRAWN BY:	DST/EGT
REVIEWED BY:	DST/EGT
PROJECT:	TLS-09-003
FILE:	CAT CREEK AS-BUILT FINAL 080410.DWG
SCALE:	N/A
SHEET:	3 of 10

WALDROOP TRACT
NOT TO SCALE

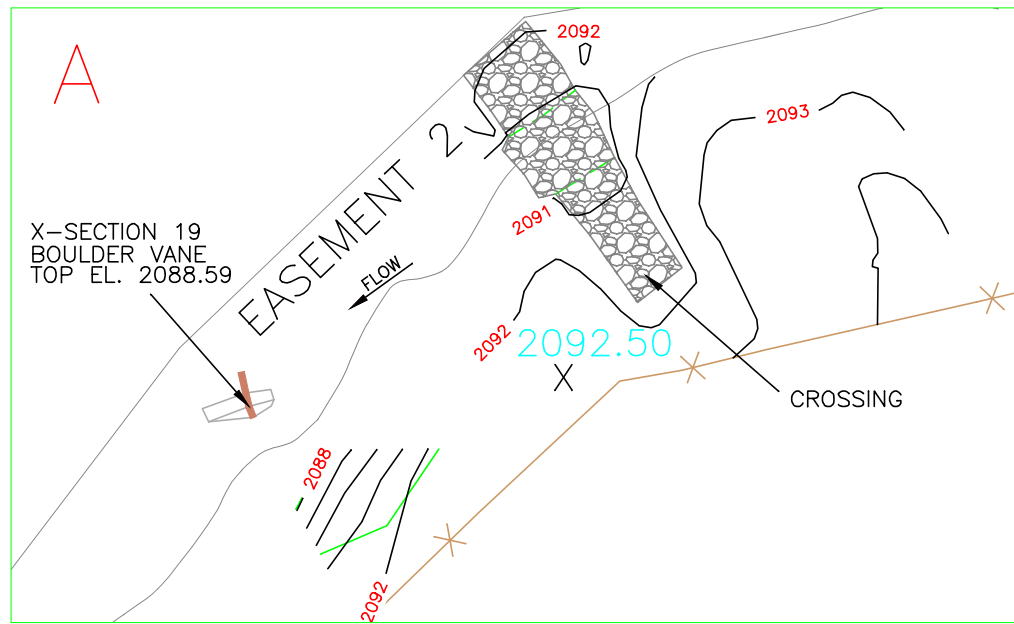
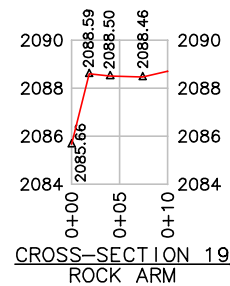
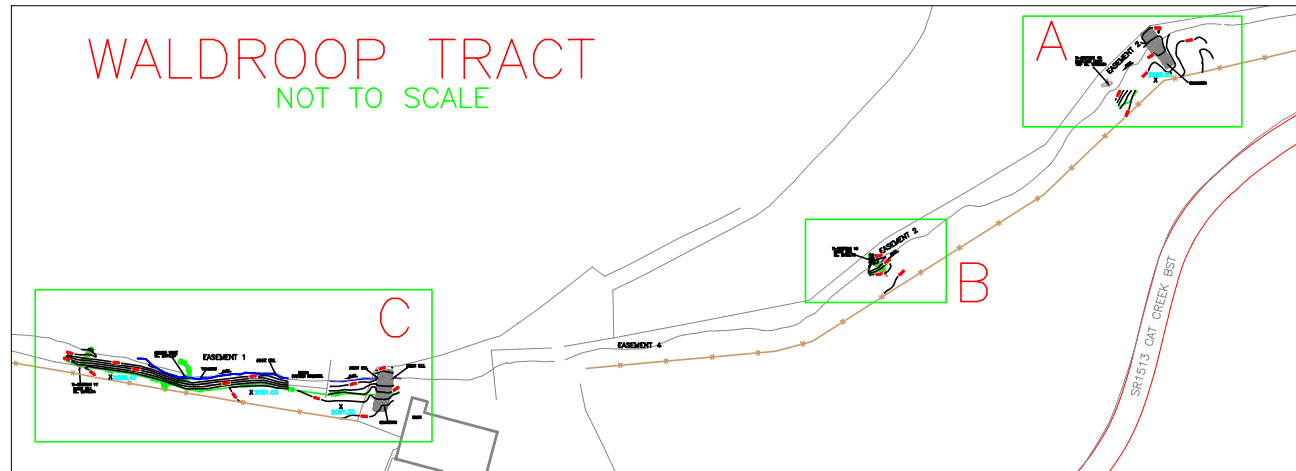

- GENERAL NOTES**
1. SEE SHEET 1 FOR GENERAL NOTES.
 2. TEN (10) PAGE DOCUMENT IS NOT VALID WITHOUT TITLE SHEET.

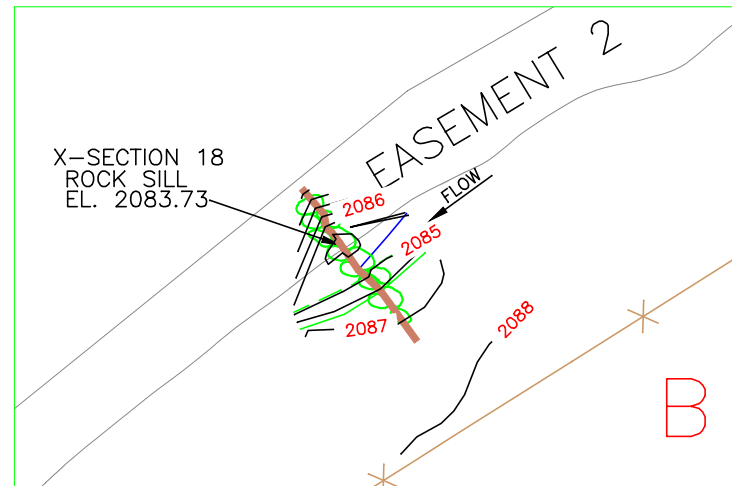
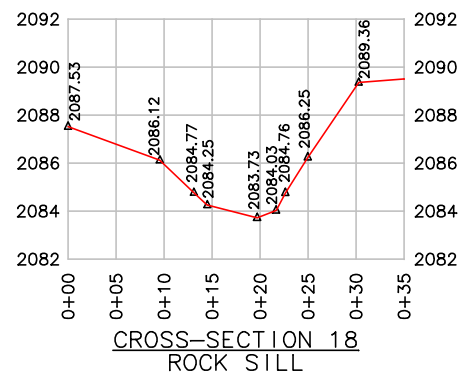
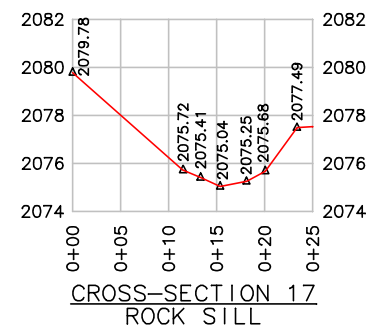

- LEGEND:**
- THALWEG
 - TOP OF BANK
 - BOTTOM OF BANK
 - CENTERLINE FLOW
 - OPEN WATER AREA
 - EDGE OF WATER
 - SPOT ELEVATION

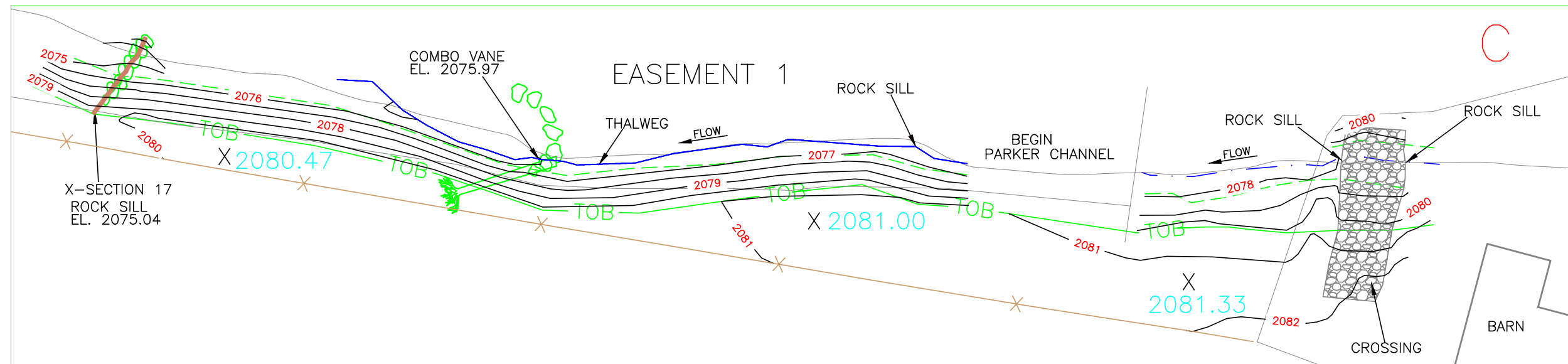
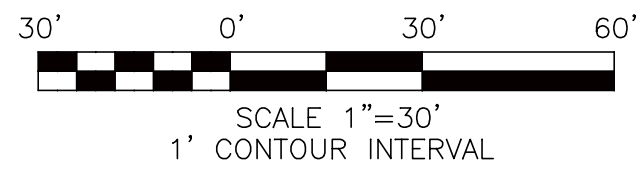

BASIS OF BEARING
NC GRID NAD 83

REVISIONS, DATE AND INITIAL:

TURNER LAND SURVEYING, PLLC
3201 Glenridge Drive, Raleigh, NC 27604 - (919)75-1378
Lturner@tnc.com - Dturner119@tnc.com
WWW.TURNERLANDSURVEYING.COM



WALDROOP TRACT
AS-BUILT SURVEY OF
CAT CREEK STREAM & WETLAND RESTORATION
SCO# 050657901
FRANKLIN NORTH CAROLINA
MACON COUNTY

DATE:	06/01/2010
SURVEYED BY:	DST/EGT
DRAWN BY:	DST/EGT
REVIEWED BY:	DST/EGT
PROJECT:	TLS-09-003
FILE:	CAT CREEK AS-BUILT FINAL 080410.DWG
SCALE:	1" = 30'
SHEET:	4 of 10

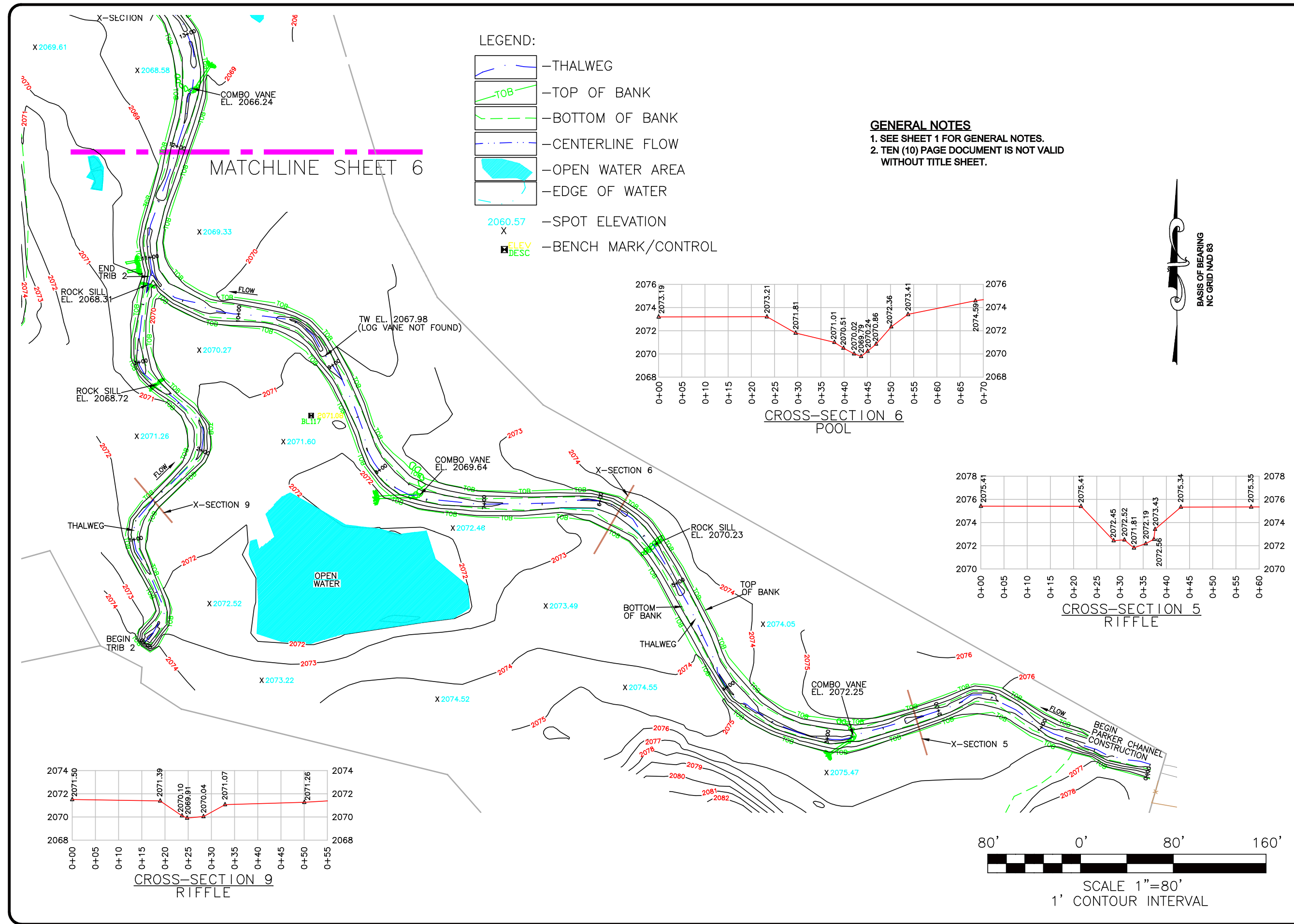

- LEGEND:**
- THALWEG
 - TOP OF BANK
 - BOTTOM OF BANK
 - CENTERLINE FLOW
 - OPEN WATER AREA
 - EDGE OF WATER
 - SPOT ELEVATION
 - BENCH MARK/CONTROL

GENERAL NOTES
 1. SEE SHEET 1 FOR GENERAL NOTES.
 2. TEN (10) PAGE DOCUMENT IS NOT VALID WITHOUT TITLE SHEET.

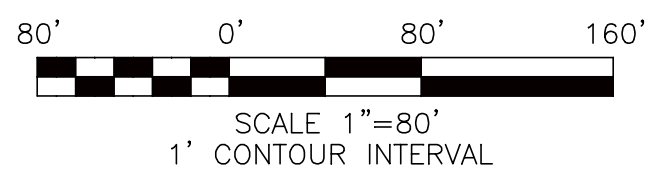
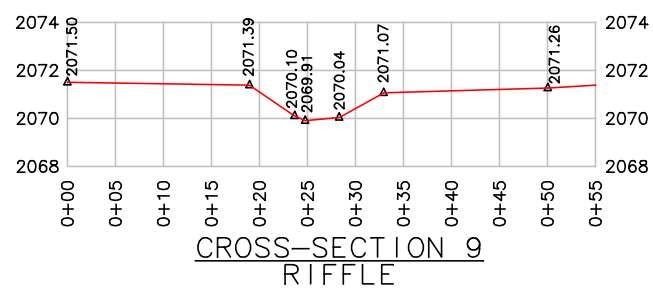
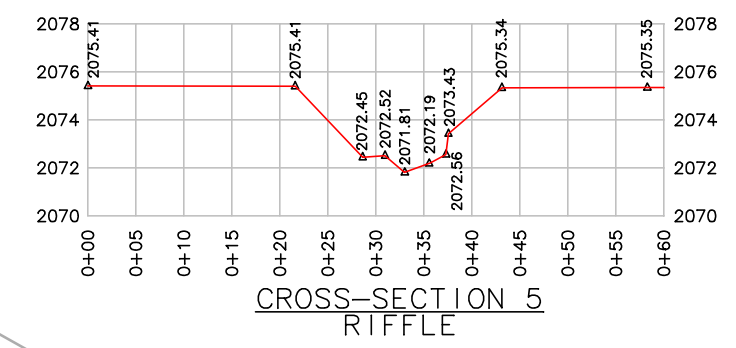
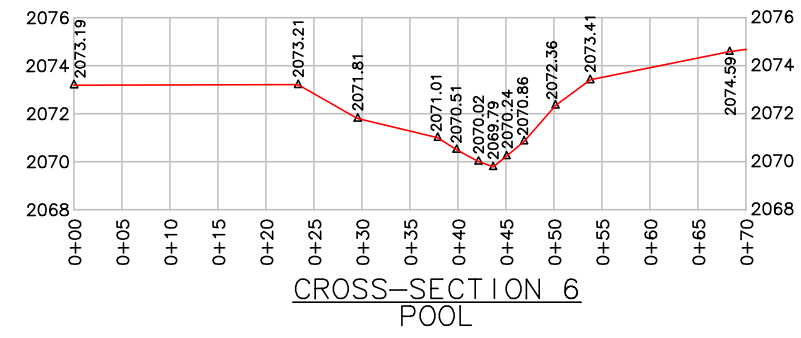

<p>REVISIONS, DATE AND INITIAL:</p>	<p>TURNER LAND SURVEYING, PLLC 3201 Glenridge Drive, Raleigh, NC 27604 - (919)75-1378 Lturner@tnc.com - Dturner119@tnc.com WWW.TURNERLANDSURVEYING.COM</p>
<p>PARKER TRACT AS-BUILT SURVEY OF CAT CREEK STREAM & WETLAND RESTORATION SCO# 050657901</p>	
<p>MACON COUNTY FRANKLIN NORTH CAROLINA</p>	
<p>DATE: 06/01/2010</p> <p>SURVEYED BY: DST/EGT</p> <p>DRAWN BY: DST/EGT</p> <p>REVIEWED BY: DST/EGT</p> <p>PROJECT: TLS-09-003</p> <p>FILE: CAT CREEK AS-BUILT FINAL 080410.DWG</p> <p>SCALE: 1" = 80'</p>	
<p>SHEET: 5 of 10</p>	

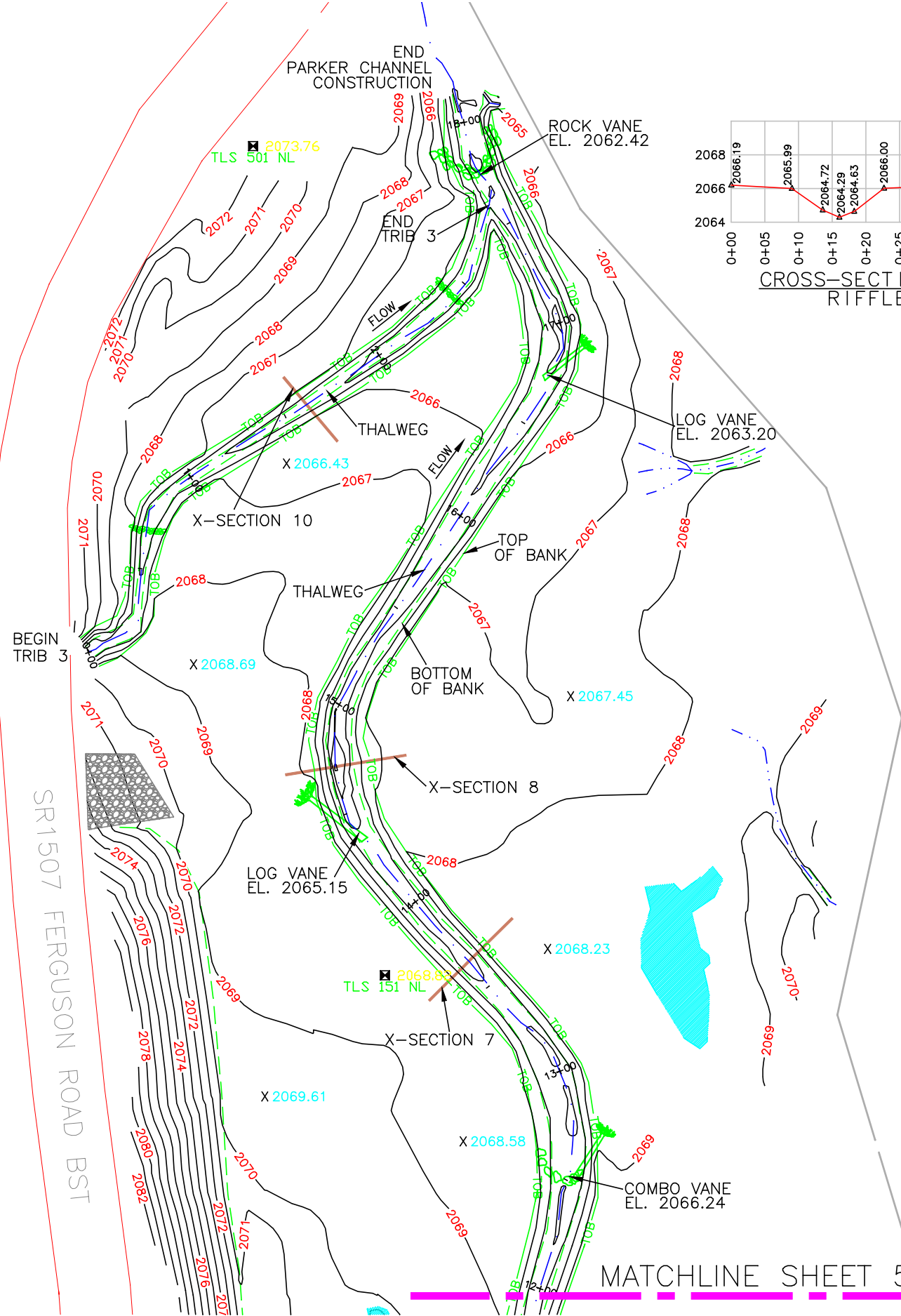

GENERAL NOTES

1. SEE SHEET 1 FOR GENERAL NOTES.
2. TEN (10) PAGE DOCUMENT IS NOT VALID WITHOUT TITLE SHEET.

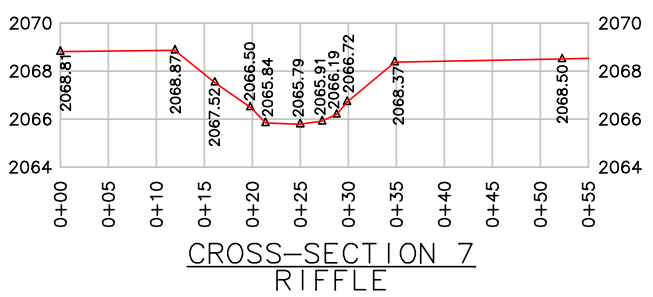
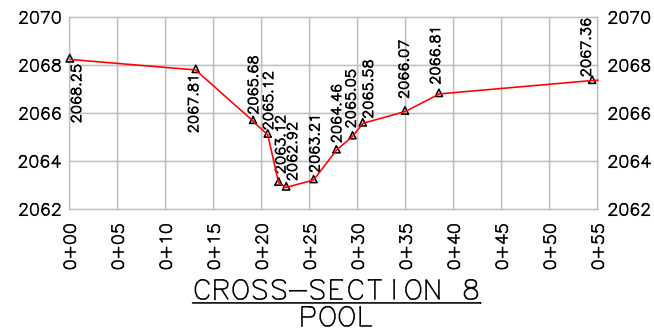
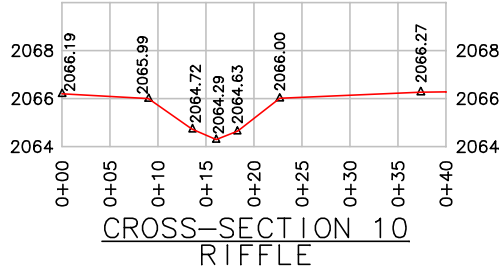

LEGEND:

- THALWEG
- TOP OF BANK
- BOTTOM OF BANK
- CENTERLINE FLOW
- OPEN WATER AREA
- EDGE OF WATER
- 2060.57 - SPOT ELEVATION
- ELEV DESC - BENCH MARK/CONTROL



SCALE 1"=60'
1' CONTOUR INTERVAL

REVISIONS, DATE AND INITIAL:

TURNER LAND SURVEYING, PLLC
3201 Glenridge Drive, Raleigh, NC 27604 - (919)975-1378
Lturner@tnc.com - Dturner119@tnc.com
WWW.TURNERLANDSURVEYING.COM



PARKER TRACT
AS-BUILT SURVEY OF
CAT CREEK STREAM & WETLAND RESTORATION
SCO# 050657901
FRANKLIN NORTH CAROLINA
MACON COUNTY

DATE:	06/01/2010
SURVEYED BY:	DST/EGT
DRAWN BY:	DST/EGT
REVIEWED BY:	DST/EGT
PROJECT:	TLS-09-003
FILE:	CAT CREEK AS-BUILT FINAL 080410.DWG
SCALE:	1" = 60'
SHEET:	6 of 10

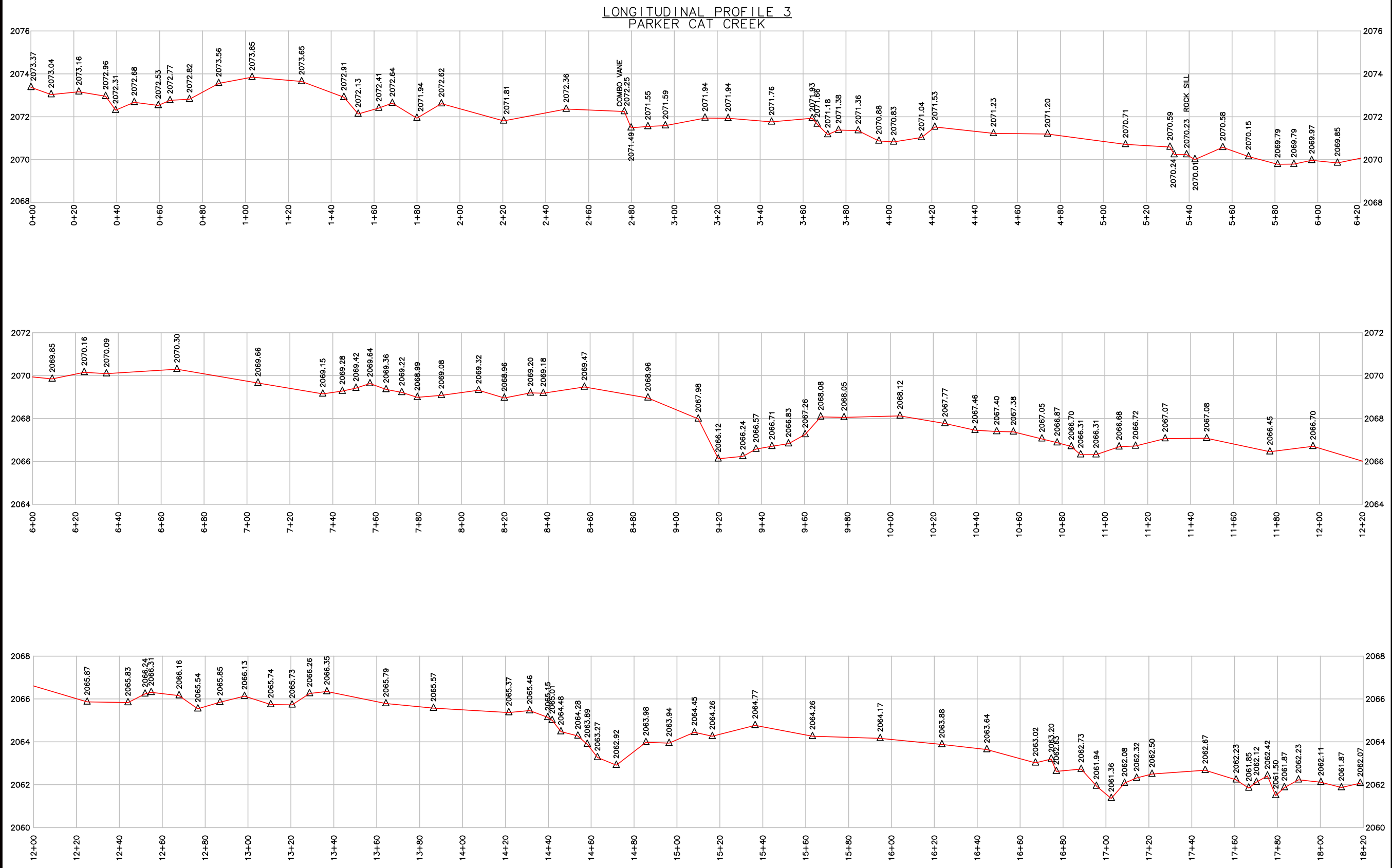

REVISIONS, DATE AND INITIAL:



TURNER LAND SURVEYING, PLLC
 3201 Glenridge Drive, Raleigh, NC 27604 - (919)75-1378
 Lturner@tnc.sr.com - Dturner119@tnc.sr.com
 WWW.TURNERLANDSURVEYING.COM

LONGITUDINAL PROFILE 3
AS-BUILT SURVEY OF
CAT CREEK STREAM & WETLAND RESTORATION
 SCO# 050657901

FRANKLIN
 MACON COUNTY
 NORTH CAROLINA

DATE:	06/01/2010
SURVEYED BY:	DST/EGT
DRAWN BY:	DST/EGT
REVIEWED BY:	DST/EGT
PROJECT:	TLS-09-003
FILE:	CAT CREEK AS-BUILT FINAL 080410.DWG
SCALE:	N/A

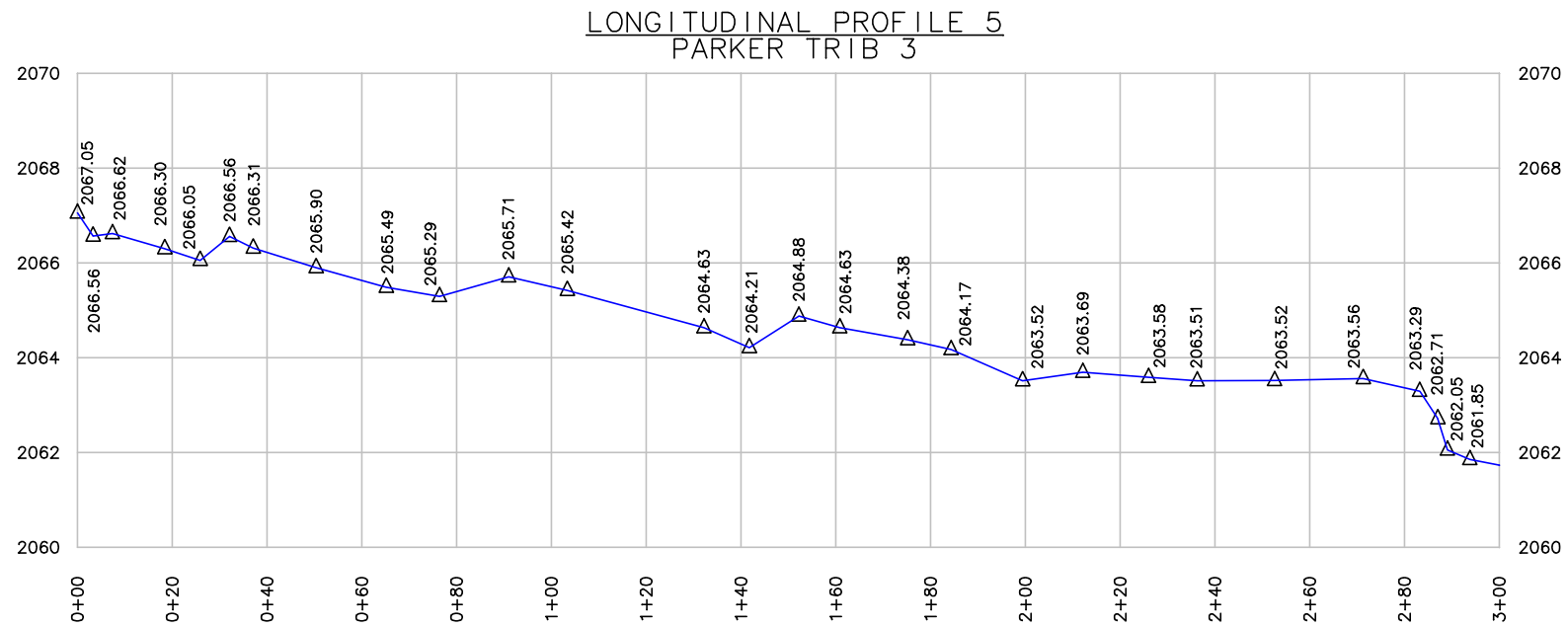
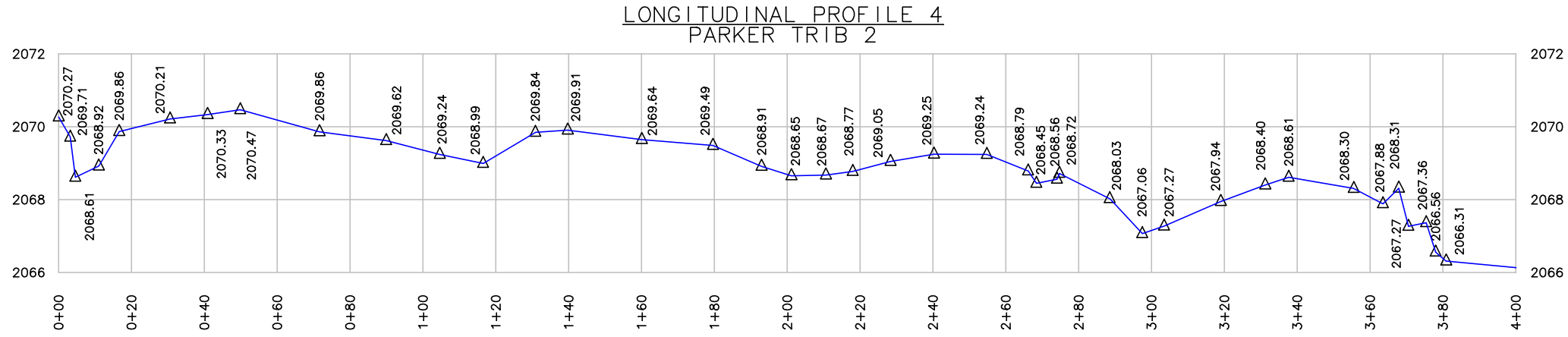

REVISIONS, DATE AND INITIAL:



TURNER LAND SURVEYING, PLLC
 3201 Glenridge Drive, Raleigh, NC 27604 - (919)875-1378
 Lturner@tnc.com - Dturner119@tnc.com
 www.TURNERLANDSURVEYING.com

LONGITUDINAL PROFILE 4 & 5
AS-BUILT SURVEY OF
CAT CREEK STREAM & WETLAND RESTORATION
 SCO# 050657901

FRANKLIN MACON COUNTY NORTH CAROLINA

DATE: 06/01/2010
 SURVEYED BY: DST/EGT
 DRAWN BY: DST/EGT
 REVIEWED BY: DST/EGT
 PROJECT: TLS-09-003
 FILE: CAT CREEK AS-BUILT FINAL 080410.DWG
 SCALE: N/A

SHEET:
6 of 10

MATCHLINE SHEET 10

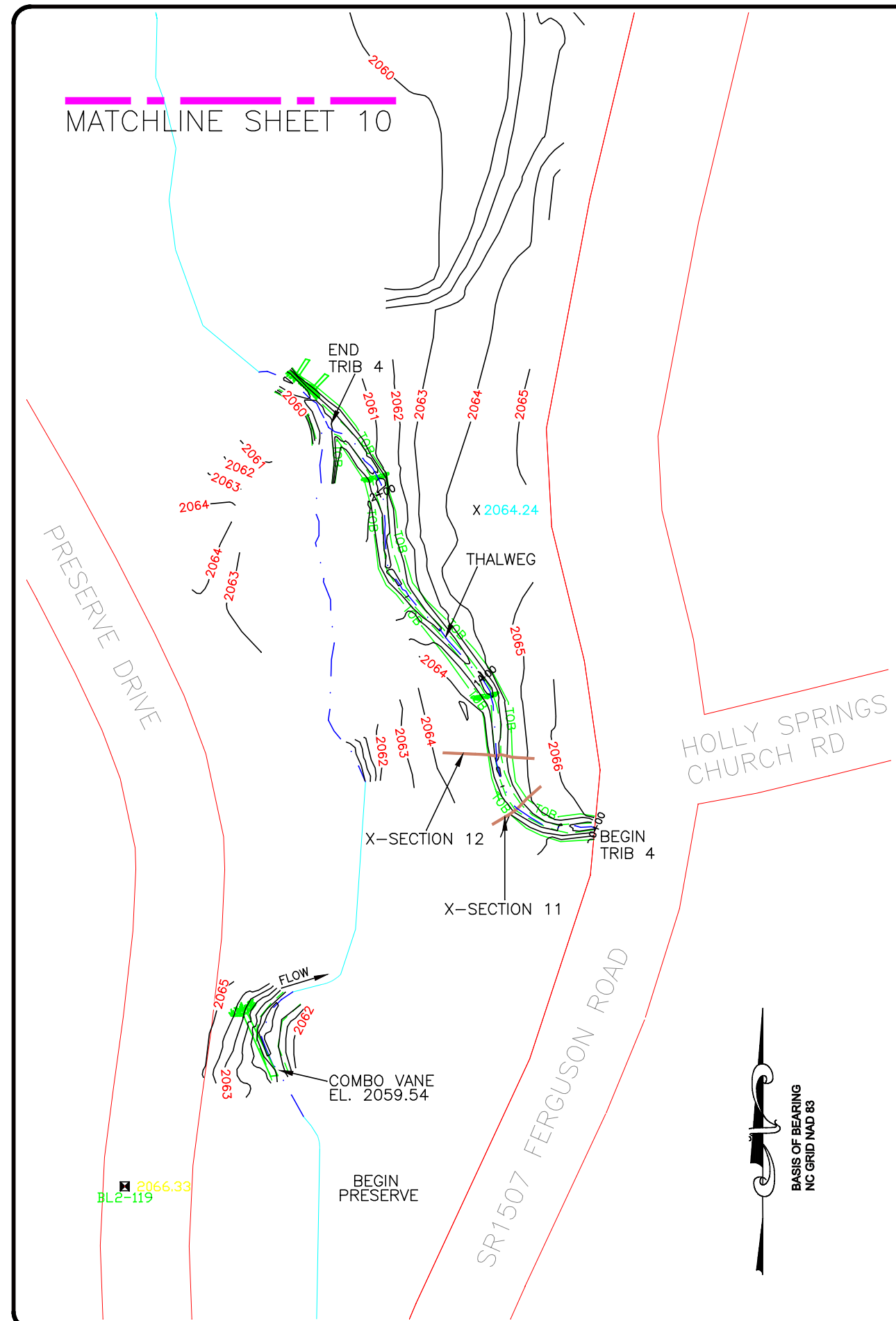

LONGITUDINAL PROFILE 6
PRESERVE TRIB 4

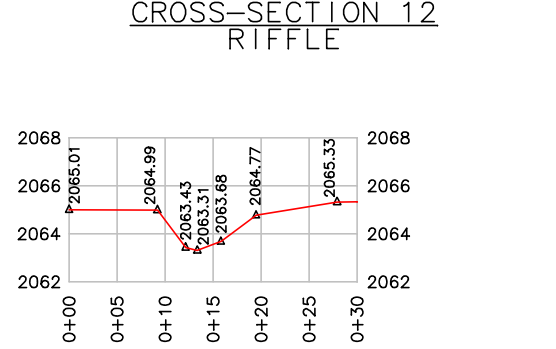
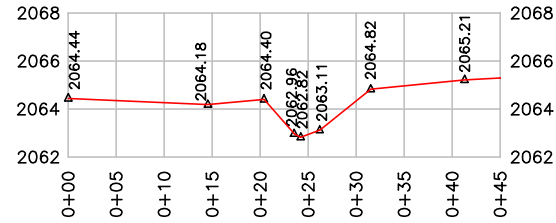
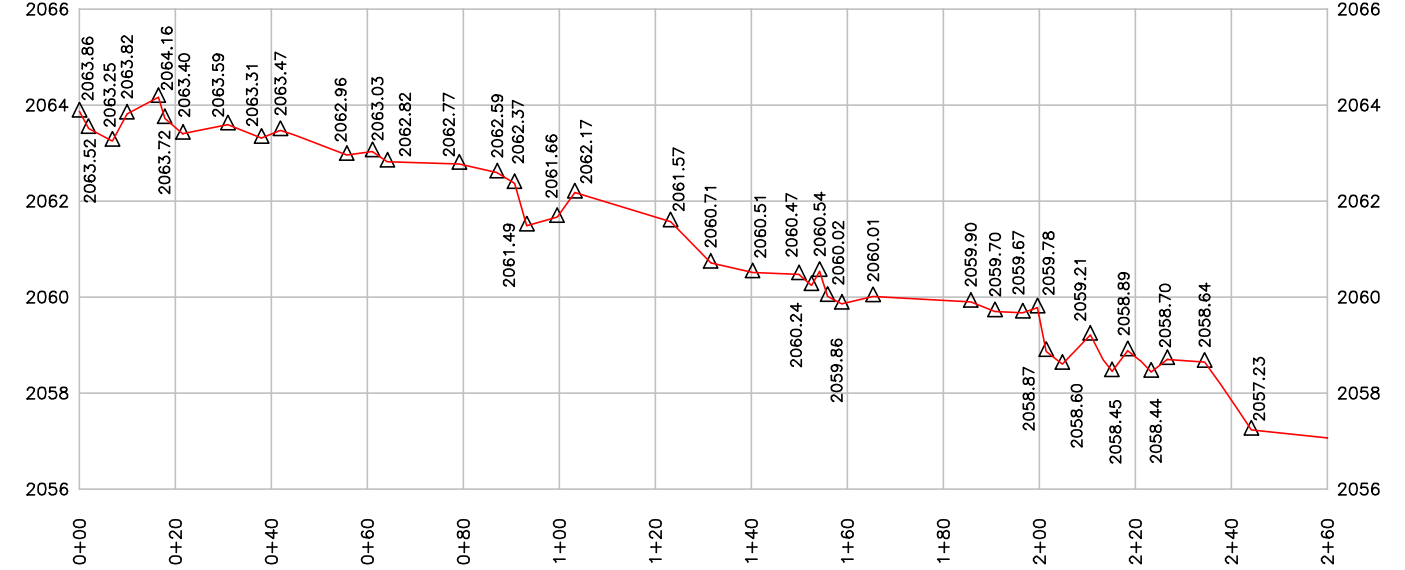

- LEGEND:
- THALWEG
 - TOP OF BANK
 - BOTTOM OF BANK
 - CENTERLINE FLOW
 - OPEN WATER AREA
 - EDGE OF WATER
 - 2060.57 X - SPOT ELEVATION
 - ELEV DESC - BENCH MARK/CONTROL

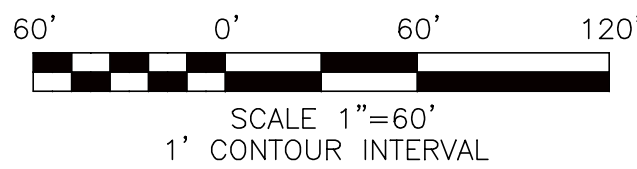

GENERAL NOTES
 1. SEE SHEET 1 FOR GENERAL NOTES.
 2. TEN (10) PAGE DOCUMENT IS NOT VALID WITHOUT TITLE SHEET.

REVISIONS, DATE AND INITIAL:

TURNER LAND SURVEYING, PLLC
 3201 Glenridge Drive, Raleigh, NC 27604 - (919)75-1378
 Lturner@tlr.com - Dturner119@tlr.com
 WWW.TURNERLANDSURVEYING.COM



EXISTING PRESERVE
AS-BUILT SURVEY OF
CAT CREEK STREAM & WETLAND RESTORATION
 SCO# 050657901

FRANKLIN NORTH CAROLINA
 MACON COUNTY

DATE:	06/01/2010
SURVEYED BY:	DST/EGT
DRAWN BY:	DST/EGT
REVIEWED BY:	DST/EGT
PROJECT:	TLS-09-003
FILE:	CAT CREEK AS-BUILT FINAL 080410.DWG
SCALE:	1" = 60'
SHEET:	9 of 10

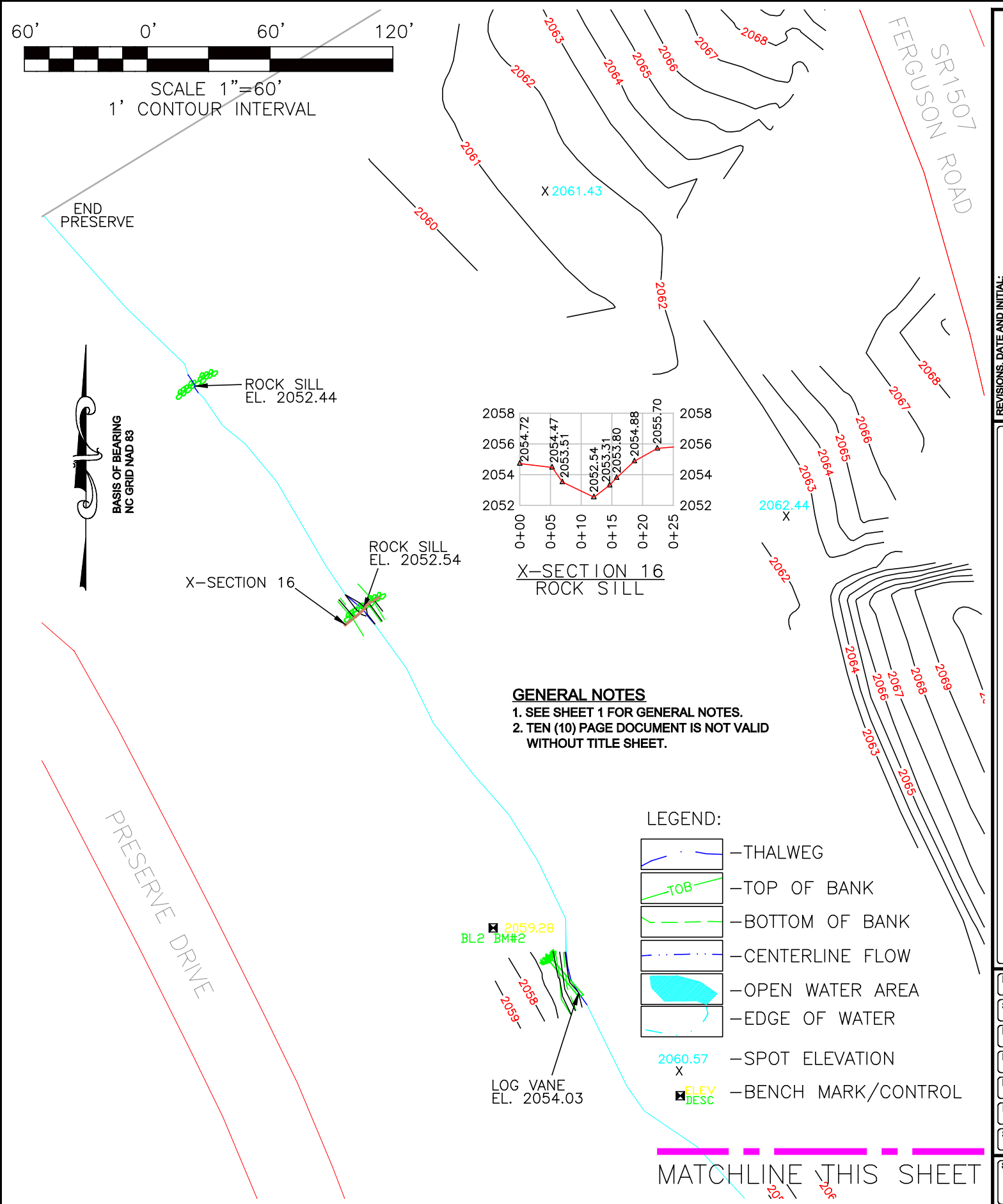
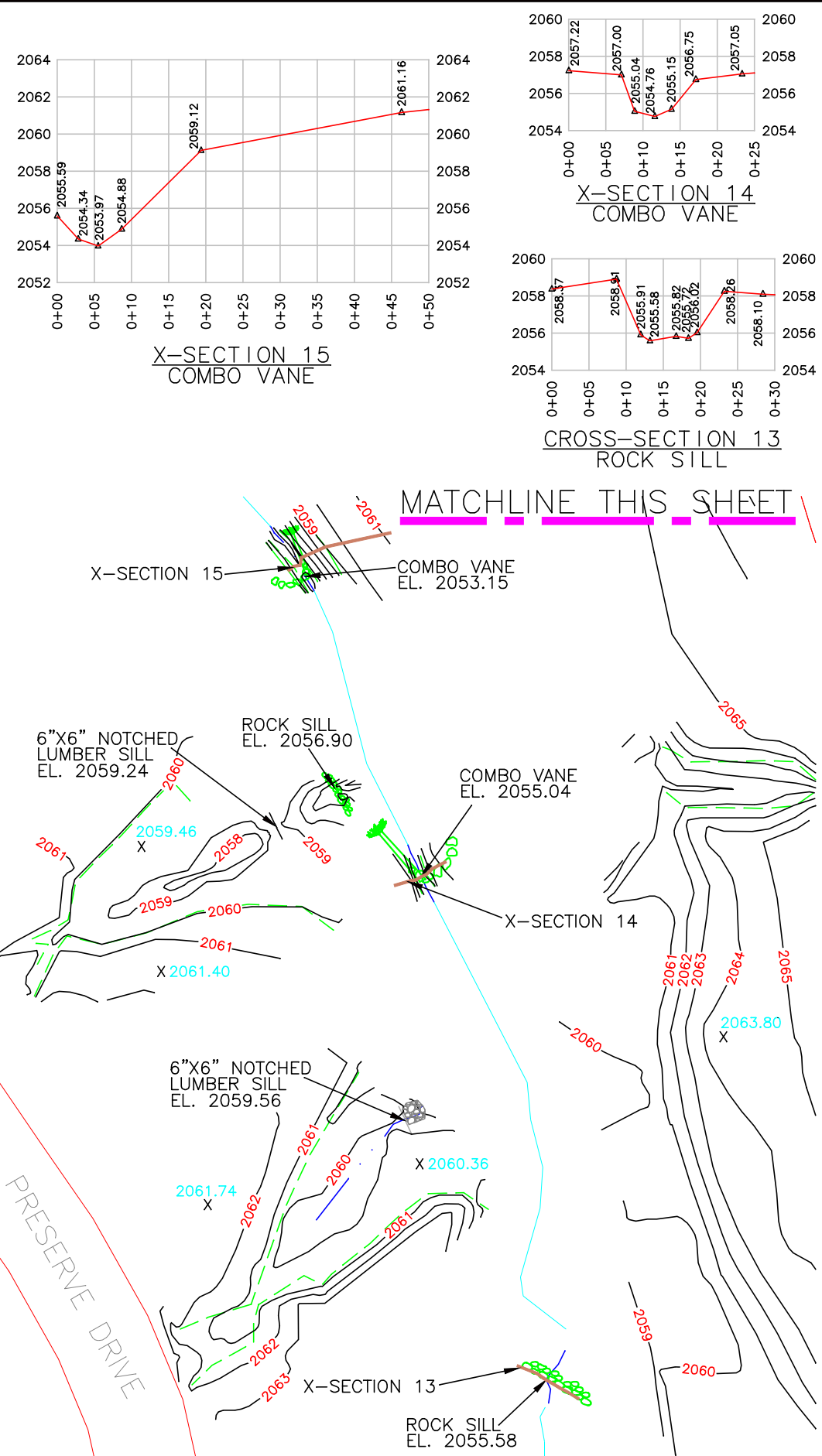

GENERAL NOTES
 1. SEE SHEET 1 FOR GENERAL NOTES.
 2. TEN (10) PAGE DOCUMENT IS NOT VALID WITHOUT TITLE SHEET.

LEGEND:

	-THALWEG
	-TOP OF BANK
	-BOTTOM OF BANK
	-CENTERLINE FLOW
	-OPEN WATER AREA
	-EDGE OF WATER
	-SPOT ELEVATION
	-BENCH MARK/CONTROL

REVISIONS, DATE AND INITIAL:

TURNER LAND SURVEYING, PLLC
 3201 Glenridge Drive, Raleigh, NC 27604 - (919)75-1378
 Lturner@tnc.com - Dturner119@tnc.com
 WWW.TURNERLANDSURVEYING.COM

EXISTING PRESERVE
AS-BUILT SURVEY OF
CAT CREEK STREAM & WETLAND RESTORATION
 SCO# 050657901

DATE: 06/01/2010
 SURVEYED BY: DST/EGT
 DRAWN BY: DST/EGT
 REVIEWED BY: DST/EGT
 PROJECT: TLS-09-003
 FILE: CAT CREEK AS-BUILT FINAL 080410.DWG
 SCALE: 1" = 60'
 SHEET: 10 of 10

NORTH CAROLINA
 MACON COUNTY
 FRANKLIN