

CROWNS WEST STREAM RESTORATION PROJECT

ANNUAL MONITORING REPORT FOR 2010 (YEAR 4)

Contract Number D06003-2



Submitted to: NCDENR - Ecosystem Enhancement Program
2728 Capital Blvd, Suite 1H 103
Raleigh, NC 27604



Prepared by: Michael Baker Engineering, Inc.

Baker

Michael Baker Engineering, Inc.
8008 Regency Parkway
Suite 2002
Cary, North Carolina 27516
Phone: 919.493.6488
Fax: 919.493.6490

December 2010

DRAFT

TABLE OF CONTENTS

1.0 EXECUTIVE SUMMARY	1
2.0 PROJECT BACKGROUND.....	3
2.1 Project Objectives	3
2.2 Project Structure, Restoration Type and Approach.....	3
2.3 Location and Setting.....	4
2.4 Project History and Background	4
2.5 Project Plan	4
3.0 PROJECT CONDITION AND MONITORING RESULTS.....	8
3.1 Vegetation Assessment	8
3.1.1 Description of Vegetative Monitoring	8
3.1.2 Vegetative Success Criteria	8
3.1.3 Vegetative Observations and Results.....	9
3.1.4 Vegetative Problem Areas	10
3.1.5 Vegetation Photographs	11
3.2 Stream Assessment.....	11
3.2.1 Morphometric Success Criteria.....	11
3.2.2 Morphometric Results.....	12
3.2.3 Hydrologic Criteria	12
3.2.4 Hydrologic Monitoring Results	13
3.2.5 Stream Problem Areas	13
3.2.6 Stream Photographs	14
3.2.7 Stream Stability Assessment.....	14
3.2.8 Quantitative Measures Summary Tables	14
3.2.9 Benthic Macroinvertebrate Sampling	15
3.2.10 Benthic Macroinvertebrate Sampling Results and Discussion	15
4.0 OVERALL CONCLUSIONS AND RECOMMENDATIONS.....	17
5.0 WILDLIFE OBSERVATIONS	18
6.0 REFERENCES.....	18

APPENDICES

APPENDIX A - Vegetation Raw Data

APPENDIX B – Stream Raw Data

LIST OF TABLES

Table 1.	Design Approach for the Crowns West Restoration Site
Table 2.	Project Activity and Reporting History
Table 3.	Project Contacts
Table 4.	Project Background
Table 5.	Vegetation Species Planted Across the Restoration Site
Table 6.	Verification of Bankfull Events
Table 7.	Summary of Pre-Restoration vs. Post-Restoration Benthic Macroinvertebrate Sampling Data
Table A.1.	Vegetation Metadata
Table A.2.	Vegetation Vigor by Species
Table A.3.	Vegetation Damage by Species
Table A.4.	Vegetation Damage by Plot
Table A.5.	Stem Count by Plot and Species
Table A.6.	Stem Count for Each Species Arranged by Plot
Table B.1.	Categorical Stream Feature Visual Stability Assessment
Table B.2.	Baseline Stream Summary
Table B.3.	Morphology and Hydraulic Monitoring Summary

LIST OF FIGURES

Figure 1.	Location of Crowns West Restoration Site.
Figure 2A.	As-built Plan Sheet 1 for the Crowns West Restoration Site.
Figure 2B.	As-built Plan Sheet 3 for the Crowns West Restoration Site.
Figure 2C.	As-built Plan Sheet 4 for the Crowns West Restoration Site.
Figure 2D.	As-built Plan Sheet 5 for the Crowns West Restoration Site.
Figure 2E.	As-built Plan Sheet 6 for the Crowns West Restoration Site
Figure 2F.	As-built Plan Sheet 7 for the Crowns West Restoration Site
Figure 2G.	As-built Plan Sheet 8 for the Crowns West Restoration Site

1.0 EXECUTIVE SUMMARY

This Annual Report details the monitoring activities during the 2010 growing season (Monitoring Year 4) on the Crowns West Stream Restoration Site (“Site”). As per the approved Restoration Plan for the Site, this Annual Monitoring Report presents data on stream geometry, stem count data from vegetation monitoring stations, and discusses any observed tendencies relating to stream stability and vegetation survival success.

Crowns West Branch had been channelized and riparian vegetation had been cleared in the lower half of the Site. The upstream area had a degraded, early successional buffer that included several exotic species. Prior to restoration, Crowns West Branch was incised along its length and lacked bedform diversity. As a result, channel degradation was widespread throughout the Site. After construction, it was determined that 3,835 linear feet (LF) of stream were restored.

A total of 11 monitoring plots 100 square meters (m²) (10m x 10m) in size were used to predict survivability of the woody vegetation planted on-site. Data from the Year 4 monitoring event of the 11 vegetation plots showed a range of 486 to 972 stems per acre, with an average survivability of 659 stems per acre. The site is currently on track for meeting the final success criteria of 260 trees per acre by the end of Year 5.

During Year 4 monitoring, kudzu (*Pueraria spp.*) and privet (*Ligustrum L.*) were observed on the Site. The kudzu is located east of Haw Branch Road and is present in the NC Division of Highways (NCDOT) right-of-way and also occurs within the project easement. The privet is located along the southern easement boundary, west of Haw Branch Road or along the right side of the restored channel west, of Haw Branch Road. The kudzu areas were treated in 2010 and are scheduled to be treated again during the 2011 growing season. The areas of privet were not treated during Year 4, but were previously treated in 2009. The privet is also scheduled to be treated during the 2011 growing season.

The total length of stream channel restored on the Site was 3,835 LF. This entire length was inspected during Year 4 of the monitoring period (2010) to assess stream performance. The visual stability assessment noted during Year 3 monitoring, several locations on M2 and the lower portion of M1 exhibited localized bank erosion, mostly in locations where sandy soils were present. During Year 4 of monitoring, these areas did not exhibit any further problems and do not call for repair at this time. According to the cross-section survey, stream dimension also remained stable during Year 4. The longitudinal profile for Year 4 showed that the in-stream structures and features are remaining stable.

The on-site crest gauge documented the occurrence of at least two bankfull flow events during Year 4 of the post-construction monitoring period. Inspection of conditions during site visits revealed visual evidence of out-of-bank flows. The largest on-site stream flow documented by the crest gauge during Year 4 of monitoring was approximately 3.72 feet (44.64 inches) above the bankfull stage.

Year 3 macro invertebrate sampling for Site 1 showed substantial improvements in the samples. The Year 3 post-restoration data has shown that the Site has developed from a newly established coastal plain stream system with a weak benthic macroinvertebrate community into a system that exhibits diverse habitat, is continuing to mature, and is able to support and cultivate biological diversity.

The Restoration Plan for the Site did not include wetland areas. Therefore, no groundwater monitoring stations or rain gauges were installed on the Site.

In summary, the Site is on track to meet the vegetative, hydrologic, and stream success criteria specified in the Site's Restoration Plan.

2.0 PROJECT BACKGROUND

The project involved the proposed restoration of 3,835 LF of stream. Table 1 summarizes the restoration areas on the Site. Selected site photographs are shown in Appendix A and B. A total of 10.8 acres of stream and riparian buffer are protected through a permanent conservation easement.

2.1 Project Objectives

The specific goals for the Crowns West Site Restoration Project were as follows:

- Restore 3,904 LF of channel dimension, pattern and profile
- Improve floodplain function by matching floodplain elevation with bankfull stage
- Establish native stream bank and floodplain vegetation in the 10.8-acre permanent conservation easement
- Improve water quality in the Crowns West and New River watersheds by reducing sediment and nutrient inputs
- Improve aquatic and riparian habitat by creating deeper pools and areas of re-aeration, planting a riparian buffer, and reducing bank erosion.

2.2 Project Structure, Restoration Type and Approach

For analysis and design purposes, Baker Engineering divided on-site streams into reaches. The reaches were numbered sequentially from west to east, with an “M” designation for “mainstem.” M1 begins on the upstream portion of the project, and flows east, ending at Haw Branch Road. M2 begins at Haw Branch Road and flows east, to the end of the wood line at the downstream end of the project. One unnamed tributary (UT1) flowing from Haw Branch Road to the confluence with Crowns West Branch was originally proposed for restoration and was included in the 3,904 LF of stream restoration originally proposed for the Site. The landowner withdrew this short section of UT1 in exchange for additional property and stream length at the upstream section of M1 on Crowns West Branch. UT1 was to be tied into M2, as an alternative the tie-in point to M2 was stabilized.

The restoration design allows stream flows larger than bankfull flows to spread onto the floodplain, dissipating flow energies and reducing stress on streambanks. In-stream structures were used to control streambed grade, reduce streambank stress, and promote bedform sequences and habitat diversity. The in-stream structures consisted of root wads, log vanes, log weirs, and constructed riffles, which promote a diversity of habitat features in the restored channel. Where grade control was a consideration, constructed riffles were installed to provide long-term stability. Streambanks were stabilized using a combination of erosion control matting, temporary and permanent seeding, bare-root planting, and transplants. Transplants provide living root mass to increase streambank stability and create holding areas for fish and aquatic biota. Native vegetation was planted across the Site. The entire restoration project is protected through a permanent conservation easement.

Table 1. Design Approach for the Crowns West Restoration Site

Crowns West Restoration Site: Project No. D06003-2				
Project Segment or Reach ID	Mitigation Type *	Approach**	Linear Footage	Stationing
M1	R	P1, P2	2,320	10+46 - 24+37
M2	R	P1, P2	1,515	24+09 - 36+13
Total linear feet of channel restored:			3,835	

*R = Restoration

**P1 = Priority I
P2 = Priority II

2.3 Location and Setting

The Site is located in Onslow County, NC (Figure 1), approximately six miles northwest of the town of Richlands. The Site lies in the White Oak River Basin within North Carolina Division of Water Quality sub-basin 03-05-02 and NCEEP targeted local watershed 03030001010010.

2.4 Project History and Background

Land use on the Site consisted primarily of row crop agriculture with adjacent woodlands. Crowns West Branch had been channelized and riparian vegetation had been cleared in the lower half of the Site. The upstream area had a degraded, early successional buffer that included several exotic species. Prior to restoration, Crowns West Branch was incised and lacked bedform diversity. As a result, channel degradation was widespread throughout the Site.

The chronology of the Crowns West Project is presented in Table 2. The contact information for all designers, contractors, and relevant suppliers is presented in Table 3. Relevant project background information is presented in Table 4.

2.5 Project Plan

Plans depicting the as-built conditions of the major project elements, locations of permanent monitoring cross-sections, and locations of permanent vegetation monitoring plots are presented in Figures 2A, 2B, 2C, 2D, 2E, 2F and 2G of this report.

Table 2. Project Activity and Reporting History

Crowns West Restoration Site: Project No. D06003-2			
Activity or Report	Scheduled Completion	Data Collection Complete	Actual Completion or Delivery
Restoration Plan Prepared	N/A	N/A	Jul-06
Restoration Plan Amended	N/A	N/A	N/A
Restoration Plan Approved	N/A	N/A	Aug-06
Final Design – (at least 90% complete)	N/A	N/A	Oct-06
Construction Begins	Nov-06	N/A	Nov-06
Temporary S&E mix applied to entire project area	N/A	N/A	Mar-07
Permanent seed mix applied to entire project area	Mar-07	N/A	Mar-07
Planting of live stakes	Mar-07	N/A	Mar-07
Planting of bare root trees	Mar-07	N/A	Mar-07
End of Construction	Mar-07	N/A	Mar-07
Survey of As-built conditions (Year 0 Monitoring-baseline)	Mar-07	Mar-07	Mar-07
Year 1 Monitoring	Dec-07	Oct-07	Dec-07
Year 2 Monitoring	Dec-08	Oct-08	Dec-08
Year 3 Monitoring	Dec-09	Oct-09	Dec-09
Year 4 Monitoring	Dec-10	Oct-10	Dec-10
Year 5 Monitoring	Scheduled Dec-11	Scheduled Oct-11	Scheduled Dec-11

Table 3. Project Contacts

Crowns West Restoration Site: Project No. D06003-2	
Designer	
Michael Baker Engineering, Inc.	8000 Regency Parkway, Suite 200 Cary, NC 27518 <u>Contact:</u> Kevin Tweedy, Tel. 919-463-5488
Construction Contractor	
River Works, Inc.	8000 Regency Parkway, Suite 200 Cary, NC 27518 <u>Contact:</u> Will Pedersen, Tel. 919-459-9001
Planting Contractor	
River Works, Inc.	8000 Regency Parkway, Suite 200 Cary, NC 27518 <u>Contact:</u> Will Pedersen, Tel. 919-459-9001
Seeding Contractor	
River Works, Inc.	8000 Regency Parkway, Suite 200 Cary, NC 27518 <u>Contact:</u> Will Pedersen, Tel. 919-459-9001
Seed Mix Sources	Mellow Marsh Farm, 919-742-1200
Nursery Stock Suppliers	International Paper, 1-888-888-7159
Monitoring Performers	
Michael Baker Engineering, Inc.	8000 Regency Parkway, Suite 200 Cary, NC 27518
Stream Monitoring Point of Contact:	Dwayne Huneycutt, Tel. 919-463-5488
Vegetation Monitoring Point of Contact:	Dwayne Huneycutt, Tel. 919-463-5488

Table 4. Project Background

Crowns West Restoration Site: Project No. D06003-2	
Project County:	Onslow County, NC
Drainage Area:	
Reach: M1	0.65 mi ²
Reach: M2	0.98 mi ²
Estimated Drainage % Impervious Cover:	
M1	<5%
M2	<5%
Stream Order:	
M1	1
M2	2
Physiographic Region	Coastal Plain
Ecoregion	Carolina Flatwoods
Rosgen Classification of As-Built	C5c
Cowardin Classification	Riverine, Upper Perennial, Unconsolidated Bottom, Sand
Dominant Soil Types	
M1	Mk,CrB
M2	Mk,CrB, AuB
Reference site ID	Beaverdam Branch
USGS HUC for Project and Reference sites	03030001010010
NCDWQ Sub-basin for Project and Reference	03-05-02
NCDWQ classification for Project and Reference	C
Any portion of any project segment 303d listed?	No
Any portion of any project segment upstream of a 303d listed segment?	No
Reasons for 303d listing or stressor?	N/A
% of project easement fenced	0%

3.0 PROJECT CONDITION AND MONITORING RESULTS

3.1 Vegetation Assessment

3.1.1 Description of Vegetative Monitoring

As a final stage of construction, the stream margins and riparian area of the Site were planted with bare root trees, live stakes, and a seed mixture of temporary and permanent ground cover herbaceous vegetation. The woody vegetation was planted randomly six to eight feet apart from the top of the stream banks to the outer edge of the project’s re-vegetation limits. In general, bare-root vegetation was planted at a target density of 680 stems per acre, in an 8-foot by 8-foot grid pattern. The tree species planted at the Site are shown in Table 5. The permanent seed mix of herbaceous species applied to the project’s riparian area included soft rush (*Juncus effuses*), reedtop (*Agrostis alba*), Virginia wild rye (*Elymus virginicus*), switchgrass (*Panicum virgatum*), smartweed (*Polygonum pennsylvanicum*), tick seed (*Bidens frondosa*), lance leaf coreopsis (*Coreopsis lanceolata*), fox sedge (*Carex vulpinoidea*), hop sedge (*Carex lupulina*), and shallow sedge (*Carex lurida*). This seed mixture was broadcast on the Site at a rate of 15 pounds per acre. All planting was completed in March 2007.

At the time of planting, 11 vegetation plots – labeled 1 through 11 - were delineated on-site to monitor survival of the planted woody vegetation. Each vegetation plot is 0.025 acre in size, or 10 meters x 10 meters. All of the planted stems inside the plot were flagged to distinguish them from any colonizing individuals and to facilitate locating them in the future. The trees also were marked with aluminum metal tags to ensure that the correct identification is made during future monitoring of the vegetation plots.

On a designated corner within each of the eleven vegetation plots, one herbaceous plot was also delineated. The herbaceous plots measure 1 meter x 1meter in size. These plots are photographed at the end of the growing season. The locations of the eleven vegetation plots are presented in Figures 2A through 2G.

3.1.2 Vegetative Success Criteria

To characterize vegetation success criteria objectively, specific goals for woody vegetation density have been defined. Data from vegetation monitoring plots should display a surviving tree density of at least 320 trees per acre at the end of the third year of monitoring, and a surviving tree density of at least 260 five-year-old trees per acre at the end of the five-year monitoring period.

Table 5. Vegetation Species Planted Across the Restoration Site			
Crowns West Restoration Site: Project No. D06003-2			
Scientific Name	Common Name	Percent Planted by Species	Total Number of Stems
Bare Root Trees Species			
<i>Betula nigra</i>	River Birch	15%	1,110
<i>Celtis laevigata</i>	Sugarberry	5%	370

Table 5. Vegetation Species Planted Across the Restoration Site			
Crowns West Restoration Site: Project No. D06003-2			
Scientific Name	Common Name	Percent Planted by Species	Total Number of Stems
<i>Fraxinus pennsylvanica</i>	Green Ash	7.50%	555
<i>Juglans nigra</i>	Black Walnut	5%	370
<i>Nyssa sylvatica var. biflora</i>	Swamp Tupelo	10%	740
<i>Platanus occidentalis</i>	Sycamore	20%	1,480
<i>Quercus lyrata</i>	Overcup Oak	10%	740
<i>Quercus michauxii</i>	Swamp Chestnut Oak	10%	740
<i>Quercus phellos</i>	Willow Oak	7.50%	555
<i>Taxodium distichum</i>	Bald Cypress	10%	740
Native Herbaceous Species			
<i>Elymus virginicus</i>	Virginia wildrye	15%	NA
<i>Panicum virgatum</i>	Switchgrass	15%	NA
<i>Carex vulpinoidea</i>	Fox sedge	5%	NA
<i>Polygonum pennsylvanicum</i>	Smart Weed	5%	NA
<i>Juncus effusus</i>	Soft rush	10%	NA
<i>Carex lupulina</i>	Hop sedge	10%	NA
<i>Agrostis alba</i>	Redtop	10%	NA
<i>Bidens frondosa</i>	Tick seed	10%	NA
<i>Coreopsis lanceolata</i>	Lance leaf coreopsis	10%	NA
<i>Carex lurida</i>	Shallow sedge	10%	NA
Woody Vegetation for Live Stakes			
<i>Salix sericia</i>	Silky Willow	40%	1,040
<i>Cornus amomum</i>	Silky Dogwood	40%	1,040
<i>Sambucus canadensis</i>	Elderberry	20%	520

3.1.3 Vegetative Observations and Results

The species that were planted as part of the permanent ground cover seed mixture broadcast on the Site after construction were present during Year 4 monitoring of the Site.

Tables A.1. through A.6. in Appendix A present vegetation metadata, vegetation vigor, vegetation damage and stem count data of the monitoring stations at the end of the Year 4 monitoring period. Data from the Year 4 monitoring event of the 11 vegetation plots showed a range of 486 to 972 stems per acre. The data showed that the plots had an average of 659 stems per acre.

Based on these results, all plots are on track to meet the interim success criteria of 260 stems per acre at the end of monitoring Year 5.

Trees within each monitoring plot are flagged regularly to prevent planted trees from losing their identifying marks due to flag degradation. It is important for trees within the monitoring plots to remain marked to ensure they are all accounted for during the annual stem counts and calculation of tree survivability. Permanent aluminum tags are used on surviving stems to aid in relocation and identification during future counts. Flags are also used to mark trees because they do not interfere with the growth of the tree.

No significant volunteer woody species were observed in any of the vegetation plots. The plots will be assessed during Year 5 monitoring for significant volunteer species.

3.1.4 Vegetative Problem Areas

During monitoring Year 3, two problems were observed in vegetation plot 1 that threatened survivability of the plot. These problems were weedy species occurring within the vegetation plot and saturated soils due to beaver dams. The strong presence of arrowleaf tearthumb (*Polygonum sagittatum*) and an unknown vine species in this area was affecting the survivability of the smaller planted stems. Another problem in this area was the presence of two beaver dams that had caused the soils to become saturated for extended periods. This had caused planted stems, mostly sycamores, to become unstable. These trees were observed to be leaning following Year 3 monitoring.

The beaver dams observed in the vegetation plot 1 area were scheduled to be removed in the winter of 2009/2010. Dwayne Huneycutt of Baker met with Mark Batchlor of the United States Department of Agriculture (USDA) on the Site in February 2010. It was noted during the site visit, that the beaver dams observed in the fall of 2009 were not present within the conservation easement. According to Mr. Batchlor of the USDA, it is likely that the beaver have moved off-site. No beaver dams or visible beaver activity were noted in September 2010. This upstream portion of the Site will be closely observed for future beaver activity during Year 5 of monitoring.

Other weedy species are mostly annuals and seem to pose very little threat to survivability on site.

During Year 4 monitoring, kudzu (*Pueraria spp.*) was observed on the Site. The kudzu is located south of Haw Branch Road in the NCDOT right-of-way and also within the project easement. Kudzu within the project easement was treated in September 2008, April 2009 and September 2009 by River Works, Inc. During monitoring Year 4, this area was treated in September 2010. Due to the subsequent treatment events, the kudzu is now under control within the conservation easement and elimination of the invasive plant appears to be possible by the conclusion of Year 5 monitoring in 2011.

Some privet (*Ligustrum L.*) was also observed on the Site, during Year 4 monitoring. The privet is located along the southern easement boundary, west of Haw Branch Road or

along the right side of the restored channel, west of Haw Branch Road. This area of privet was not treated in 2010. This area was previously treated in September 2008, April 2009 and September 2009 by River Works, Inc. Infested areas had been treated in previous years with herbicides and are scheduled to be treated again in 2011.

3.1.5 Vegetation Photographs

Photographs are used to visually document vegetation plot success. A total of 11 reference stations were established to document tree conditions at each vegetation plot across the Site. Additional photo stations were also established at each of the 11 vegetation plots for herbaceous vegetation monitoring. Reference photos of both tree conditions and herbaceous conditions are taken at least once per year. Photos of the tree plots showing the on-site vegetation are included in Appendix A of this report. Photos of the herbaceous plots are also included in Appendix A.

3.2 Stream Assessment

3.2.1 Morphometric Success Criteria

To document the stated success criteria, the following monitoring program was instituted following construction completion on the Site:

Cross-sections: Two permanent cross-sections were installed per 1,000 LF of stream restoration work, with one of the locations being a riffle cross-section and one location being a pool cross-section. A total of nine permanent cross-sections were established across the Site. Each cross-section was marked on both banks with permanent pins to establish the exact transect used. The permanent cross-section pins are surveyed and located relative to a common benchmark to facilitate easy comparison of year-to-year data. The annual cross-section surveys include points measured at all breaks in slope, including top of bank, bankfull, inner berm, edge of water, and thalweg.

The approved Restoration Plan requires the following criteria be met to achieve stream restoration success. There should be little change in as-built cross-sections. If changes do take place, they will be evaluated to determine if they represent a movement toward a more unstable condition (e.g., down-cutting or erosion) or a movement toward increased stability (e.g., settling, vegetative changes, deposition along the banks, or decrease in width/depth ratio). Cross-sections will be classified using the Rosgen Stream Classification System, and all monitored cross-sections should fall within the quantitative parameters defined for channels of the design stream type.

Longitudinal Profiles: A complete longitudinal profile was surveyed following construction completion to record as-built conditions. The profile was conducted for the entire length of the restored channels (M1 and M2). Measurements included thalweg, water surface, bankfull, and top of low bank. Each of these measurements was taken at the head of each feature (e.g., riffle, pool, and glide). In addition, maximum pool depth was recorded. All surveys were tied to a single, permanent benchmark.

As directed by EEP guidelines, longitudinal profiles will be completed in all five years of the monitoring period. The longitudinal profiles should show that the bedform features are remaining stable; i.e., they are not aggrading or degrading. The pools should remain deep, with flat water surface slopes, and the riffles should remain steeper and shallower

than the pools. Bedforms observed should be consistent with those observed for channels of the design stream type.

3.2.2 Morphometric Results

Year 4 cross-section monitoring data for stream stability were collected during October 2010. The nine permanent cross-sections along the restored channels (five located across riffles and four located across pools) were re-surveyed to document stream dimension at the end of monitoring Year 4. Data from each of these cross-sections were compared to data collected during the as-built condition survey, Years 1, 2 and 3 of monitoring. The cross-sectional data are presented in Appendix B. The cross-sections show that there has been very little adjustment to stream dimension since construction.

Cross-sections 1, 3, 4, 7 and 8 are located across riffles found between meander bends. Cross-section 1 has aggraded slightly since the as-built survey but has remained relatively stable through Year 4. The channels in cross-sections 3, 4, 7 and 8 have remained relatively stable since the as-built survey. The floodplains of cross-sections 7 and 8 remained stable through Year 4 monitoring. It was noted during Years 2 and 3 that visual on-site observations of areas east of Haw Branch Road documented deposition of sediment on the floodplain. This is considered to be a natural system response and no areas of concern have been noted due to the deposition.

Cross-sections 2, 5, 6, and 9 are located across pools found at the apex of meander bends. Based on the cross-section data, the pool at cross-section 6 has filled slightly since Year 1 monitoring but has remained relatively stable through Years 2, 3, and 4. It was noted during Year 4 that cross-sections 2, 5 and 9 have remained at or below the as-built thalweg elevations in the maximum pool depths. All pools are remaining deep and seem to be stable.

The longitudinal profiles of reaches M1 and M2 are presented in Appendix B. The longitudinal profile for Year 4 was surveyed in October 2010 and was compared to data collected during the as-built condition survey, and Years 1, 2 and 3 of monitoring. The results of the Year 4 longitudinal profile show that the pools and riffles in M1 have maintained elevations and pool depths, similar to those documented during the as-built survey, and Years 1, 2 and 3 of monitoring. The longitudinal profile shows that the riffles and in-stream structures throughout reach M1 are stable.

The Year 4 profile for M2 shows that the riffles and pools at the beginning of the reach, (stations 33+95 to 42+50) have aggraded slightly since as-built conditions. This section of M2 is showing a tendency to aggrade in drier years (Year 2 and 4) and scour back out in wetter years (i.e. Year 3). This is considered to be a normal pattern of stream bed dynamics within sandbed streams. The Year 4 profile for M2 shows that the pools have remained deep since Year 1. The longitudinal profile for M2 shows that the riffles and in-stream structures are stable on the downstream portion of the reach.

3.2.3 Hydrologic Criteria

One crest gauge was installed on the Site to document bankfull events. The gauge is checked regularly and records the highest out-of-bank flow between site visits. The gauge is located on the downstream portion of reach M2, which is presented in Figure 2G.

The approved Restoration Plan requires that two bankfull flow events must be documented within the five-year monitoring period. The two bankfull events must occur in separate years, otherwise, the stream monitoring will continue until two bankfull events have been documented in separate years.

3.2.4 Hydrologic Monitoring Results

The on-site crest gauge documented the occurrence of at least two bankfull flow events during Year 4 of the post-construction monitoring period, as shown in Table 6. Inspection of conditions during site visits revealed visual evidence of out-of-bank flow, confirming the crest gauge readings. The highest on-site stream flow documented by the crest gauge during Year 4 of monitoring was approximately 3.72 feet (44.64 inches) above the bankfull stage and was the result of overbank flooding of M2. Photographs documenting bankfull evidence observed during Year 4 are presented in Appendix B.

Table 6. Verification of Bankfull Events

Crowns West Restoration Site: EEP Contract No. D06003-2			
Date of Data Collection	Estimated Date of Occurrence of Bankfull Event	Method of Data Collection	Measurement (feet)
2/9/2010	Winter of 2010	Crest Gage on M2	3.51
12/1/2010	9/29/2010	Crest Gage on M2	3.72

The crest gauge on the Site has documented at least one bankfull event per year since as-built conditions. Four bankfull events have been recorded in separate years, which meet the success criteria as stated the site Restoration Plan. The crest gauge readings will continue to be recorded through Year 5 of the project in order to observe flood event depths that may occur on the Site.

3.2.5 Stream Problem Areas

During Year 2 (2008) monitoring, the Site experienced several areas of localized bank erosion. These problems were repaired in November 2008. The stream problem areas were located on reaches M1 and M2. All problems areas were located in pools where erosion occurred around root wads that were installed in sandy soils. During Year 4 these repaired areas were functioning properly and will continue to be monitored closely during future site visits.

During Year 3 monitoring, several additional bank areas on M2 and the lower portion of M1 exhibited small localized, areas of bank erosion, attributed to the number of high flow events during the year and the presence of mostly sandy soils in the identified areas. These areas were small and were not considered to call for repair at this time. However, these areas are being closely observed during site visits. During Year 4 these areas were functioning properly with no further degradation and will continue to be monitored closely during future site visits.

In 2009, two beaver dams on the upstream portion of M1 had caused the soils to become saturated for an extended period. The saturation affected planted stems, mostly sycamores, to lean more than 45 degrees. As of October 2010, the dams are currently not present on the Site. All trees within the vegetation plot that were impacted by the soft soils are currently still alive and are included in the stems totals presented in Table A.1 through A.6. A detailed explanation of the beaver dams and affected areas are discussed in section 3.1.4 of this report.

3.2.6 Stream Photographs

Photographs are used to visually document restoration success. A total of 23 reference stations were established to document conditions at the constructed grade control structures across the Site, and additional photo stations were established at each of the 9 permanent cross-sections. The GPS coordinates of each grade control structure photo station have been noted as additional reference to ensure the same photo location is used throughout the monitoring period. Reference photos are taken at least once per year.

Each stream bank is photographed at each permanent cross-section photo station. For each stream bank photo, the photo view line follows a survey tape placed across the channel, perpendicular to flow (representing the cross-section line). The photograph is framed so that the survey tape is centered in the photo (appears as a vertical line at the center of the photograph), keeping the channel water surface line horizontal and near the lower edge of the frame.

Photographs will be used to document restoration success visually. Reference stations were photographed before construction and will be photographed for at least five years following construction. Reference photos will be taken once per year, from a height of approximately five to six feet. Permanent markers are established to ensure that the same locations (and view directions) on the Site are photographed during each monitoring event. Photos for each of the nine permanent cross-sections are included in Appendix B. A photo log of the restored channel is also presented in Appendix B of this report. Herbaceous vegetation is dense along the edges of the restored stream, making the photography of some of the stream channel areas difficult.

3.2.7 Stream Stability Assessment

A summary of the results obtained from the visual inspection of in-stream structures performed during Year 4 of post-construction monitoring is presented in Table B.1. The percentages noted are a general, overall field evaluation of the how the features were performing at the time of the photo point survey. According to the visual stability assessment, during Year 4 monitoring, some bank areas as described in Section 3.2.5 have experienced some localized erosion problems. Excluding these bank areas, all other stream features are performing as designed.

3.2.8 Quantitative Measures Summary Tables

The quantitative pre-construction, reference reach, and design data used to determine restoration approach, as well as the as-built baseline data used during the project's post construction monitoring period are summarized in Appendix B.

3.2.9 Benthic Macroinvertebrate Sampling

Benthic macroinvertebrate monitoring was conducted in accordance with the Crowns West Restoration Plan. Because of seasonal fluctuations in populations, macroinvertebrate sampling must be consistently conducted in the same season as the initial species evaluations. Benthic sampling for the Site as well as the reference site was conducted during March 2010. This report summarizes the benthic samples collected in March 2010 for Year 3 of the post-construction monitoring phase.

This is the final data collection event for benthic macroinvertebrates for the Site.

The sampling methodology followed the Qual 4 method listed in NCDWQ's Standard Operating Procedures for Benthic Macroinvertebrates (2006). Field sampling was conducted by Michael Baker Engineering, Inc. Laboratory identification of collected species was conducted by Wendell Pennington, of Pennington and Associates, Inc.

Benthic macroinvertebrate samples were collected at one location on the Site (Site 1) and one location at the Beaverdam Branch reference site in Jones County (Site 2). Site 1 is located within the restoration area of M1 on the Site.

Benthic macroinvertebrates were collected to assess quantity and quality of life in the streams. In particular, specimens belonging to the insect orders Ephemeroptera (mayflies), Plecoptera (stoneflies) and Trichoptera (caddisflies), (EPT species) are useful as an index of water quality. These groups are generally the least tolerant to water pollution and therefore are very useful indicators of water quality. Sampling for these three orders is referred to as EPT sampling.

Habitat assessments using NCDWQ's protocols were also conducted at each site. Physical and chemical measurements including water temperature, dissolved oxygen concentration (mg/L), pH, and specific conductivity were recorded at each site. The habitat assessment field data sheets, lab results and photos are presented in Appendix B.

3.2.10 Benthic Macroinvertebrate Sampling Results and Discussion

A comparison between the pre- and post-construction monitoring results is presented in Table 7 with complete laboratory results presented in Appendix B.

At Site 2, the undisturbed reference site, the Year 3 community structure and ecological habitat appears to be similar to that observed during the pre-construction, Year 1 and Year 2 monitoring periods. Site 2 data show a stable total taxa richness and a stable EPT taxa richness. EPT taxa richness at Site 2 has remained relatively stable since Year 1 monitoring. The Year 3 sampling results displayed relatively stable total and EPT biotic indices.

Site 1, which underwent complete restoration, exhibited improvements in total and EPT taxa richness since Year 1 monitoring. According to the lab results, Site 1 showed an improvement in the total biotic index following Year 3 of monitoring. The EPT biotic index following Year 3 has increased from no observed communities to an index 6.36 since March 2006. It is anticipated that, as the project matures, EPT populations will increase as more habitat in the form of snags, logs, and leaf packs become available.

The Year 3 data for the Site displayed 37.5 percent Dominance in Common (DIC) compared to the reference site. This indicates that 37.5 percent of the dominant

communities at the reference site are dominant at Site 1. In pre-construction conditions, Site 1 had a DIC of 41 percent. The DIC result of 37.5 percent at Site 1 following Year 3 monitoring, indicates that post-construction recolonization from refugia upstream or downstream, is likely returning to pre-restoration levels. It is anticipated that improvements in biotic indices and an increase in DIC will be seen in as communities begin to re-colonize and the project matures.

Overall, the Year 3 data for Site 1 has displayed substantial improvements in all criteria of the macro invertebrate samples. The Year 3 post-restoration data has shown that the Site has developed from a newly established coastal plain stream system with a weak benthic macroinvertebrate community into a system that exhibits diverse habitats, is continually maturing, and is able to support and cultivate biological diversity.

Table 7. Summary of Pre-Restoration vs. Post-Restoration Benthic Macroinvertebrate Sampling Data								
Crowns West Restoration Site: EEP Contract No. D06003-2								
	Site 1				Site 2			
	M1 Crowns West (Restoration)				Beaverdam Branch (Reference)			
	Pre	Post	Post	Post	Pre	Post	Post	Post
	3/3/2006	2/28/2008	2/9/2009	3/10/2010	1/5/2006	2/28/2008	2/9/2009	3/10/2010
Total Taxa Richness	24	14	20	19	28	35	34	31
EPT Taxa Richness	4	0	1	4	3	6	9	6
Total Biotic Index	6.75	3.99	7.50	6.80	7.78	6.73	6.59	6.40
EPT Biotic Index	5.78	None	4.00	6.36	4.05	5.28	4.69	6.19
Dominance in Common (%)	41	18	25	37.5	N/A	N/A	N/A	N/A
EPT Abundance	-	0	2	17	-	29	35	28
Habitat Assessment Rating	42	88	65	67	89	106	91	91
Water Temperature (°C)	Not Collected	10.5	8.6	9.4	Not Collected	7.9	8.9	14.3
DO Concentration (mg/l)	Not Collected	5.05	11.8	10.91	Not Collected	9	7.8	9.3
pH	Not Collected	6.63	6.98	5.96	Not Collected	7.24	7.52	6.6
Conductivity (µmhos/cm)	Not Collected	110	150	90	Not Collected	320	340	240

4.0 OVERALL CONCLUSIONS AND RECOMMENDATIONS

Stream Monitoring - The total length of stream channel restored on the Site was 3,835 LF. This entire length was inspected during Year 4 of the monitoring period (2010) to assess stream performance. Visual stability assessments during Years 2 and 3 noted several small, localized erosion areas. Those observed during Year 2 were repaired and those observed during Year 3 did not require repairs. During Year 4 monitoring, all of these areas appear to be stable.

Based on the survey data, all riffles, pools, and other constructed features along the restored channel are stable and functioning as designed. The on-site crest gauge documented the occurrence of at least two bankfull flow events during Year 4 of the post-construction monitoring period. The highest on-site stream flow documented by the crest gauge during Year 4 of monitoring was approximately 3.72 feet (44.64 inches) above the bankfull stage and was the result of overbank flooding of M2. Inspection of site conditions during visits revealed visual evidence of out-of-bank flows.

Overall, the Site is on track to achieve the stream morphology success criteria specified in the Restoration Plan for the Site.

Year 3 macroinvertebrate lab results for the Site, exhibited improvements in total and EPT taxa richness. The total biotic index improved since Year 2 while a decline in the EPT biotic index was observed during Year 3. It is anticipated that, as the project matures, benthic macroinvertebrate populations will increase as more habitat in the form of snags, logs, and leaf packs become available. The DIC result of 37.5 percent at Site 1 following Year 3 monitoring, indicates that post-construction recolonization from refugia upstream or downstream, is likely returning to pre-restoration levels.

Vegetation Monitoring - For the 11 monitoring plots, vegetation monitoring indicated a survivability range of 486 stems per acre to 972 stems per acre with an overall average of 659 stems per acre. The data show that the Site has met the minimum interim success criteria of 320 stems per acre by the end of Year 3 and is on track for meeting the final success criteria of 260 stems per acre by the end of Year 5.

During Year 4 monitoring, kudzu (*Pueraria spp.*) and privet (*Ligustrum L.*) were observed on the Site. These kudzu areas were treated in 2010 and are scheduled to be treated again during the 2011 growing season. The areas of privet were not treated during Year 4, but were previously treated in 2009 and are scheduled for treatment in 2011.

Overall, the site is on track to achieve the vegetative success criteria specified in the Restoration Plan for the Site.

5.0 WILDLIFE OBSERVATIONS

Observations of deer and raccoon tracks are common on the Site. During certain times of the year, frogs, snakes, lizards and crawfish and have been observed.

6.0 REFERENCES

Rosgen, D. L. 1994. *A Classification of Natural Rivers*. *Catena* 22: 169-199.

Schafale, M. P., and A. S. Weakley. 1990. *Classification of the Natural Communities of North Carolina, Third Approximation*. North Carolina Natural Heritage Program, Division of Parks and Recreation. NCDENR. Raleigh, NC.

USDA, NC Agricultural Experiment Station, *Soil Survey of Onslow County, North Carolina*, 1992.

NCDWQ, Standard Operating Procedures for Benthic Macroinvertebrates. (2006).

FIGURES

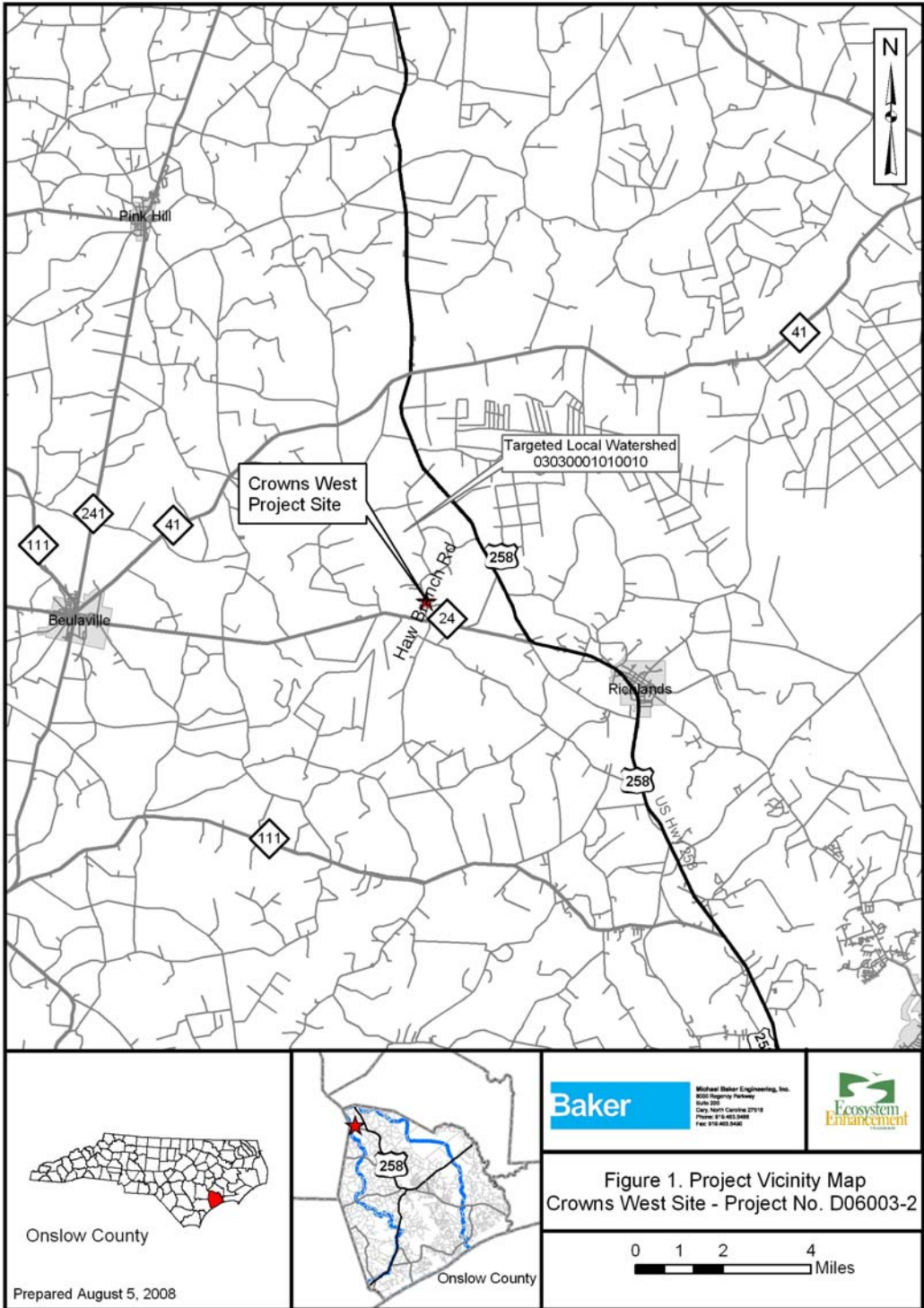

Figure 1. Location of Crowns West Stream Restoration Site.

PROJECT: D06003 - 2 CROWNS WEST

CROWNS WEST STREAM RESTORATION PROJECT
PROJECT # - D06003-2

ONSLOW COUNTY

LOCATION: OFF HAW BRANCH ROAD SR 1230
NORTHWEST OF RICHLANDS

TYPE OF WORK: AS-BUILT FOR STREAM RESTORATION

STATE	BUCK PROJECT REFERENCE NO.	SHEET NO.	TOTAL SHEETS
NC	0290R	1	13
NO.	DATE	CHECKED BY	APPROVED BY
1	04/09/07	JOSHUA WHITE	KEVIN TWEEDY
2	04/30/07	JOSHUA WHITE	KEVIN TWEEDY

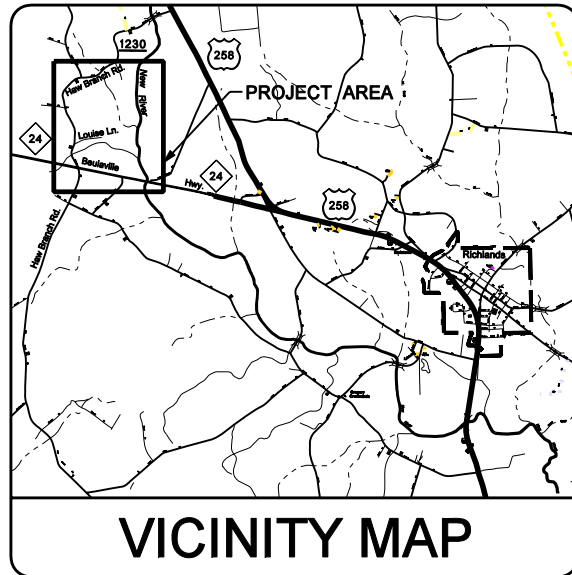

INDEX OF SHEETS

1	TITLE SHEET
1-A	STREAM CONVENTIONAL SYMBOLS GENERAL NOTES, STANDARD SPECIFICATIONS, AND VEGETATION SELECTION
1-B	CONVENTIONAL SYMBOLS
2 TO 2-C	TYPICAL POOL AND RIFFLE CROSS SECTIONS, STRUCTURE DETAILS
3 TO 8	AS-BUILT PLAN VIEWS

BEGIN CONSTRUCTION M1
 STA 10+00.00
 77.6368° W
 34.9254° N

END CONSTRUCTION M1
 STA 33+20.05

BEGIN CONSTRUCTION M2
 STA 33+83.41

END CONSTRUCTION M2
 STA 48+98.44
 77.6285° W
 34.9290° N

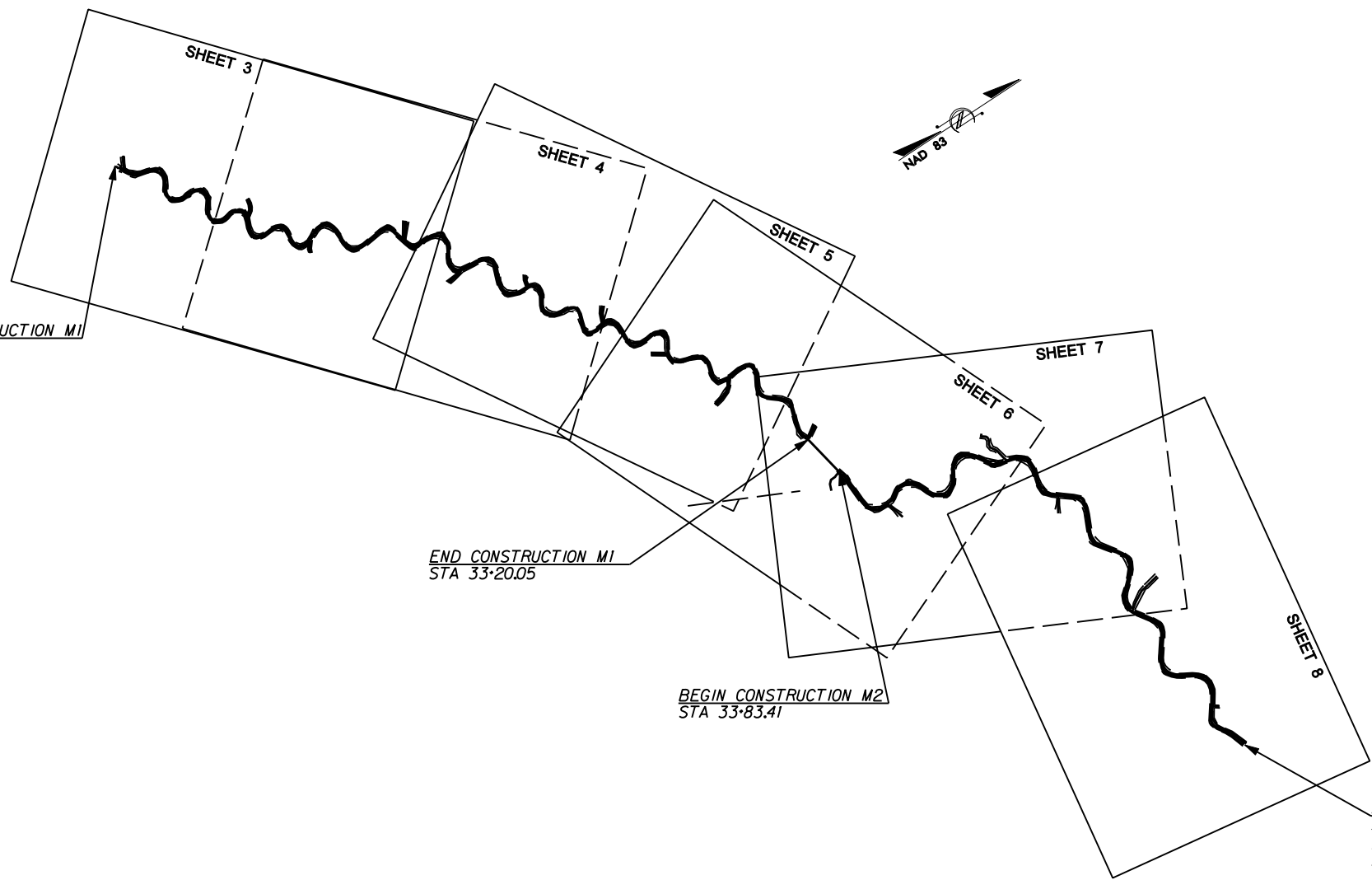
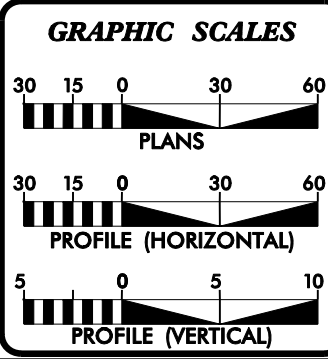

FIGURE 2A



DESIGN DATA

EXISTING STREAM LENGTH = 3334 FT
 AS-BUILT STREAM LENGTH = 3835 FT

PROJECT REACH	EXISTING	AS-BUILT
M1	1819 FT	2320 FT
M2	1515 FT	1515 FT

PREPARED FOR THE OFFICE OF:
 NCDENR - ECOSYSTEM ENHANCEMENT PROGRAM
 2728 CAPITAL BLVD, SUITE 1H 103
 RALEIGH, NC 27604

Ecosystem Enhancement PROGRAM

CONTACT: GUY PEARCE
 REP FULL DELIVERY COORDINATOR

PREPARED IN THE OFFICE OF:
Baker

MARCH 2007
 COMPLETION DATE:

KEVIN TWEEDY, PE
 PROJECT ENGINEER

JOSHUA WHITE
 PROJECT DESIGNER

PROJECT ENGINEER

THIS DOCUMENT
 ORIGINALLY ISSUED AND
 SEALED BY:
 KEVIN L. TWEEDY
 027337
 APRIL 30, 2007

THIS MEDIA SHALL NOT BE CONSIDERED
 A CERTIFIED DOCUMENT

SIGNATURE: _____ P.E.

THIS DOCUMENT
ORIGINALLY ISSUED AND
SEALED BY:



KEVIN L. TWEEDY
027337
APRIL 30, 2007

THIS MEDIA SHALL NOT BE CONSIDERED
A CERTIFIED DOCUMENT

Baker

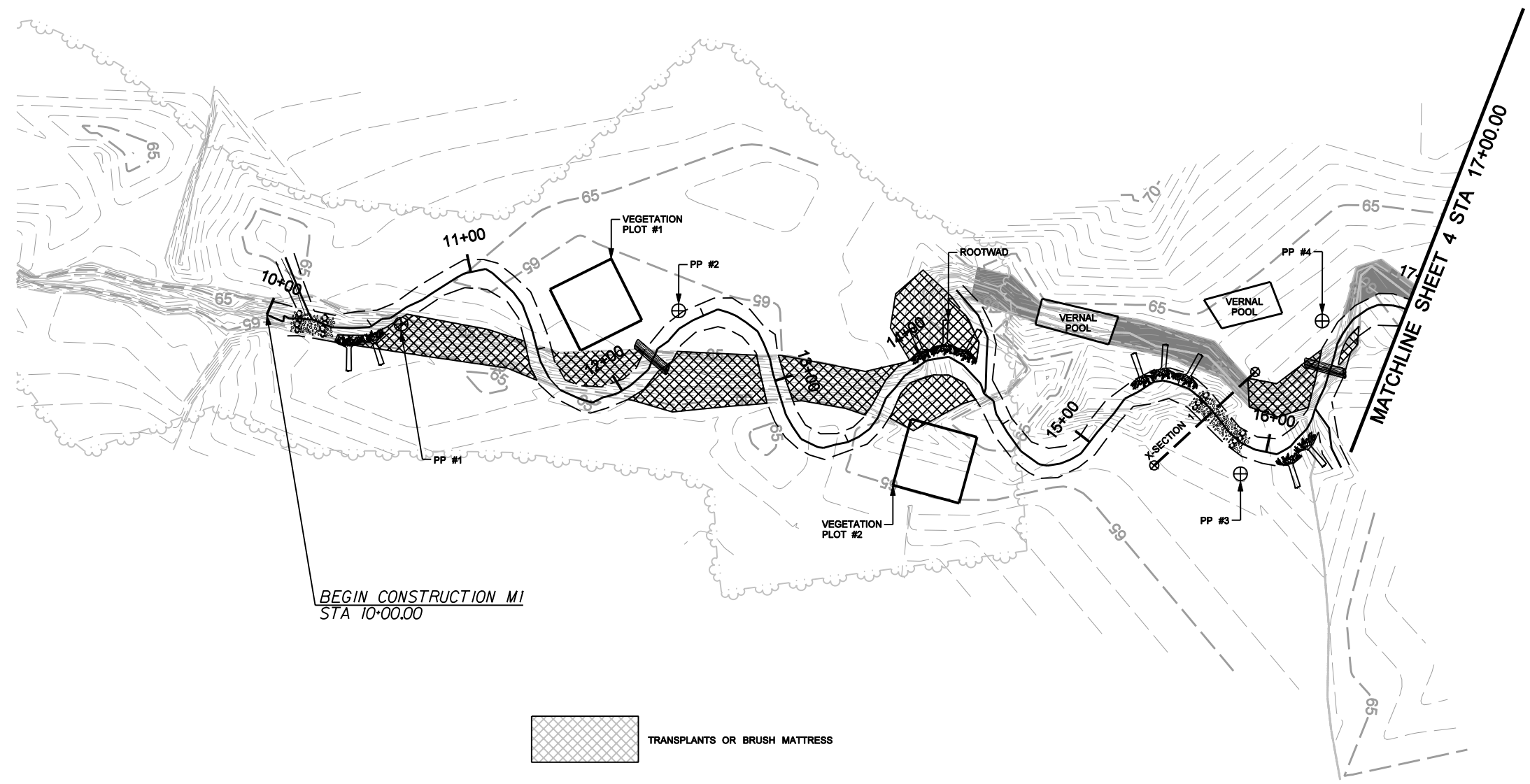
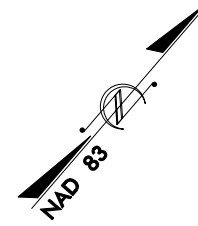
Baker Engineering
5000 Regency Parkway
Suite 200
Cary, NORTH CAROLINA 27518
Phone: 919.483.5488
Fax: 919.483.5490

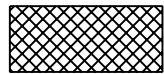

-  TRANSPLANTS OR BRUSH MATTRESS
-  DITCH PLUG
-  CHANNEL FILL

NOTE:
PRESERVED TREES WHERE POSSIBLE BETWEEN STATIONS 10+00 TO 33+86.

NOTE:
CONTOURS SHOWN ARE PRE-RESTORATION CONDITIONS.

FIGURE 2B

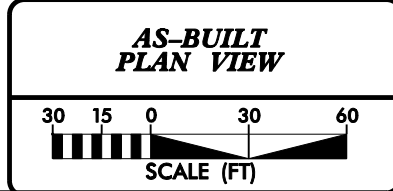

2/26/03

IV/27/2007
F:\0290R\design\as-built\0290R_Buck_ASB_04.dgn

PROJECT ENGINEER

THIS DOCUMENT
ORIGINALLY ISSUED AND
SEALED BY:

KEVIN L. TWEEDY
027337
APRIL 30, 2007

THIS MEDIA SHALL NOT BE CONSIDERED
A CERTIFIED DOCUMENT

Baker
Baker Engineering
6000 Regency Parkway
Suite 200
Cary, NORTH CAROLINA 27518
Phone: 919.463.5488
Fax: 919.463.5490



NOTE:
CONTOURS SHOWN ARE PRE-RESTORATION CONDITIONS.

**AS-BUILT
PLAN VIEW**

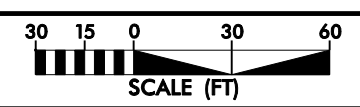
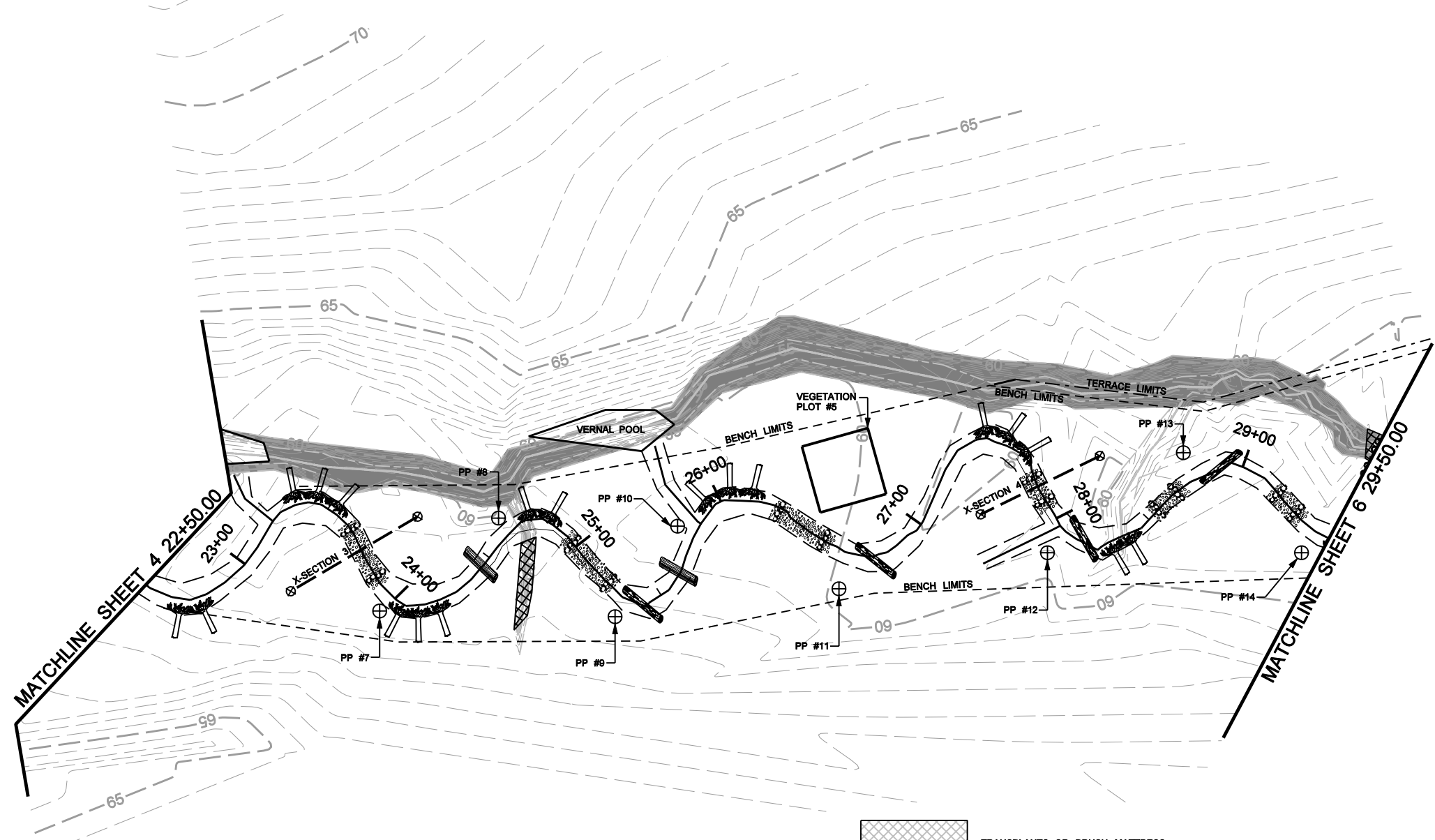
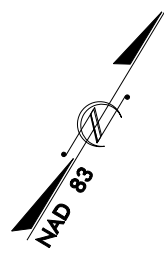





FIGURE 2C

IV/27/2007
 F:\0290R\design\as-built\0290R_Buck_ASB_05.dgn



-  TRANSPLANTS OR BRUSH MATTRESS
-  DITCH PLUG
-  CHANNEL FILL

NOTE:
PRESERVED TREES WHERE POSSIBLE BETWEEN STATIONS 10+00 TO 33+66.

NOTE:
CONTOURS SHOWN ARE PRE-RESTORATION CONDITIONS.

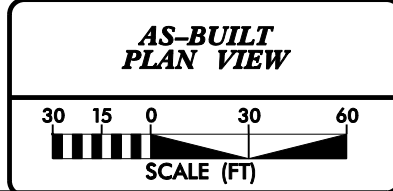
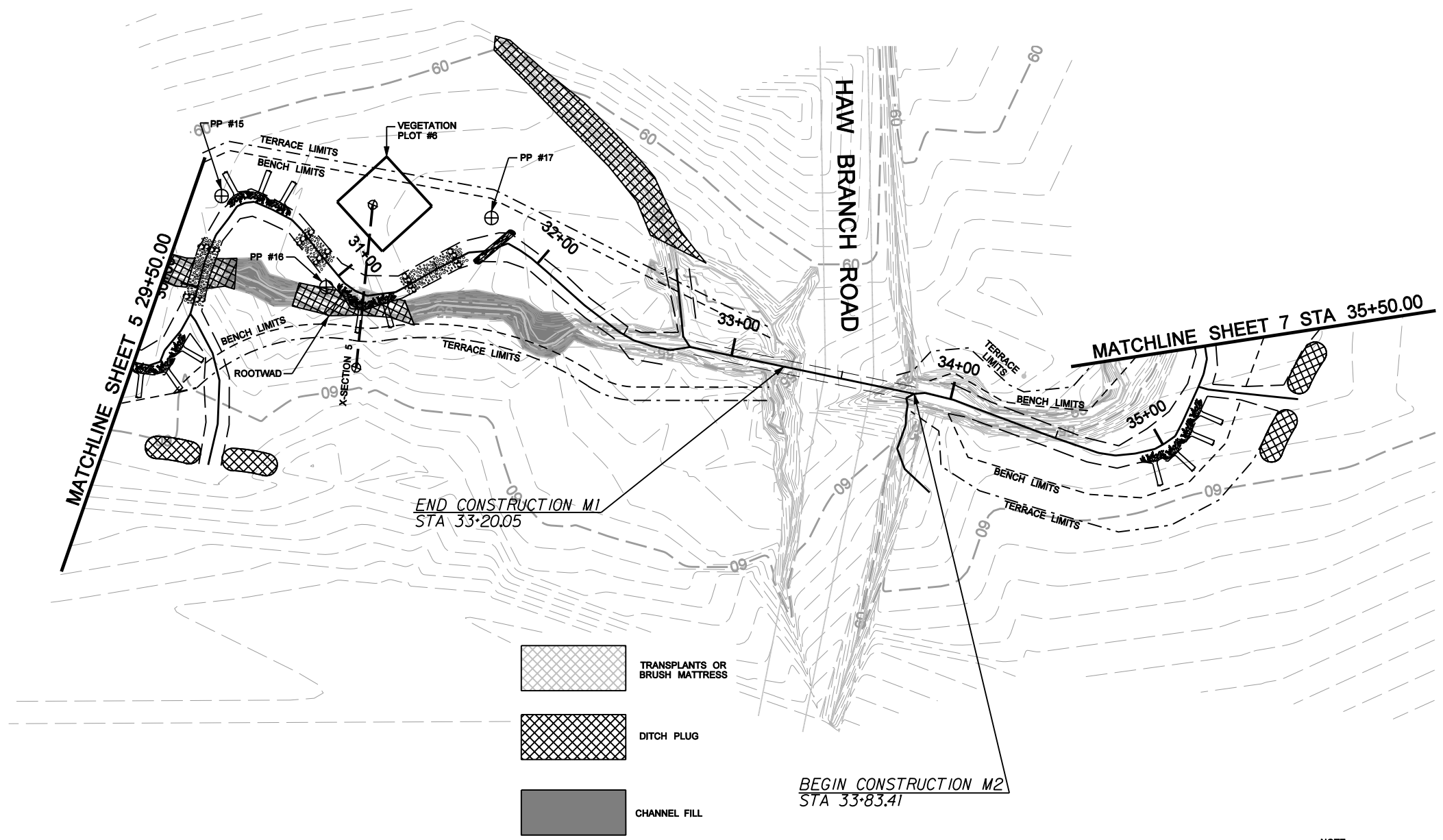
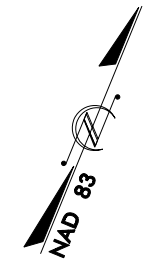

FIGURE 2D

2/26/03

 11/27/2007
 F:\0290R\design\as-built\0290R_Buck_ASB_06.dgn



NOTE:
PRESERVED TREES WHERE POSSIBLE BETWEEN STATIONS 10+00 TO 33+66.

NOTE:
CONTOURS SHOWN ARE PRE-RESTORATION CONDITIONS.

FIGURE 2E

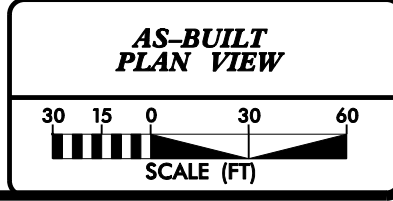

2/26/03
 11/27/2007
 F:\0290R\design\as-built\0290R_Buck_ASB_07.dgn

THIS DOCUMENT
ORIGINALLY ISSUED AND
SEALED BY:

KEVIN L. TWEEDY
027337
APRIL 30, 2007

THIS MEDIA SHALL NOT BE CONSIDERED
A CERTIFIED DOCUMENT

Baker

Baker Engineering
6000 Regency Parkway
Suite 200
Cary, NORTH CAROLINA 27518
Phone: 919.463.5488
Fax: 919.463.5490

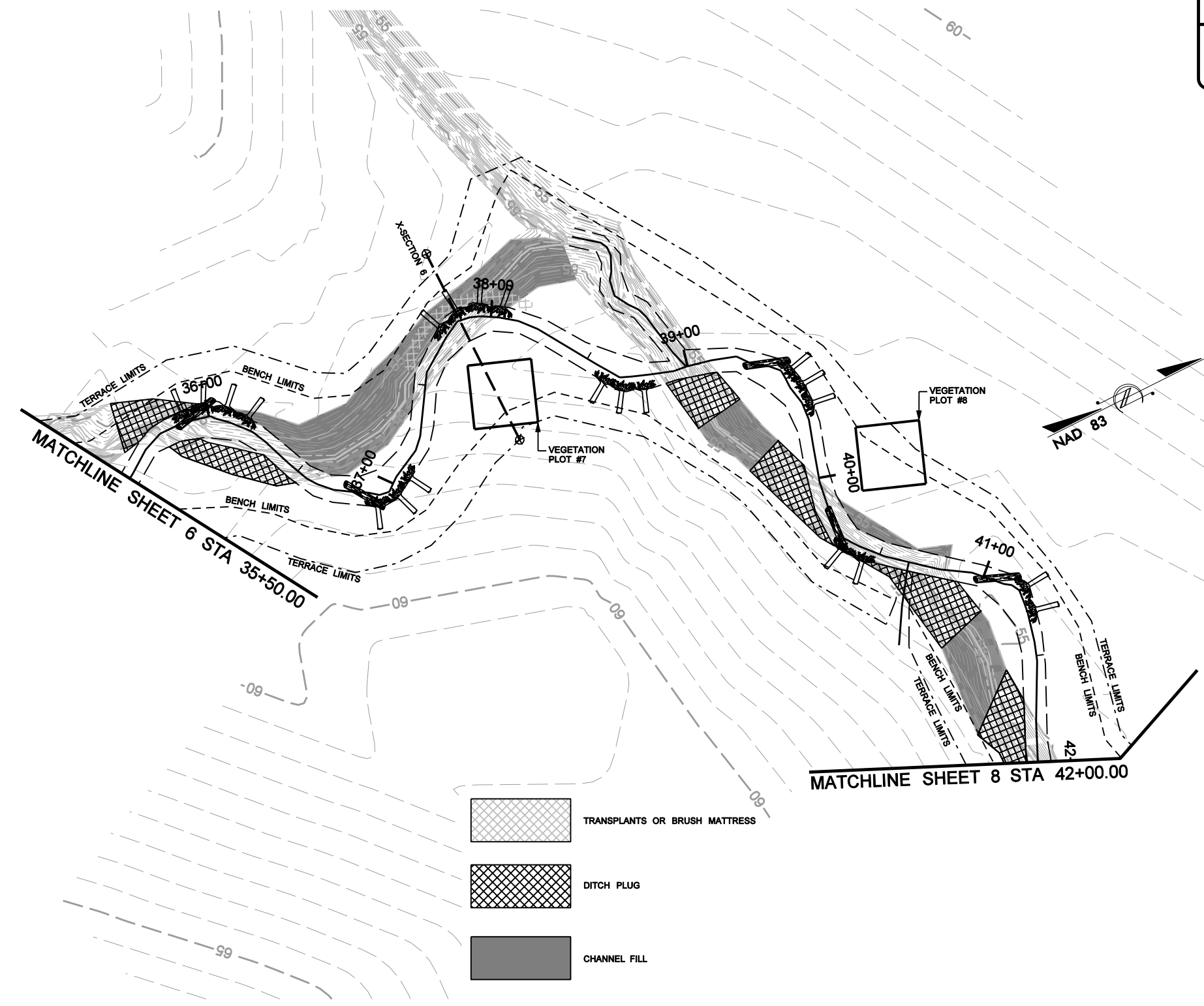

NOTE:
CONTOURS SHOWN ARE PRE-RESTORATION CONDITIONS.

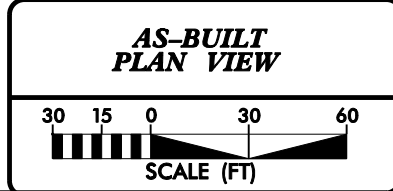

FIGURE 2F

2/26/03
11/27/2007
F:\0290R\design\as-built\0290R_Buck_ASB_08.dgn

THIS DOCUMENT
ORIGINALLY ISSUED AND
SEALED BY:



KEVIN L. TWEEDY
027337
APRIL 30, 2007

THIS MEDIA SHALL NOT BE CONSIDERED
A CERTIFIED DOCUMENT

Baker

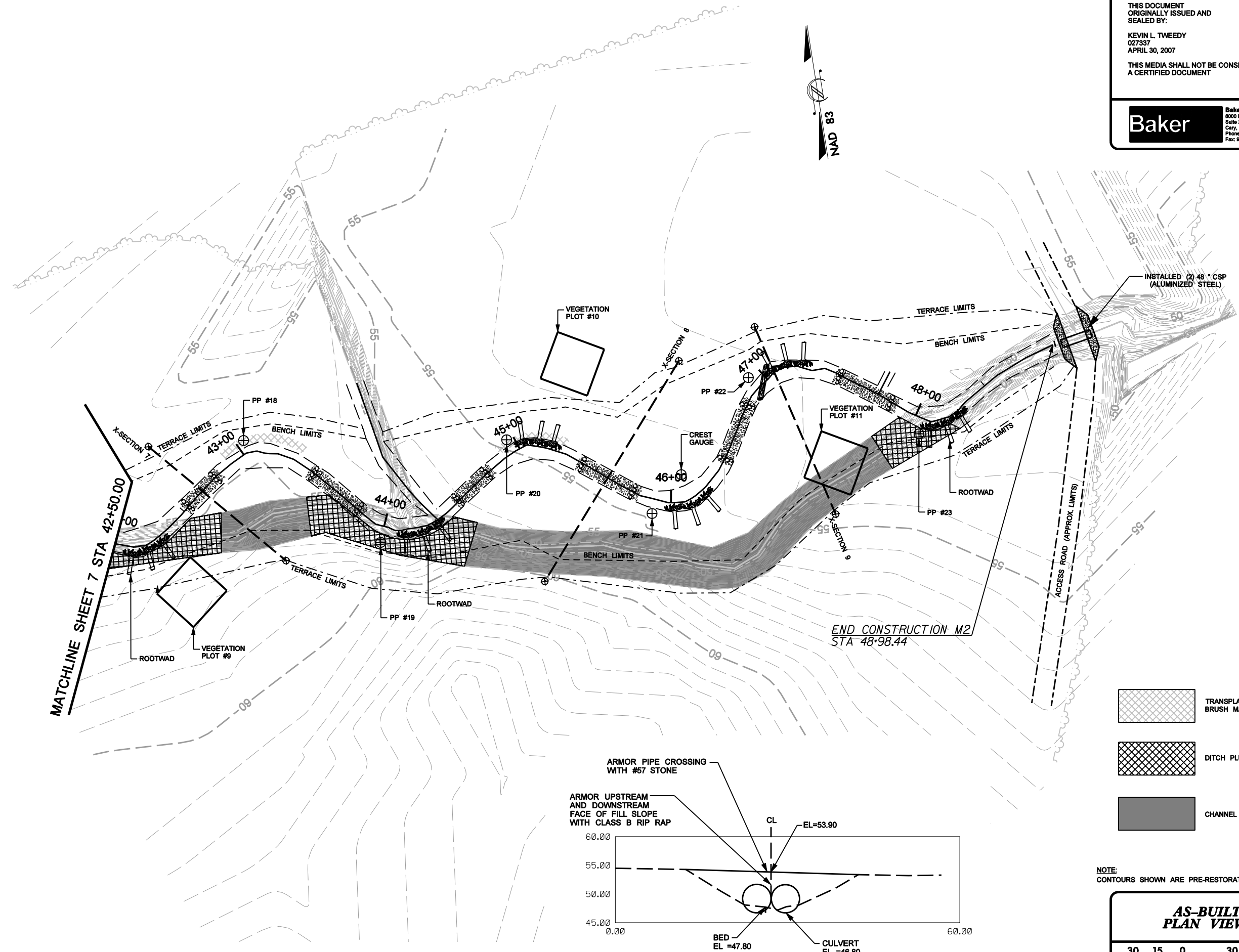
Baker Engineering
8000 Regency Parkway
Suite 220
Cary, NORTH CAROLINA 27518
Phone: 919.493.5488
Fax: 919.493.5490



-  TRANSPLANTS OR BRUSH MATTRESS
-  DITCH PLUG
-  CHANNEL FILL

NOTE:
CONTOURS SHOWN ARE PRE-RESTORATION CONDITIONS.

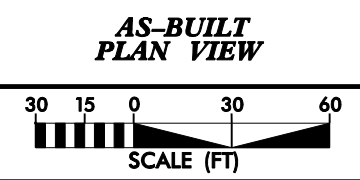
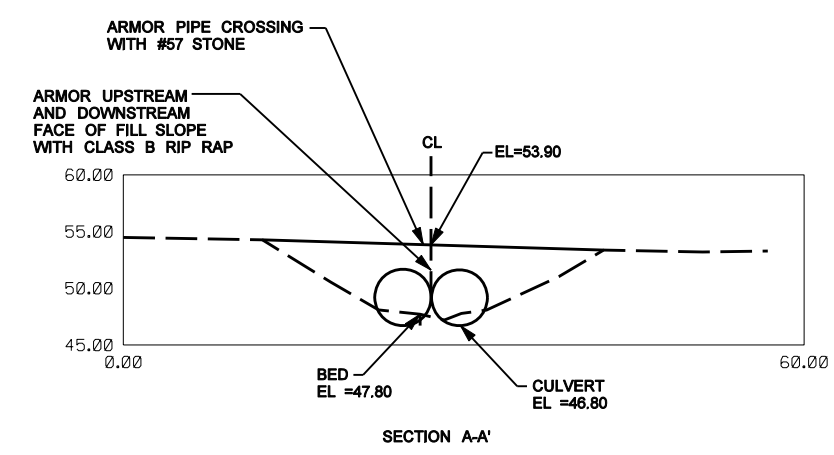

FIGURE 2G

2/26/03
11/27/2007
F:\0290R\design\as-built\0290R_Buck_ASB_09.dgn

APPENDIX A

VEGETATION RAW DATA

VEGETATION TABLES

Table A.1. Vegetation Metadata

Crowns West Restoration Site: Project No. D06003-2	
Report Prepared By	Dwayne Huneycutt
Date Prepared	9/23/2010 15:03
database name	cvs-eep-entrytool-v2.2.7_2009.mdb
database location	L:\Monitoring\Veg Plot Info\CVS Data Tool\Crowns West\Year 4
computer name	CARYWDHUNEYCU2
file size	36347904
DESCRIPTION OF WORKSHEETS IN THIS DOCUMENT-----	
Metadata	Description of database file, the report worksheets, and a summary of project(s) and project data.
Proj, planted	Each project is listed with its PLANTED stems per acre, for each year. This excludes live stakes.
Proj, total stems	Each project is listed with its TOTAL stems per acre, for each year. This includes live stakes, all planted stems, and all natural/volunteer stems.
Plots	List of plots surveyed with location and summary data (live stems, dead stems, missing, etc.).
Vigor	Frequency distribution of vigor classes for stems for all plots.
Vigor by Spp	Frequency distribution of vigor classes listed by species.
Damage	List of most frequent damage classes with number of occurrences and percent of total stems impacted by each.
Damage by Spp	Damage values tallied by type for each species.
Damage by Plot	Damage values tallied by type for each plot.
Planted Stems by Plot and Spp	A matrix of the count of PLANTED living stems of each species for each plot; dead and missing stems are excluded.
PROJECT SUMMARY-----	
Project Code	D060032
project Name	Crowns West
Description	Stream Restoration Project
River Basin	White Oak
length(ft)	3835
stream-to-edge width (ft)	50
area (sq m)	35624.71
Required Plots (calculated)	10
Sampled Plots	0

Table A.2. Vegetation Vigor by Species

Crowns West Restoration Site: Project No. D06003-2									
Species	Common Name	Excellent	Good	Fair	Unlikely to Survive Year	Dead	Missing		
<i>Betula nigra</i>	river birch	11	2				1		
<i>Celtis laevigata</i>	sugarberry		3			1			
<i>Fraxinus pennsylvanica</i>	green ash	8	7	2	1	3			
<i>Juglans nigra</i>	black walnut	1	1	1		3			
<i>Nyssa biflora</i>	swamp tupelo	2	12	12					
<i>Quercus lyrata</i>	overcup oak	13	5	1				1	
<i>Quercus michauxii</i>	swamp chestnut oak	5	5	1		1			
<i>Quercus nigra</i>	water oak	1							
<i>Quercus phellos</i>	willow oak	8	2	3					
<i>Taxodium distichum</i>	bald cypress	12	6	4					
<i>Platanus occidentalis</i>	American sycamore	24	14	11		1		1	
TOT:		11	11	85	57	35	2	9	2

Table A.3. Vegetation Damage by Species

Crowns West Restoration Site: Project No. D06003-2									
Species	Common Name	Count of Damage Categories							
		No Damage	Beaver	Insects	Unknown	Vine Strangulation			
<i>Betula nigra</i>	river birch	2	12			1	1		
<i>Celtis laevigata</i>	sugarberry	0	4						
<i>Fraxinus pennsylvanica</i>	green ash	1	20				1		
<i>Juglans nigra</i>	black walnut	1	5				1		
<i>Nyssa biflora</i>	swamp tupelo	1	25					1	
<i>Platanus occidentalis</i>	American sycamore	4	47	1			3		
<i>Quercus lyrata</i>	overcup oak	1	19				1		
<i>Quercus michauxii</i>	swamp chestnut oak	0	12						
<i>Quercus nigra</i>	water oak	0	1						
<i>Quercus phellos</i>	willow oak	0	13						
<i>Taxodium distichum</i>	bald cypress	0	22						
TOT:		11	11	10	180	1	1	7	1

Table A.4. Vegetation Damage by Plot

Crowns West Restoration Site: Project No. D06003-2							
Plot	Count of Damage Categories	No Damage	Beaver	Insects	Unknown	Vine Strangulation	
D060032-DH-0001-year:4	2	11	1				1
D060032-DH-0002-year:4	0	17					
D060032-DH-0003-year:4	0	14					
D060032-DH-0004-year:4	1	14			1		
D060032-DH-0005-year:4	0	18					
D060032-DH-0006-year:4	0	17					
D060032-DH-0007-year:4	0	15					
D060032-DH-0008-year:4	0	22					
D060032-DH-0009-year:4	6	11			6		
D060032-DH-0010-year:4	0	24					
D060032-DH-0011-year:4	1	17		1			
TOT:	11	180	1	1	7	1	

Table A.5. Stem Count by Plot and Species

Crowns West Restoration Site: Project No. D06003-2																
Species	Common Name	Total Planted Stems	# Plots	Average # Stems	Plot D060032-DH-0001-year:4	Plot D060032-DH-0002-year:4	Plot D060032-DH-0003-year:4	Plot D060032-DH-0004-year:4	Plot D060032-DH-0005-year:4	Plot D060032-DH-0006-year:4	Plot D060032-DH-0007-year:4	Plot D060032-DH-0008-year:4	Plot D060032-DH-0009-year:4	Plot D060032-DH-0010-year:4	Plot D060032-DH-0011-year:4	
<i>Betula nigra</i>	river birch	13	7	1.86	2	1		1	4	1			3			1
<i>Celtis laevigata</i>	sugarberry	4	3	1.33				2			1	1				
<i>Fraxinus pennsylvanica</i>	green ash	18	6	3			2	3			6	1		2		4
<i>Juglans nigra</i>	black walnut	3	2	1.5							1					2
<i>Nyssa biflora</i>	swamp tupelo	26	9	2.89	1	3	2	3	3	1		4		4		5
<i>Platanus occidentalis</i>	American sycamore	49	11	4.45	5	9	7	3	1	6	1	6	4	6		1
<i>Quercus lyrata</i>	overcup oak	19	6	3.17	1	1				5	3		4	5		
<i>Quercus michauxii</i>	swamp chestnut oak	11	7	1.57				2		2	2	1	1	2		1
<i>Quercus nigra</i>	water oak	1	1	1												1
<i>Quercus phellos</i>	willow oak	13	5	2.6	3		2				1	2		5		
<i>Taxodium distichum</i>	bald cypress	22	6	3.67		3	1		10	1	1	6				
TOT:	11	179	11		12	17	14	14	18	16	14	22	13	24	15	

Table A.6. Stem Count for Each Species Arranged by Plot

Crowns West Restoration Site: Project No. D06003-2													
Tree Species	Plots											Year 4 Totals	Average Stems/acre
	1	2	3	4	5	6	7	8	9	10	11		
<i>Betula nigra</i>	2	1		1	4	1			3		1	13	N/A
<i>Celtis laevigata</i>				2				1	1			4	
<i>Fraxinus pennsylvanica</i>			2	3			6	1		2	4	18	
<i>Juglans nigra</i>								1			2	3	
<i>Nyssa biflora</i>	1	3	2	3	3	1		4		4	5	26	
<i>Platanus occidentalis</i>	5	9	7	3	1	6	1	6	4	6	1	49	
<i>Quercus lyrata</i>	1	1				5	3		4	5		19	
<i>Quercus michauxii</i>				2		2	2	1	1	2	1	11	
<i>Quercus nigra</i>											1	1	
<i>Quercus phellos</i>	3		2				1	2		5		13	
<i>Taxodium distichum</i>		3	1		10	1	1	6				22	
Stems/plot Year 4	12	17	14	14	18	16	14	22	13	24	15	179	
Stems/acre Year 4	486	688	567	567	729	648	567	891	526	972	607	N/A	659
Stems/acre Year 3	486	688	567	567	729	688	607	891	648	972	607		677
Stems/acre Year 2	567	688	567	567	809	769	647	891	688	972	809		725
Stems/acre Initial	729	729	607	648	972	760	640	1053	850	1093	931		819

VEGETATION PHOTOS



Vegetation Plot 1



Herbaceous Vegetation Plot 1



Vegetation Plot 2



Herbaceous Vegetation Plot 2



Vegetation Plot 3



Herbaceous Vegetation Plot 3



Vegetation Plot 4



Herbaceous Vegetation Plot 4



Vegetation Plot 5



Herbaceous Vegetation Plot 5



Vegetation Plot 6



Herbaceous Vegetation Plot 6



Vegetation Plot 7



Herbaceous Vegetation Plot 7



Vegetation Plot 8



Herbaceous Vegetation Plot 8



Vegetation Plot 9



Herbaceous Vegetation Plot 9



Vegetation Plot 10



Herbaceous Vegetation Plot 10



Vegetation Plot 11



Herbaceous Vegetation Plot 11

APPENDIX B

GEOMORPHIC RAW DATA

STREAM TABLES

Table B.1. Categorical Stream Feature Visual Stability Assessment

Crowns Wet Restoration Site: Project No. D06003-2						
	Performance Percentage					
Feature	Initial	MY-01	MY-02	MY-03	MY-04	MY-05
A. Riffles	100%	100%	95%	95%	95%	
B. Pools	100%	100%	90%	90%	90%	
C. Thalweg	100%	100%	100%	100%	100%	
D. Meanders	100%	100%	100%	100%	100%	
E. Bed General	100%	100%	100%	100%	100%	
F. Bank Condition	100%	100%	95%	95%	95%	
G. Wads	100%	100%	75%	90%	90%	

Table B.2. Baseline Stream Summary

Crowns West Restoration Site: Project No. D06003-2

Crowns West - Reach M1

Parameter	USGS Gauge		Regional Curve Interval			Pre-Existing Condition			Reference Reach(es) Data			Design			As-built		
	LL	UL	Eq.	Min	Mean	Max	Min	Mean	Max	Min	Med	Max	Min	Mean	Max		
Dimension - Riffle	-----	-----	-----	-----	-----	-----	-----	-----	-----	-----	-----	-----	-----	-----	-----	-----	-----
BF Width (ft)	-----	-----	-----	5.6	5.9	6.2	-----	-----	-----	9	9.0	9.0	8.8	10.1	11.3		
Floodprone Width (ft)	-----	-----	-----	8.0	10.5	13.0	-----	-----	-----	70.0	90.0	110.0	58.2	61	64.6		
BF Mean Depth (ft)	-----	-----	-----	1.4	1.6	1.7	-----	-----	-----	0.9	0.9	0.9	0.72	0.73	0.74		
BF Max Depth (ft)	-----	-----	-----	1.70	2.0	2.20	1.5	1.6	1.7	1.1	1.2	1.2	1.2	1.2	1.3		
BF Cross Sectional Area (ft ²)	-----	-----	-----	8.4	9.0	9.5	24	24.0	24	8.0	8.0	8.0	6.3	8.4	7.4		
Width/Depth Ratio	-----	-----	-----	3.4	3.9	4.3	11.0	14.0	17.0	-----	10.0	-----	12.2	13.9	15.3		
Entrenchment Ratio	-----	-----	-----	1.3	1.8	2.2	10.0	10.5	11.0	7.0	9.0	11.0	5.3	6.1	6.6		
Bank Height Ratio	-----	-----	-----	2.7	2.8	2.9	1.0	1.2	1.3	1.0	1.1	1.2	1.0	1.0	1.0		
BF Velocity (fps)	-----	-----	-----	-----	-----	-----	1.5	1.5	1.5	2.2	-----	2.2	-----	-----	-----		
Pattern	-----	-----	-----	-----	-----	-----	-----	-----	-----	-----	-----	-----	-----	-----	-----	-----	-----
Channel Beltwidth (ft)	-----	-----	-----	-----	-----	-----	-----	-----	-----	45	58.5	72	-----	-----	-----		
Radius of Curvature (ft)	-----	-----	-----	-----	-----	-----	-----	-----	-----	18	27	36	-----	-----	-----		
Meander Wavelength (ft)	-----	-----	-----	-----	-----	-----	-----	-----	-----	-----	-----	-----	-----	-----	-----		
Meander Width Ratio	-----	-----	-----	-----	-----	-----	-----	-----	-----	5	6.5	8	-----	-----	-----		
Profile	-----	-----	-----	-----	-----	-----	-----	-----	-----	-----	-----	-----	-----	-----	-----	-----	-----
Riffle Length (ft)	-----	-----	-----	-----	-----	-----	-----	-----	-----	-----	-----	-----	-----	-----	-----		
Riffle Slope (ft/ft)	-----	-----	-----	-----	-----	-----	-----	-----	-----	-----	-----	-----	-----	-----	-----		
Pool Length (ft)	-----	-----	-----	-----	-----	-----	-----	-----	-----	-----	-----	-----	-----	-----	-----		
Pool Spacing (ft)	-----	-----	-----	-----	-----	-----	2.5	-----	3.4	23	34	45	-----	-----	-----		
Substrate and Transport Parameters	-----	-----	-----	-----	-----	-----	-----	-----	-----	-----	-----	-----	-----	-----	-----	-----	-----
d16 / d35 / d50 / d84 / d95	-----	-----	-----	.2/.29/.36/.68/.94			.3/.4/.5/.9/1.2			-----	-----	-----	-----	-----	-----		
Reach Shear Stress (competency) lb/ft ²	-----	-----	-----	-----	-----	-----	-----	-----	-----	-----	-----	-----	-----	-----	-----		
Stream Power (transport capacity) W/m ²	-----	-----	-----	-----	-----	-----	-----	-----	-----	-----	-----	-----	-----	-----	-----		
Additional Reach Parameters	-----	-----	-----	-----	-----	-----	-----	-----	-----	-----	-----	-----	-----	-----	-----	-----	-----
Channel length (ft)	-----	-----	-----	-----	1,938	-----	-----	-----	-----	-----	2,372	-----	-----	2,275	-----		
Drainage Area (SM)	-----	-----	-----	-----	0.7	-----	3	-----	3	-----	0.7	-----	-----	0.7	-----		
Rosgen Classification	-----	-----	-----	-----	G5/E5	-----	C5c	-----	C5c	-----	E5	-----	-----	C5	-----		
BF Discharge (cfs)	-----	-----	-----	-----	-----	-----	37	-----	37	-----	17.3	-----	-----	-----	-----		
Sinuosity	-----	-----	-----	-----	1.27	-----	-----	-----	1.66	-----	1.4	-----	-----	1.4	-----		
BF slope (ft/ft)	-----	-----	-----	-----	0.004	-----	-----	-----	0.0004	-----	0.0030	-----	-----	0.004	-----		

Crowns West - Reach M2

Parameter	USGS Gauge		Regional Curve Interval			Pre-Existing Condition			Reference Reach(es) Data			Design			As-built		
	LL	UL	Eq.	Min	Mean	Max	Min	Mean	Max	Min	Mean	Max	Min	Mean	Max		
Dimension - Riffle	----	----	LL	UL	Eq.	Min	Mean	Max	Min	Mean	Max	Min	Mean	Max	Min	Mean	Max
BF Width (ft)	----	----	----	----	----	5.8	----	12.0	----	----	----	----	10	----	8.77	10.13	11.52
Floodprone Width (ft)	----	----	----	----	----	17.0	----	37.0	----	----	----	60.0	70.0	80.0	58.2	78.4	133.1
BF Mean Depth (ft)	----	----	----	----	----	1.4	----	1.8	----	----	----	1.0	1.0	1.0	0.71	0.84	1.12
BF Max Depth (ft)	----	----	----	----	----	2.5	----	3.0	1.5	----	1.7	1.2	1.3	1.3	1.19	1.41	1.80
BF Cross Sectional Area (ft²)	----	----	----	----	----	9.7	----	16.8	24	24	24	10.0	10	10.0	6.3	8.5	10.6
Width/Depth Ratio	----	----	----	----	----	3.4	----	8.6	11.0	----	17.0	----	10.0	----	8.5	12.4	15.8
Entrenchment Ratio	----	----	----	----	----	1.5	----	6.4	10.0	----	11.0	6.0	7.0	8.0	5.2	7.9	14.1
Bank Height Ratio	----	----	----	----	----	1.9	----	2.3	1.0	----	1.3	1.0	1.1	1.2	1.0	1.0	1.0
BF Velocity (fps)	----	----	----	----	----	----	----	----	1.5	----	1.5	1.6	----	1.6	----	----	----
Pattern																	
Channel Beltwidth (ft)	----	----	----	----	----	----	----	----	----	----	----	50	65	80	----	----	----
Radius of Curvature (ft)	----	----	----	----	----	----	----	----	----	----	----	20	30	40	----	----	----
Meander Wavelength (ft)	----	----	----	----	----	----	----	----	----	----	----	----	----	----	----	----	----
Meander Width Ratio	----	----	----	----	----	----	----	----	----	----	----	5	6.5	8	----	----	----
Profile																	
Riffle Length (ft)	----	----	----	----	----	----	----	----	----	----	----	----	----	----	----	----	----
Riffle Slope (ft/ft)	----	----	----	----	----	----	----	----	----	----	----	----	----	----	----	----	----
Pool Length (ft)	----	----	----	----	----	----	----	----	----	----	----	----	----	----	----	----	----
Pool Spacing (ft)	----	----	----	----	----	----	----	----	2.5	----	3.4	25	38	50	----	----	----
Substrate and Transport Parameters																	
d16 / d35 / d50 / d84 / d95	----	----	----	----	----	.2/.29/.36/.68/.94			.3/.4/.5/.9/1.2			----	----	----	----	----	----
Reach Shear Stress (competency) lb/ft²	----	----	----	----	----	----	----	----	----	----	----	----	----	----	----	----	----
Stream Power (transport capacity) W/m²	----	----	----	----	----	----	----	----	----	----	----	----	----	----	----	----	----
Additional Reach Parameters																	
Channel length (ft)	----	----	----	----	----	1396	----	----	----	----	----	1528	----	----	1560	----	----
Drainage Area (SM)	----	----	----	----	----	1	----	----	3	----	3	1	----	----	1	----	----
Rosgen Classification	----	----	----	----	----	G5/E5	----	----	C5c	----	C5c	E5	----	----	C5	----	----
BF Discharge (cfs)	----	----	----	----	----	----	----	----	37	37	37	16.2	----	----	----	----	----
Sinuosity	----	----	----	----	----	1.27	----	----	1.66	----	1.66	1.4	----	----	1.38	----	----
BF slope (ft/ft)	----	----	----	----	----	0.004	----	----	0.0004	----	0.0004	0.003	----	----	0.004	----	----

Table B.3. Morphology and Hydraulic Monitoring Summary

Crowns West Restoration Site: Project No. D06003-2																				
Reach: M1 (2320 feet)																				
Parameter	Cross-section 1 Riffle					Cross-section 2 Pool					Cross-section 3 Riffle					Cross-section 4 Riffle				
	MY1	MY2	MY3	MY4	MY5	MY1	MY2	MY3	MY4	MY5	MY1	MY2	MY3	MY4	MY5	MY1	MY2	MY3	MY4	MY5
Dimension																				
BF Width (ft)	11.52	9.79	12.79	9.83		12.38	10.43	10.09	10.44		10.32	10.38	14.61	10.80		8.77	8.76	9.62	9.08	
BF Mean Depth (ft)	0.73	0.61	0.46	0.60		1.89	1.57	1.61	1.98		0.71	0.61	0.50	0.62		0.72	0.58	0.66	0.67	
Width/Depth Ratio	15.78	16.05	27.97	16.32		6.54	6.64	6.27	5.26		14.48	16.99	29.05	17.43		12.18	15.10	14.51	13.62	
BF Cross-sectional Area (ft²)	8.41	6.00	5.80	5.90		23.46	16.40	16.20	20.70		7.35	6.30	7.30	6.70		6.31	5.10	6.40	6.10	
BF Max Depth (ft)	1.25	0.97	0.91	1.04		3.05	2.75	2.77	3.00		1.27	1.10	1.15	1.24		1.19	0.92	0.66	1.07	
Width of Floodprone Area (ft)	60.21	60.18	60.18	60.16		69.89	69.89	69.87	64.62		64.57	64.50	64.56	64.64		58.30	58.18	58.20	58.26	
Entrenchment Ratio	5.2	6.1	4.7	6.1		5.6	6.7	6.9	6.2		6.3	5.3	4.4	6.0		6.6	6.6	6.0	6.4	
Bank Height Ratio	1.0	1.0	1.0	1.0		1.2	1.2	1.2	1.1		1.0	1.1	1.0	1.1		1.0	1.1	1.0	1.1	
Wetted Perimeter (ft)	12.98	11.01	13.71	11.03		16.16	13.57	13.31	14.4		11.74	11.6	15.61	12.04		10.21	9.92	10.94	10.42	
Hydraulic Radius (ft)	32.29	32.71	56.4	33.24		14.97	14.85	14.15	12.5		29.67	34.59	58.6	35.48		25.08	30.78	29.68	27.91	
Substrate																				
d50 (mm)																				
d84 (mm)																				
Parameter	Cross-section 5 Pool																			
	MY1	MY2	MY3	MY4	MY5															
Dimension																				
BF Width (ft)	12.83	11.19	14.69	11.61																
BF Mean Depth (ft)	1.15	1.33	1.28	1.55																
Width/Depth Ratio	11.2	8.4	11.4	7.5																
BF Cross-sectional Area (ft²)	14.7	14.9	18.9	18.0																
BF Max Depth (ft)	2.63	2.69	2.91	3.11																
Width of Floodprone Area (ft)	62.48	68.39	67.83	70.67																
Entrenchment Ratio	5.1	6.1	4.6	5.6																
Bank Height Ratio	1.0	1.1	1.0	1.0																
Wetted Perimeter (ft)	15.13	13.85	17.25	14.71																
Hydraulic Radius (ft)	23.53	18.17	24.14	16.51																
Substrate																				
d50 (mm)																				
d84 (mm)																				

Parameter	MY-1 (2007)			MY-2 (2008)			MY-3 (2009)			MY-4 (2010)			MY-5 (2011)							
	Min	Max	Med	Min	Max	Med	Min	Max	Med	Min	Max	Med	Min	Max	Med					
Pattern																				
Channel Beltwidth (ft)																				
Radius of Curvature (ft)																				
Meander Wavelength (ft)																				
Meander Width Ratio																				
Profile																				
Riffle length (ft)																				
Riffle Slope (ft/ft)																				
Pool Length (ft)																				
Pool Spacing (ft)																				
Additional Reach Parameters																				
Valley Length (ft)			2833.1			2833.1			2833.1			2833.1			2833.1					
Channel Length (ft)			3907.59			3907.59			3907.59			3907.59			3907.59					
Sinuosity			1.38			1.38			1.38			1.38			1.38					
Water Surface Slope (ft/ft)			0.0041			0.0041			0.0041			0.0041			0.0041					
BF Slope (ft/ft)			0.0057			0.0057			0.0057			0.0057			0.0057					
Rosgen Classification			C			C			C			C			C					
Reach: M2 (1515 feet)																				
Parameter	Cross-section 6					Cross-section 7					Cross-section 8					Cross-section 9				
	Pool					Riffle					Riffle					Pool				
	MY1	MY2	MY3	MY4	MY5	MY1	MY2	MY3	MY4	MY5	MY1	MY2	MY3	MY4	MY5	MY1	MY2	MY3	MY4	MY5
Dimension																				
BF Width (ft)	14.00	13.13	13.68	13.42		10.60	9.12	11.69	11.01		9.46	9.24	8.69	8.93		12.31	14.44	15.22	11.01	
BF Mean Depth (ft)	1.70	1.26	1.22	1.21		0.94	0.88	0.79	0.76		1.12	0.98	0.90	0.81		1.75	1.79	1.75	0.76	
Width/Depth Ratio	8.24	10.40	11.19	11.05		11.25	10.41	14.84	14.58		8.46	9.46	9.66	11.00		7.03	8.06	8.72	14.58	
BF Cross-sectional Area (ft²)	23.77	16.60	16.70	16.30		9.98	8.00	9.20	8.30		10.57	9.00	7.80	7.30		21.55	25.90	26.60	8.30	
BF Max Depth (ft)	3.30	2.17	2.44	2.00		1.52	1.37	1.55	1.47		1.80	1.53	1.39	1.33		3.21	3.86	3.91	0.76	
Width of Floodprone Area (ft)	87.97	85.74	87.56	85.50		87.73	85.64	87.44	86.07		140.14	138.05	137.59	129.41		118.98	116.46	117.45	118.62	
Entrenchment Ratio	5.5	5.3	5.3	5.1		7.1	7.9	6.4	6.7		14.1	13.9	14.5	13.2		8.9	7.8	7.5	6.7	
Bank Height Ratio	1.0	1.1	1.1	1.1		1.0	1.1	1.0	1.0		1.0	1.1	1.0	1.1		1.0	1.1	1.1	1.0	
Wetted Perimeter (ft)	17.4	15.65	16.12	15.84		12.48	10.88	13.27	12.53		11.7	11.2	10.49	10.55		15.81	18.02	18.72	12.53	
Hydraulic Radius (ft)	18.18	22.06	23.6	23.31		23.44	21.7	30.47	29.92		18.04	19.9	20.22	22.81		15.81	17.91	19.19	29.92	
Substrate																				
d50 (mm)																				
d84 (mm)																				

Parameter	MY-1 (2007)			MY-2 (2008)			MY-3 (2009)			MY-4 (2010)			MY-5 (2011)		
	Min	Max	Med	Min	Max	Med	Min	Max	Med	Min	Max	Med	Min	Max	Med
Pattern															
Channel Beltwidth (ft)															
Radius of Curvature (ft)															
Meander Wavelength (ft)															
Meander Width Ratio															
Profile															
Riffle length (ft)															
Riffle Slope (ft/ft)															
Pool Length (ft)															
Pool Spacing (ft)															
Additional Reach Parameters															
Valley Length (ft)			2833.1			2833.1			2833.1			2833.1			
Channel Length (ft)			3907.59			3907.59			3907.59			3907.59			
Sinuosity			1.38			1.38			1.38			1.38			
Water Surface Slope (ft/ft)			0.0041			0.0041			0.0041			0.0041			
BF Slope (ft/ft)			0.0057			0.0057			0.0057			0.0057			
Rosgen Classification			C			C			C			C			

**STREAM DATA
AND PHOTOS**

Permanent Cross-section 1
(Year 4 Data - Collected October 2010)



Looking at the Left Bank



Looking at the Right Bank

Feature	Stream Type	BKF Area	BKF Width	BKF Depth	Max BKF Depth	W/D	BH Ratio	ER	BKF Elev	TOB Elev
Riffle	C	5.9	9.83	0.6	1.04	16.32	1	6.1	63.99	64.02

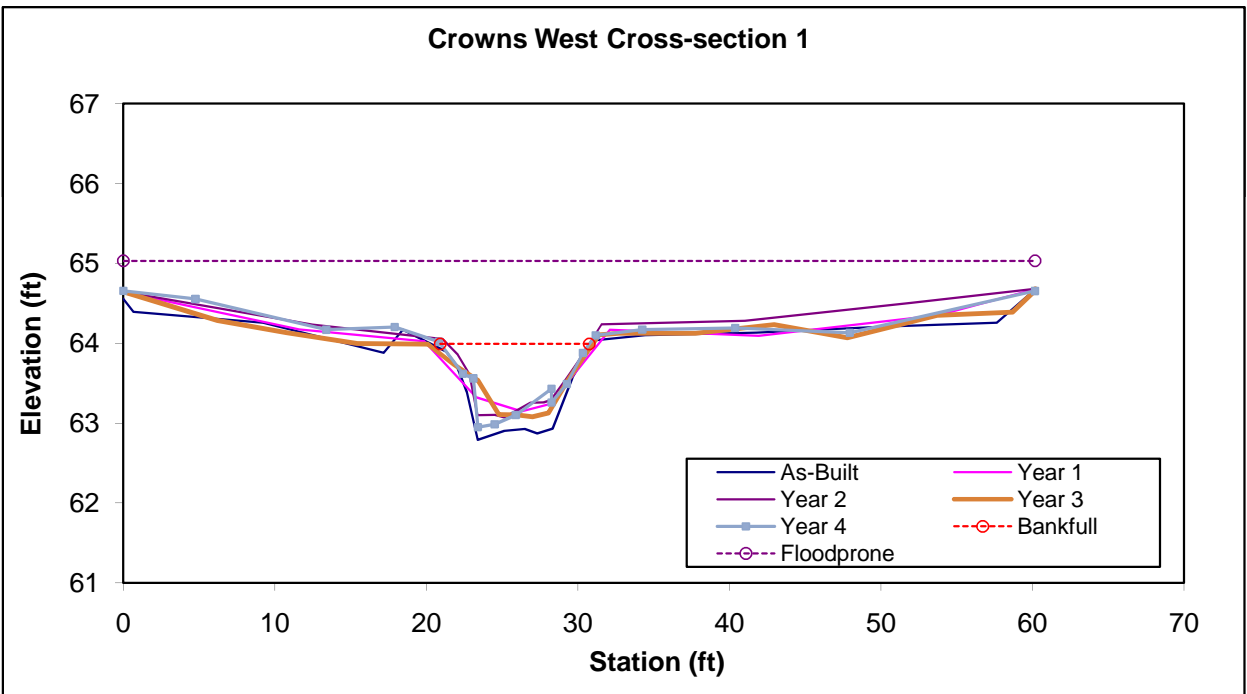

Permanent Cross-section 2
(Year 4 Data - Collected October 2010)



Looking at the Left Bank



Looking at the Right Bank

Feature	Stream Type	BKF Area	BKF Width	BKF Depth	Max BKF Depth	W/D	BH Ratio	ER	BKF Elev	TOB Elev
Pool		20.7	10.44	1.98	3	5.26	1.1	6.2	62.45	62.71

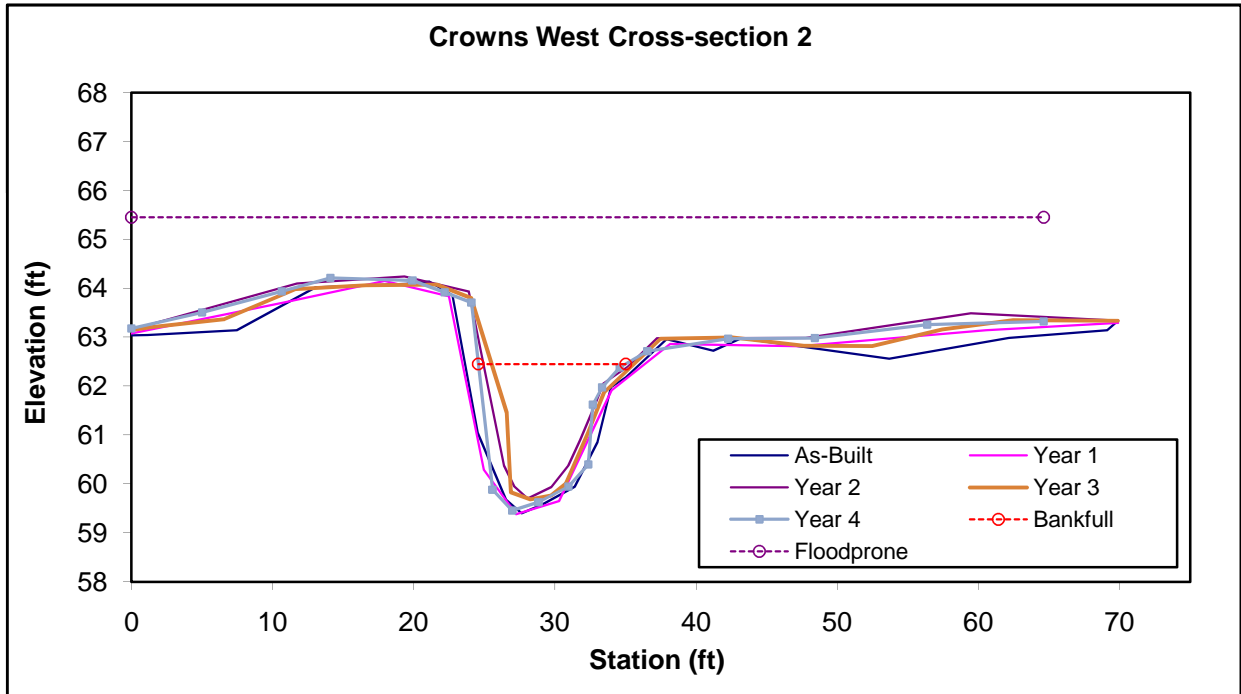

Permanent Cross-section 3
(Year 4 Data - Collected October 2010)



Looking at the Left Bank



Looking at the Right Bank

Feature	Stream Type	BKF Area	BKF Width	BKF Depth	Max BKF Depth	W/D	BH Ratio	ER	BKF Elev	TOB Elev
Riffle	C	6.7	10.8	0.62	1.24	17.43	1.1	6	61.2	61.28

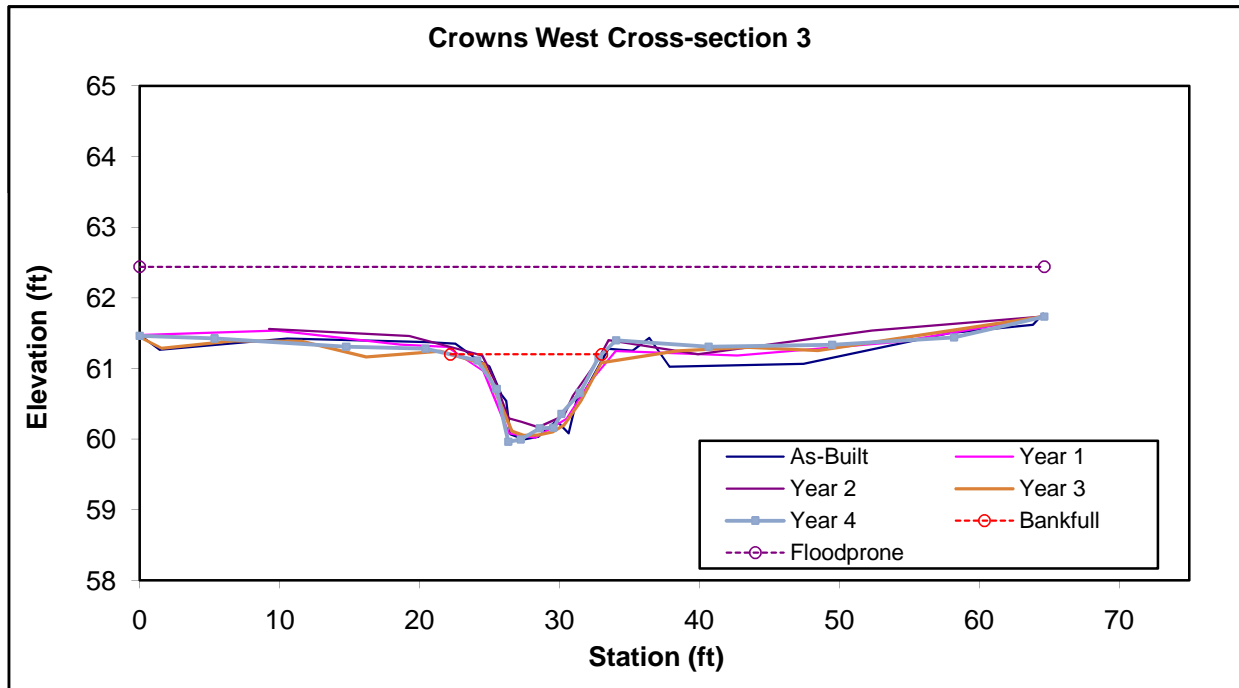

Permanent Cross-section 4
(Year 4 Data - Collected October 2010)



Looking at the Left Bank



Looking at the Right Bank

Feature	Stream Type	BKF Area	BKF Width	BKF Depth	Max BKF Depth	W/D	BH Ratio	ER	BKF Elev	TOB Elev
Riffle	C	6.1	9.08	0.67	1.07	13.62	1.1	6.4	58.92	58.98

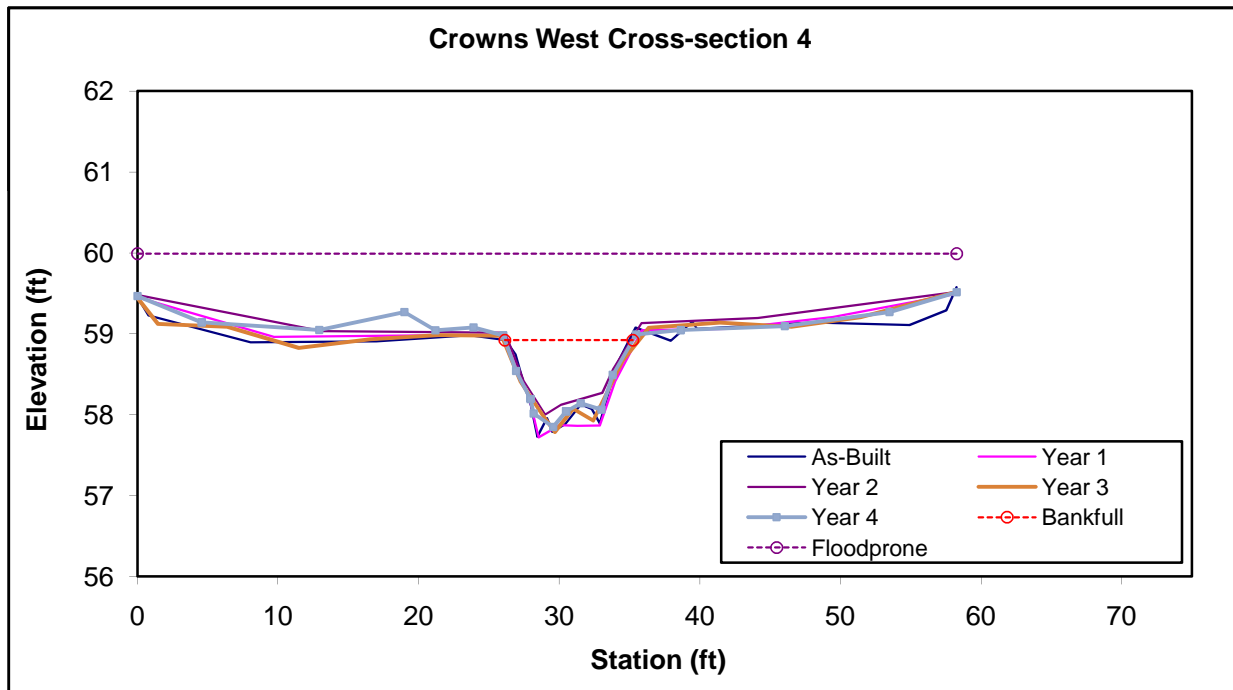

Permanent Cross-section 6
(Year 4 Data - Collected October 2010)



Looking at the Left Bank



Looking at the Right Bank

Feature	Stream Type	BKF Area	BKF Width	BKF Depth	Max BKF Depth	W/D	BH Ratio	ER	BKF Elev	TOB Elev
Pool		16.3	13.42	1.21	2	11.05	1.1	5.1	53.05	53.28

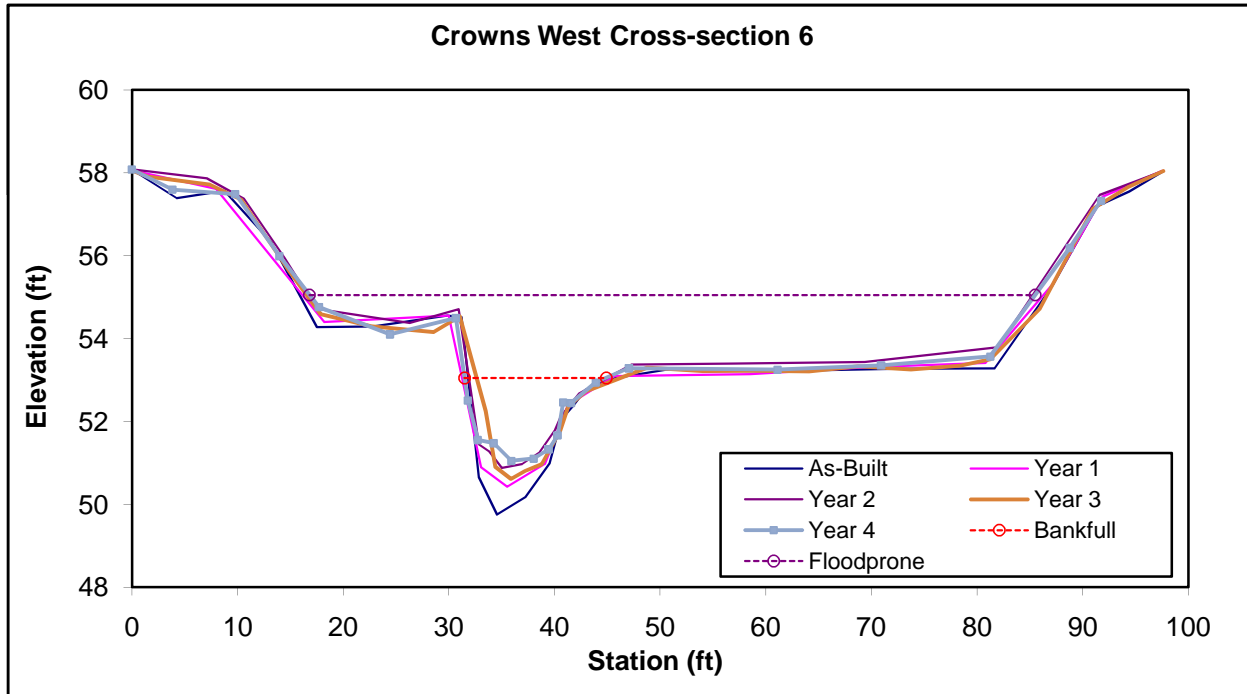

Permanent Cross-section 7
(Year 4 Data - Collected October 2010)



Looking at the Left Bank



Looking at the Right Bank

Feature	Stream Type	BKF Area	BKF Width	BKF Depth	Max BKF Depth	W/D	BH Ratio	ER	BKF Elev	TOB Elev
Riffle	C	8.3	11.01	0.76	1.47	14.58	1	6.7	52.8	52.78

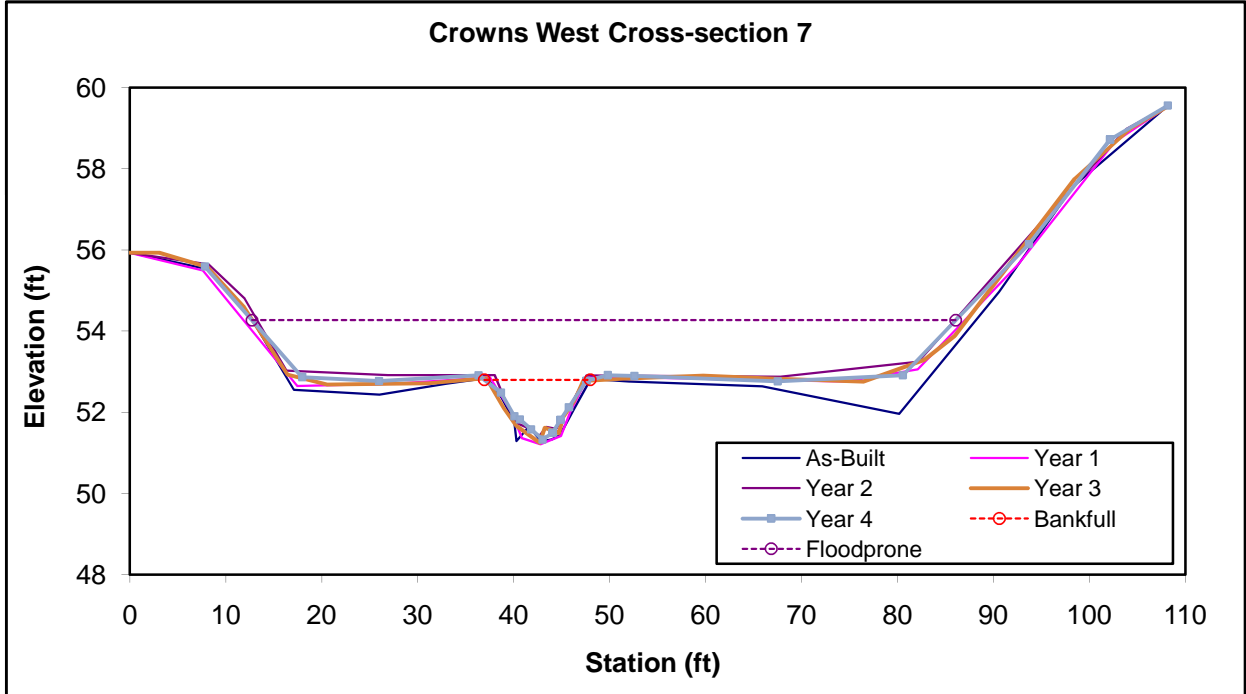



Photo Point 1 - Constructed Riffle 1



Photo Point 2 - Log Weir 1



Photo Point 3 - Constructed Riffle 2



Photo Point 4 - Log Weir 2



Photo Point 5 - Log Weir 3



Photo Point 6 - Log Weir 4



Photo Point 7 - Constructed Riffle 3



Photo Point 8 - Log Weir 5



Photo Point 9 - Constructed Riffle 4



Photo Point 10 - Log Weir 6



Photo Point 11 - Constructed Riffle 5



Photo Point 12 - Constructed Riffle 6



Photo Point 13 - Constructed Riffle 7



Photo Point 14 - Constructed Riffle 8



Photo Point 15 - Constructed Riffle 9



Photo Point 16 - Constructed Riffle 10



Photo Point 17 - Constructed Riffle 11



Photo Point 18 - Constructed Riffle 12



Photo Point 19 - Constructed Riffle 12



Photo Point 20 - Constructed Riffle 13



Photo Point 21 - Constructed Riffle 13



Photo Point 22 - Constructed Riffle 13



Photo Point 23 - Constructed Riffle 13



Crest Gauge after Bankfull - 3.72 feet



Bankfull evidence noted on stream bank
February 9, 2010



Bankfull evidence noted on stream bank
February 9, 2010

Table 1. Taxa list and abundance for benthic macroinvertebrates collected By Baker Engineering, Crowns West and Beaverdam Branch, Onslow/Jones Counties, 10 March 2010. Crowns West is a restoration site; Beaverdam Branch is a reference site. A=Abundant, C=Common, R=Rare

<u>Taxon</u>	<u>TV</u>	<u>Crowns W Beaverdam</u>	
EPHEMEROPTERA			
Leptophlebia sp	6.2	R	-
Pseudocloeon frondalis	7.5	C	C
Pseudocloeon propinquous	5.8	C	R
Baetis intercalaris	7.0	-	C
Maccaffertium modestum	5.5	-	A
Stenacron interpunctatum	6.9	-	R
TRICHOPTERA			
Cheumatopsyche spp	6.2	A	A
COLEOPTERA			
Gyrinus sp	6.2	R	C
Dineutus sp	5.5	-	R
Helichus sp	4.6	-	C
Enochrus sp	8.8	-	R
ODONATA			
Calopteryx sp	7.8	-	A
Ischnura sp	9.5	-	C
Pachydiplax longipennis	9.9	R	-
MEGALOPTERA			
Nigronia serricornis	5.0	-	R
DIPTERA: MISCELANEOUS			
Tipula spp	7.3	-	R
Simulium spp	6.0	A	C
S. ubiquitum	-	A	A
S. venustum gr	7.1	C	-
Chrysops sp	6.7	R	R
DIPTERA: CHIRONOMIDAE			
Microtendipes sp	5.5	-	R
Polypedilum aviceps	3.7	-	C
Polypedilum fallax	6.4	-	R
Rheotanytarsus sp	5.9	R	-
Conchapelopia group	8.4	R	C
Corynoneura sp	6.0	-	R
Eukiefferiella claripennis gr	5.6	R	-
Cricotopus bicinctus	8.5	C	C
C. patens	-	R	-
Orthocladius obumbratus gr	8.5	C	A
O. oliveri	-	A	-
Parametricnemus lundbecki	3.7	R	R

<u>Taxon</u>	<u>TV</u>	<u>Crowns W Beaverdam</u>	
CRUSTACEA			
Procambarus sp	7.0	R	-
Crangonyx sp	7.9	R	-
Gammarus fasciatus	9.1	-	A
Hyalella azteca	7.8	-	R
Caecidotea racovitzai	5.5	-	R
MOLLUSCA			
Physella spp	8.8	-	C
OTHER			
Ranatra sp (Hemiptera)	7.8	-	R
<u>Summary Metrics</u>			
Total Taxa Richness		19	31
EPT taxa Richness		4	6
EPT Abundance		17	28
NC Biotic Index		6.6	6.2
Seasonally corrected		6.8	6.4

Notes

- All sites are assumed to be too small for a rating, although the abundance of Hydropsychidae (which require flowing water) at both sites indicated that these streams could support a more normal lotic macroinvertebrate community.
- The Biotic Index values for Crowns West would be in the Fair range for Coastal Plain streams >4 meters wide, while Beaverdam Br would be in the Good-Fair range. Low EPT taxa richness for Crowns West also suggested lower water quality, esp. the absence of *Maccaffertium*
- The much higher taxa richness at the reference site may reflect a higher habitat diversity.



Site 1 – Crowns West macroinvertebrate sampling site, view is upstream (Year 3)



Site 1 – Crowns West macroinvertebrate sampling site, view is downstream (Year 3)



Site 2 – Beaverdam Branch macroinvertebrate sampling site, view is upstream (Year 3)



Site 2 – Beaverdam Branch macroinvertebrate sampling site, view is downstream (Year 3)

Site 2
Beaverdam Br.

Year 3

3/06 Revision 7

Habitat Assessment Field Data Sheet
Coastal Plain Streams

TOTAL SCORE 91

Biological Assessment Unit, DWQ

Directions for use: The observer is to survey a minimum of 100 meters with 200 meters preferred of stream, preferably in an upstream direction starting above the bridge pool and the road right-of-way. The segment which is assessed should represent average stream conditions. To perform a proper habitat evaluation the observer needs to get into the stream. To complete the form, select the description which best fits the observed habitats and then circle the score. If the observed habitat falls in between two descriptions, select an intermediate score. A final habitat score is determined by adding the results from the different metrics.

Stream Beaverdam Br. Location/road: Site 2 (Road Name Davis Field) County Jones

Date 3-18-10 CC# _____ Basin Neuse Subbasin 03-04-11

Observer(s) DH, RD Type of Study: Fish Benthos Basinwide Special Study (Describe) _____

Latitude _____ Longitude _____ Ecoregion: CA SWP Sandhills CB

Water Quality: Temperature 14.3 °C DO 9.30 mg/l Conductivity (corr.) 242 µS/cm pH 6.60

Physical Characterization: Visible land use refers to immediate area that you can see from sampling location. Check off what you observe driving thru the watershed in watershed land use.

Visible Land Use: 100 %Forest %Residential %Active Pasture % Active Crops
 %Fallow Fields % Commercial %Industrial %Other - Describe: _____

Watershed land use Forest Agriculture Urban Animal operations upstream

Width: (meters) Stream 2m Channel (at top of bank) 2m Stream Depth: (m) Avg _____ Max _____
 Width variable Braided channel Large river >25m wide

Bank Height (from deepest part of channel to top of bank): (m) 1m

Flow conditions : High Normal Low

Channel Flow Status

Useful especially under abnormal or low flow conditions.

- A. Water reaches base of both banks, minimal channel substrate exposed
- B. Water fills >75% of available channel, or <25% of channel substrate is exposed.....
- C. Water fills 25-75% of available channel, many logs/snags exposed.....
- D. Root mats out of water.....
- E. Very little water in channel, mostly present as standing pools.....

Turbidity: Clear Slightly Turbid Turbid Tannic Milky Colored (from dyes) Green tinge

Good potential for Wetlands Restoration Project?? YES NO

Details N/A

Channelized ditch

- Deeply incised-steep, straight banks Both banks undercut at bend Channel filled in with sediment
- Recent overbank deposits Bar development Sewage smell
- Excessive periphyton growth Heavy filamentous algae growth

Manmade Stabilization: N Y: Rip-rap, cement, gabions Sediment/grade-control structure Berm/levee

Weather Conditions: _____ Photos: N Y Digital 35mm

Remarks:

TYPICAL STREAM CROSS SECTION DIAGRAM ON BACK

Photos:

Fish (minnows)

I. Channel Modification

A. Natural channel-minimal dredging.....	Score
B. Some channelization near bridge, or historic (>20 year old), and/or bends beginning to reappear..	13
C. Extensive channelization, straight as far as can see, channelized ditch.....	10
D. Banks shored with hard structure, >80% of reach disrupted, instream habitat gone.....	5
Remarks _____	0
	Subtotal 15

II. Instream Habitat: Consider the percentage of the reach that is favorable for benthos colonization or fish cover. If >50% of the reach is snags, and 1 type is present, circle the score of 16. Definition: leafpacks consist of older leaves that are packed together and have begun to decay (not piles of leaves in pool areas). Mark as Rare, Common, or Abundant.

Sticks Snags/logs Undercut banks or root mats Macrophytes Leafpacks

AMOUNT OF REACH FAVORABLE FOR COLONIZATION OR COVER

	>50%	30-50%	10-30%	<10%
	Score	Score	Score	Score
4 or 5 types present.....	20	15	10	5
3 types present.....	18	13	8	4
2 types present.....	17	12	7	3
1 type present.....	16	11	6	2
No substrate for benthos colonization and no fish cover.....	0			

No woody vegetation in riparian zone Remarks _____ Subtotal 15

III. Bottom Substrate (silt, clay, sand, detritus, gravel) look at entire reach for substrate scoring.

A. Substrate types mixed

1. gravel dominant.....	Score
2. sand dominant.....	15
3. detritus dominant.....	13
4. silt/clay/muck dominant.....	7
	4

B. Substrate homogeneous

1. nearly all gravel.....	12
2. nearly all sand.....	10
3. nearly all detritus.....	4
4. nearly all silt/clay/muck.....	1

Remarks _____ Subtotal 13

IV. Pool Variety Pools are areas of deeper than average maximum depths with little or no surface turbulence. Water velocities associated with pools are always slow.

A. Pools present

1. Pools Frequent (>30% of 100m length surveyed)	Score
a. variety of pool sizes.....	10
b. pools about the same size (indicates pools filling in).....	8
2. Pools Infrequent (<30% of the 100m length surveyed)	
a. variety of pool sizes.....	6
b. pools about the same size.....	4

B. Pools absent

1. Deep water/run habitat present.....	4
2. Deep water/run habitat absent.....	0

Subtotal 10

Remarks _____ Page Total 53

V. Bank Stability and Vegetation

A. Banks stable or no banks, just flood plain

1. little or no evidence of erosion or bank failure, little potential for erosion 10 10

B. Erosion areas present

1. diverse trees, shrubs, grass; plants healthy with good root systems..... 9 9
 2. few trees or small trees and shrubs; vegetation appears generally healthy..... 7 7
 3. sparse vegetation; plant types and conditions suggest poorer soil binding..... 4 4
 4. mostly grasses, few if any trees and shrubs, high erosion and failure potential at high flow 2 2
 5. little or no bank vegetation, mass erosion and bank failure evident.....0 0

Total 18

Remarks _____

VI. Light Penetration (Canopy is defined as tree or vegetative cover directly above the stream's surface. Canopy would block out sunlight when the sun is directly overhead).

A. Stream with **good** canopy with some breaks for light penetration 10
 B. Stream with **full canopy** - breaks for light penetration absent..... 8
 C. Stream with **partial canopy** - sunlight and shading are essentially equal..... 7
 D. Stream with **minimal canopy** - full sun in all but a few areas..... 2
 E. **No canopy** and no shading..... 0

Subtotal 10

Remarks _____

VII. Riparian Vegetative Zone Width

Definition: A break in the riparian zone is any area which allows sediment to enter the stream. Breaks refer to the near-stream portion of the riparian zone (banks); places where pollutants can directly enter the stream.

	Lft. Bank Score	Rt. Bank Score
A. Riparian zone intact (no breaks)		
1. zone width > 18 meters.....	5	5
2. zone width 12-18 meters.....	4	4
3. zone width 6-12 meters.....	3	3
4. zone width < 6 meters.....	2	2
B. Riparian zone not intact (breaks)		
1. breaks rare		
a. zone width > 18 meters.....	4	4
b. zone width 12-18 meters.....	3	3
c. zone width 6-12 meters.....	2	2
d. zone width < 6 meters.....	1	1
2. breaks common		
a. zone width > 18 meters.....	3	3
b. zone width 12-18 meters.....	2	2
c. zone width 6-12 meters.....	1	1
d. zone width < 6 meters.....	0	0

Total 10

Remarks _____

Page Total 38

TOTAL SCORE 91

Site 1
Crowns West

Year 3

Habitat Assessment Field Data Sheet
Coastal Plain Streams

TOTAL SCORE 67

Biological Assessment Unit, DWQ

Directions for use: The observer is to survey a minimum of 100 meters with 200 meters preferred of stream, preferably in an upstream direction starting above the bridge pool and the road right-of-way. The segment which is assessed should represent average stream conditions. To perform a proper habitat evaluation the observer needs to get into the stream. To complete the form, select the description which best fits the observed habitats and then circle the score. If the observed habitat falls in between two descriptions, select an intermediate score. A final habitat score is determined by adding the results from the different metrics.

Stream Crowns West Location/road: Site (Road Name Branch Rd) County Onslow

Date 3-10-10 CC# _____ Basin Neuse Subbasin 03-05-02

Observer(s) OH, RD Type of Study: Fish Benthos Basinwide Special Study (Describe) _____

Latitude _____ Longitude _____ Ecoregion: CA SWP Sandhills CB

Water Quality: Temperature 9.4 °C DO 10.91 mg/l Conductivity (corr.) 90 µS/cm pH 5.96

Physical Characterization: Visible land use refers to immediate area that you can see from sampling location. Check off what you observe driving thru the watershed in watershed land use.

Visible Land Use: 50 %Forest 10 %Residential %Active Pasture 30 % Active Crops
____ %Fallow Fields % Commercial _____ %Industrial 10 %Other - Describe: Restoration site

Watershed land use Forest Agriculture Urban Animal operations upstream

Width: (meters) Stream 1-1.5m Channel (at top of bank) _____ Stream Depth: (m) Avg _____ Max _____
 Width variable Braided channel Large river >25m wide

Bank Height (from deepest part of channel to top of bank): (m) _____

Flow conditions: High Normal Low

Channel Flow Status

Useful especially under abnormal or low flow conditions.

- A. Water reaches base of both banks, minimal channel substrate exposed
- B. Water fills >75% of available channel, or <25% of channel substrate is exposed.....
- C. Water fills 25-75% of available channel, many logs/snags exposed.....
- D. Root mats out of water.....
- E. Very little water in channel, mostly present as standing pools.....

Turbidity: Clear Slightly Turbid Turbid Tannic Milky Colored (from dyes) Green tinge

Good potential for Wetlands Restoration Project?? YES NO

Details N/A

- Channelized ditch
- Deeply incised-steep, straight banks Both banks undercut at bend Channel filled in with sediment
- Recent overbank deposits Bar development Sewage smell
- Excessive periphyton growth Heavy filamentous algae growth

Manmade Stabilization: N Y: Rip-rap, cement, gabions Sediment/grade-control structure Berm/levee

Weather Conditions: _____ Photos: N Y Digital 35mm

Remarks:

TYPICAL STREAM CROSS SECTION DIAGRAM ON BACK

Photos: upstream + @downstream

I. Channel Modification

	<u>Score</u>
A. Natural channel-minimal dredging.....	<u>15</u>
B. Some channelization near bridge, or historic (>20 year old), and/or bends beginning to reappear..	10
C. Extensive channelization, straight as far as can see, channelized ditch.....	5
D. Banks shored with hard structure, >80% of reach disrupted, instream habitat gone.....	0
Remarks _____	Subtotal <u>15</u>

II. Instream Habitat: Consider the percentage of the reach that is favorable for benthos colonization or fish cover. If >50% of the reach is snags, and 1 type is present, circle the score of 16. Definition: leafpacks consist of older leaves that are packed together and have begun to decay (not piles of leaves in pool areas). Mark as Rare, Common, or Abundant.

Sticks Snags/logs Undercut banks or root mats Macrophytes Leafpacks

AMOUNT OF REACH FAVORABLE FOR COLONIZATION OR COVER

	>50%	30-50%	10-30%	<10%
	Score	Score	Score	Score
4 or 5 types present.....	20	15	<u>10</u>	5
3 types present.....	18	13	8	4
2 types present.....	17	12	7	3
1 type present.....	16	11	6	2
No substrate for benthos colonization and no fish cover.....	0			

No woody vegetation in riparian zone Remarks _____ Subtotal 10

III. Bottom Substrate (silt, clay, sand, detritus, gravel) look at entire reach for substrate scoring.

A. Substrate types mixed	<u>Score</u>
1. gravel dominant.....	15
2. sand dominant.....	<u>13</u>
3. detritus dominant.....	7
4. silt/clay/muck dominant.....	4
B. Substrate homogeneous	
1. nearly all gravel.....	12
2. nearly all sand.....	7
3. nearly all detritus.....	4
4. nearly all silt/clay/muck.....	1

Remarks _____ Subtotal 13

IV. Pool Variety Pools are areas of deeper than average maximum depths with little or no surface turbulence. Water velocities associated with pools are always slow.

A. Pools present	<u>Score</u>
1. Pools Frequent (>30% of 100m length surveyed)	
a. variety of pool sizes.....	<u>10</u>
b. pools about the same size (indicates pools filling in).....	8
2. Pools Infrequent (<30% of the 100m length surveyed)	
a. variety of pool sizes.....	6
b. pools about the same size.....	4
B. Pools absent	
1. Deep water/run habitat present.....	12
2. Deep water/run habitat absent.....	0

Subtotal 810

Remarks _____ Page Total 48

V. Bank Stability and Vegetation

A. Banks stable or no banks, just flood plain

1. little or no evidence of erosion or bank failure, little potential for erosion 10 10

B. Erosion areas present

1. diverse trees, shrubs, grass; plants healthy with good root systems..... 9 9
 2. few trees or small trees and shrubs; vegetation appears generally healthy..... 7 7
 3. sparse vegetation; plant types and conditions suggest poorer soil binding..... 4 4
 4. mostly grasses, few if any trees and shrubs, high erosion and failure potential at high flow 2 2
 5. little or no bank vegetation, mass erosion and bank failure evident.....0 0

Total 9

Remarks _____

VI. Light Penetration (Canopy is defined as tree or vegetative cover directly above the stream's surface. Canopy would block out sunlight when the sun is directly overhead).

A. Stream with **good** canopy with some breaks for light penetration 10
 B. Stream with **full canopy** - breaks for light penetration absent..... 8
 C. Stream with **partial** canopy - sunlight and shading are essentially equal..... 7
 D. Stream with **minimal** canopy - full sun in all but a few areas..... 2
 E. **No canopy** and no shading..... 0

Subtotal 2

Remarks _____

VII. Riparian Vegetative Zone Width

Definition: A break in the riparian zone is any area which allows sediment to enter the stream. Breaks refer to the near-stream portion of the riparian zone (banks); places where pollutants can directly enter the stream.

	Lft. Bank Score	Rt. Bank Score
A. Riparian zone intact (no breaks)		
1. zone width > 18 meters.....	5	5
2. zone width 12-18 meters.....	4	4
3. zone width 6-12 meters.....	3	3
4. zone width < 6 meters.....	2	2
B. Riparian zone not intact (breaks)		
1. breaks rare		
a. zone width > 18 meters.....	4	4
b. zone width 12-18 meters.....	3	3
c. zone width 6-12 meters.....	2	2
d. zone width < 6 meters.....	1	1
2. breaks common		
a. zone width > 18 meters.....	3	3
b. zone width 12-18 meters.....	2	2
c. zone width 6-12 meters.....	1	1
d. zone width < 6 meters.....	0	0

Total 8

Remarks _____

Page Total 19

TOTAL SCORE 67

