

# Deep Meadow Mitigation Site Record Drawings

Union County, North Carolina  
Yadkin River Basin HUC 03040105

for  
NCDEQ  
Division of Mitigation Services

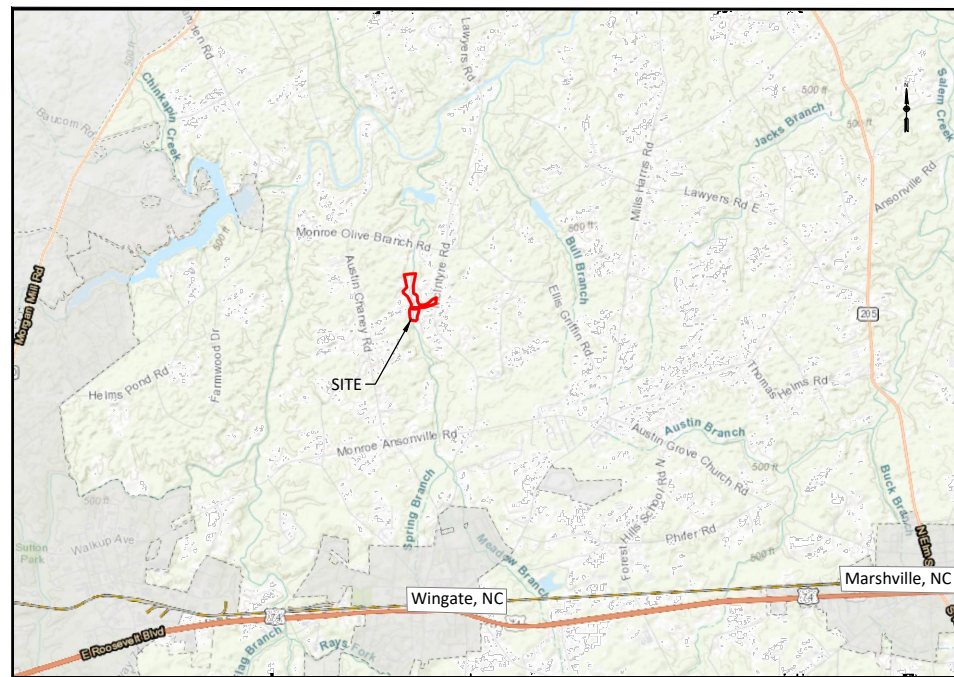

Vicinity Map  
Not to Scale

**RECORD DRAWINGS  
ISSUED MARCH 6, 2020**

**CERTIFICATE OF SURVEY AND ACCURACY**

I, PHILLIP B. KEE, CERTIFY THAT THE GROUND TOPOGRAPHIC SURVEY PORTION OF THIS PROJECT WAS COMPLETED UNDER MY DIRECT SUPERVISION FROM AN ACTUAL SURVEY MADE UNDER MY DIRECT SUPERVISION; THAT THE RECORD DRAWINGS WERE PREPARED BY WILDLANDS ENGINEERING, INC. FROM DIGITAL FILES PROVIDED BY KEE MAPPING AND SURVEYING, PA AS SHOWN ON AN AS-BUILT SURVEY FOR "WILDLANDS ENGINEERING, INC.", JOB #1910115-AB, DATED FEBRUARY 28, 2020; THAT THIS SURVEY WAS PERFORMED AT THE 95% CONFIDENCE LEVEL TO MEET THE FEDERAL GEOGRAPHIC DATA COMMITTEE STANDARDS AND TO MEET THE REQUIREMENTS OF A TOPOGRAPHIC SURVEY TO THE ACCURACY OF CLASS A HORIZONTAL AND CLASS C VERTICAL WHERE APPLICABLE; THAT THE ORIGINAL DATA WAS OBTAINED BETWEEN THE DATES OF 10/29/19 - 11/07/19; THAT THE CONTOURS SHOWN AS BROKEN LINES MAY NOT MEET THE STATED STANDARD AND ALL COORDINATES ARE BASED ON NAD 83 (NSRS 2011) AND ALL ELEVATIONS ARE BASED ON NAVD 88 AND COORDINATE VALUES WERE TAKEN FROM AN EXISTING CONDITIONS TOPOGRAPHIC SURVEY PREPARED BY TURNER LAND SURVEYING, SIGNED, SEALED AND DATED ON 03/02/2017 BY ELIZABETH G. TURNER, NC PLS LICENSE #4440; THAT THIS MAP MEETS THE SPECIFICATIONS FOR TOPOGRAPHIC SURVEYS AS STATED IN TITLE 21, CHAPTER 56, SECTION .1606.

WITNESS MY ORIGINAL SIGNATURE, LICENSE NUMBER, AND SEAL THIS \_\_\_\_\_ DAY OF \_\_\_\_\_, A.D.

3/10/2020 | 6:01 AM PDT



DocuSigned by:  
*Phillip B. Kee*  
D965004A7692407...  
PHILLIP B. KEE, PLS L-4647



**Sheet Index**

Title Sheet	0.1
General Notes and Symbols	0.2
Project Overview	0.3
Stream Plan and Profile	1.1-1.11
Wetland Grading	2.1-2.2
Planting List	3.1
Planting Plan	3.2-3.4

**Project Directory**

**Engineering:**  
Wildlands Engineering, Inc.  
License No. F-0831  
1430 South Mint Street, Ste 104  
Charlotte, NC 28203  
Aaron S. Earley, PE  
704-332-7754

**Owner:**  
NCDEQ  
Division of Mitigation Services  
5 Ravenscroft Drive, Ste 102  
Asheville, NC 28801  
Harry Tsomides  
828-545-7057

**Existing Condition Surveying:**  
Turner Land Surveying  
PO Box 148  
Swannanoa, NC 28778  
Elisabeth G. Turner, PLS  
919-827-0745

DMS Project No. 97131  
Yadkin River Basin HUC 03040105

**As-Built Surveying:**  
Kee Mapping and Surveying, PA  
88 Central Avenue  
Asheville, NC 28801  
Phillips B. Kee, PLS  
828-575-9021



Deep Meadow Mitigation Site Record Drawings  
Union County, North Carolina

Title Sheet

Revisions:	

Date: March 6, 2020  
Job Number: 005-02162  
Project Engineer: ASE  
Drawn By: HCB  
Checked By: JCK

0.1

Sheet

D:\ActiveProjects\005-02162-DeepMeadowMonitoring\Baseline\_Monitoring\_2020\Plans\02162-AB\_CoverNotes.dwg March 9, 2020

March 6, 2020

### As-Built Features

- Recorded Conservation Easement
- As-Built Thalweg Alignment
- As-Built Bankfull
- As-Built Major Contour (5' Interval)
- As-Built Minor Contour
- As-Built Cross Section

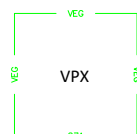

Permanent Vegetation Monitoring Plots



Groundwater Gage



Crest Gauge



Photo Point

AS-BUILT DRAWINGS:  
Deviations from the design will be shown in red.

### As-Built Structures

- As-Built Various Constructed Riffles Per Sheet 6.1 and 6.2
- As-Built Brush Toe
- As-Built Wetland Rehabilitation
- As-Built Wetland Re-establishment
- As-Built Vegetated Soil Lift
- As-Built Riprap as Ditch Stabilization and Permanent Crossing
- As-Built Wetland Berm
- As-Built Rock Toe
- As-Built Gravel

### As-Built Structures

- As-Built Log Sill
- As-Built Lunker Log
- As-Built Log Vane
- As-Built Rock Vane
- As-Built Rock Sill
- As-Built J-Hook

### Pre-construction Features

- Pre-construction Property Line
- Pre-construction Major Contour (5' Interval)
- Pre-construction Minor Contour
- Published 1% Annual Chance of Floodplain Boundary
- Effective Non-encroachment Limits
- Pre-construction Fence
- Pre-construction Storm Pipe
- Pre-construction Farm Road
- Pre-construction Wetland
- Pre-construction Farm Road

### Design Features

- Recorded Conservation Easement
- Designed Thalweg Alignment
- Designed Major Contour (5' Interval)
- Designed Minor Contour
- Designed Bank Grading Limits
- Designed 1% Annual Chance Floodplain Boundary
- Designed Non-encroachment limits
- Designed Tree Removal
- Designed Tree Save
- Designed Safety Fence
- Designed Silt Fence
- Designed Temporary Rock Sediment Dam

### Design Structures

- Designed Various Constructed Riffles
- Designed Brush Toe
- Designed Boulder Cluster Riffle
- Designed Wetland Rehabilitation
- Designed Wetland Re-establishment
- Designed Vegetated Soil Lift
- Deposition bars to be removed
- Designed Ditch Stabilization
- Designed Wetland Berm

### Design Structures

- Design Log Sill
- Design Lunker Log
- Design Log Vane
- Design Rock Vane
- Design Rock Sill
- Design Permanent Crossing

#### PROJECT NOTES:

Topographic survey was completed by Turner Land Surveying in November 2016 and supplemented with Union County LIDAR data provided by the North Carolina Floodplain Mapping Program website. Parcel boundary survey completed by Turner Land Surveying in February 2017.

Horizontal Datum: North American Datum of 1983 (NAD83)  
Vertical Datum: North American Vertical Datum of 1988 (NAVD88)

As-Built survey completed on December 6, 2019 by Kee Land Surveying.

**WILDLANDS**  
ENGINEERING, INC.  
1405 W. GARDNER ST., SUITE 104  
CHARLOTTE, NC 28203  
Tel: 704.332.7754  
Fax: 704.332.3306  
Firm License No. F-0831

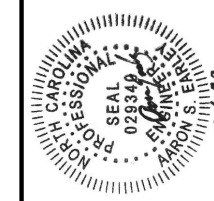

Deep Meadow Mitigation Site Record Drawings  
 Union County, North Carolina  
 General Notes and Symbols

Revisions:

Date:	March 6, 2020
Job Number:	005-02162
Project Engineer:	ASE
Drawn By:	HCB
Checked By:	JCK

# 0.2

Sheet

D:\ActiveProjects\005-02162-Deep Meadow\Monitoring\Baseline\_Monitoring\_2020\Plans\02162-AB\_CourtNotes.dwg

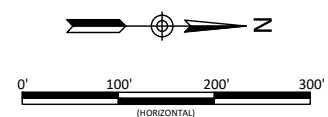
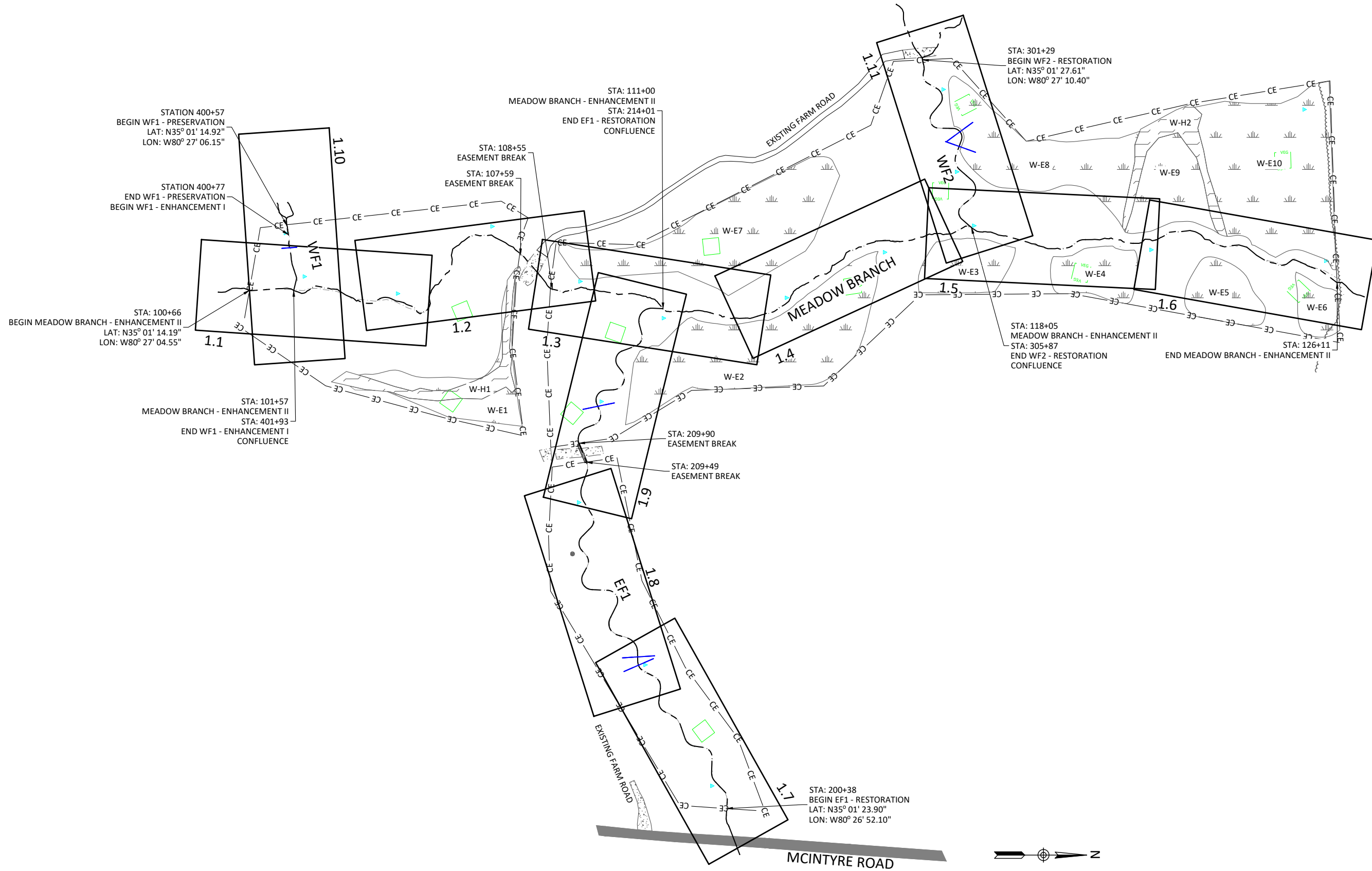

Deep Meadow Mitigation Site Record Drawings  
 Union County, North Carolina  
 Project Overview

Revisions:

Date:	March 6, 2020
Job Number:	005-02162
Project Engineer:	ASE
Drawn By:	HCB
Checked By:	JCK

0.3

March 6, 2020

D:\ActiveProjects\005-02162-Deep Meadow\Monitor\Baseline\_Monitoring\_2020\Plan\02162-48\_Profile.dwg

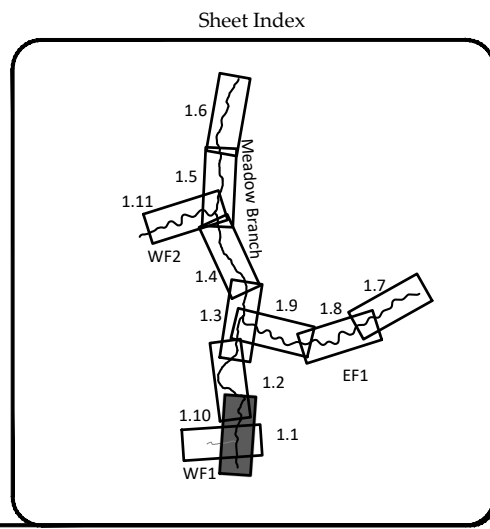
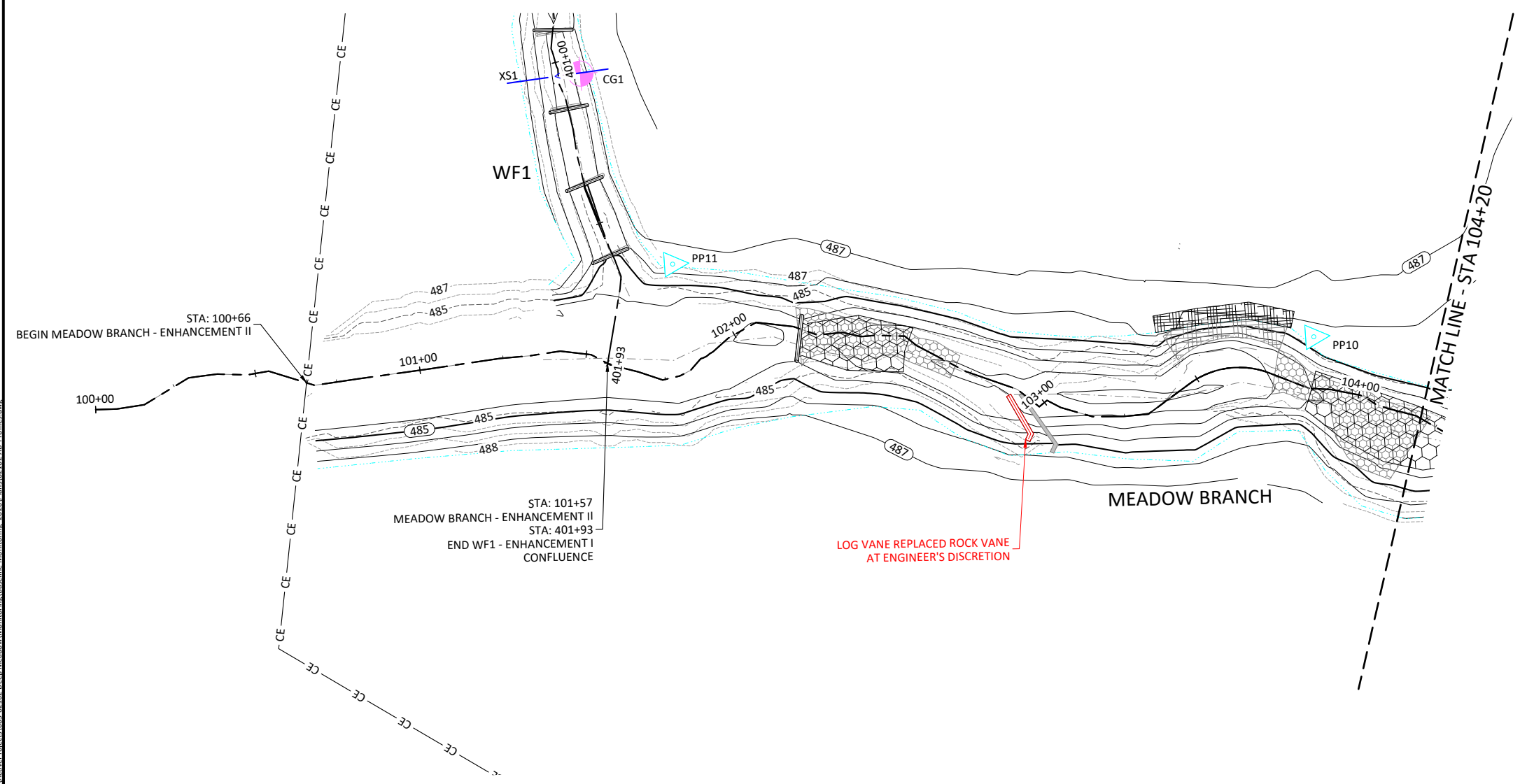
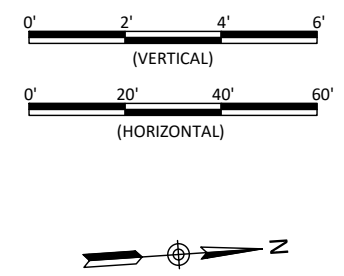
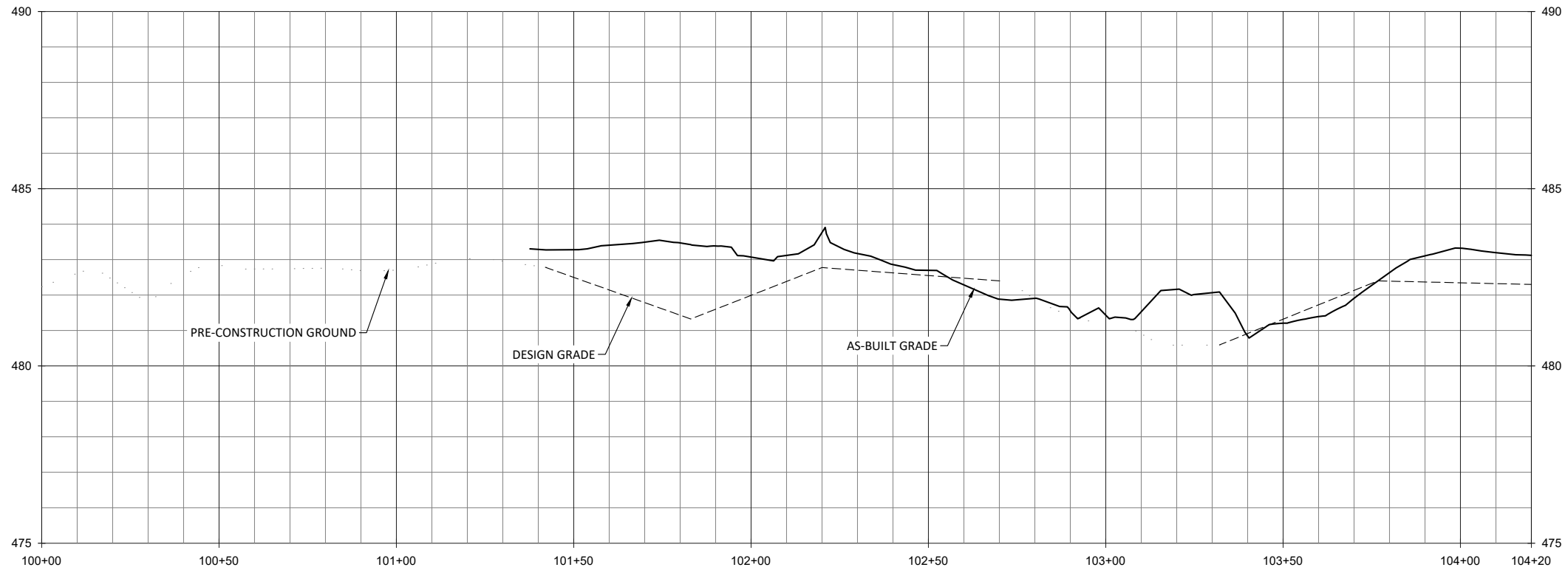

Deep Meadow Mitigation Site Record Drawings  
Union County, North Carolina

Meadow Branch  
Stream Plan and Profile

Revisions:

Date: March 6, 2020

Job Number:	005-02162
Project Engineer:	ASE
Drawn By:	HCB
Checked By:	JCK

1.1

Sheet

**WILDLANDS**  
ENGINEERING, INC.  
1485 N. WILSON ROAD  
CHARLOTTE, NC 28203  
Tel: 704.332.7754  
Fax: 704.332.3306  
Firm License No. F-0831



D:\ActiveProjects\005-02162-Deep Meadow\Monitor\Baseline\_Monitoring\_2020\Plan\02162-48\_Profile.dwg  
 March 6, 2020

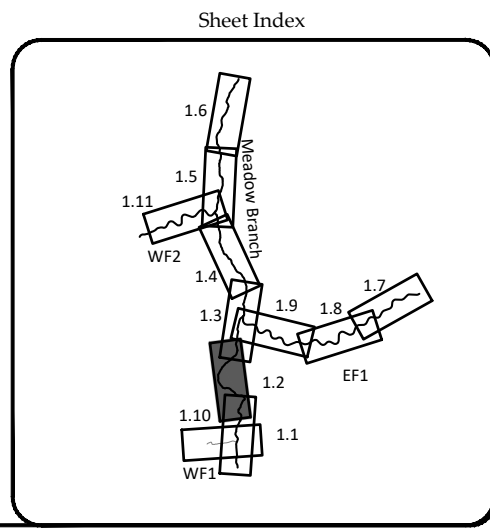
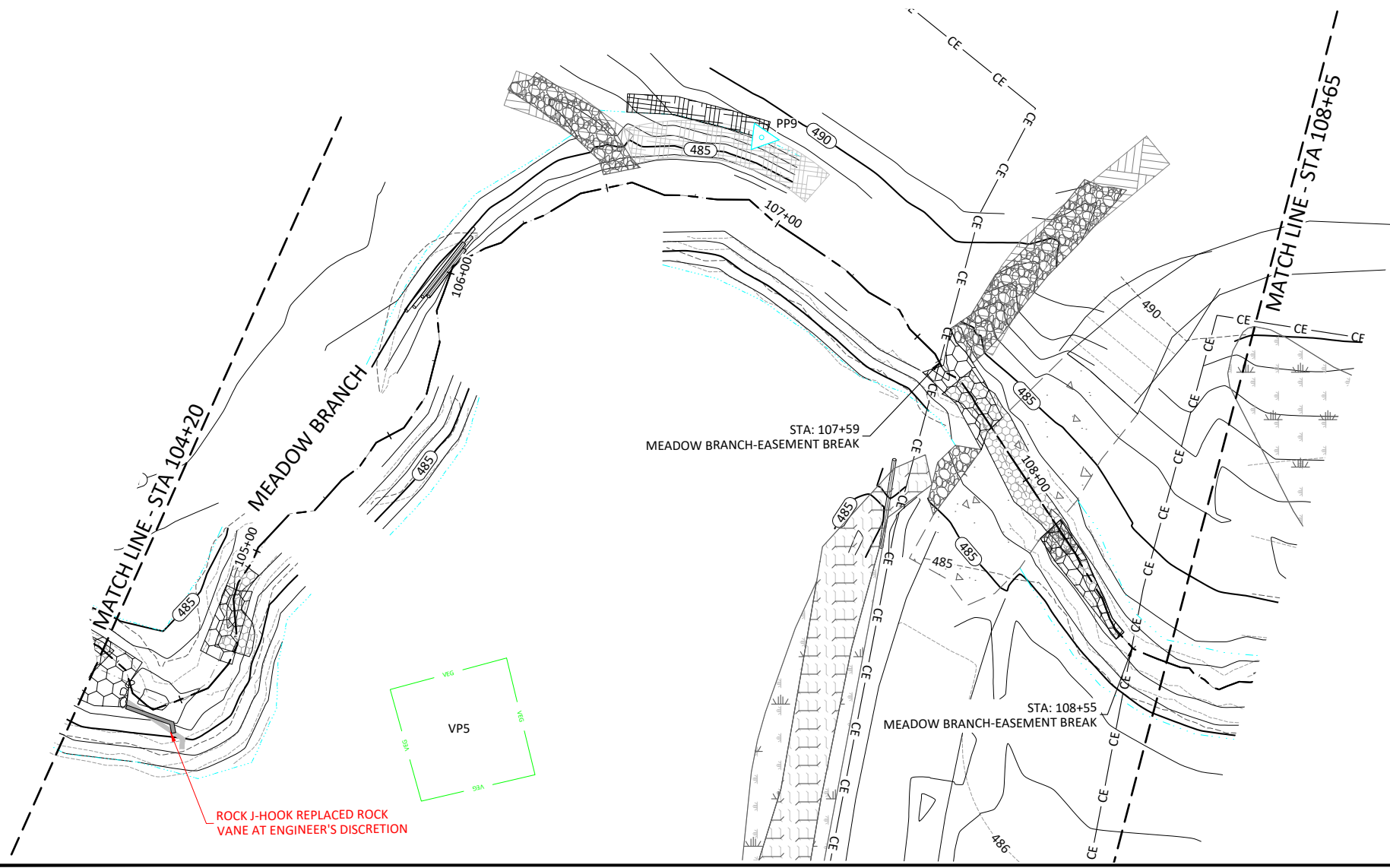
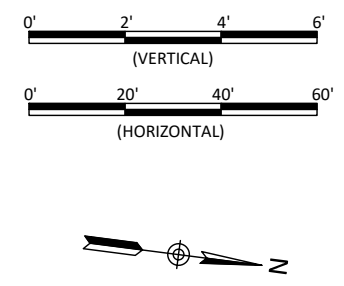
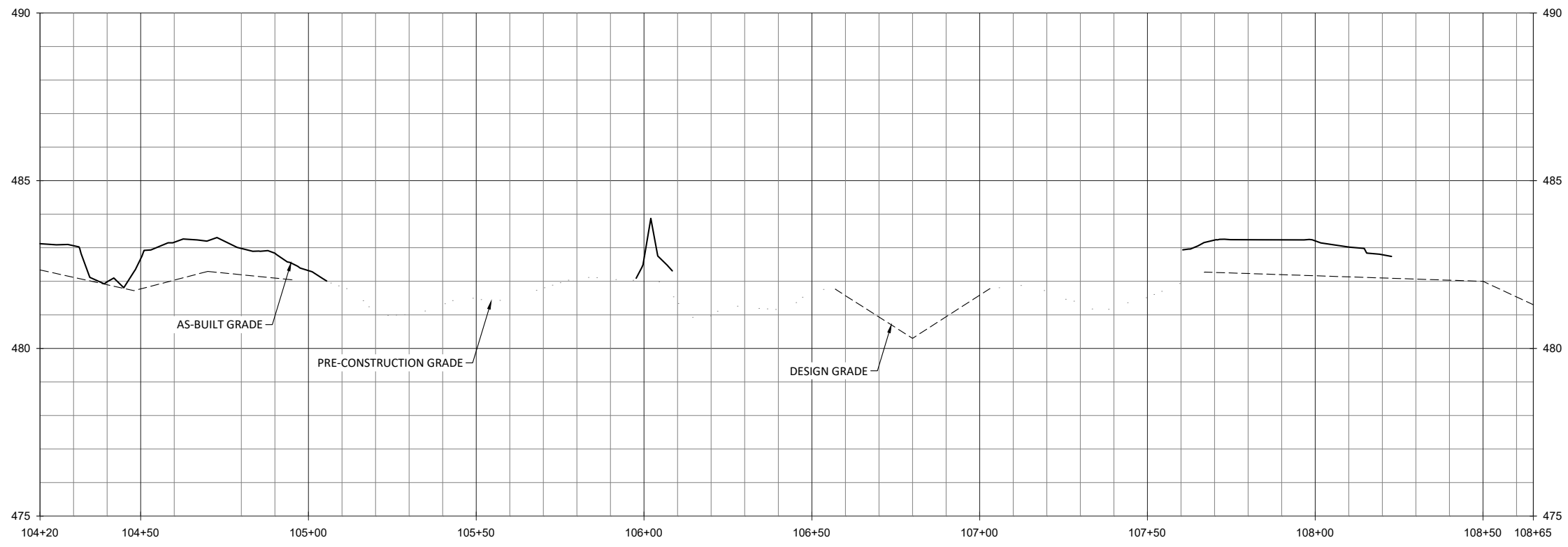

Deep Meadow Mitigation Site Record Drawings  
 Union County, North Carolina  
 Meadow Branch  
 Stream Plan and Profile

Revisions:

No.	Description	Date

Date: March 6, 2020  
 Job Number: 005-02162  
 Project Engineer: ASE  
 Drawn By: HCB  
 Checked By: JCK



**WILDLANDS**  
 ENGINEERING, INC.  
 1485 W. WILSON ROAD  
 CHARLOTTE, NC 28203  
 Tel: 704.332.7754  
 Fax: 704.332.3306  
 Firm License No. F-0831

1.2

Sheet

March 6, 2020  
D:\ActiveProjects\005-02162-Deep Meadow\Monitor\Baseline\_Monitoring\_2020\Plan\02162-18-Profile.dwg

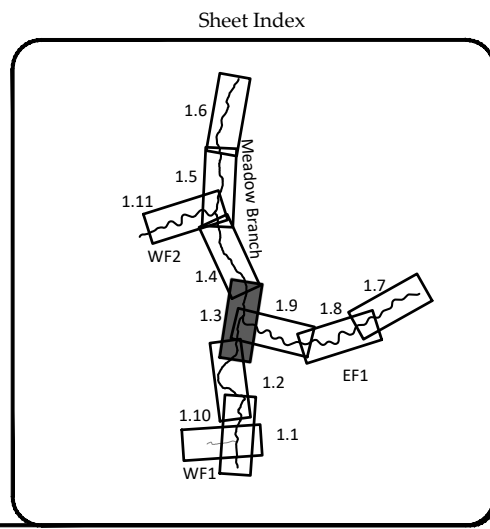
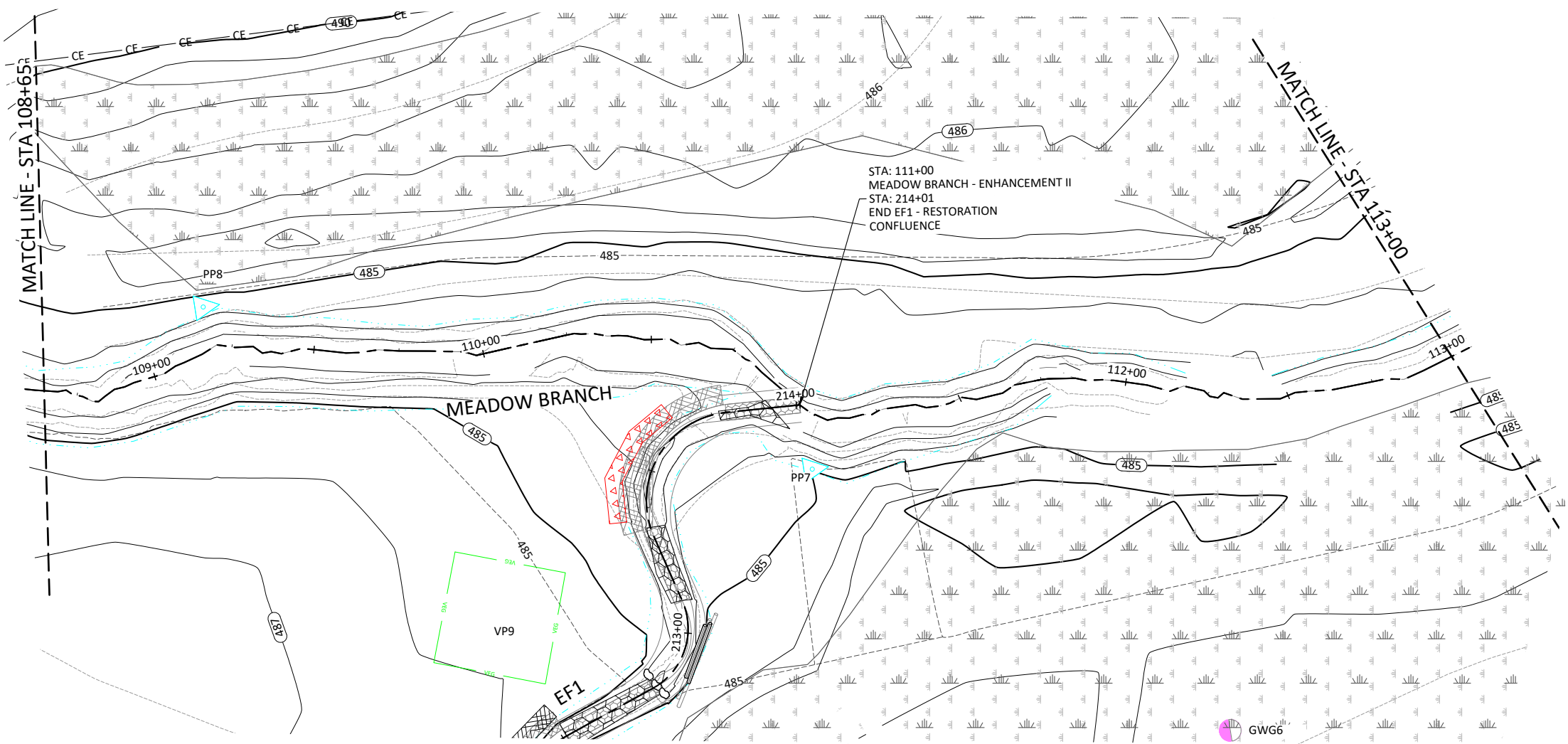
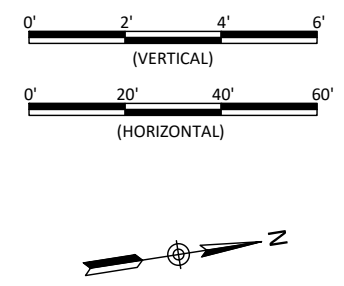
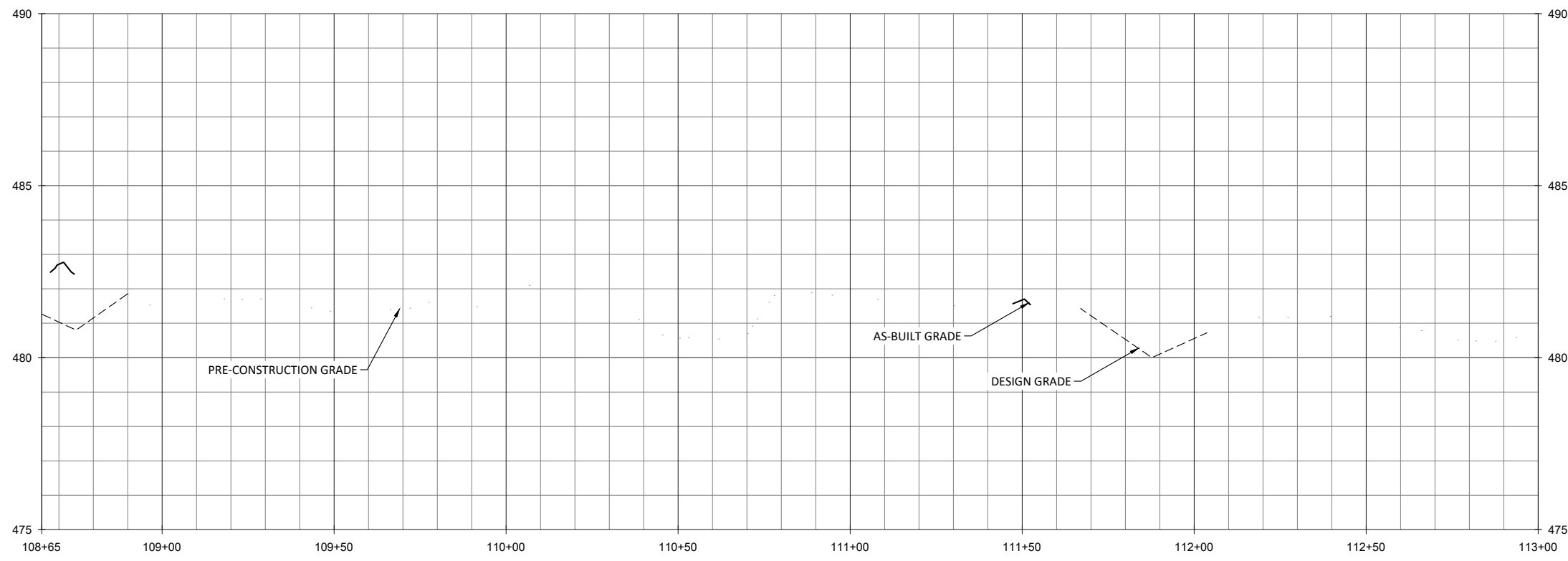

Deep Meadow Mitigation Site Record Drawings  
Union County, North Carolina  
Meadow Branch  
Stream Plan and Profile

Revisions:	

Date:	March 6, 2020
Job Number:	005-02162
Project Engineer:	ASE
Drawn By:	HCB
Checked By:	JCK

1.3

Sheet

**WILDLANDS**  
ENGINEERING  
1405 E. WILSON ROAD, SUITE 104  
CHARLOTTE, NC 28203  
Tel: 704.332.7754  
Fax: 704.332.3306  
Firm License No. F-0831



D:\ActiveProjects\095-02162-Deep Meadow\Monitor\Baseline\_Monitoring\_2020\Plan\02162-08\_Profile.dwg

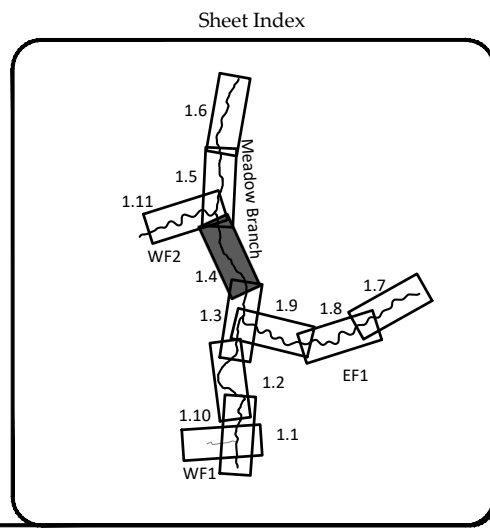
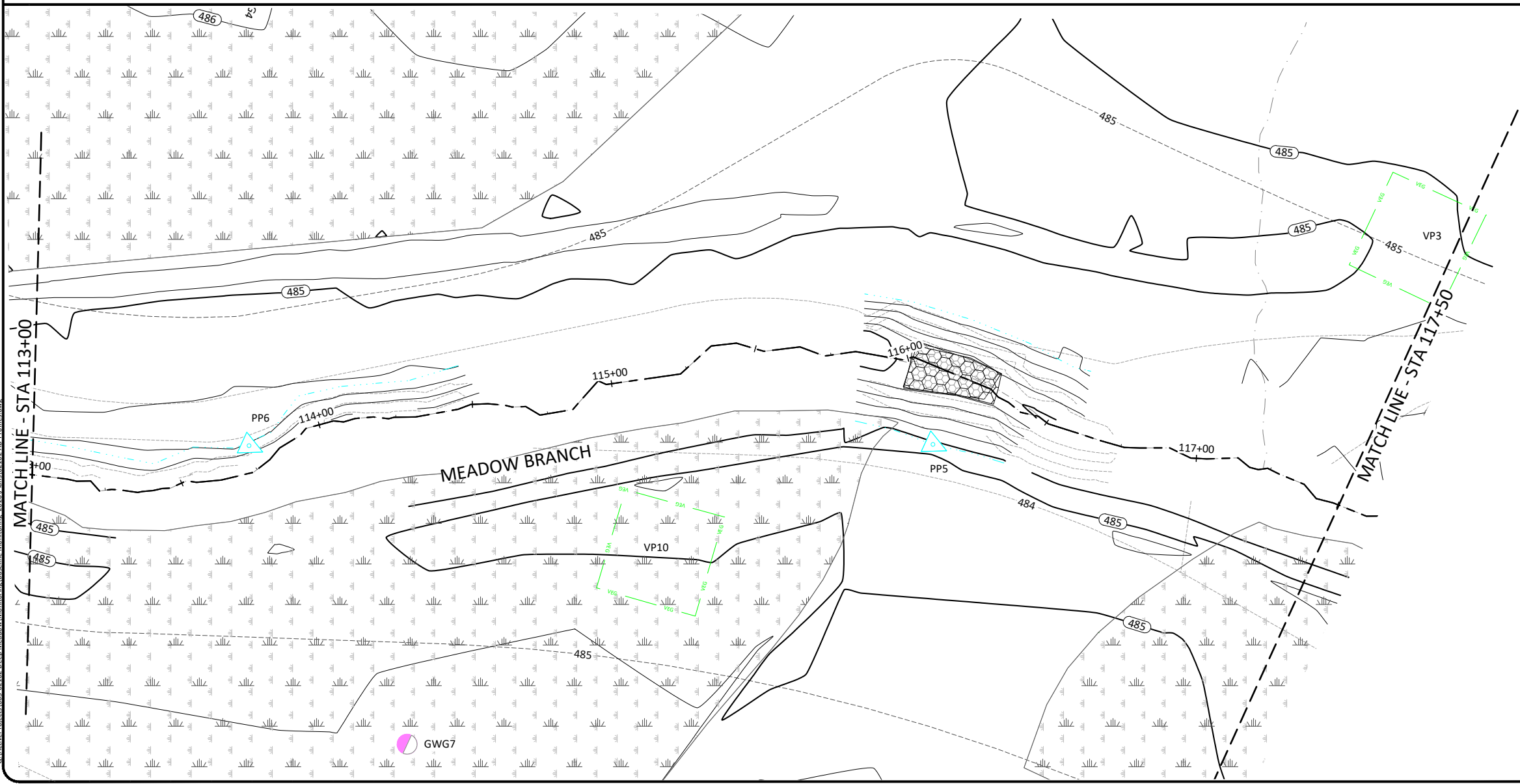
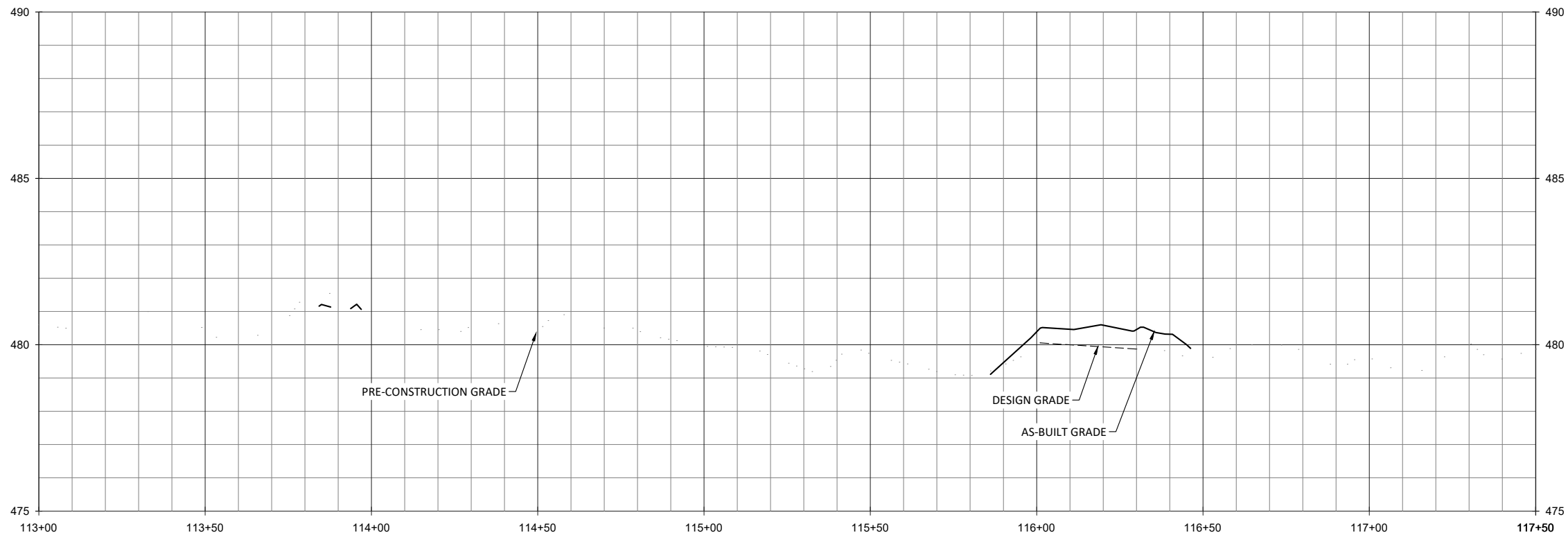

Deep Meadow Mitigation Site Record Drawings  
 Union County, North Carolina  
 Meadow Branch  
 Stream Plan and Profile

**WILDLANDS**  
 ENGINEERING, INC.  
 1485 E. WILSON ROAD, SUITE 104  
 CHARLOTTE, NC 28203  
 TEL: 704.332.7754  
 FAX: 704.332.3306  
 FIRM LICENSE NO. F-0831

PROFESSIONAL SEAL  
 029349  
 ENGINEER  
 MARRON S. ELLIOTT  
 3-6-20

Revisions:	

Date:	March 6, 2020
Job Number:	005-02162
Project Engineer:	ASE
Drawn By:	HCB
Checked By:	JCK

1.4

Sheet

March 6, 2020

D:\ActiveProjects\005-02162-Deep Meadow Monitor\Baseline Monitors\_2020\Plan\02162-48-Profile.dwg

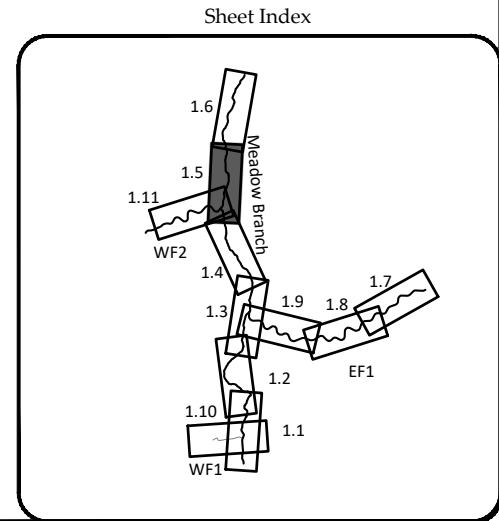
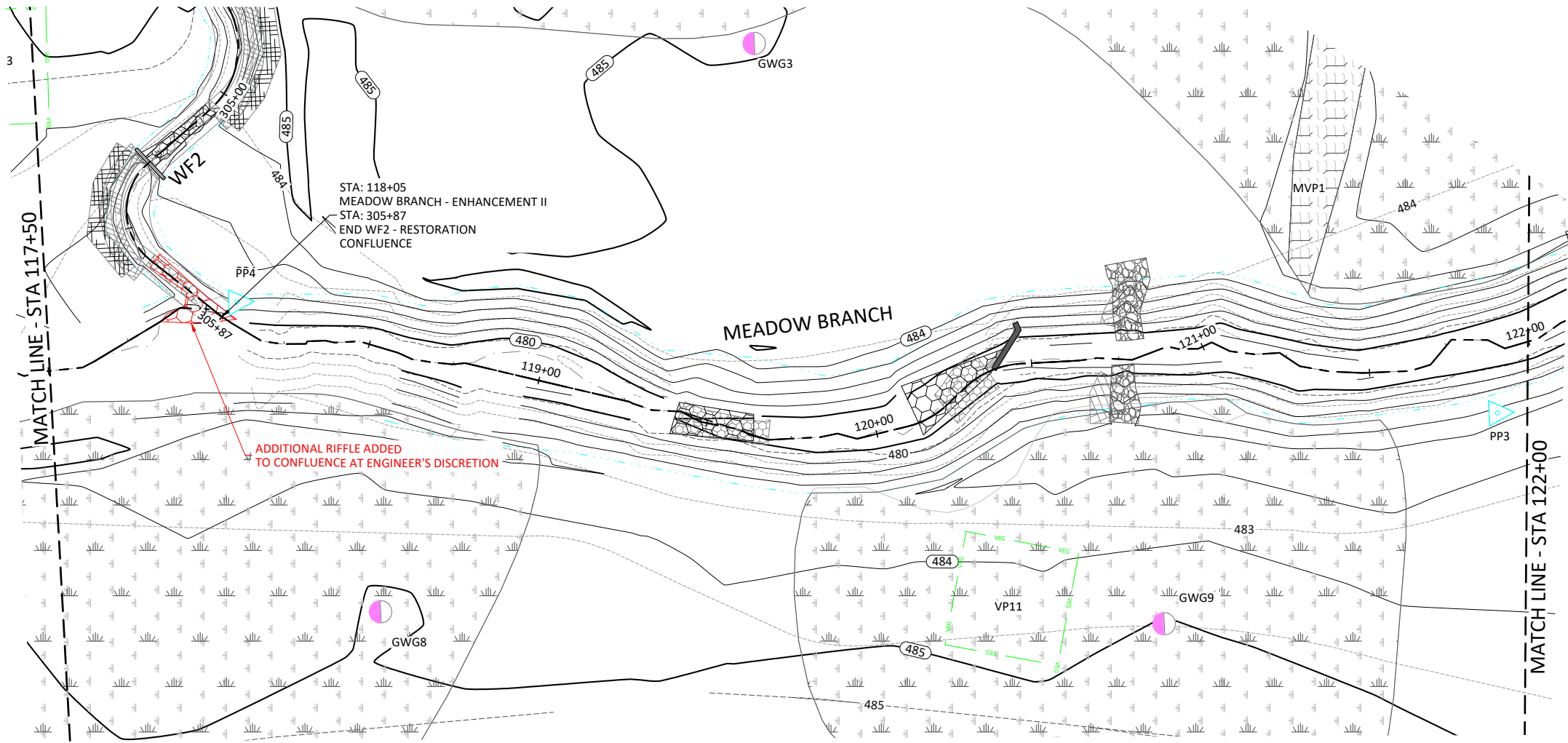
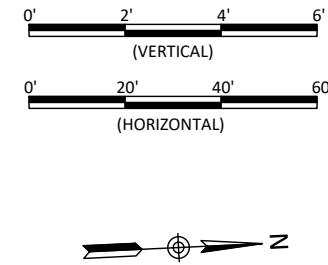
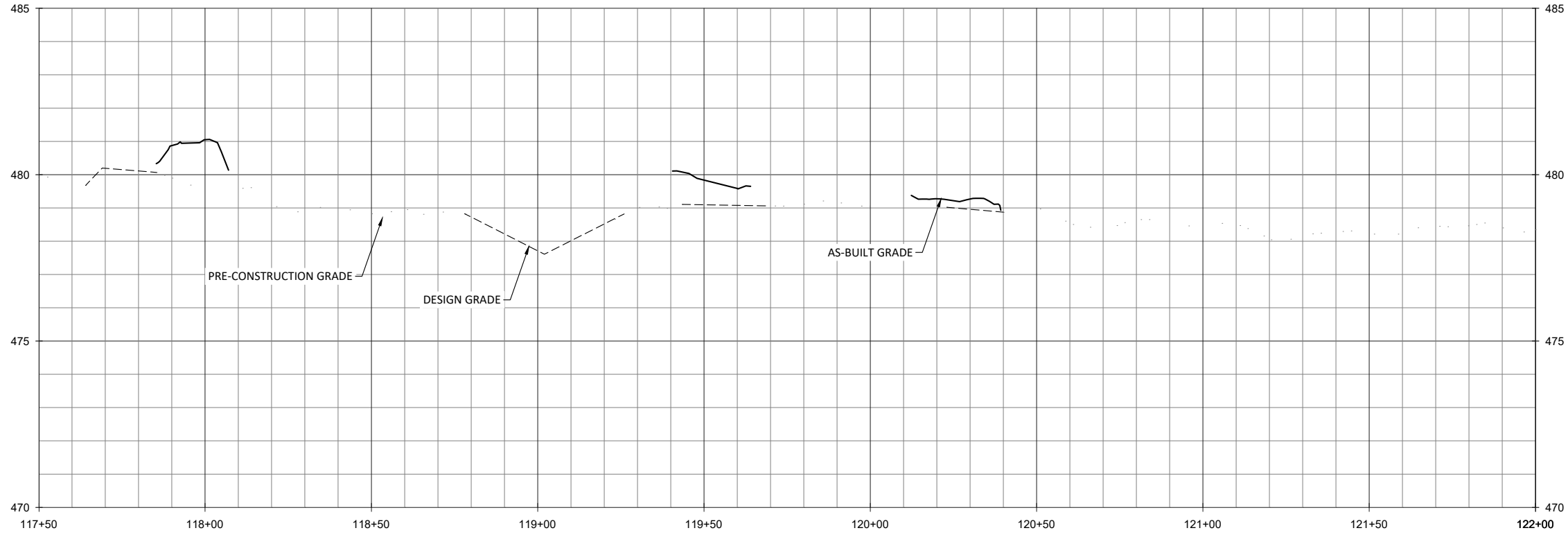

Deep Meadow Mitigation Site Record Drawings  
 Union County, North Carolina  
 Meadow Branch  
 Stream Plan and Profile

Revisions:

Date: March 6, 2020  
 Job Number: 005-02162  
 Project Engineer: ASE  
 Drawn By: HCB  
 Checked By: JCK

1.5

Sheet

**WILDLANDS ENGINEERING, INC.**  
 1405 N. GREENWAY, SUITE 104  
 CHARLOTTE, NC 28203  
 Tel: 704.332.7754  
 Fax: 704.332.3306  
 Firm License No. F-0831





March 6, 2020

D:\ActiveProjects\005-02162-Deep Meadow Monitor\Baseline\_Monitoring\_2020\Plan\02162-AB\_Profile.dwg

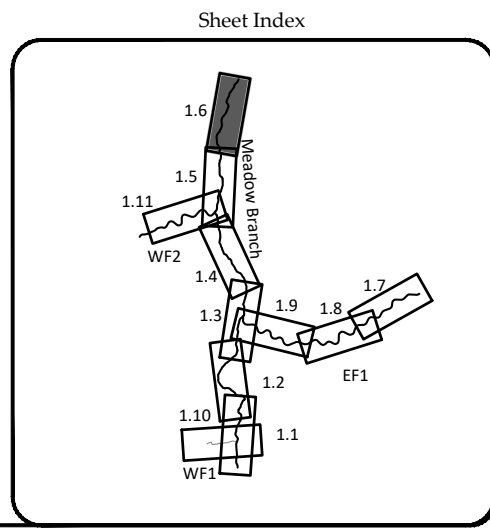
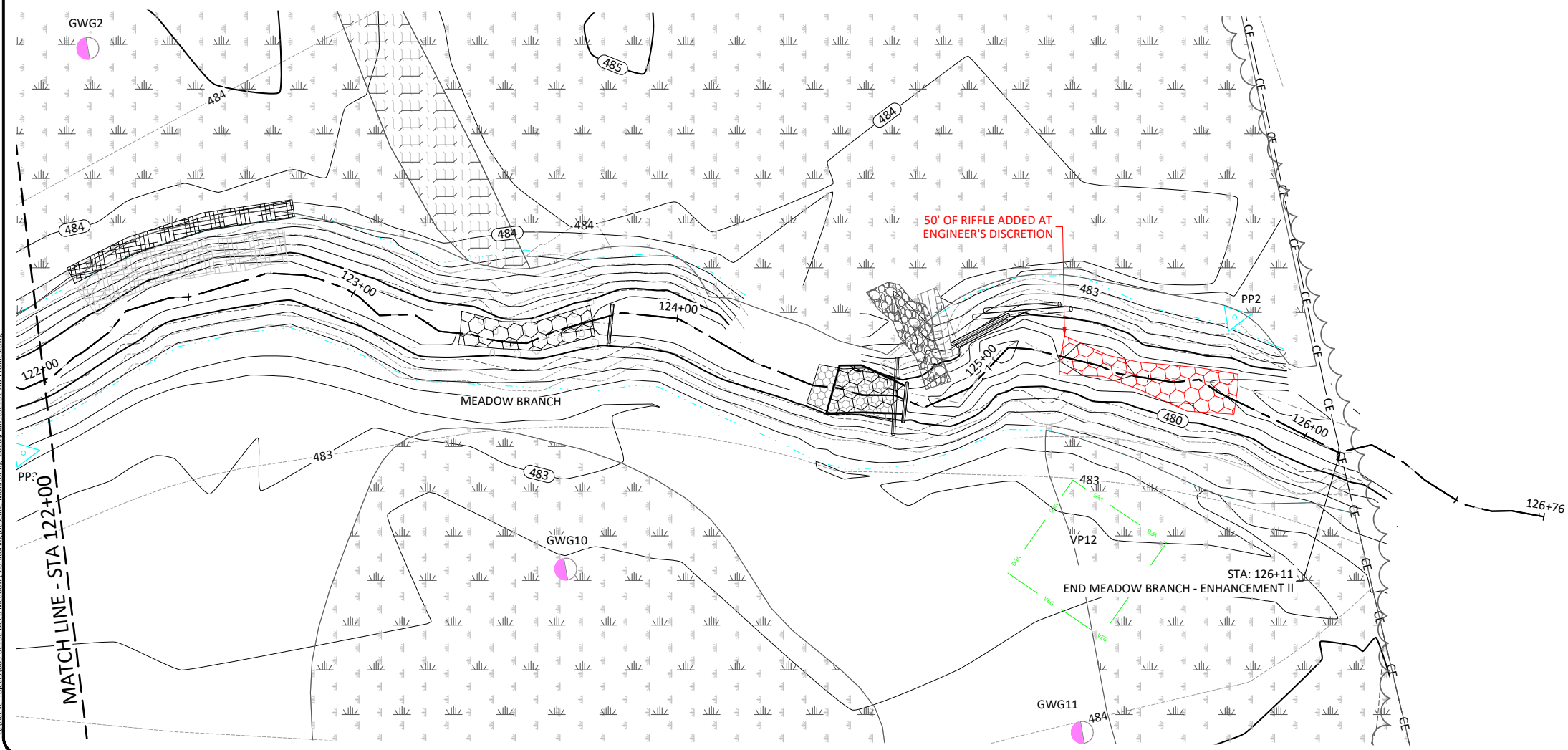
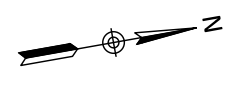
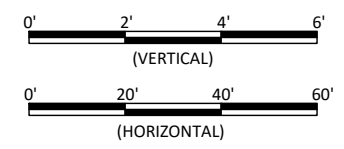
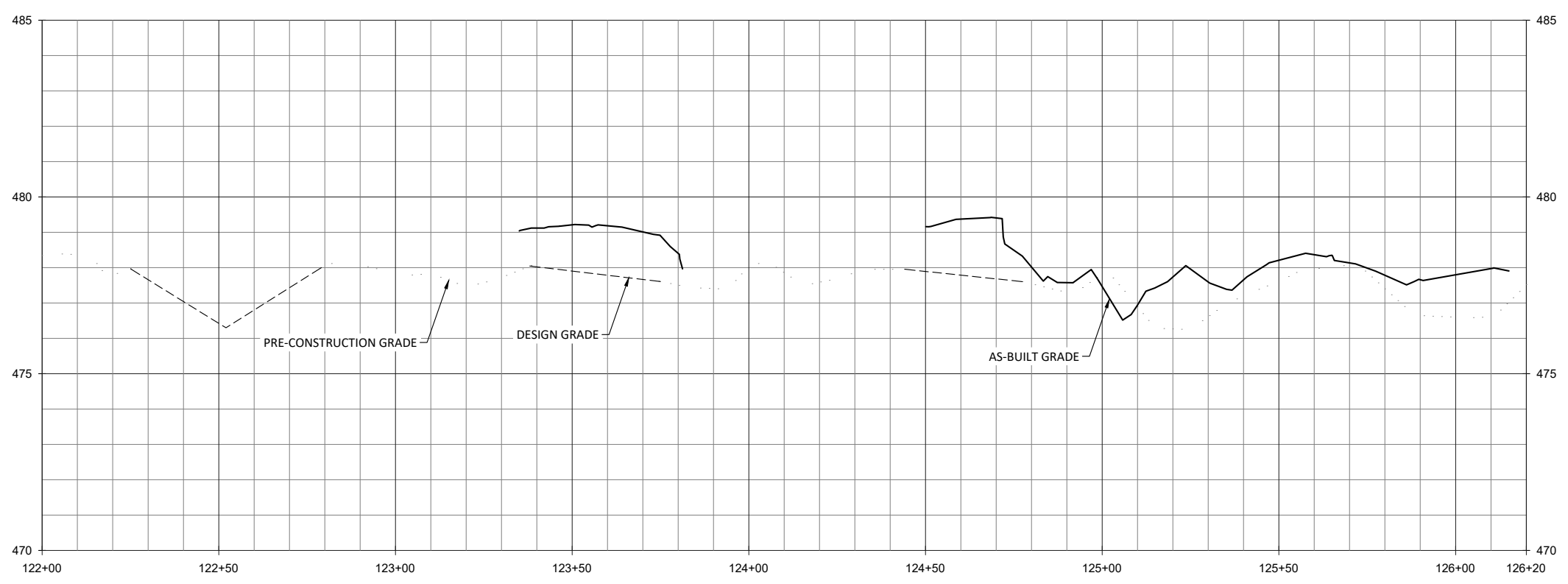

Deep Meadow Mitigation Site Record Drawings  
Union County, North Carolina

Meadow Branch  
Stream Plan and Profile

Revisions:

Date: March 6, 2020

Job Number:	005-02162
Project Engineer:	ASE
Drawn By:	HCB
Checked By:	JCK

1.6

Sheet

**WILDLANDS**  
ENGINEERING  
1405 E. WILSON AVENUE, SUITE 104  
CHARLOTTE, NC 28203  
Tel: 704.332.7754  
Fax: 704.332.3306  
Firm License No. F-0831



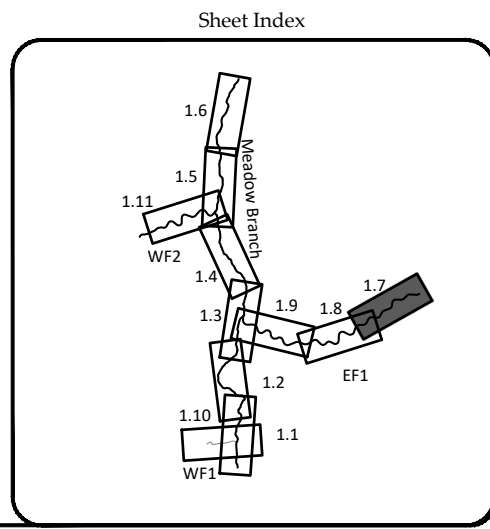
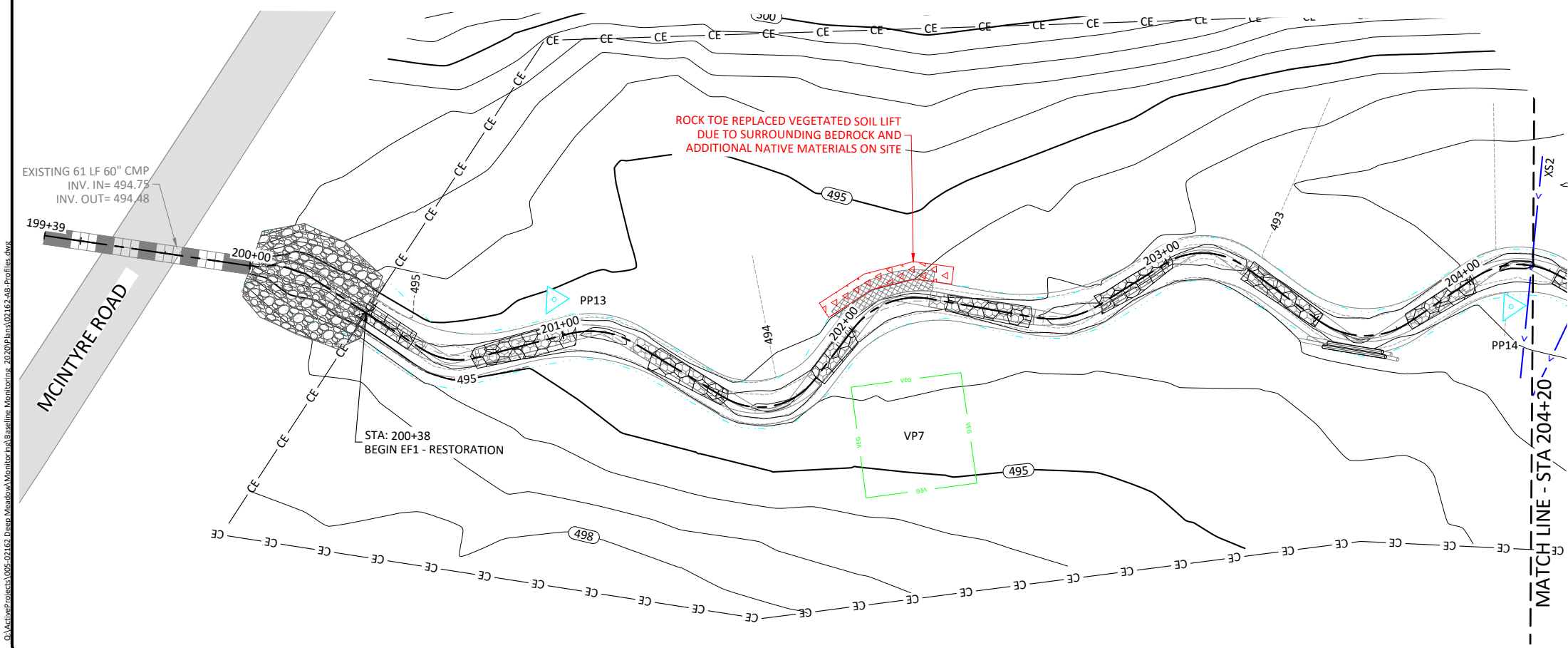
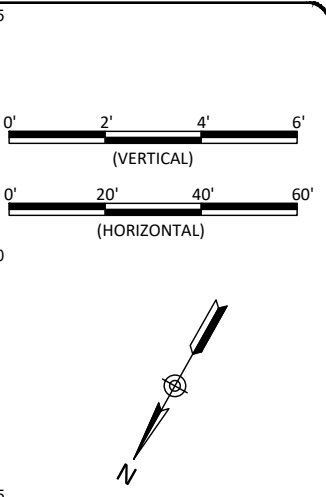
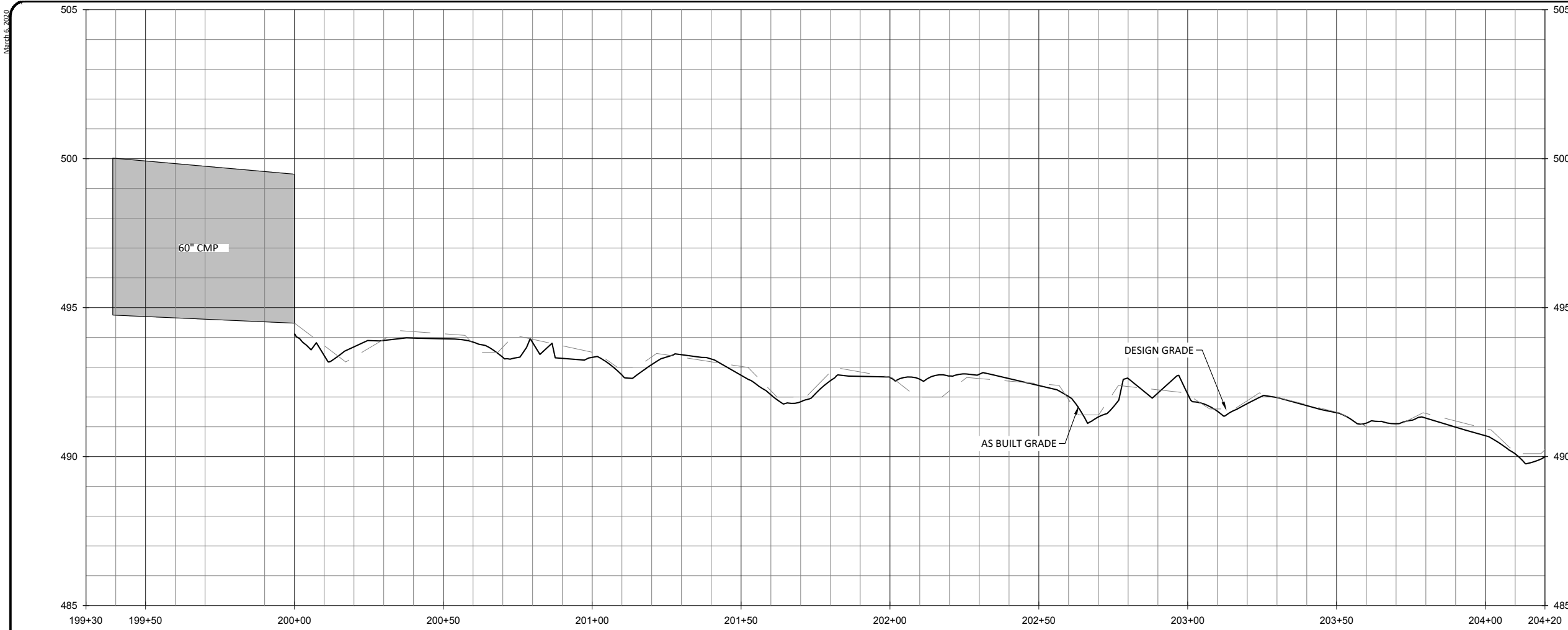

Deep Meadow Mitigation Site Record Drawings  
 Union County, North Carolina

EF1  
 Stream Plan and Profile

Revisions:

Date: March 6, 2020  
 Job Number: 005-02162  
 Project Engineer: ASE  
 Drawn By: HCB  
 Checked By: JCK

1.7

Sheet

**WILDLANDS**  
 ENGINEERING, INC.  
 1485 S. GARDNER ST., SUITE 104  
 CHARLOTTE, NC 28203  
 Tel: 704.332.7754  
 Fax: 704.332.3306  
 Firm License No. F-0831



D:\ActiveProjects\005-02162\_Deep\_Meadow\_Monitoring\Baseline\_Monitoring\_2020\Plan\02162-48\_Profile.dwg

March 6, 2020

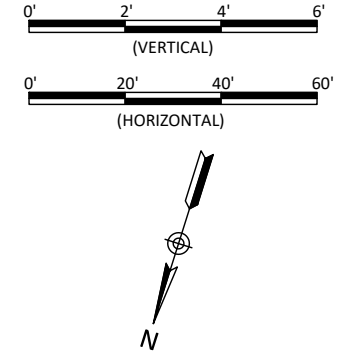
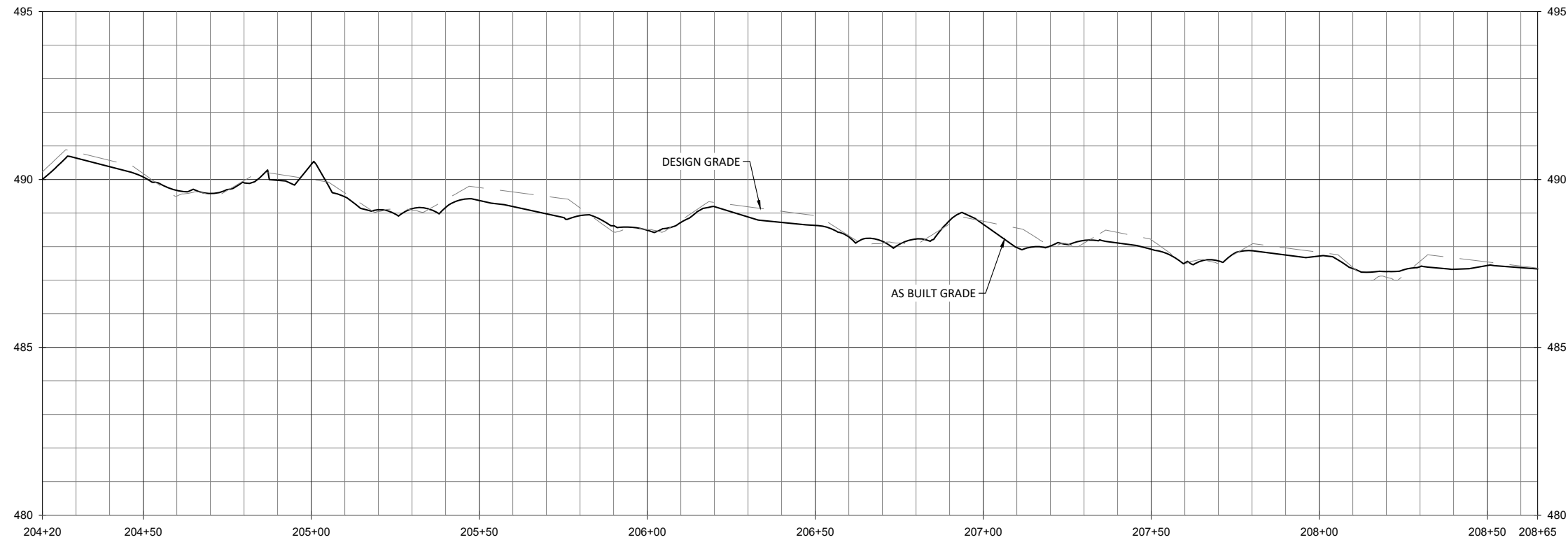

**WILDLANDS**  
 ENGINEERING, INC.  
 1485 N. GREENWOOD AVENUE, SUITE 104  
 CHARLOTTE, NC 28203  
 Tel: 704.332.7754  
 Fax: 704.332.3306  
 Firm License No. F-0831



Deep Meadow Mitigation Site Record Drawings  
 Union County, North Carolina

EF1  
 Stream Plan and Profile

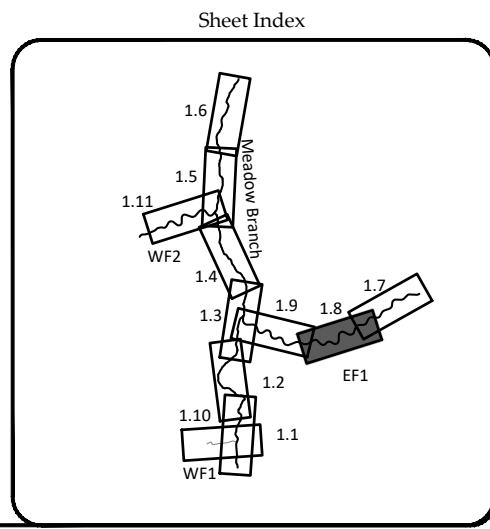
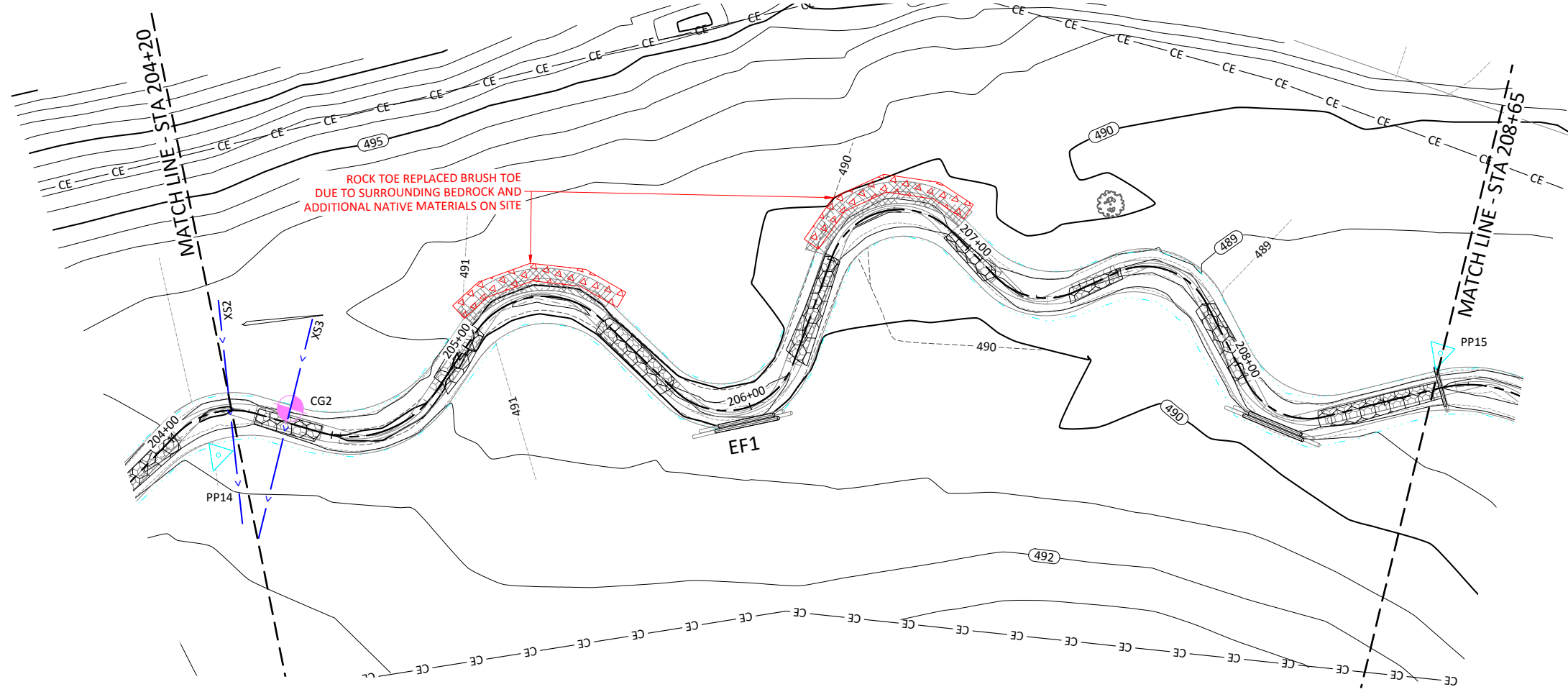

Revisions:



Date: March 6, 2020  
 Job Number: 005-02162  
 Project Engineer: ASE  
 Drawn By: HCB  
 Checked By: JCK

**1.8**

Sheet

D:\ActiveProjects\005-02162\_Deep\_Meadow\_Monitoring\Baseline\_Monitoring\_2020\Plan\02162\_48\_Profile.dwg

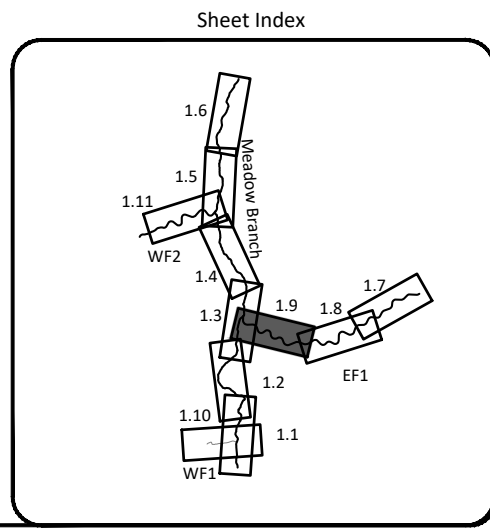
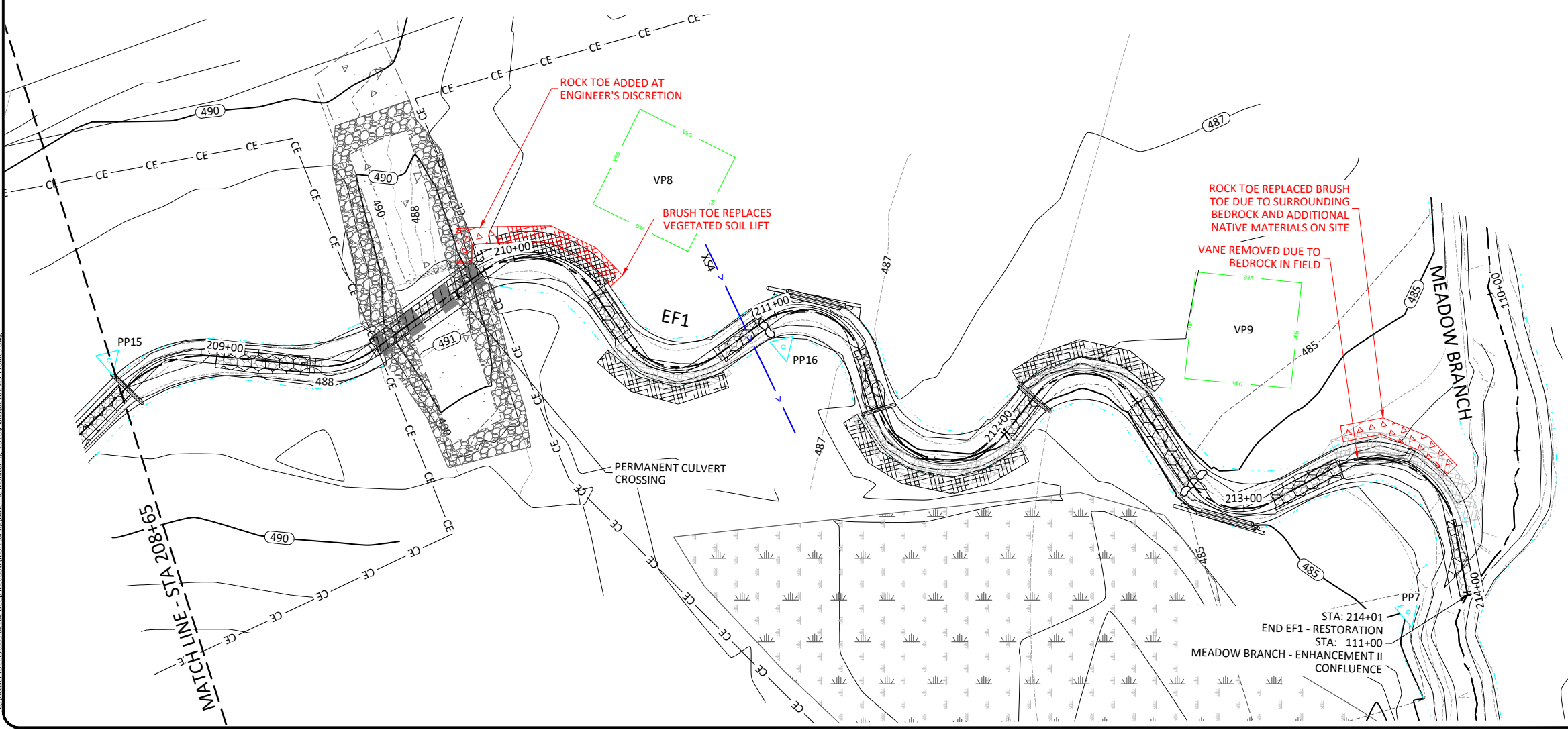
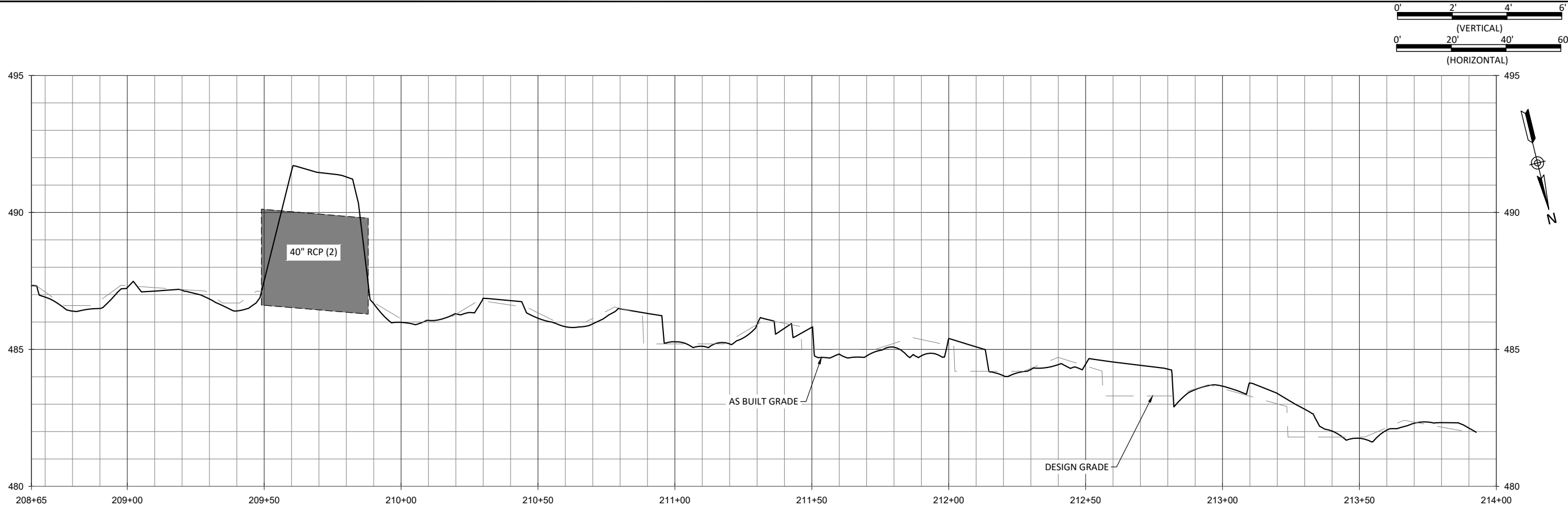
D:\ActiveProjects\005-02162-Deep Meadow\Monitor\Baseline\_Monitoring\_2020\Plan\02162-48\_Profile.dwg



**WILDLANDS**  
ENGINEERING, INC.  
1465 N. WILSON ROAD  
CHARLOTTE, NC 28203  
Tel: 704.332.7754  
Fax: 704.332.3306  
Firm License No. F-0831

Professional Engineer  
Seal No. 029349  
Expiration Date 3-1-20

---

Deep Meadow Mitigation Site Record Drawings  
Union County, North Carolina

EF1  
Stream Plan and Profile

---

Date: March 6, 2020  
Job Number: 005-02162  
Project Engineer: ASE  
Drawn By: HCB  
Checked By: JCK

Revisions:

1.9

Sheet

March 6, 2020

D:\ActiveProjects\005-02162-Deep Meadow\Monitor\Baseline\_Monitoring\_2020\Plan\02162-48-Profiles.dwg

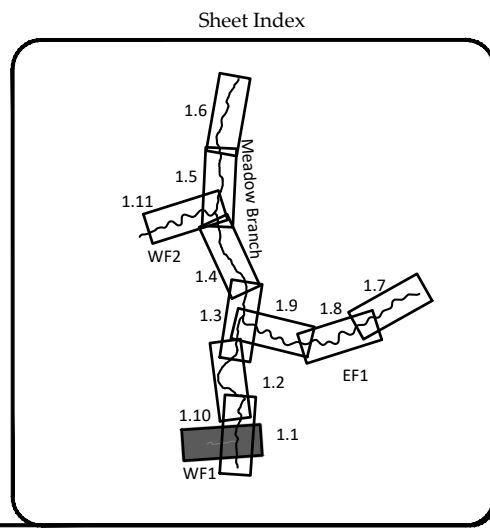
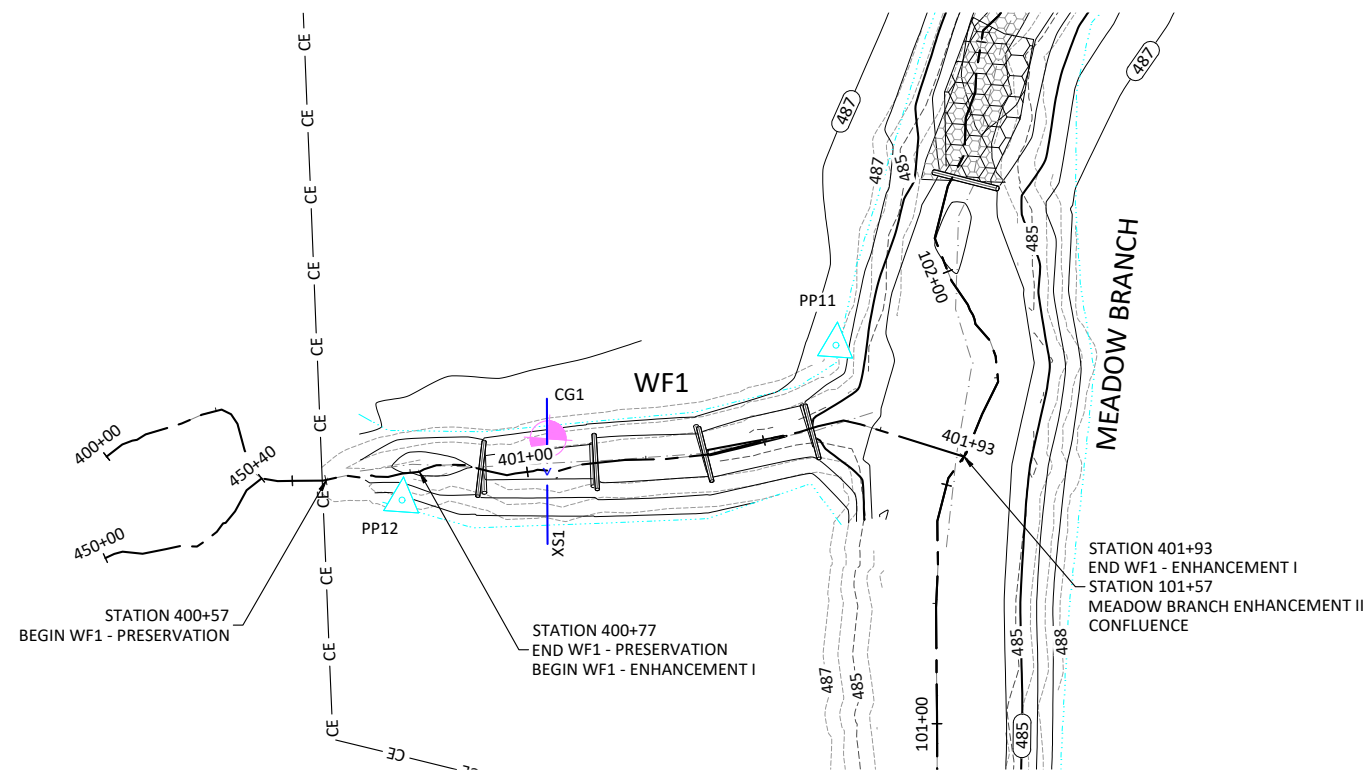
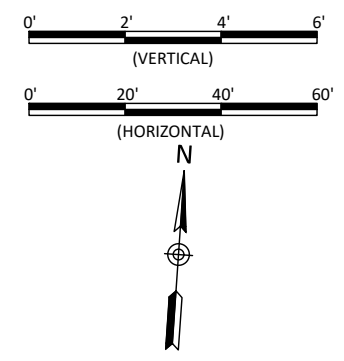
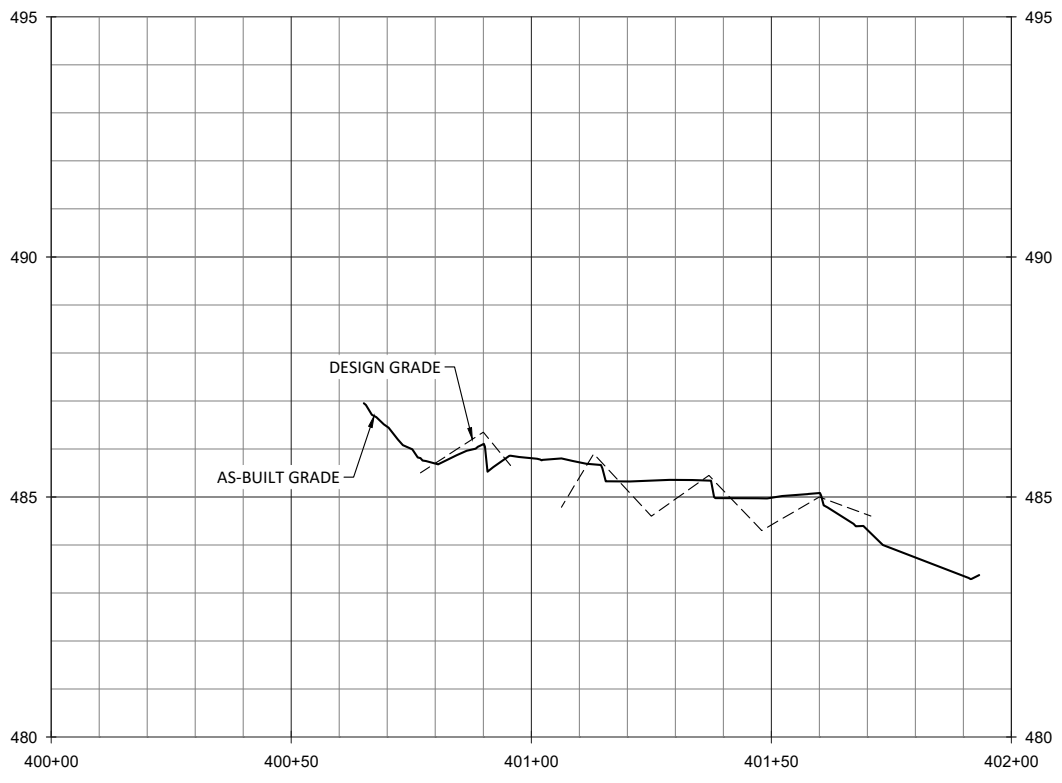

Deep Meadow Mitigation Site Record Drawings  
 Union County, North Carolina

WF1  
 Stream Plan and Profile

Revisions:

Date:	March 6, 2020
Job Number:	005-02162
Project Engineer:	ASE
Drawn By:	HCB
Checked By:	JCK

1.10

Sheet

**WILDLANDS**  
 ENGINEERING  
 1485 N. GARDNER ST., 104  
 CHARLOTTE, NC 28203  
 Tel: 704.332.7754  
 Fax: 704.332.3306  
 Firm License No. F-0831



March 6, 2020  
D:\ActiveProjects\005-02162-Deep Meadow Monitor\Baseline\_Monitoring\_2020\Plan\02162-48-Profiles.dwg

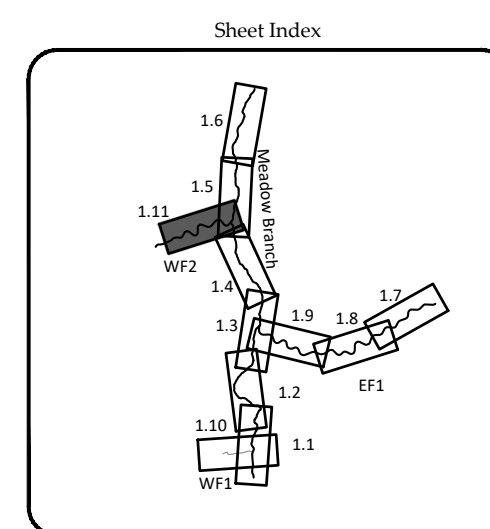
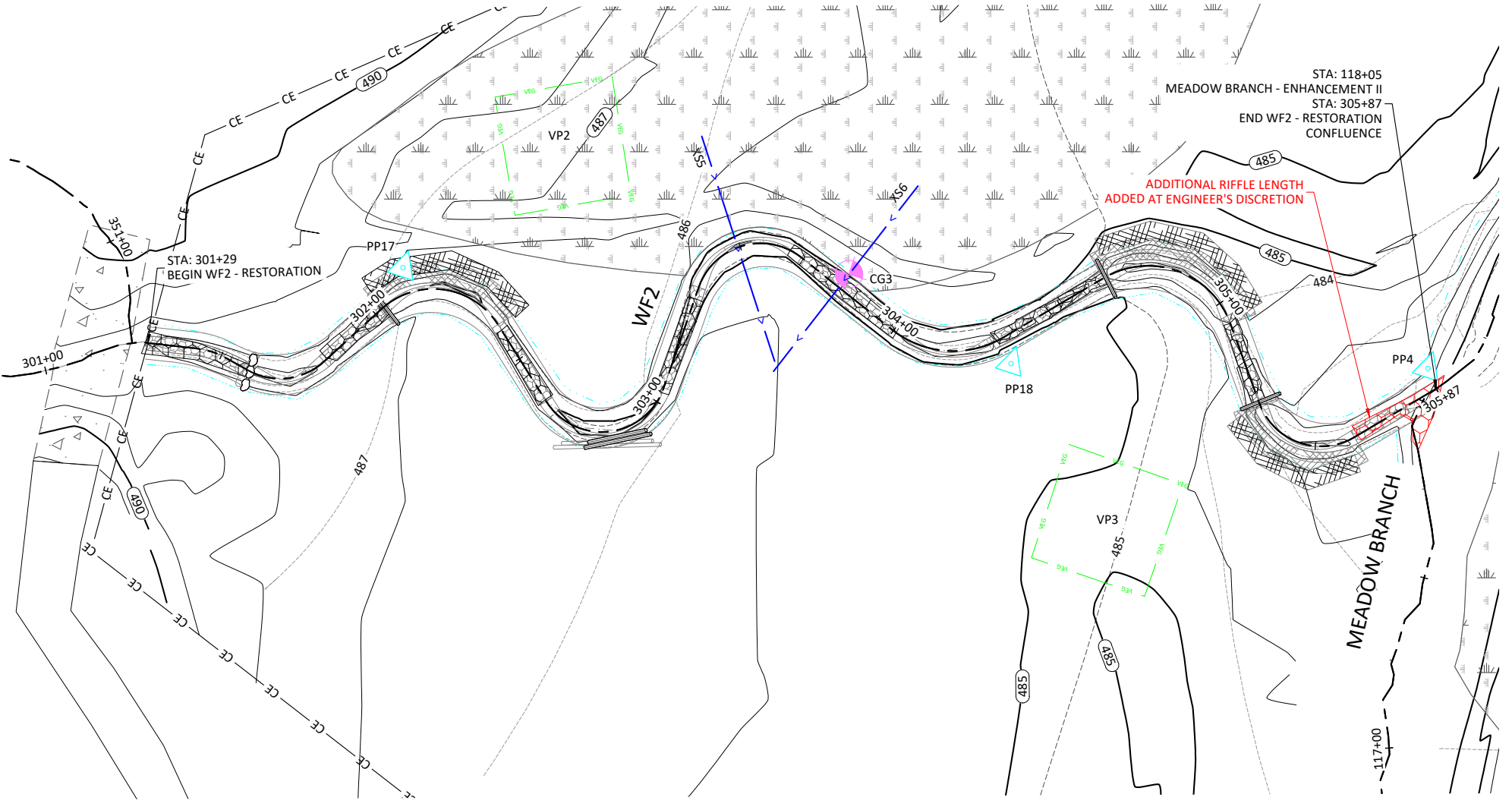
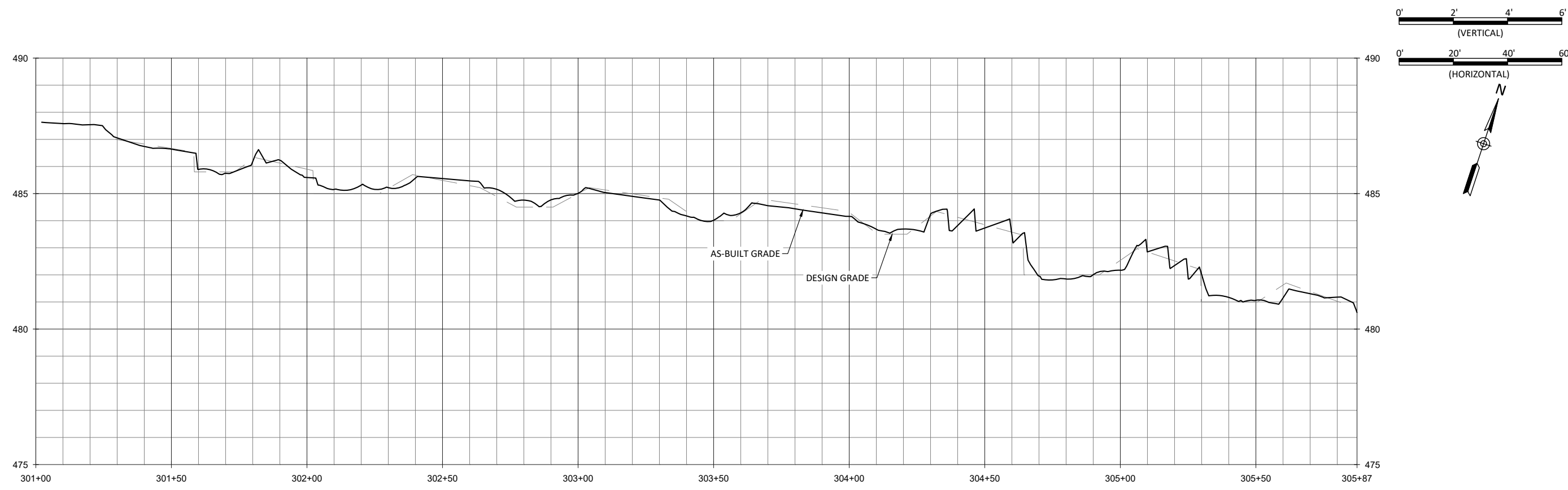

Deep Meadow Mitigation Site Record Drawings  
Union County, North Carolina

WF2  
Stream Plan and Profile

Date:	March 6, 2020
Job Number:	005-02162
Project Engineer:	ASE
Drawn By:	HCB
Checked By:	JCK

Revisions:



1.11

Sheet

WILDLANDS  
ENGINEERING, INC.  
1405 N. GREENWAY, SUITE 104  
CHARLOTTE, NC 28203  
Tel: 704.332.7754  
Fax: 704.332.3306  
Firm License No. F-0831

March 6, 2020

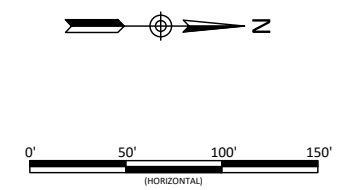
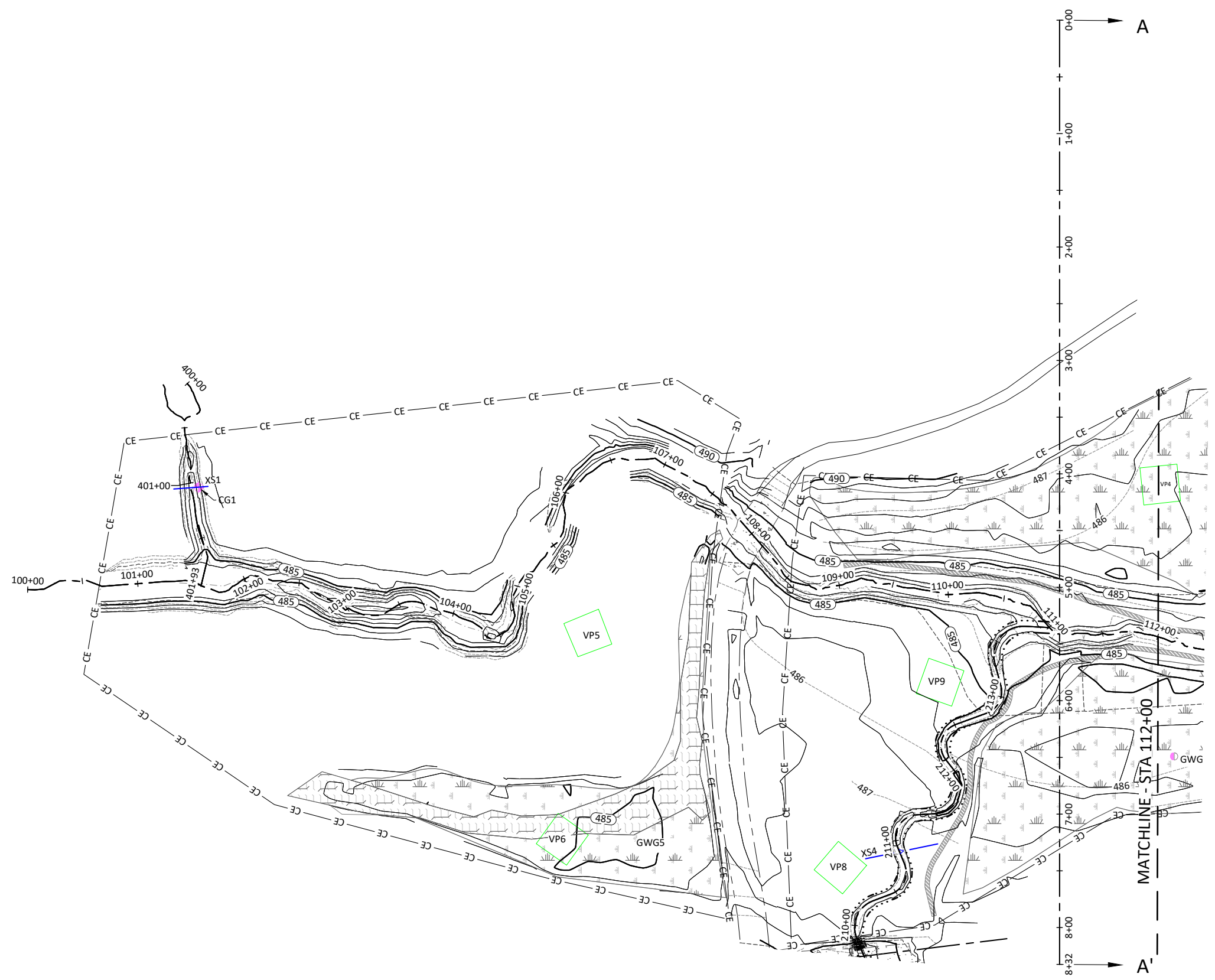
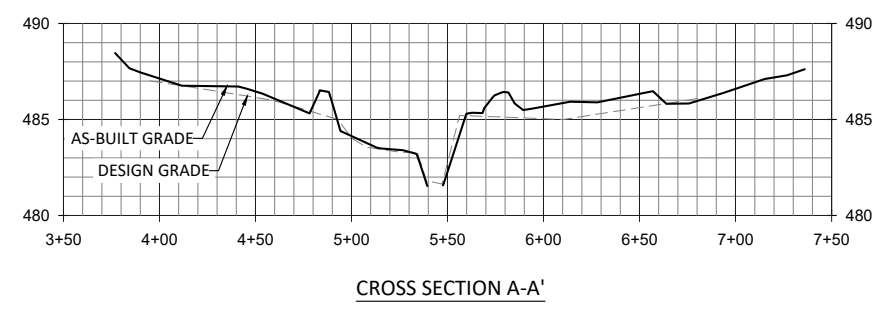
D:\ActiveProjects\005-02162-Deep Meadow\Monitor\Baseline\_Monitoring\_2020\Plan\02162-A8-Wetland\_Gradings.dwg



Deep Meadow Mitigation Site Record Drawings  
 Union County, North Carolina  
 Wetland Grading

Revisions:



Date: March 6, 2020  
 Job Number: 005-02162  
 Project Engineer: ASE  
 Drawn By: HCB  
 Checked By: JCK

2.1

Sheet

**WILDLANDS**  
 ENVIRONMENTAL ENGINEERING  
 1485 W. GARDNER STREET, 104  
 CHARLOTTE, NC 28203  
 Tel: 704.332.7754  
 Fax: 704.332.3306  
 Firm License No. F-0831

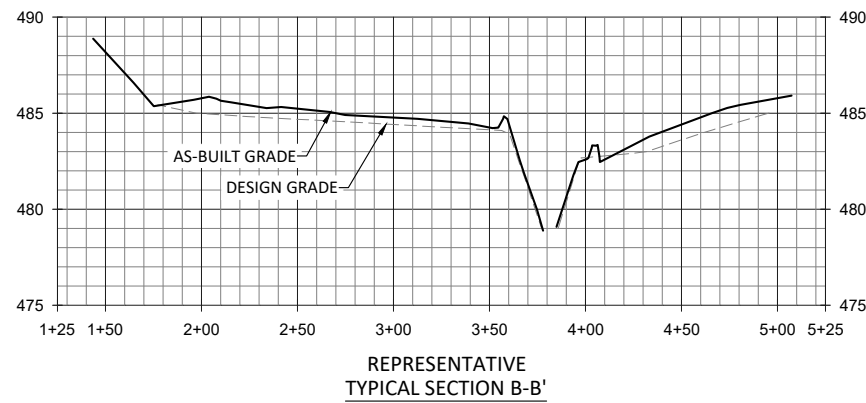
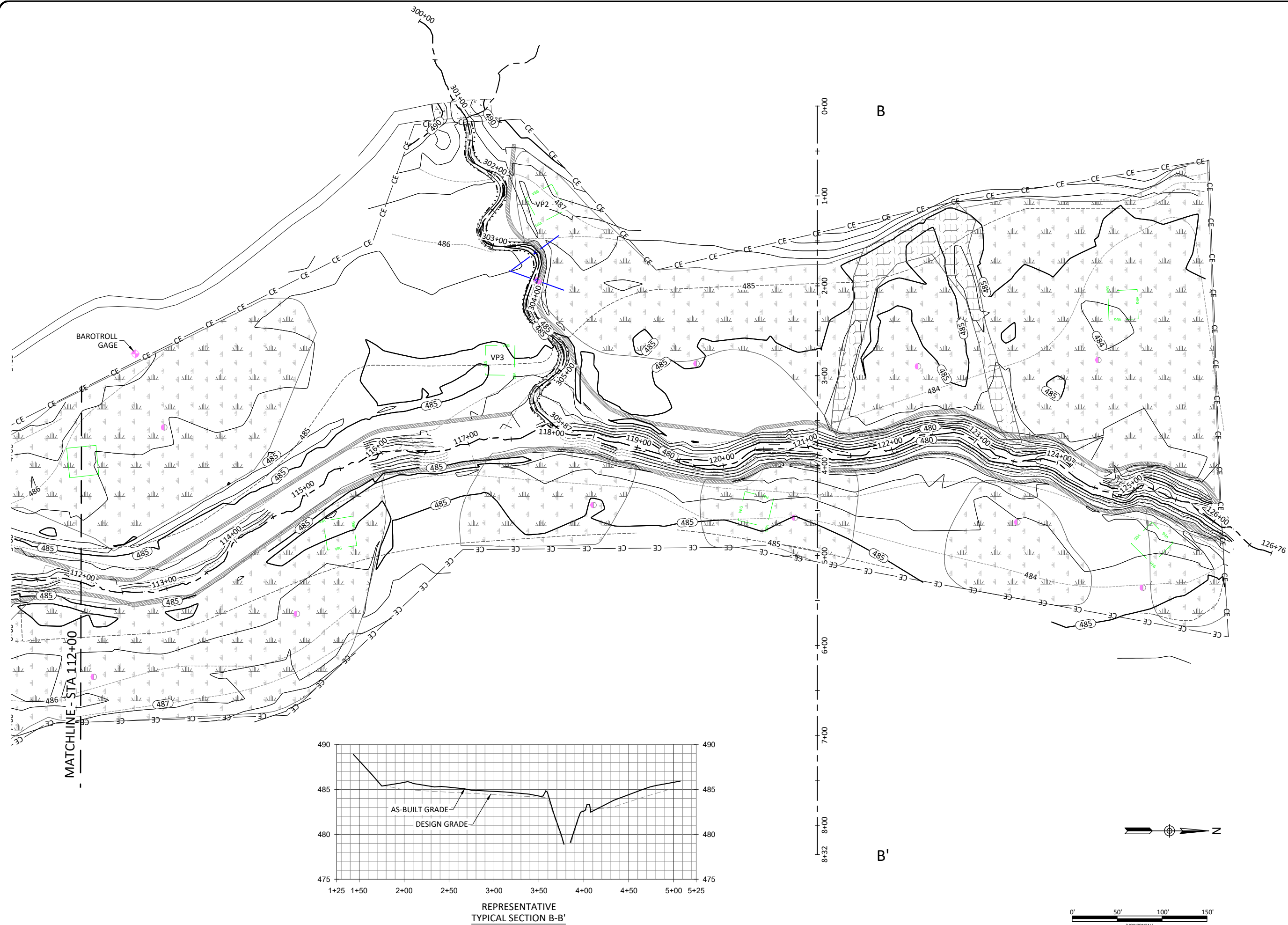



Deep Meadow Mitigation Site Record Drawings  
 Union County, North Carolina  
 Wetland Grading

Revisions:

Date: March 6, 2020  
 Job Number: 005-02162  
 Project Engineer: ASE  
 Drawn By: HCB  
 Checked By: JCK

2.2



D:\ActiveProjects\005-02162-DeepMeadow\Monitor\Baseline\_Monitoring\_2020\Plants\02162-4B-Planting.dwg March 6, 2020

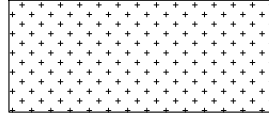

Buffer Planting Zone			
Bare Root			
Species	Common Name	Spacing	% of Stems
<i>Quercus phellos</i>	Willow Oak	12 ft.	10%
<i>Platanus occidentalis</i>	Sycamore	12 ft.	20%
<i>Betula nigra</i>	River Birch	12 ft.	15%
<i>Liriodendron tulipifera</i>	Tulip Poplar	12 ft.	15%
<i>Fraxinus pennsylvanica</i>	Green Ash	12 ft.	10%
Alternatives			
<i>Alnus serrulata</i>	Tag Alder	12 ft.	10%
<i>Quercus pagoda</i>	Cherrybark Oak	12 ft.	10%
<i>Quercus michauxii</i>	Swamp Chestnut Oak	12 ft.	10%
Total			100%

Note:  
Permanent Riparian seeding in  
all disturbed areas within  
Conservation Easement

Permanent Riparian Seeding				
Pure Live Seed (20 lbs/ acre)				
Approved Date	Species Name	Common Name	Stratum	Density (lbs/acre)
All Year	<i>Panicum rigidulum</i>	Redtop Panicgrass	Herb	1.5
All Year	<i>Agrostis hyemalis</i>	Winter Bentgrass	Herb	4.0
All Year	<i>Chasmanthium latifolium</i>	River Oats	Herb	2.0
All Year	<i>Rudbeckia hirta</i>	Blackeyed Susan	Herb	1.0
All Year	<i>Coreopsis lanceolata</i>	Lanceleaf Coreopsis	Herb	1.0
All Year	<i>Carex vulpinoidea</i>	Fox Sedge	Herb	3.0
All Year	<i>Panicum clandestinum</i>	Deertongue	Herb	3.5
All Year	<i>Elymus virginicus</i>	Virginia Wild Rye	Herb	2.0
All Year	<i>Asclepias syrica</i>	Common Milkweed	Herb	0.2
All Year	<i>Baptisia australis</i>	Blue False Indigo	Herb	0.2
All Year	<i>Gaillardia pulchella</i>	Annual Gaillardia	Herb	1.0
All Year	<i>Echinacea purpurea</i>	Pale Purple Coneflower	Herb	0.6



Wetland Bare Root Planting			
Scientific Name	Common Name	Spacing	%
<i>Platanus occidentalis</i>	Sycamore	12 ft.	15
<i>Quercus phellos</i>	Willow Oak	12 ft.	15
<i>Betula nigra</i>	River Birch	12 ft.	10
<i>Quercus michauxii</i>	Swamp Chestnut Oak	12 ft.	10
<i>Diospyros virginiana</i>	Persimmon	12 ft.	10
<i>Populus deltoides</i>	Eastern Cottonwood	12 ft.	10
<i>Cephalanthus occidentalis</i>	Buttonbush	12 ft.	10
<i>Lindera benzoin</i>	Spice Bush	12 ft.	10
<i>Cornus amomum</i>	Silky Dogwood	12 ft.	10
Total			100%

Temporary Seeding		
Approved Date	Type	Planting Rate (lbs/acre)
Jan 1 – May 1	Rye Grain ( <i>Secale cereale</i> )	120
	Ground Agricultural Limestone	2,000
	10-10-10 Fertilizer	750
	Straw Mulch	4,000
May 1 – Aug 15	German Millet ( <i>Setaria italica</i> )	40
	Ground Agricultural Limestone	2,000
	10-10-10 Fertilizer	750
	Straw Mulch	4,000
Aug 15 – Dec 30	Rye Grain ( <i>Secale cereale</i> )	120
	Ground Agricultural Limestone	2,000
	10-10-10 Fertilizer	1,000
	Straw Mulch	4,000

Streambank Planting Zone			
Live Stakes			
Species	Common Name	Spacing	% of Stems
<i>Salix nigra</i>	Black Willow	6 ft.	10%
<i>Cornus amomum</i>	Silky Dogwood	6 ft.	35%
<i>Salix sericea</i>	Silky Willow	6 ft.	40%
<i>Physocarpus opulifolius</i>	Ninebark	6 ft.	15%
Total			100%
Herbaceous Plugs			
<i>Juncus effusus</i>	Common Rush	5 ft.	40%
<i>Carex alata</i>	Broadwing Sedge	5 ft.	40%
<i>Panicum virgatum</i>	Switchgrass	5 ft.	20%
Total			100%



Deep Meadow Mitigation Site Record Drawings  
Union County, North Carolina

Planting List

Revisions:

Date: March 6, 2020  
Job Number: 005-02162  
Project Engineer: ASE  
Drawn By: HCB  
Checked By: JCK

D:\ActiveProjects\005-02162-Deep Meadow\Monitor\Baseline\_Monitoring\_2020\Plans\02162-08\_Planting.dwg  
 March 6, 2020

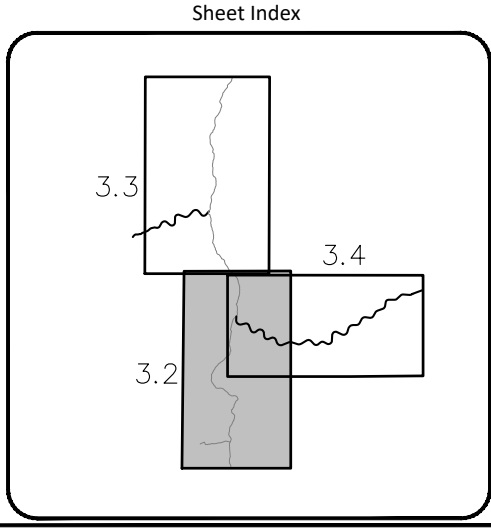
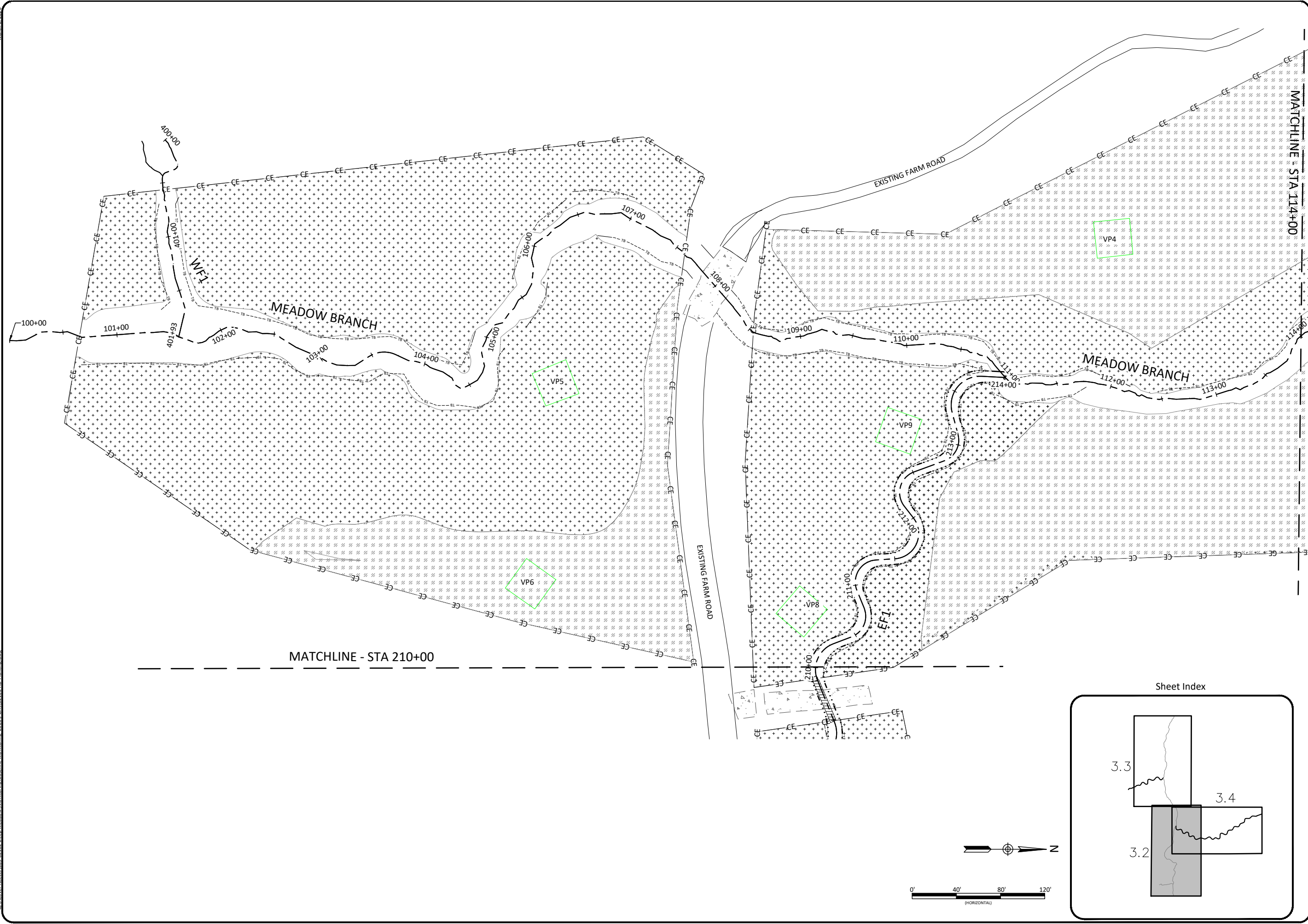

**Deep Meadow Mitigation Site Record Drawings**  
**Union County, North Carolina**

Meadow Branch and WF1  
 Planting Plan

Date:	March 6, 2020
Job Number:	005-02162
Project Engineer:	ASE
Drawn By:	HCB
Checked By:	JCK

Revisions:

3.2

Sheet



**WILDLANDS**  
 ENGINEERING  
 1405 E. WILSON ROAD  
 CHARLOTTE, NC 28203  
 Tel: 704.332.7754  
 Fax: 704.332.3306  
 Firm License No. F-0831

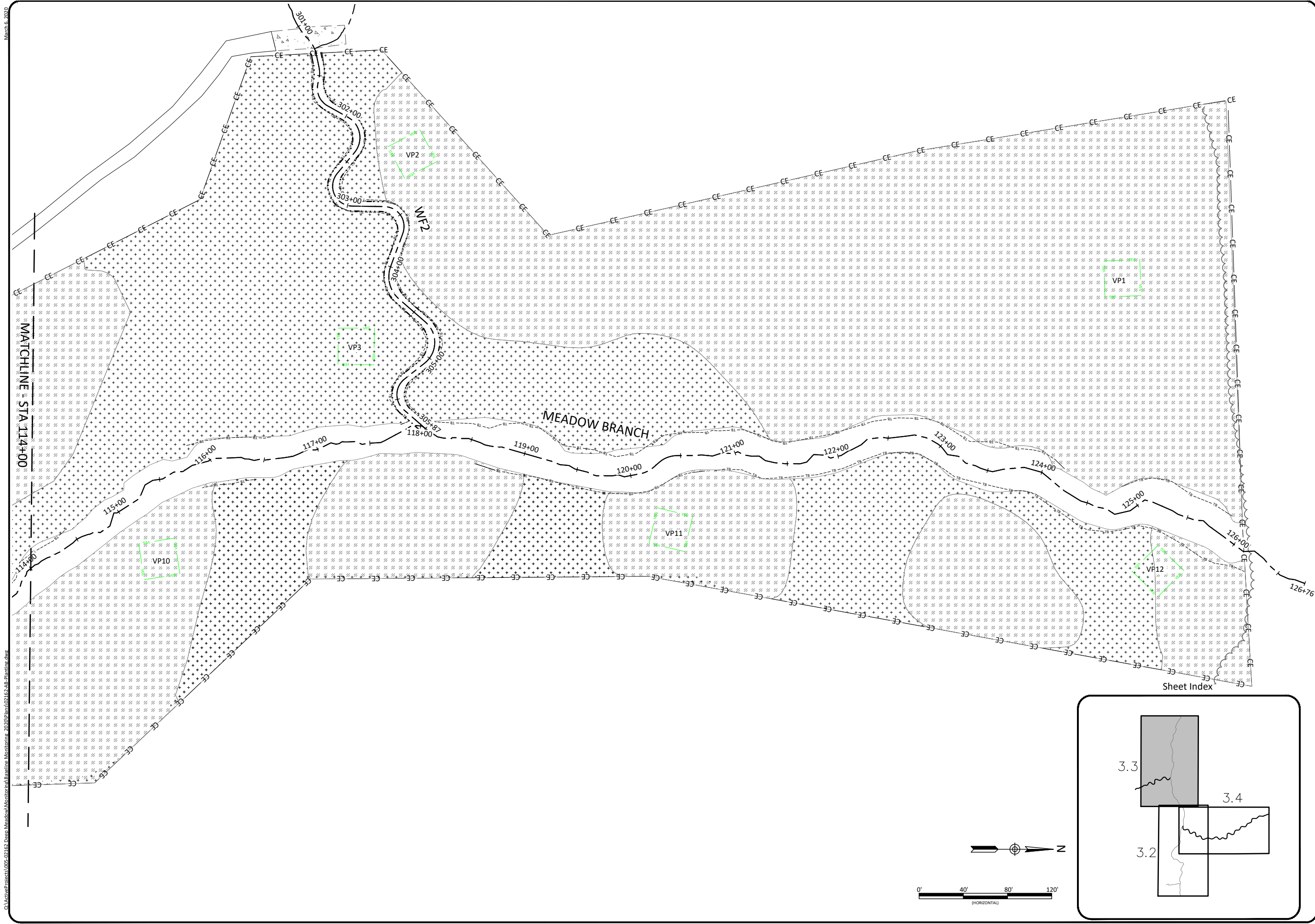

March 6, 2020  
 D:\ActiveProjects\005-02162-Deep Meadow\Monitor\Baseline\_Monitoring\_2020\Plans\02162-AB\_Planting.dwg

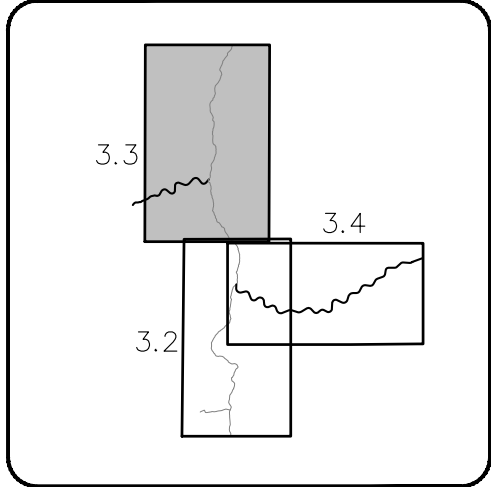
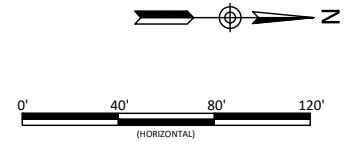

**Deep Meadow Mitigation Site Record Drawings**  
**Union County, North Carolina**  
 Meadow Branch and WF2  
 Planting Plan

Revisions:

Date: March 6, 2020  
 Job Number: 005-02162  
 Project Engineer: ASE  
 Drawn By: HCB  
 Checked By: JCK

3.3

Sheet



**WILDLANDS**  
 ENGINEERING, INC.  
 1406 E. WILSON ROAD  
 CHARLOTTE, NC 28203  
 Tel: 704.332.7754  
 Fax: 704.332.3306  
 Firm License No. F-0831

March 6, 2020  
D:\ActiveProjects\005-02162-Deep Meadow\Monitor\Baseline\_Monitoring\_2020\Plans\02162-48-Planting.dwg

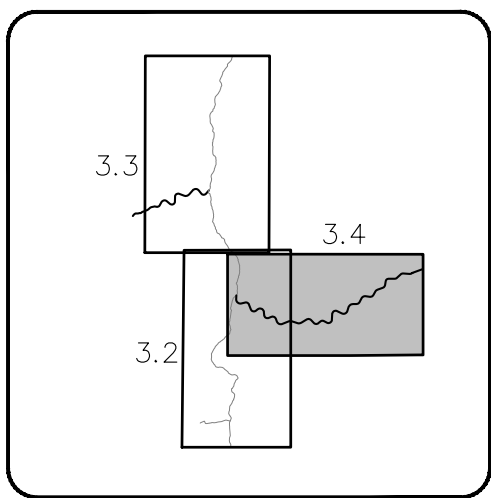
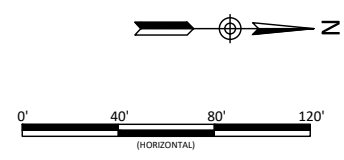

Deep Meadow Mitigation Site Record Drawings  
Union County, North Carolina

EF1  
Planting Plan

Revisions:

No.	Description	By	Date

Date: March 6, 2020  
Job Number: 005-02162  
Project Engineer: ASE  
Drawn By: HCB  
Checked By: JCK

3.4

Sheet



**WILDLANDS**  
ENGINEERING, INC.  
1405 E. WILSON ROAD, SUITE 104  
CHARLOTTE, NC 28203  
Tel: 704.332.7754  
Fax: 704.332.3306  
Firm License No. F-0831