

09/08/2022

NC DEPARTMENT OF ENVIRONMENTAL QUALITY DIVISION OF MITIGATION SERVICES AS-BUILT PLANS NESBIT SITE

STATE	STATE PROJECT REFERENCE NO.	SHEET NO.	TOTAL SHEETS
N.C.	NESBIT SITE	1	

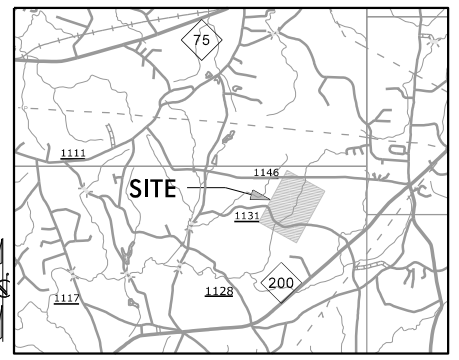

VICINITY MAP
Not to Scale

LOCATION: UNION COUNTY, NORTH CAROLINA

TYPE OF WORK: STREAM RESTORATION AND ENHANCEMENT (CLEARING, GRUBBING, GRADING, EROSION CONTROL AND PLANTING)

RECORD DRAWING

NOTE: GLEN BRANCH IS LOCATED IN A FEMA LIMITED DETAILED STUDY AREA. PROJECT TO BE CONSTRUCTED ACCORDING TO APPROVED CONSTRUCTION DOCUMENTS. ANY DEVIATIONS FROM THE PLANS WILL REQUIRE APPROVAL FROM THE ENGINEER AND FLOODPLAIN ADMINISTRATOR

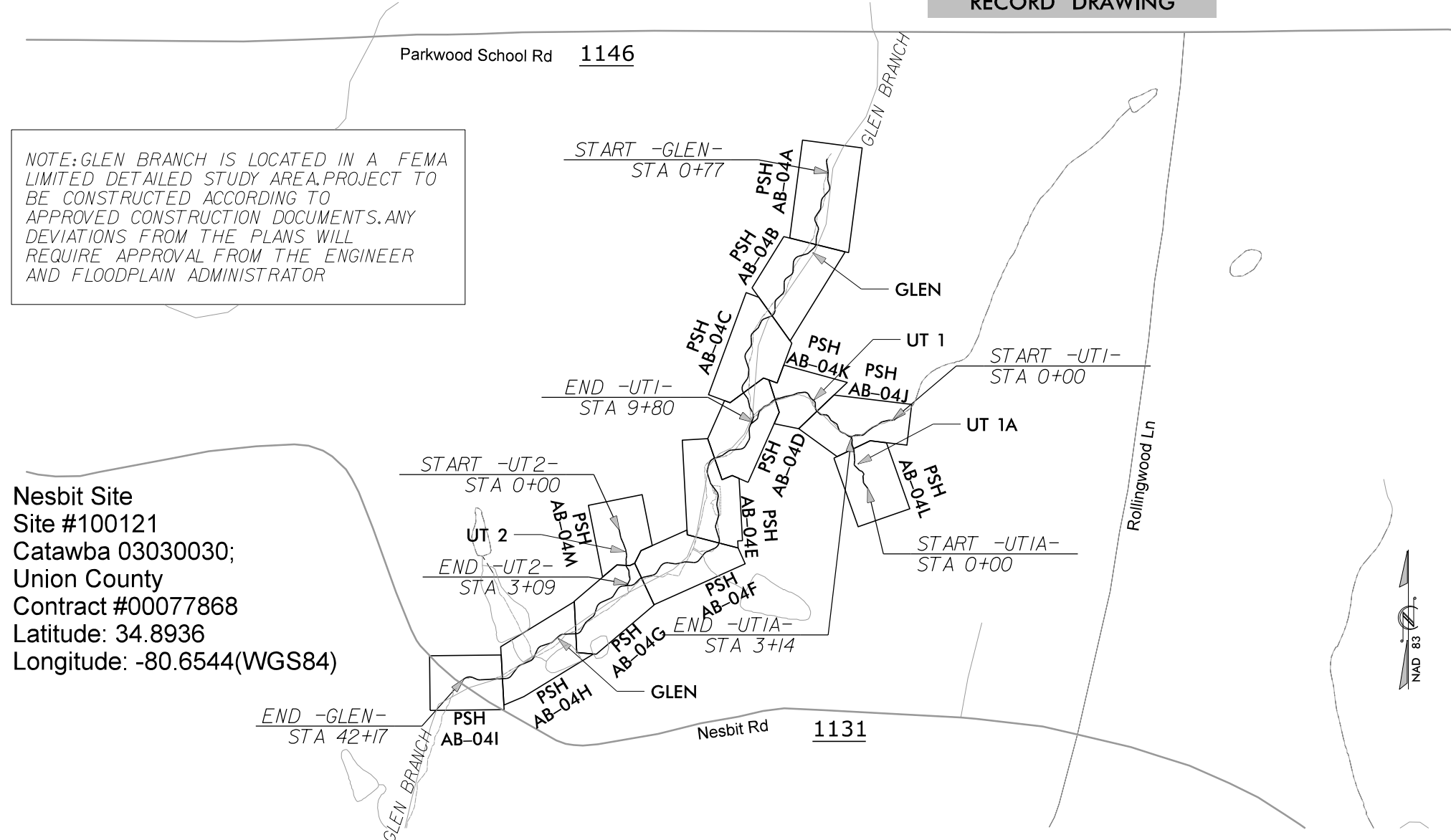

Nesbit Site
Site #100121
Catawba 03030030;
Union County
Contract #00077868
Latitude: 34.8936
Longitude: -80.6544(WGS84)

SURVEYORS CERTIFICATION(S)

Surveyor's disclaimer: No attempt was made to locate any cemeteries, wetlands, hazardous material sites, underground utilities or any other features above, or below ground other than those shown. However, no visible evidence of cemeteries or utilities, aboveground or otherwise, was observed by the undersigned (other than those shown).

I certify that the survey is of an existing parcel or parcels of land or one or more existing easements and does not create a new street or change an existing street.

I, JOHN A. RUDOLPH, certify that this plat was prepared under my supervision from an actual field survey made under my supervision, of as-built conditions.

That the boundaries not surveyed are clearly indicated as such and were plotted from information as referenced hereon: That the ratio of precision as calculated was 1:7,500+ and that the global navigational satellite system (GNSS) was used to perform this survey and the following information was used:

Class of Survey: CLASS B (HORIZONTAL) CLASS B (VERTICAL)
Positional Accuracy: 0.12 feet (HORIZONTAL)
Type of GPS field procedure: RTK
Dates of survey: May and June 2022
Datum/Epoch: NAD 1983(2011)
Published/Fixed Control Use: OPUS
Geoid Model: 2012B CONUS
Combined Grid Factor: 0.99995565 GROUND TO GRID
Units: US SURVEY FEET

That this plat meets the requirements of the standards of practice for land surveying in North Carolina. Witness my hand and seal this 29th day of June, 2022.

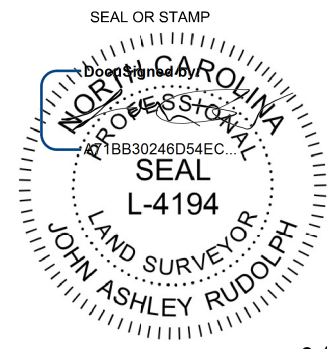

9/1/2022
Professional Land Surveyor License Number L-4194

CONTRACT: NESBIT SITE

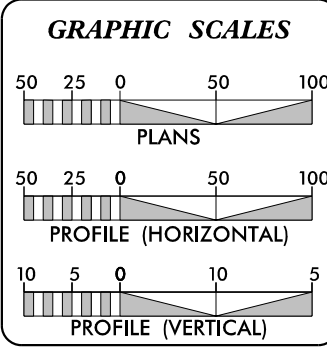

PROPOSED LENGTH OF -GLEN- = 4140	PROPOSED LENGTH OF -UT 1A- = 314		
PROPOSED LENGTH OF -UT 1- = 980	PROPOSED LENGTH OF -UT 2- = 309		
TOTAL STREAM LENGTHS (LF) = 5743			
RESTORATION LEVEL	STREAM (linear footage)	RIPARIAN WETLAND (acreage)	NONRIPARIAN WETLAND (acreage)
RESTORATION	4801	5.338 (Reestablishment)	0.000
ENHANCEMENT I	316	1.789 (Rehabilitation)	0.000
ENHANCEMENT II	541	0.000	0.000
PRESERVATION	0	0.000	0.000
TOTALS	5658	7.127	0.000
MITIGATION UNITS	5199.756 SMUs	6.531 RIPARIAN WMUs	NONRIPARIAN WMUs

Axiom Environmental
218 Snow Ave
Raleigh, NC 27603

GRANT LEWIS
PROJECT DESIGNER

Restoration Systems
1101 Haynes St.
Suite 211
Raleigh, NC 27604

WORTH CREECH
SITE CONSTRUCTION MANAGER

Prepared in the Office of:
SUNGATE DESIGN GROUP, P.A.

905 JONES FRANKLIN ROAD
RALEIGH, NORTH CAROLINA 27606
TEL (919) 859-2243
ENG FIRM LICENSE NO. C-890

JOSHUA G. DALTON, P.E.
PROJECT ENGINEER

DocuSigned by:
Joshua Dalton
10887D8C14994C3...
26971

ENGINEER
JOSHUA G. DALTON

9/1/2022
DATE:

9/1/2022 Nesbit_Rdy_PSH_AB-01.dgn jnarvey

CONVENTIONAL PLAN SHEET SYMBOLS

Note: Not to Scale

*S.U.E. = Subsurface Utility Engineering

BOUNDARIES AND PROPERTY:

State Line	-----
County Line	-----
Township Line	-----
City Line	-----
Reservation Line	-----
Property Line	-----
Existing Iron Pin	EP
Computed Property Corner	-----
Property Monument	EDM
Parcel/Sequence Number	(23)
Existing Fence Line	-x-x-x-
Proposed Fence Gate	□
Proposed Barbed Wire Fence	◇
Existing Wetland Boundary	---WLB---
Proposed Wetland Boundary	---WLB---
Existing Endangered Animal Boundary	---EAB---
Existing Endangered Plant Boundary	---EPB---
Existing Historic Property Boundary	---HPB---

BUILDINGS AND OTHER CULTURE:

Gas Pump Vent or U/G Tank Cap	○
Sign	○
Well	W
Small Mine	⊗
Foundation	□
Area Outline	□
Cemetery	⊕
Building	□
School	□
Church	⊕
Dam	□

HYDROLOGY:

Stream or Body of Water	-----
Hydro, Pool or Reservoir	□
Jurisdictional Stream	---JS---
Buffer Zone 1	---BZ 1---
Buffer Zone 2	---BZ 2---
Flow Arrow	←
Disappearing Stream	-----
Spring	○
Wetland	---WLB---
Proposed Lateral, Tail, Head Ditch	-----

RIGHT OF WAY & PROJECT CONTROL:

Secondary Horiz and Vert Control Point	◆
Primary Horiz Control Point	○
Primary Horiz and Vert Control Point	●

Exist Permanent Easment Pin and Cap	◇
New Permanent Easment Pin and Cap	◆
Vertical Benchmark	⊕
Existing Right of Way Marker	△
Existing Right of Way Line	-----
New Right of Way Line	-----
New Right of Way Line with Pin and Cap	◇
New Right of Way Line with Concrete or Granite RW Marker	△
New Control of Access Line with Concrete CA Marker	⊕
Existing Control of Access	⊕
New Control of Access	⊕
Existing Easement Line	---E---
New Conservation Easement	---E---
New Temporary Drainage Easement	---TDE---
New Permanent Drainage Easement	---PDE---
New Permanent Drainage / Utility Easement	---DUE---
New Permanent Utility Easement	---PUE---
New Temporary Utility Easement	---TUE---
New Aerial Utility Easement	---AUE---

ROADS AND RELATED FEATURES:

Existing Edge of Pavement	-----
Existing Curb	-----
Proposed Slope Stakes Cut	---C---
Proposed Slope Stakes Fill	---F---
Proposed Curb Ramp	CR
Existing Metal Guardrail	-----
Proposed Guardrail	-----
Existing Cable Guiderail	-----
Proposed Cable Guiderail	-----
Equality Symbol	⊕
Pavement Removal	⊗

VEGETATION:

Single Tree	⊕
Single Shrub	⊕
Hedge	-----
Woods Line	-----
Orchard	⊕
Vineyard	Vineyard

EXISTING STRUCTURES:

MAJOR:	
Bridge, Tunnel or Box Culvert	CONC
Bridge Wing Wall, Head Wall and End Wall	CONC WW
MINOR:	
Head and End Wall	CONC HW

Pipe Culvert	-----
Footbridge	-----
Drainage Box: Catch Basin, DI or JB	CB
Paved Ditch Gutter	-----
Storm Sewer Manhole	⊕
Storm Sewer	-----

UTILITIES:

POWER:	
Existing Power Pole	●
Proposed Power Pole	○
Existing Joint Use Pole	●
Proposed Joint Use Pole	○
Power Manhole	⊕
Power Line Tower	⊗
Power Transformer	⊗
U/G Power Cable Hand Hole	-----
H-Frame Pole	●
U/G Power Line LOS B (S.U.E.*)	-----
U/G Power Line LOS C (S.U.E.*)	-----
U/G Power Line LOS D (S.U.E.*)	-----

TELEPHONE:

Existing Telephone Pole	●
-------------------------	---

WATER:

Water Manhole	⊕
Water Meter	○
Water Valve	⊗
Water Hydrant	⊕
U/G Water Line LOS B (S.U.E.*)	-----
U/G Water Line LOS C (S.U.E.*)	-----
U/G Water Line LOS D (S.U.E.*)	-----
Above Ground Water Line	A/G Water

GAS:

Gas Valve	◇
Gas Meter	⊕
U/G Gas Line LOS B (S.U.E.*)	-----
U/G Gas Line LOS C (S.U.E.*)	-----
U/G Gas Line LOS D (S.U.E.*)	-----
Above Ground Gas Line	A/G Gas

SANITARY SEWER:

Sanitary Sewer Manhole	⊕
Sanitary Sewer Cleanout	⊕
U/G Sanitary Sewer Line	-----
Above Ground Sanitary Sewer	A/G Sanitary Sewer
SS Forced Main Line LOS B (S.U.E.*)	-----
SS Forced Main Line LOS C (S.U.E.*)	-----

SS Forced Main Line LOS D (S.U.E.*)	-----
-------------------------------------	-------

MISCELLANEOUS:

Utility Pole	●
Utility Pole with Base	□
Utility Located Object	○
Utility Traffic Signal Box	⊕
Utility Unknown U/G Line LOS B (S.U.E.*)	-----
U/G Tank; Water, Gas, Oil	□
Underground Storage Tank, Approx. Loc.	UST
A/G Tank; Water, Gas, Oil	□
Geoenvironmental Boring	⊕
U/G Test Hole LOS A (S.U.E.*)	⊕
Abandoned According to Utility Records	AATUR
End of Information	E.O.I.
Existing Contour Major	-----
Existing Contour Minor	-----
Contour Interval = 1 ft	

Riffle Rip Rap	⊗
----------------	---

Log Vane	-----
----------	-------

Log Cross Vane	-----
----------------	-------

Step Pool Structure	-----
---------------------	-------

Stream Plug	⊗
-------------	---

Floodplain Interceptor	-----
------------------------	-------

Proposed Fence	-----
----------------	-------

Limits of Disturbance	LOD
-----------------------	-----

AS-BUILT:

Stream Centerline	-----
-------------------	-------

Stream Top of Bank	-----
--------------------	-------

Stream Gauge	○
--------------	---

Groundwater Gauge	#
-------------------	---

Benthic & Water Quality Station	1
---------------------------------	---

Origin Point on CVS Plots	⊕
---------------------------	---

CVS Plots	#
-----------	---

Cross Section	XS-10R
---------------	--------

Adjusted Stream Structure	-----
---------------------------	-------

Not Constructed	-----
-----------------	-------

SURVEY INFORMATION PROPERTY/
EASEMENT PROVIDED BY:
K2 DESIGN GROUP, P.A.
5688 U.S. HIGHWAY 70 EAST
GOLDSBORO, NC 27534

Parkwood School Rd
1146

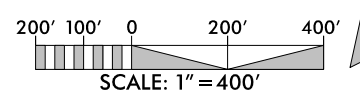

HORIZONTAL DATUM: NAD 83 (2011)
VERTICAL DATUM: NAVD 1988

NAD 83

— CE — CE — CONSERVATION EASEMENT

GLEN BRANCH

GLEN BRANCH

GLEN

UT 1

UT 1A

CROSSING

UT 2

GLEN

Nesbit Rd

1131

Rollingwood Ln

60' WIDE NON-EXCLUSIVE ACCESS EASEMENT

9/1/2022
Nesbit Rd.dwg_PSH_AB-03.dgn

SUNGATE DESIGN GROUP, P.A.
 845 GILES FARM LANE ROAD
 BAYLOR UNIVERSITY CAMPUS
 TEL: (919) 855-2243
 ENG FIRM LICENSE NO. C-890

Axiom Environmental, Inc.

© 2022 SUNGATE DESIGN GROUP, P.A. THIS DRAWING AND ALL REPRODUCTIONS OF IT ARE THE SOLE PROPERTY OF SDG. REPRODUCTION OR OTHER USES OF THIS DRAWING WITHOUT WRITTEN CONSENT OF SDG IS NOT PERMITTED.

**NESBIT
UNION COUNTY, NC
EASEMENT**

PROJECT # :
 DRAWING NAME:
 DATE: 2022
 DRAWN BY: JRH
 REVIEWED BY: JGD
 REVISIONS:

SHEET NO.
AB-03

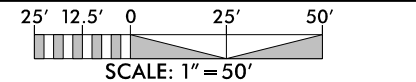

RECORD DRAWING

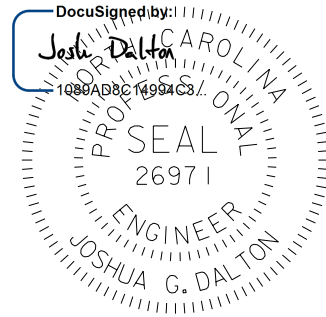

9/1/2022

DATE:
DOCUMENT NOT CONSIDERED FINAL
UNLESS ALL SIGNATURES COMPLETED

HORIZONTAL DATUM: NAD 83 (2011)
VERTICAL DATUM: NAVD 1988

SUNGATE DESIGN GROUP, P.A.
850 GILES FARM LANE ROAD
SUNGATE, NORTH CAROLINA 27866
TEL: (919) 855-2243
ENG FIRM LICENSE NO. C-980

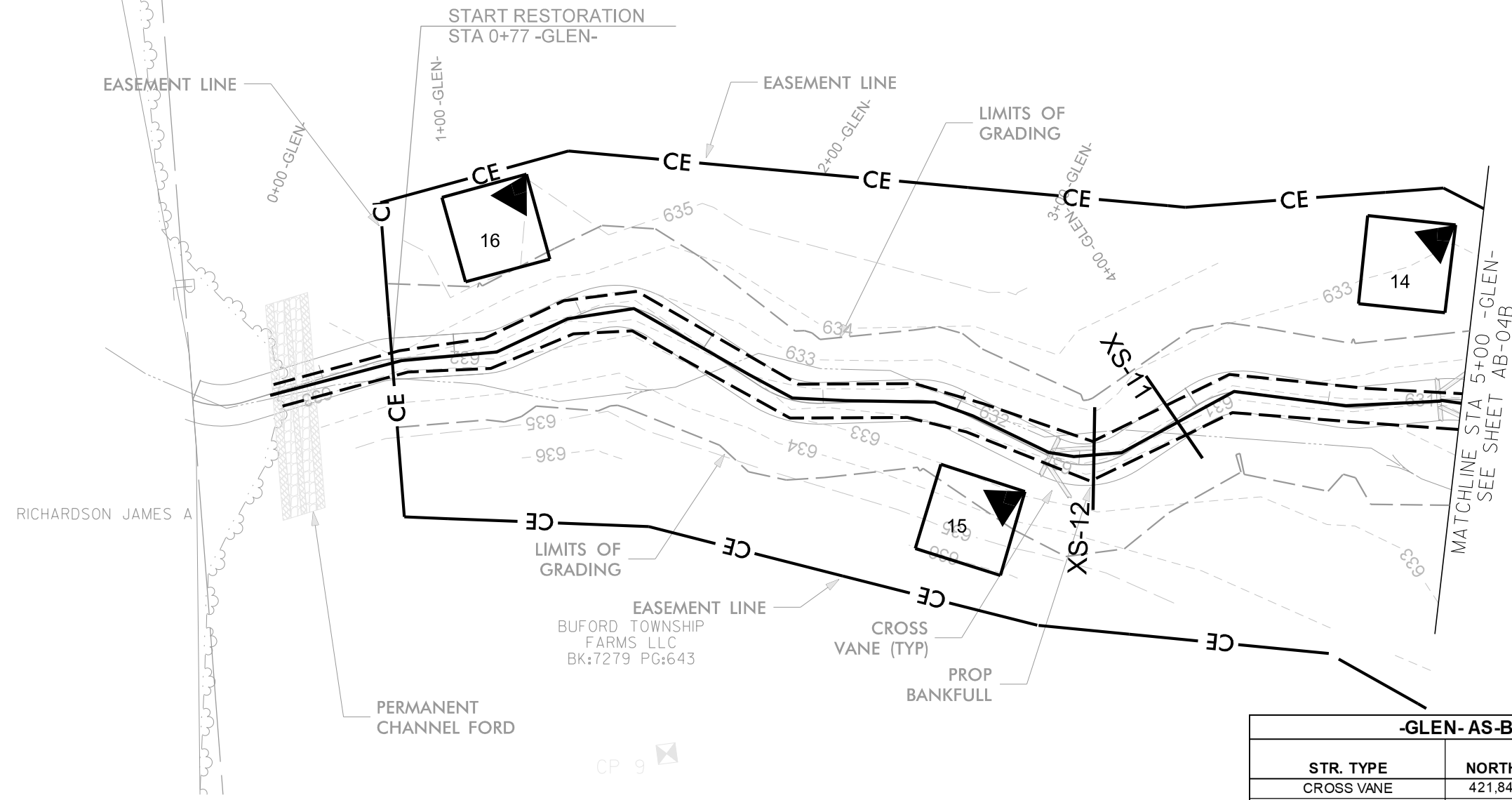
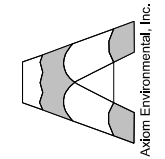

-GLEN- AS-BUILT STRUCTURE LOCATIONS				
STR. TYPE	NORTHING	EASTING	Prop Elevation	AB Survey Elevation
CROSS VANE	421,847.05	1,504,567.15	631.45	631.30
CROSS VANE	421,701.08	1,504,569.32	631.00	630.88

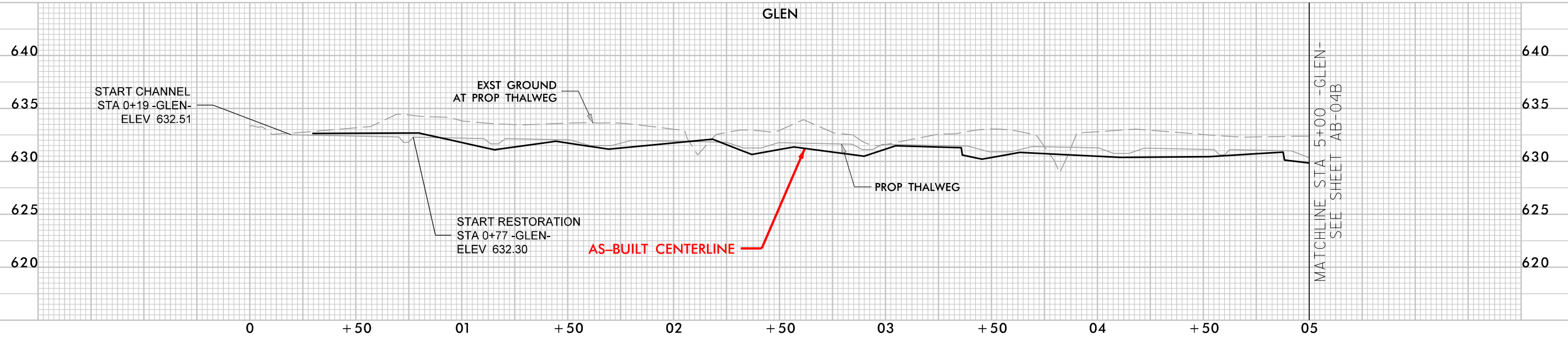

© 2022 SUNGATE DESIGN GROUP, P.A. THIS DRAWING AND ALL REPRODUCTIONS OF IT ARE THE SOLE PROPERTY OF SDG. REPRODUCTION OR OTHER USES OF THIS DRAWING WITHOUT WRITTEN CONSENT OF SDG IS NOT PERMITTED.

NESBIT
UNION COUNTY, NC
AS-BUILT STRUCTURES

PROJECT # :
DRAWING NAME:
DATE: 2022
DRAWN BY: JRH
REVIEWED BY: JGD
REVISIONS:

SHEET NO.
AB-04A

9/1/2022 Nesbit_Rdly_psh_AB-04A.dgn

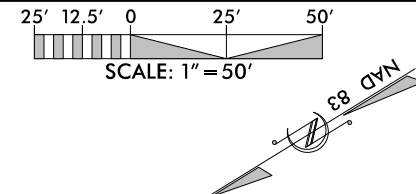

RECORD DRAWING

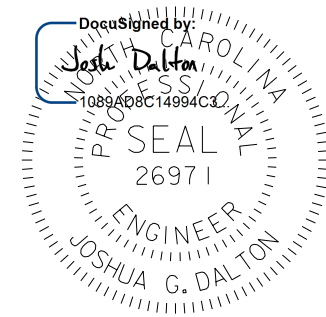

9/1/2022

DATE:
DOCUMENT NOT CONSIDERED FINAL
UNLESS ALL SIGNATURES COMPLETED

HORIZONTAL DATUM: NAD 83 (2011)
VERTICAL DATUM: NAVD 1988

SUNGATE DESIGN GROUP, P.A.
 855 GILES FRANKLIN ROAD
 SUNGATE, NORTH CAROLINA 27866
 TEL: (919) 855-2243
 ENG FIRM LICENSE NO. C-980

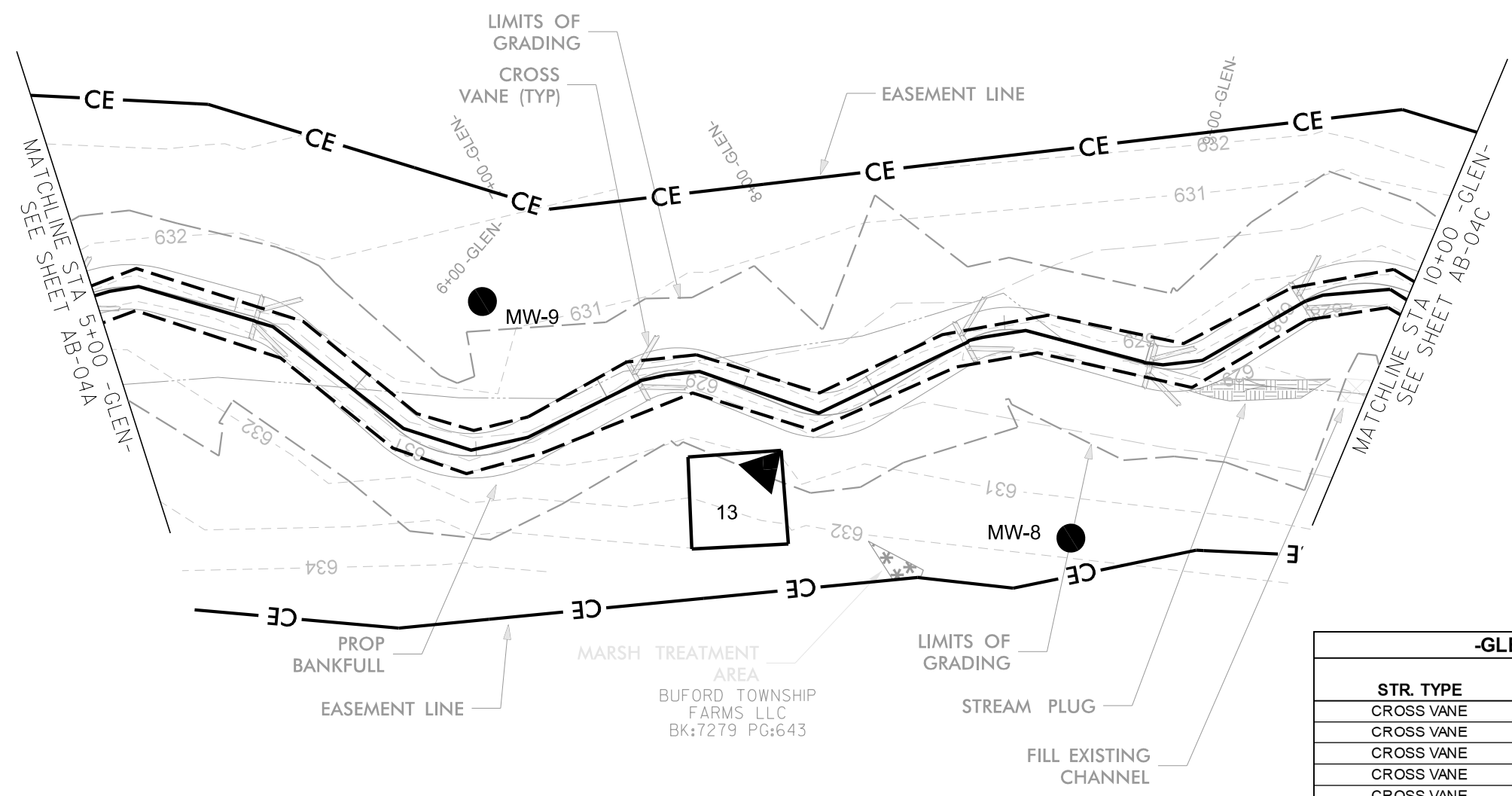
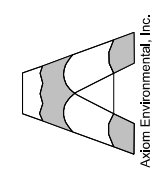

-GLEN- AS-BUILT STRUCTURE LOCATIONS				
STR. TYPE	NORTHING	EASTING	Prop Elevation	AB Survey Elevation
CROSS VANE	421,649.30	1,504,531.06	630.52	630.64
CROSS VANE	421,548.54	1,504,443.25	629.65	629.77
CROSS VANE	421,445.17	1,504,395.08	628.88	628.80
CROSS VANE	421,395.15	1,504,354.34	628.33	628.47
CROSS VANE	421,338.52	1,504,345.58	628.05	628.10

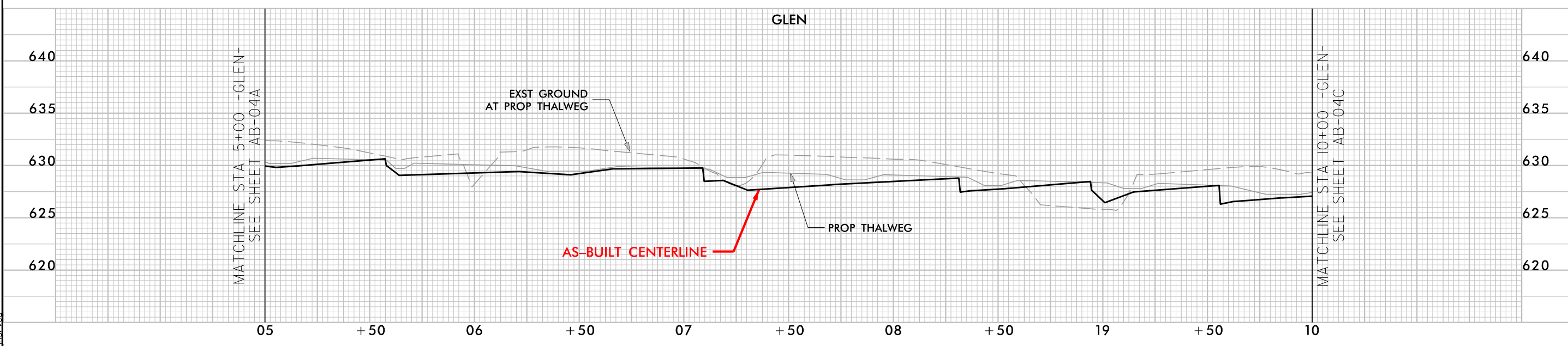

9/1/2022 Nesbit rdj_psh_AB-04B.dgn

© 2022 SUNGATE DESIGN GROUP, P.A. THIS DRAWING AND ALL REPRODUCTIONS OF IT ARE THE SOLE PROPERTY OF SDG. REPRODUCTION OR OTHER USES OF THIS DRAWING WITHOUT WRITTEN CONSENT OF SDG IS NOT PERMITTED.

NESBIT
 UNION COUNTY, NC
AS-BUILT STRUCTURES

PROJECT # :
 DRAWING NAME:
 DATE: 2022
 DRAWN BY: JRH
 REVIEWED BY: JGD
 REVISIONS:

SHEET NO.
AB-04B

-GLEN- AS-BUILT STRUCTURE LOCATIONS				
STR. TYPE	NORTHING	EASTING	Prop Elevation	AB Survey Elevation
LOG VANE	421,288.32	1,504,286.87	627.51	
CROSS VANE	421,244.86	1,504,257.11	627.26	627.47
CROSS VANE	421,210.94	1,504,223.69	626.70	626.64
CROSS VANE	421,154.68	1,504,216.66	626.43	
CROSS VANE	421,021.64	1,504,200.78	625.46	625.41
CROSS VANE	420,974.54	1,504,199.01	625.20	625.23

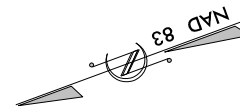
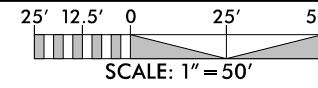

RECORD DRAWING

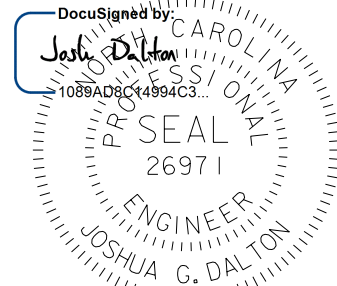

9/1/2022

DATE:

DOCUMENT NOT CONSIDERED FINAL
UNLESS ALL SIGNATURES COMPLETED

HORIZONTAL DATUM: NAD 83 (2011)
VERTICAL DATUM: NAVD 1988

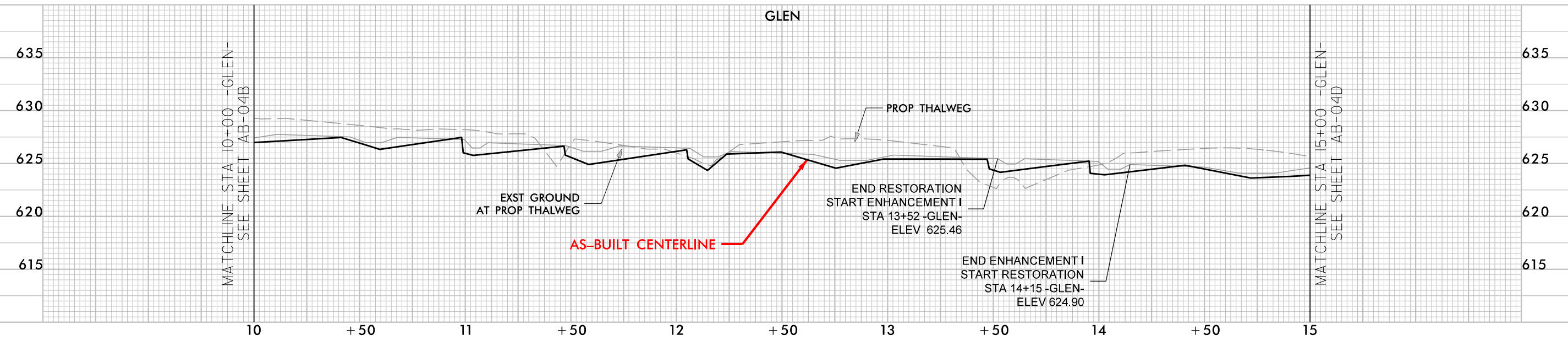
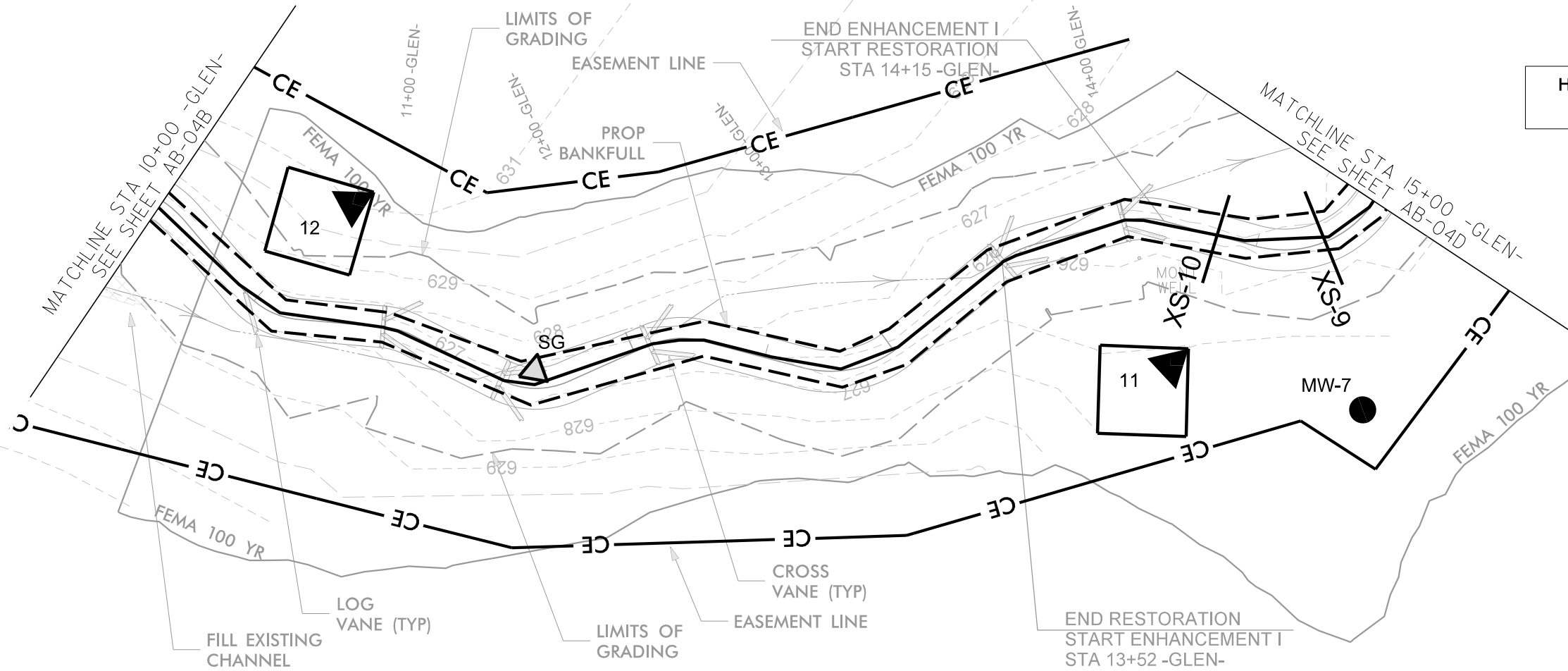

© 2022 SUNGATE DESIGN GROUP, P.A. THIS DRAWING AND ALL REPRODUCTIONS OF IT ARE THE SOLE PROPERTY OF SDG. REPRODUCTION OR OTHER USES OF THIS DRAWING WITHOUT WRITTEN CONSENT OF SDG IS NOT PERMITTED.

SUNGATE DESIGN GROUP, P.A.
834 GILES FARM ROAD
SUNGATE, NORTH CAROLINA 27866
TEL: (919) 856-2243
ENG FIRM LICENSE NO. C-980

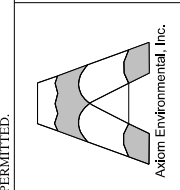

NESBIT
UNION COUNTY, NC
AS-BUILT STRUCTURES

PROJECT # :
DRAWING NAME:
DATE: 2022
DRAWN BY: JRH
REVIEWED BY: JGD
REVISIONS:
SHEET NO.
AB-04C

9/1/2022 Nesbit_Psh_AB-04C.dgn

-UT 1- AS-BUILT STRUCTURE LOCATIONS				
STR. TYPE	NORTHING	EASTING	Prop Elevation	AB Survey Elevation
DROP STRUCTURE	420,738.10	1,504,243.50	624.08	624.02
DROP STRUCTURE	420,724.87	1,504,226.51	622.92	

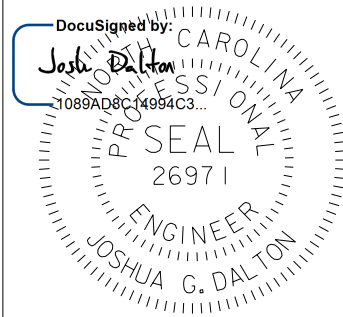
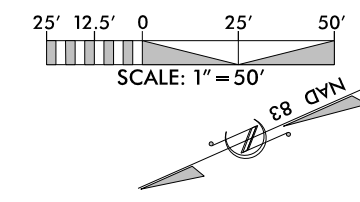

DATE: 9/1/2022

DOCUMENT NOT CONSIDERED FINAL
UNLESS ALL SIGNATURES COMPLETED

HORIZONTAL DATUM: NAD 83 (2011)
VERTICAL DATUM: NAVD 1988

RECORD DRAWING

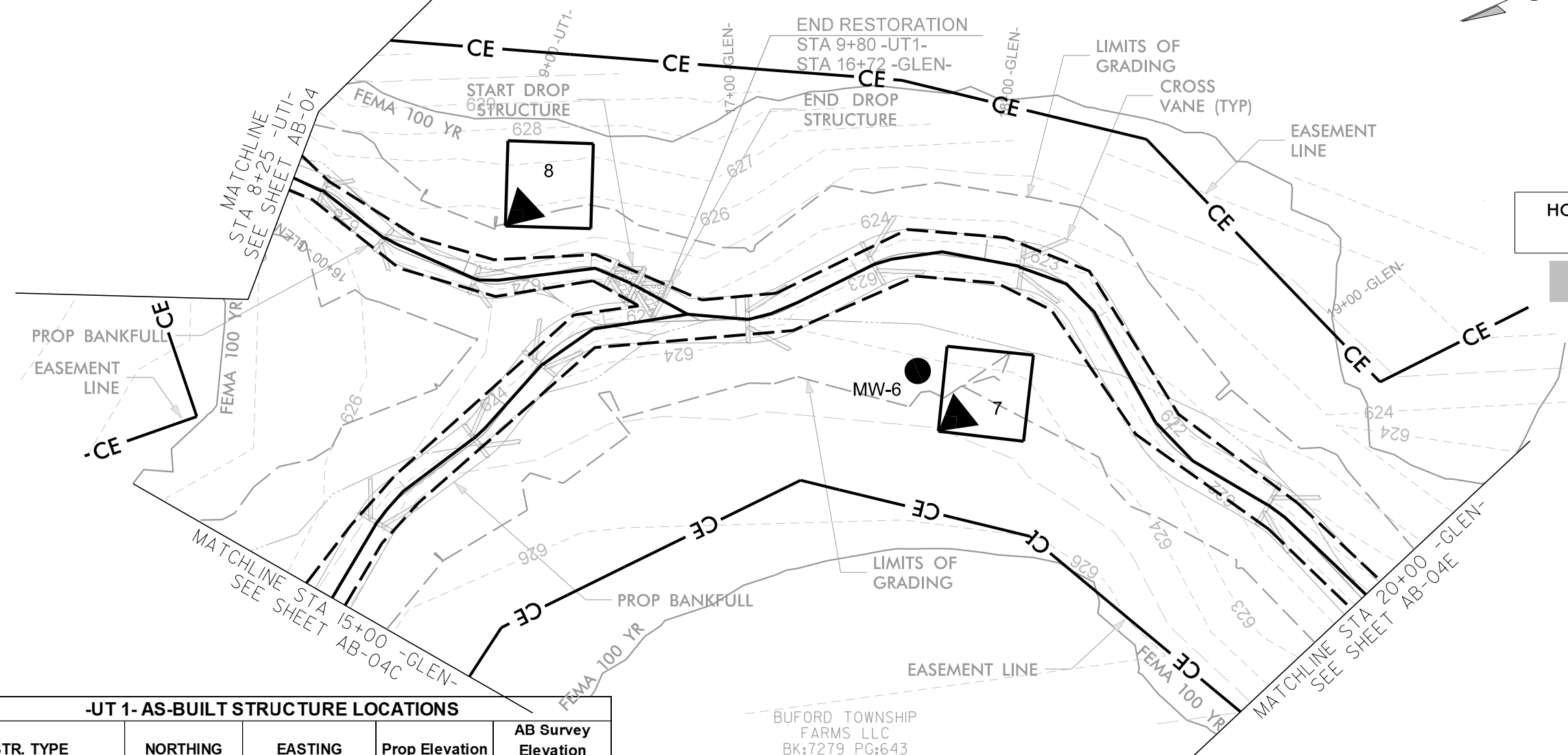

-UT 1- AS-BUILT STRUCTURE LOCATIONS				
STR. TYPE	NORTHING	EASTING	Prop Elevation	AB Survey Elevation
CROSS VANE	420,825.34	1,504,316.94	625.32	625.20
CROSS VANE	420,812.27	1,504,290.44	624.93	624.83
CROSS VANE	420,786.94	1,504,262.35	624.51	624.46

-GLEN- AS-BUILT STRUCTURE LOCATIONS				
STR. TYPE	NORTHING	EASTING	Prop Elevation	AB Survey Elevation
CROSS VANE	420,858.18	1,504,193.38	624.35	614.19
CROSS VANE	420,811.13	1,504,206.43	623.79	623.71
CROSS VANE	420,777.11	1,504,223.41	623.56	623.54
CROSS VANE	420,698.11	1,504,206.85	622.92	622.80
CROSS VANE	420,646.00	1,504,206.84	622.65	622.54
CROSS VANE	420,594.61	1,504,183.26	622.10	622.06
CROSS VANE	420,545.73	1,504,062.30	621.19	621.15

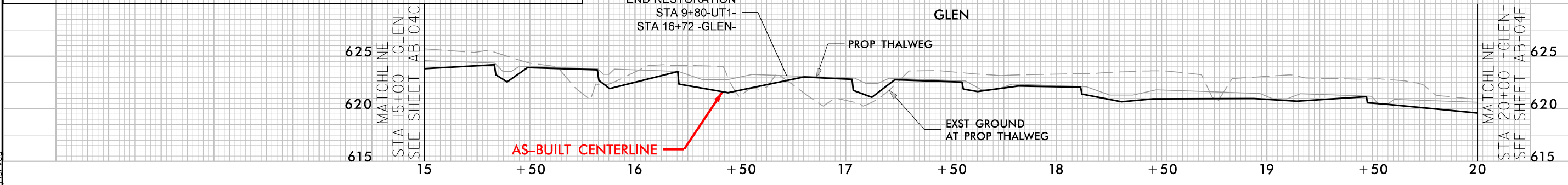
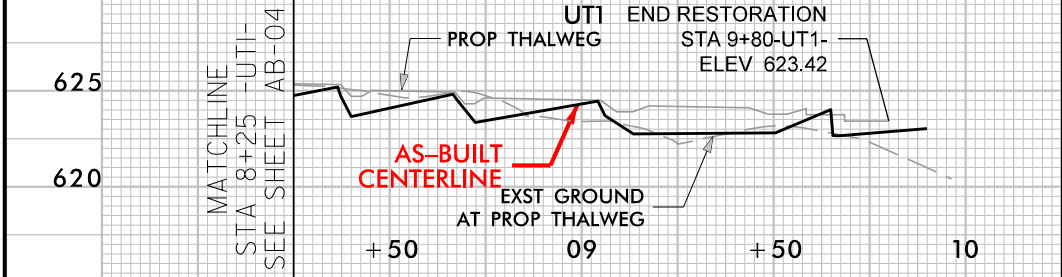

SUNGATE DESIGN GROUP, P.A.
 845 GAYNES FARM ROAD
 SUITE 200
 WILSON, NC 27606
 TEL: (919) 856-2243
 ENG FIRM LICENSE NO. C-980

NCSPE
 PROFESSIONAL SEAL
 ENGINEER
 JOSHUA G. DALTON
 26971

DATE: 9/1/2022
 DOCUMENT NOT CONSIDERED FINAL
 UNLESS ALL SIGNATURES COMPLETED

HORIZONTAL DATUM: NAD 83 (2011)
 VERTICAL DATUM: NAVD 1988

RECORD DRAWING

PROJECT # :
 DRAWING NAME:
 DATE: 2022
 DRAWN BY: JRH
 REVIEWED BY: JGD
 REVISIONS:

SHEET NO.
AB-04D

NESBIT
 UNION COUNTY, NC
 AS-BUILT STRUCTURES

Axkam Environmental, Inc.

© 2022 SUNGATE DESIGN GROUP, P.A. THIS DRAWING AND ALL REPRODUCTIONS OF IT ARE THE SOLE PROPERTY OF SDG. REPRODUCTION OR OTHER USES OF THIS DRAWING WITHOUT WRITTEN CONSENT OF SDG IS NOT PERMITTED.

9/1/2022
 Nesbit.rdy_psh_AB-04D.dgn

-GLEN- AS-BUILT STRUCTURE LOCATIONS				
STR. TYPE	NORTHING	EASTING	Prop Elevation	AB Survey Elevation
CROSS VANE	420,527.20	1,504,014.02	620.61	
LOG VANE	420,090.67	1,504,039.62	618.74	618.48

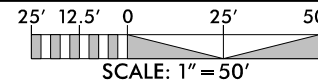

RECORD DRAWING

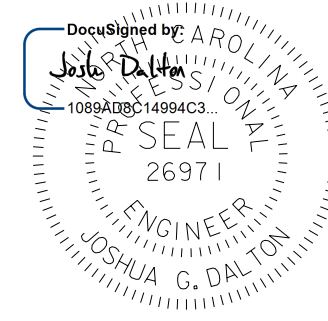

9/1/2022

DATE:

**DOCUMENT NOT CONSIDERED FINAL
UNLESS ALL SIGNATURES COMPLETED**

SUNGATE DESIGN GROUP, P.A.
 845 GILES FARM ROAD
 SUITE 200
 CARY, NC 27513
 TEL: (919) 855-2243
 ENG FIRM LICENSE NO. C-980

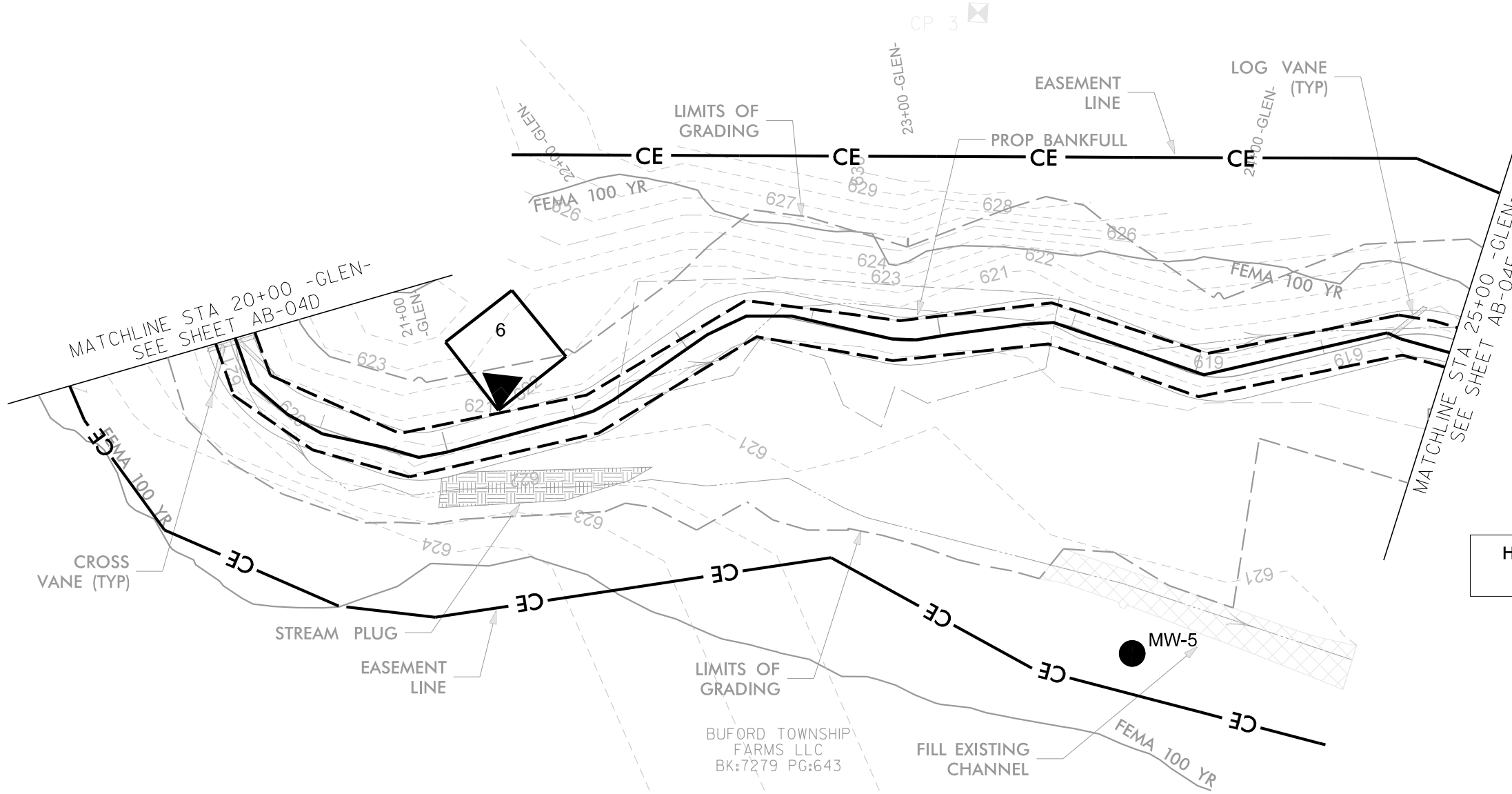
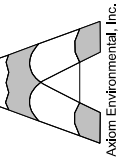

**HORIZONTAL DATUM: NAD 83 (2011)
VERTICAL DATUM: NAVD 1988**

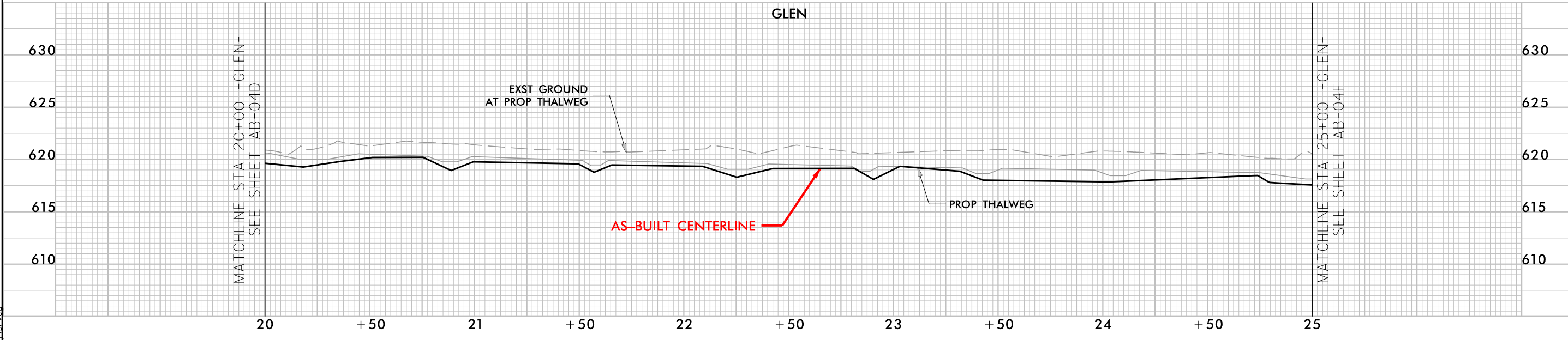

9/1/2022 Nesbit_Rdy_psh_AB-04E.dgn

© 2022 SUNGATE DESIGN GROUP, P.A. THIS DRAWING AND ALL REPRODUCTIONS OF IT ARE THE SOLE PROPERTY OF SDG. REPRODUCTION OR OTHER USES OF THIS DRAWING WITHOUT WRITTEN CONSENT OF SDG IS NOT PERMITTED.

**NESBIT
UNION COUNTY, NC
AS-BUILT STRUCTURES**

PROJECT # :
 DRAWING NAME:
 DATE: 2022
 DRAWN BY: JRH
 REVIEWED BY: JGD
 REVISIONS:

SHEET NO.
AB-04E

-GLEN- AS-BUILT STRUCTURE LOCATIONS				
STR. TYPE	NORTHING	EASTING	Prop Elevation	AB Survey Elevation
CROSS VANE	419,962.76	1,503,860.41	618.01	617.69
CROSS VANE	419,907.35	1,503,702.20	617.26	617.08
CROSS VANE	419,878.66	1,503,624.97	616.63	616.55

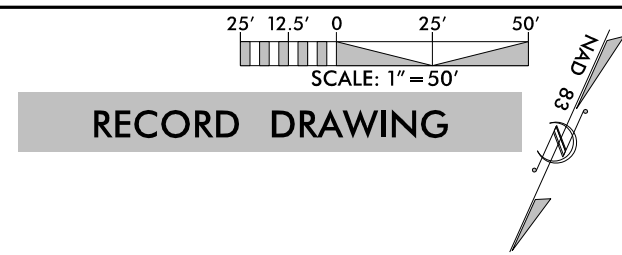

RECORD DRAWING

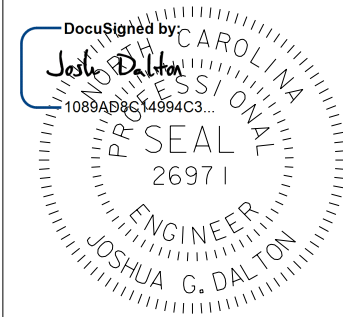

9/1/2022

DATE:
DOCUMENT NOT CONSIDERED FINAL
UNLESS ALL SIGNATURES COMPLETED

HORIZONTAL DATUM: NAD 83 (2011)
VERTICAL DATUM: NAVD 1988

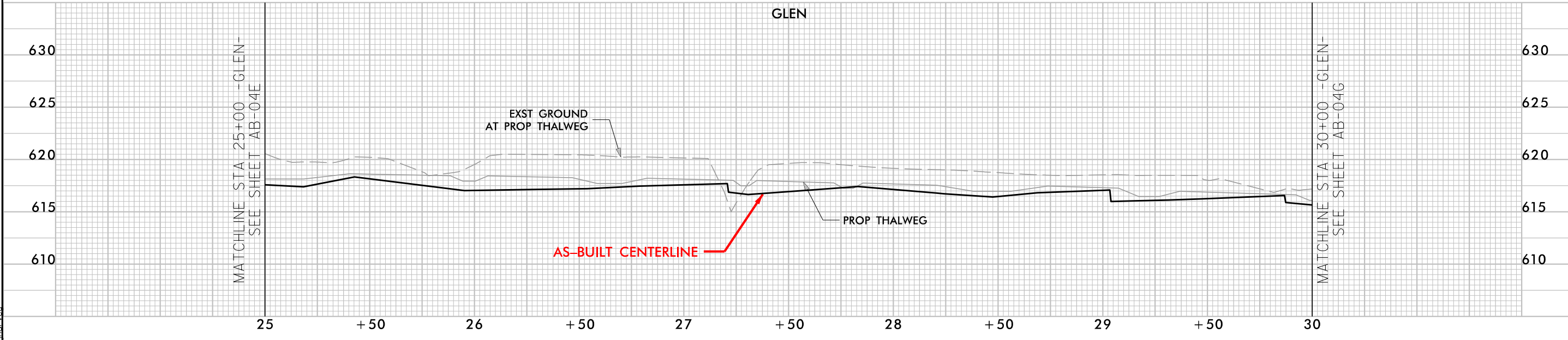
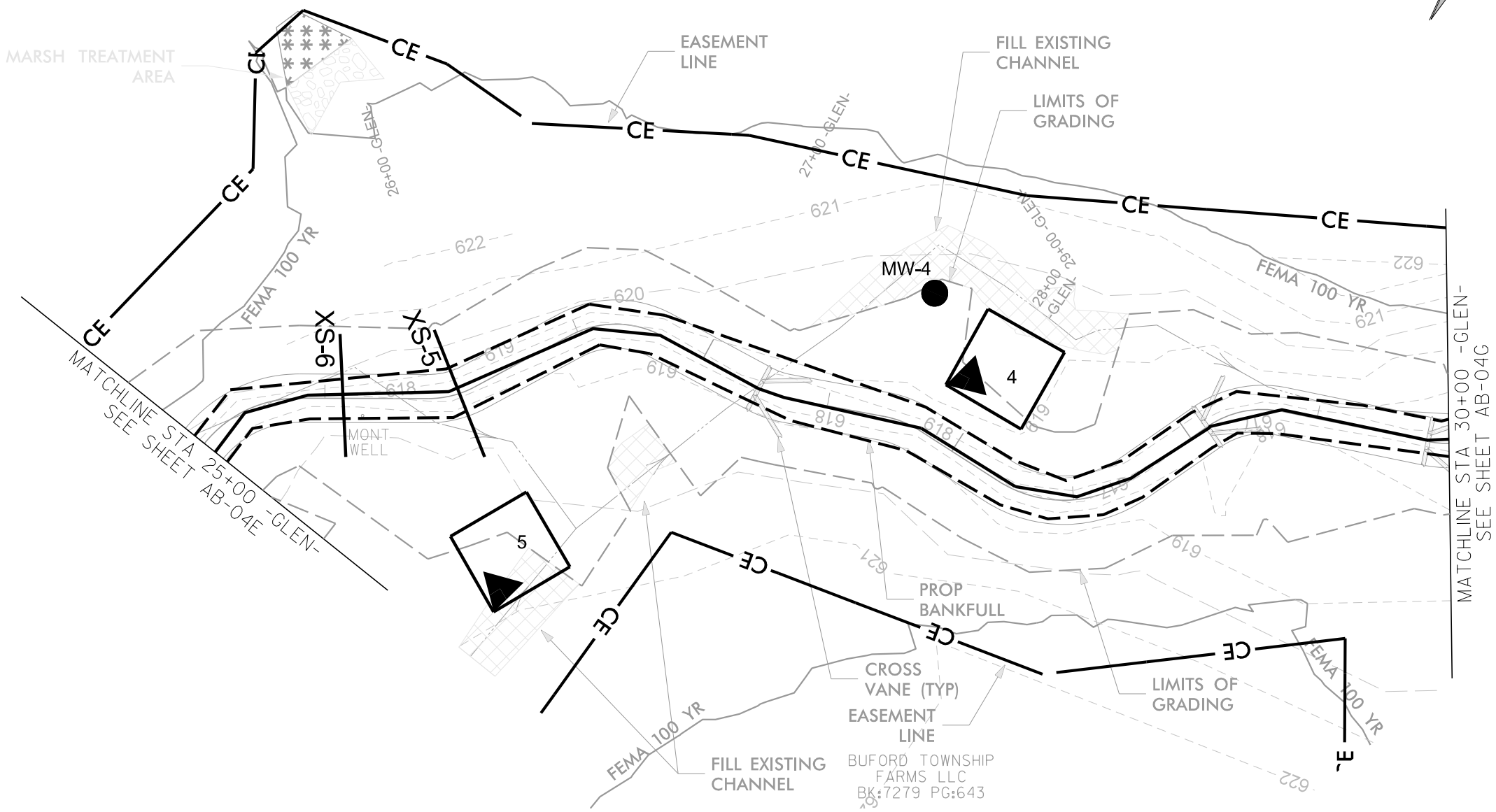

SUNGATE DESIGN GROUP, P.A.
 845 GILES FARM ROAD
 1089 AD8C14994C3...
 TEL: (919) 856-2243
 ENG FIRM LICENSE NO. C-980

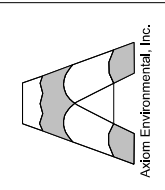

NESBIT
 UNION COUNTY, NC

AS-BUILT STRUCTURES

PROJECT # :
 DRAWING NAME:
 DATE: 2022
 DRAWN BY: JRH
 REVIEWED BY: JGD
 REVISIONS:
 SHEET NO.
AB-04F

9/1/2022 Nesbit_Rdy_psh_AB-04F.dgn

© 2022 SUNGATE DESIGN GROUP, P.A. THIS DRAWING AND ALL REPRODUCTIONS OF IT ARE THE SOLE PROPERTY OF SDG. REPRODUCTION OR OTHER USES OF THIS DRAWING WITHOUT WRITTEN CONSENT OF SDG IS NOT PERMITTED.

-GLEN- AS-BUILT STRUCTURE LOCATIONS

STR. TYPE	NORTHING	EASTING	Prop Elevation	AB Survey Elevation
CROSS VANE	419,844.28	1,503,581.33	616.38	616.26
CROSS VANE	419,743.25	1,503,399.45	615.16	614.96
CROSS VANE	419,636.42	1,503,318.18	614.35	614.14

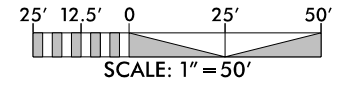

RECORD DRAWING

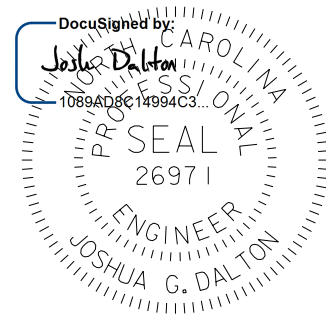

9/1/2022

DATE:
DOCUMENT NOT CONSIDERED FINAL UNLESS ALL SIGNATURES COMPLETED

SUNGATE DESIGN GROUP, P.A.
 845 GILES FARM ROAD
 SUITE 200 CARY, NC 27513
 TEL: (919) 856-2243
 ENG. FIRM LICENSE NO. C-890

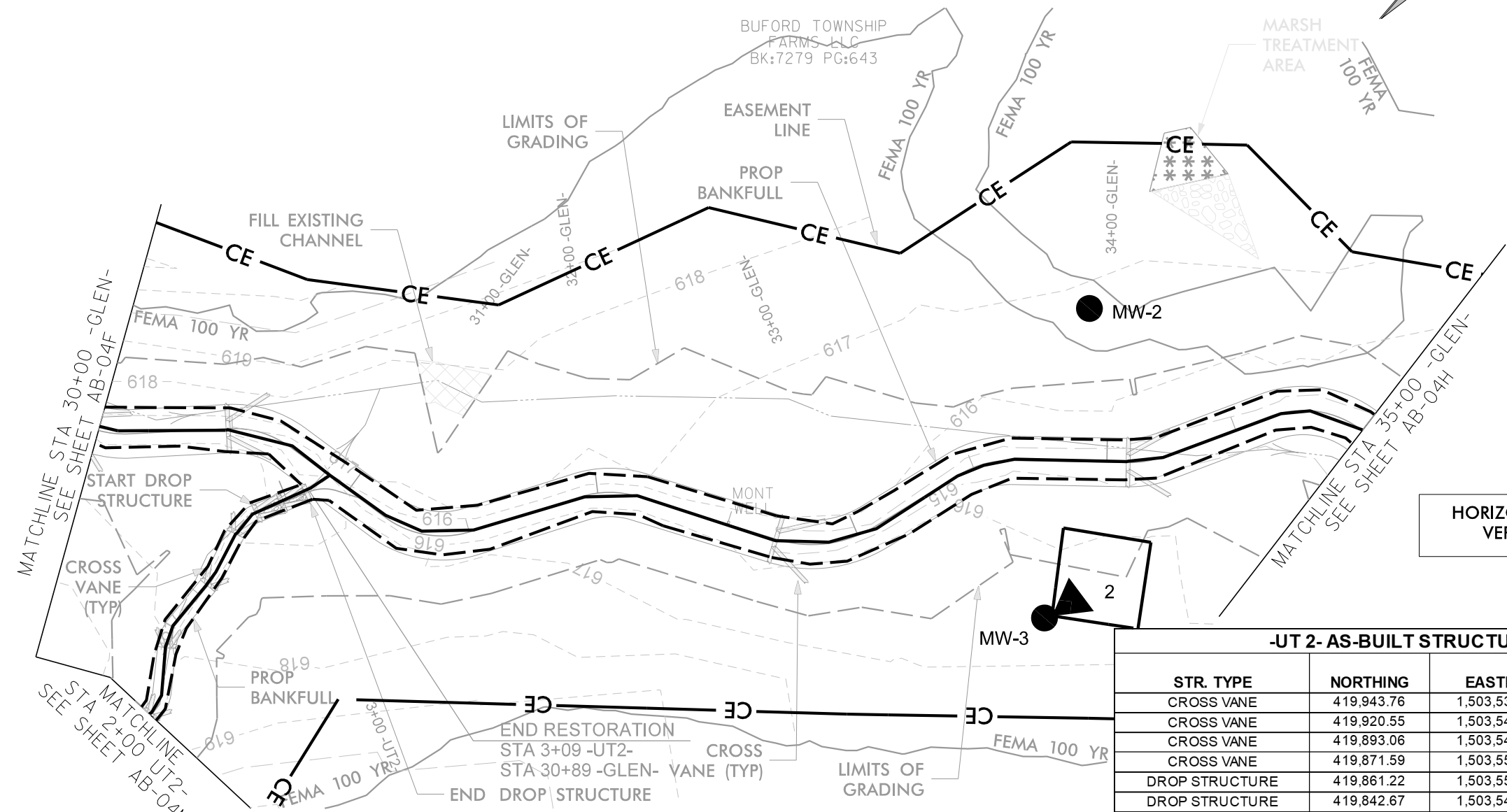
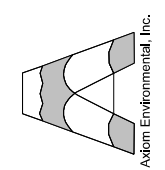

HORIZONTAL DATUM: NAD 83 (2011)
VERTICAL DATUM: NAVD 1988

-UT 2- AS-BUILT STRUCTURE LOCATIONS

STR. TYPE	NORTHING	EASTING	Prop Elevation	AB Survey Elevation
CROSS VANE	419,943.76	1,503,533.96	617.83	617.72
CROSS VANE	419,920.55	1,503,546.20	617.46	617.52
CROSS VANE	419,893.06	1,503,549.12	617.09	617.00
CROSS VANE	419,871.59	1,503,553.93	616.69	616.73
DROP STRUCTURE	419,861.22	1,503,552.69	616.39	
DROP STRUCTURE	419,842.67	1,503,543.17	615.82	

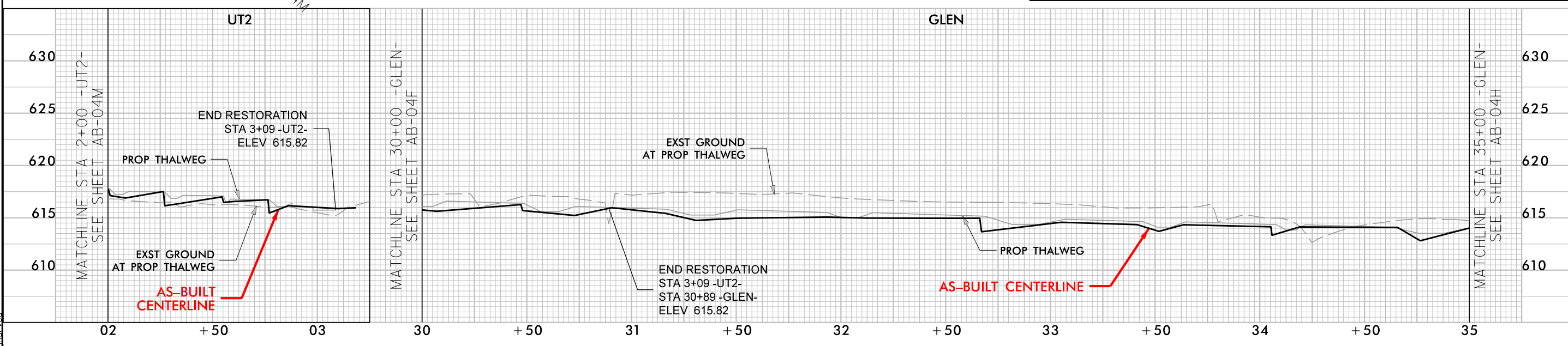

9/1/2022 Nesbit.rdy_psh_AB-04G.dgn

© 2022 SUNGATE DESIGN GROUP, P.A. THIS DRAWING AND ALL REPRODUCTIONS OF IT ARE THE SOLE PROPERTY OF SDG. REPRODUCTION OR OTHER USES OF THIS DRAWING WITHOUT WRITTEN CONSENT OF SDG IS NOT PERMITTED.

NESBIT
 UNION COUNTY, NC
AS-BUILT STRUCTURES

PROJECT # :
 DRAWING NAME:
 DATE: 2022
 DRAWN BY: JRH
 REVIEWED BY: JGD
 REVISIONS:

SHEET NO.
AB-04G

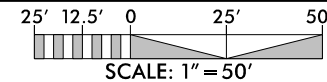

RECORD DRAWING

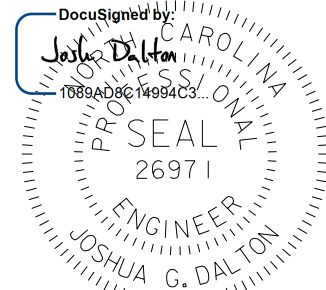

DATE: 9/1/2022

DOCUMENT NOT CONSIDERED FINAL
UNLESS ALL SIGNATURES COMPLETED

HORIZONTAL DATUM: NAD 83 (2011)
VERTICAL DATUM: NAVD 1988

SUNGATE DESIGN GROUP, P.A.
850 GILES FARM ROAD
SALISBURY, NC 27866
TEL: (919) 856-2243
ENG. FIRM LICENSE NO. C-980

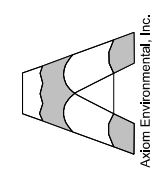

NESBIT
UNION COUNTY, NC
AS-BUILT STRUCTURES

PROJECT # :
DRAWING NAME:
DATE: 2022
DRAWN BY: JRH
REVIEWED BY: JGD
REVISIONS:

SHEET NO.
AB-04H

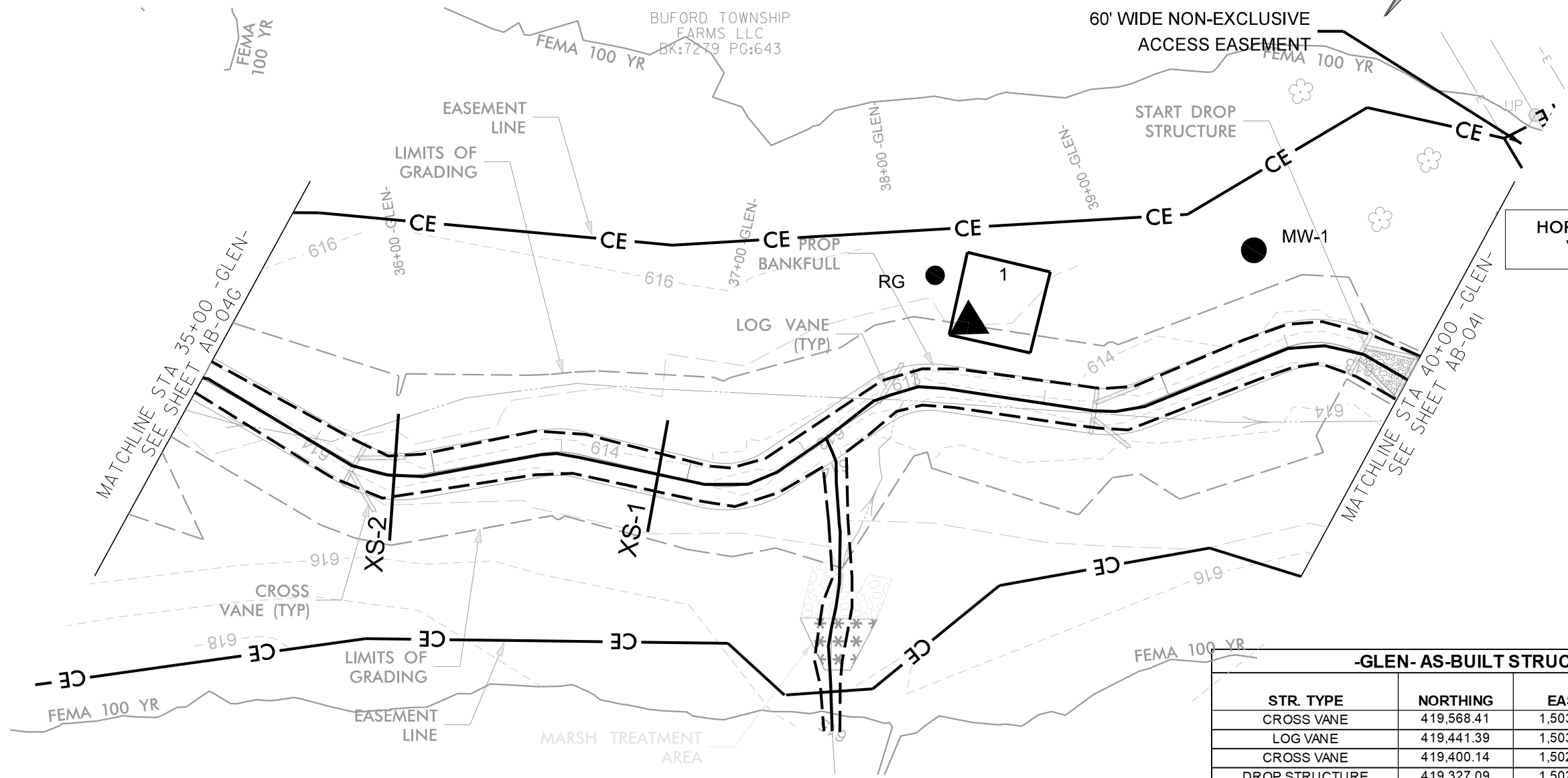

-GLEN- AS-BUILT STRUCTURE LOCATIONS				
STR. TYPE	NORTHING	EASTING	Prop Elevation	AB Survey Elevation
CROSS VANE	419,568.41	1,503,191.67	613.69	613.49
LOG VANE	419,441.39	1,503,030.54	612.96	612.36
CROSS VANE	419,400.14	1,502,957.46	612.68	612.43
DROP STRUCTURE	419,327.09	1,502,880.74	612.37	612.16

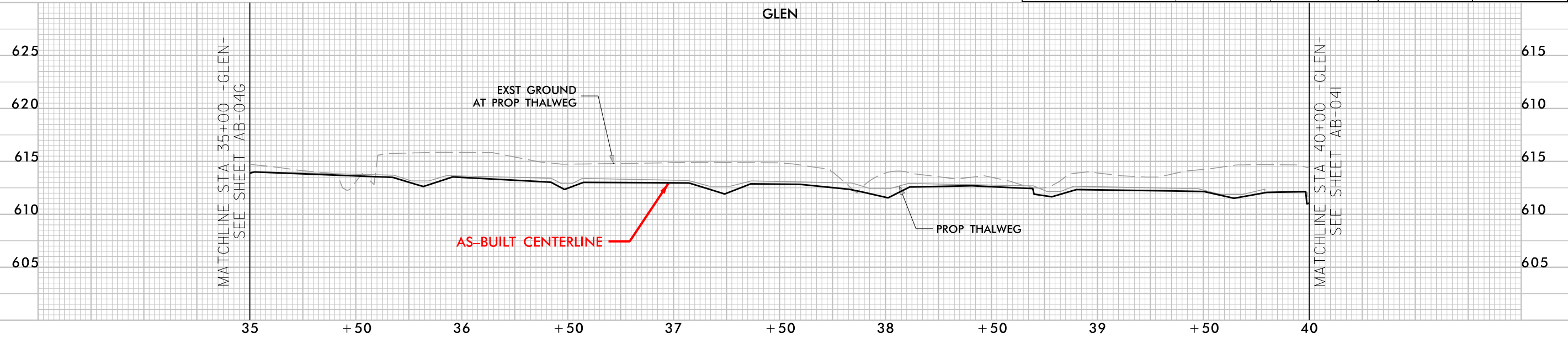

9/1/2022 Nesbit_Rdy_psh_AB-04H.dgn

© 2022 SUNGATE DESIGN GROUP, P.A. THIS DRAWING AND ALL REPRODUCTIONS OF IT ARE THE SOLE PROPERTY OF SDG. REPRODUCTION OR OTHER USES OF THIS DRAWING WITHOUT WRITTEN CONSENT OF SDG IS NOT PERMITTED.

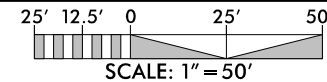

RECORD DRAWING

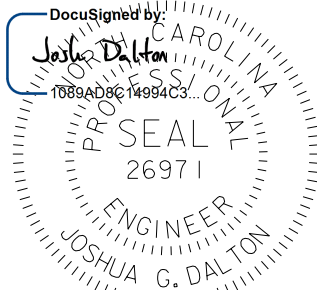

9/1/2022

DATE:
DOCUMENT NOT CONSIDERED FINAL
UNLESS ALL SIGNATURES COMPLETED

HORIZONTAL DATUM: NAD 83 (2011)
VERTICAL DATUM: NAVD 1988

SUNGATE DESIGN GROUP, P.A.
 845 GILES FARM ROAD
 WELLSVILLE, NC 27884
 TEL: (919) 856-2243
 ENG FIRM LICENSE NO. C-980

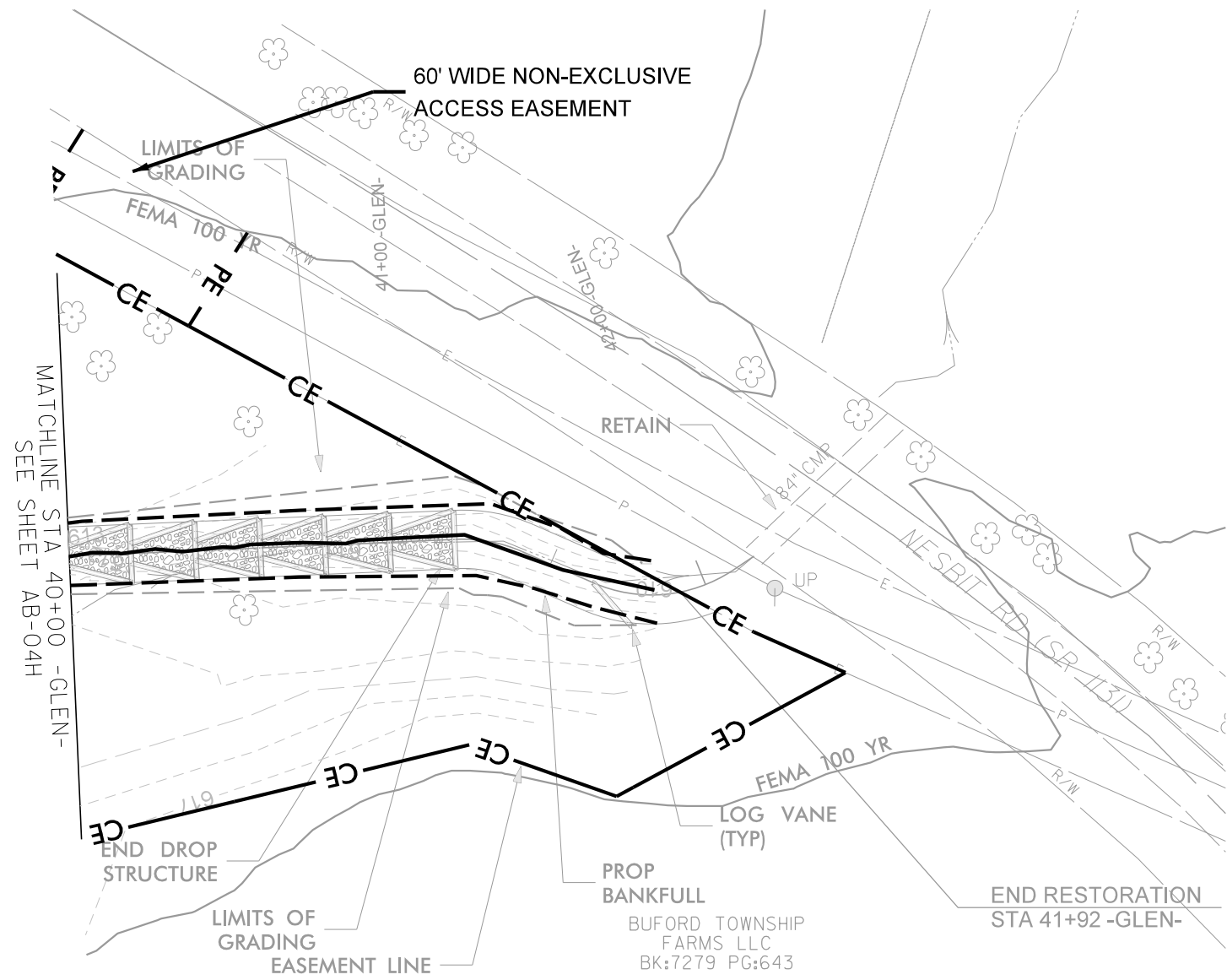
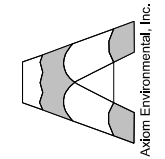

-GLEN- AS-BUILT STRUCTURE LOCATIONS				
STR. TYPE	NORTHING	EASTING	Prop Elevation	AB Survey Elevation
DROP STRUCTURE	419,319.49	1,502,740.15	609.99	610.56
LOG VANE	419,332.39	1,502,698.02	610.37	

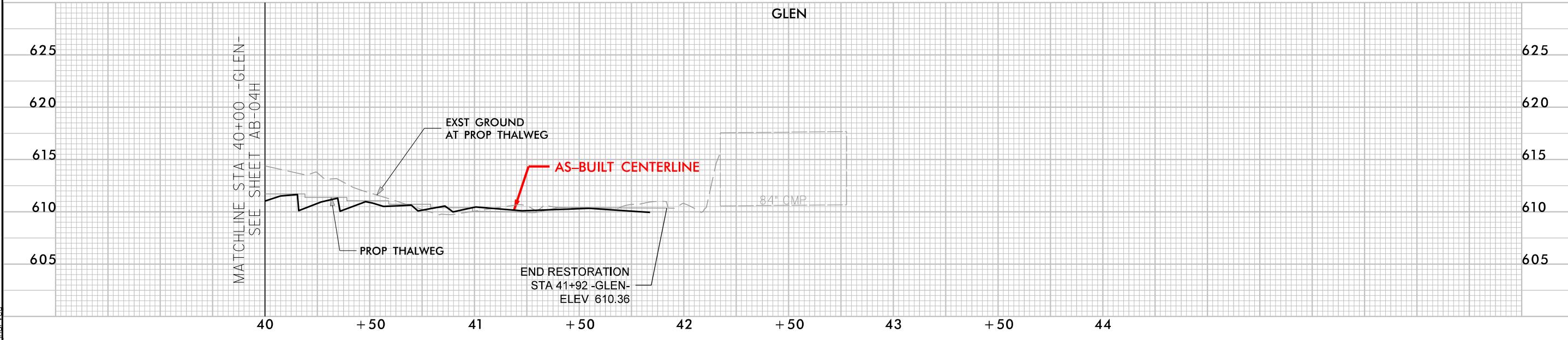

9/1/2022 Nesbit Rdj_esh_AB-041.dgn

© 2022 SUNGATE DESIGN GROUP, P.A. THIS DRAWING AND ALL REPRODUCTIONS OF IT ARE THE SOLE PROPERTY OF SDG. REPRODUCTION OR OTHER USES OF THIS DRAWING WITHOUT WRITTEN CONSENT OF SDG IS NOT PERMITTED.

PROJECT # :
DRAWING NAME:
DATE: 2022
DRAWN BY: JRH
REVIEWED BY: JGD
REVISIONS:

SHEET NO.
AB-04I

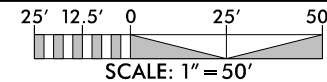

RECORD DRAWING

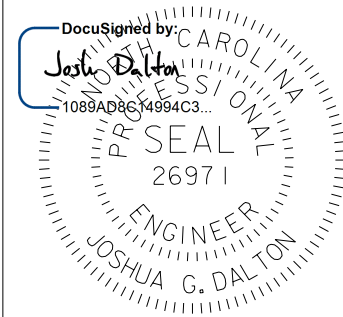

9/1/2022

DATE:

DOCUMENT NOT CONSIDERED FINAL
UNLESS ALL SIGNATURES COMPLETED

HORIZONTAL DATUM: NAD 83 (2011)
VERTICAL DATUM: NAVD 1988

SUNGATE DESIGN GROUP, P.A.
845 GAYNES FARM LANE ROAD
SUNGATE, NORTH CAROLINA 27866
TEL: (919) 855-2243
ENG. FIRM LICENSE NO. C-980

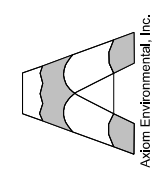

-UT 1- AS-BUILT STRUCTURE LOCATIONS				
STR. TYPE	NORTHING	EASTING	Prop Elevation	AB Survey Elevation
CROSS VANE	420,726.60	1,504,929.62	629.04	628.97
CROSS VANE	420,606.78	1,504,870.08	628.02	
CROSS VANE	420,658.38	1,504,831.71	628.79	628.92
CROSS VANE	420,646.52	1,504,764.22	628.65	628.74
CROSS VANE	420,671.66	1,504,705.11	628.52	628.63
CROSS VANE	420,731.32	1,504,654.49	628.35	628.44

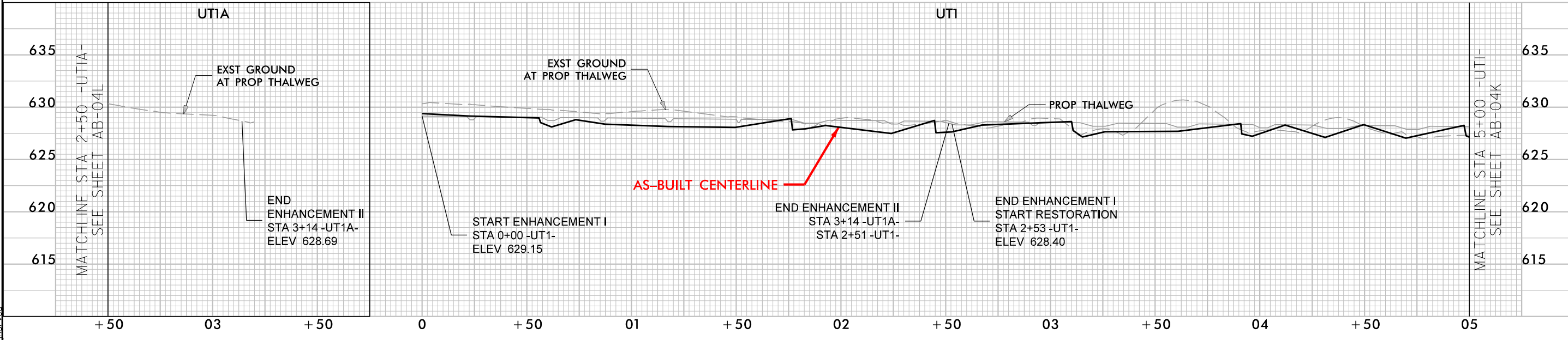
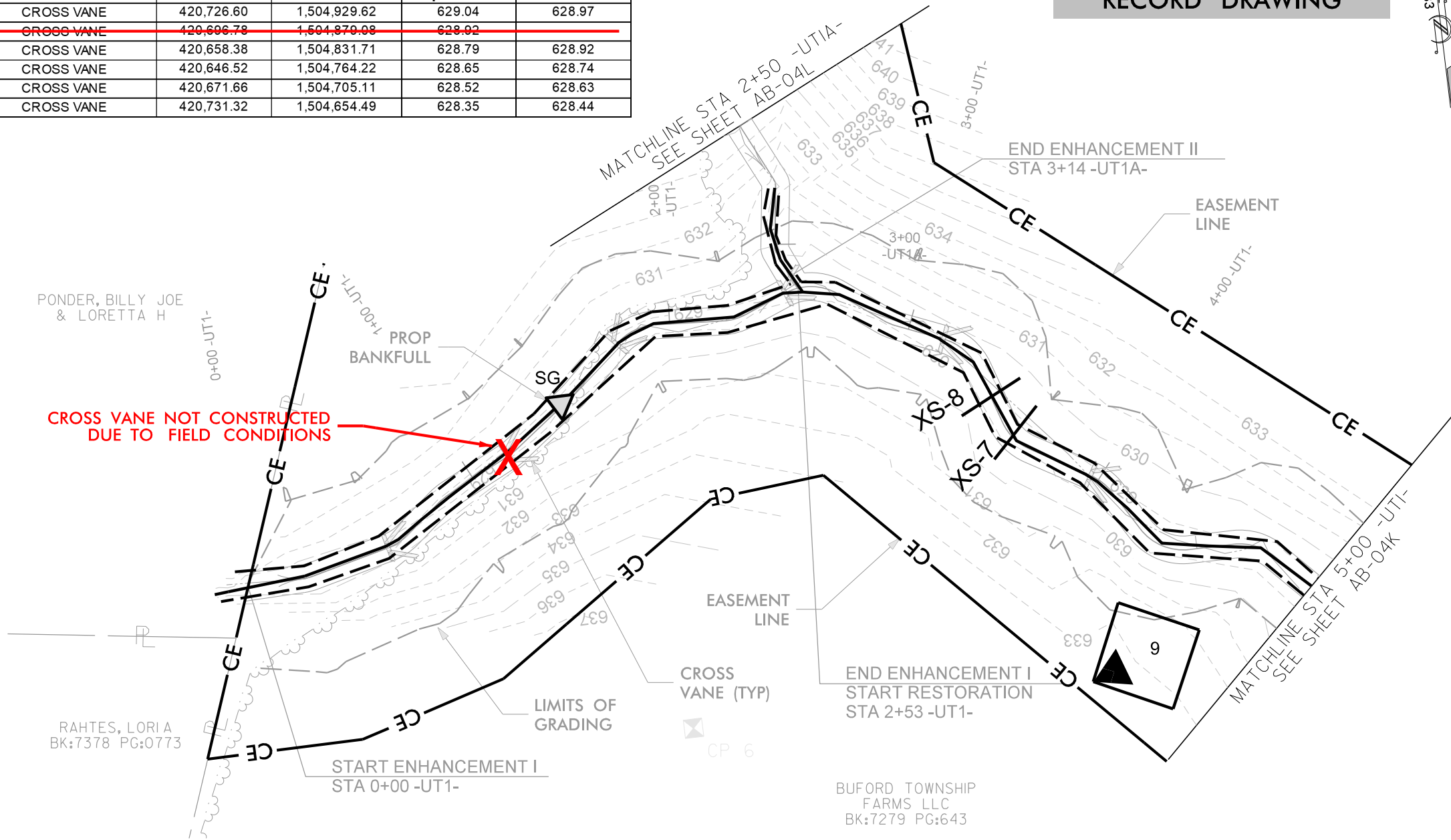

9/1/2022 Nesbit.rdy_psh_AB-04J.dgn

© 2022 SUNGATE DESIGN GROUP, P.A. THIS DRAWING AND ALL REPRODUCTIONS OF IT ARE THE SOLE PROPERTY OF SDG. REPRODUCTION OR OTHER USES OF THIS DRAWING WITHOUT WRITTEN CONSENT OF SDG IS NOT PERMITTED.

NESBIT
UNION COUNTY, NC

AS-BUILT STRUCTURES

PROJECT # :
DRAWING NAME:
DATE: 2022
DRAWN BY: JRH
REVIEWED BY: JGD
REVISIONS:

SHEET NO.
AB-04J

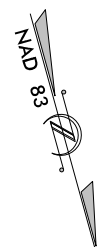
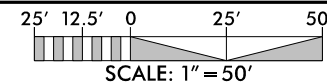

-UT 1- AS-BUILT STRUCTURE LOCATIONS				
STR. TYPE	NORTHING	EASTING	Prop Elevation	AB Survey Elevation
CROSS VANE	420,845.31	1,504,339.96	625.70	
CROSS VANE	420,788.20	1,504,570.84	628.11	628.27
CROSS VANE	420,853.55	1,504,541.68	627.63	627.73
CROSS VANE	420,877.08	1,504,526.39	627.25	627.47
CROSS VANE	420,871.67	1,504,440.70	626.69	626.34
CROSS VANE	420,864.90	1,504,402.19	626.25	626.04

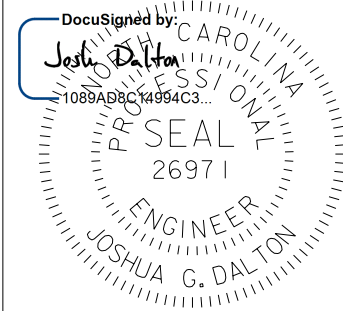

9/1/2022

DATE:
DOCUMENT NOT CONSIDERED FINAL
UNLESS ALL SIGNATURES COMPLETED

RECORD DRAWING

HORIZONTAL DATUM: NAD 83 (2011)
VERTICAL DATUM: NAVD 1988

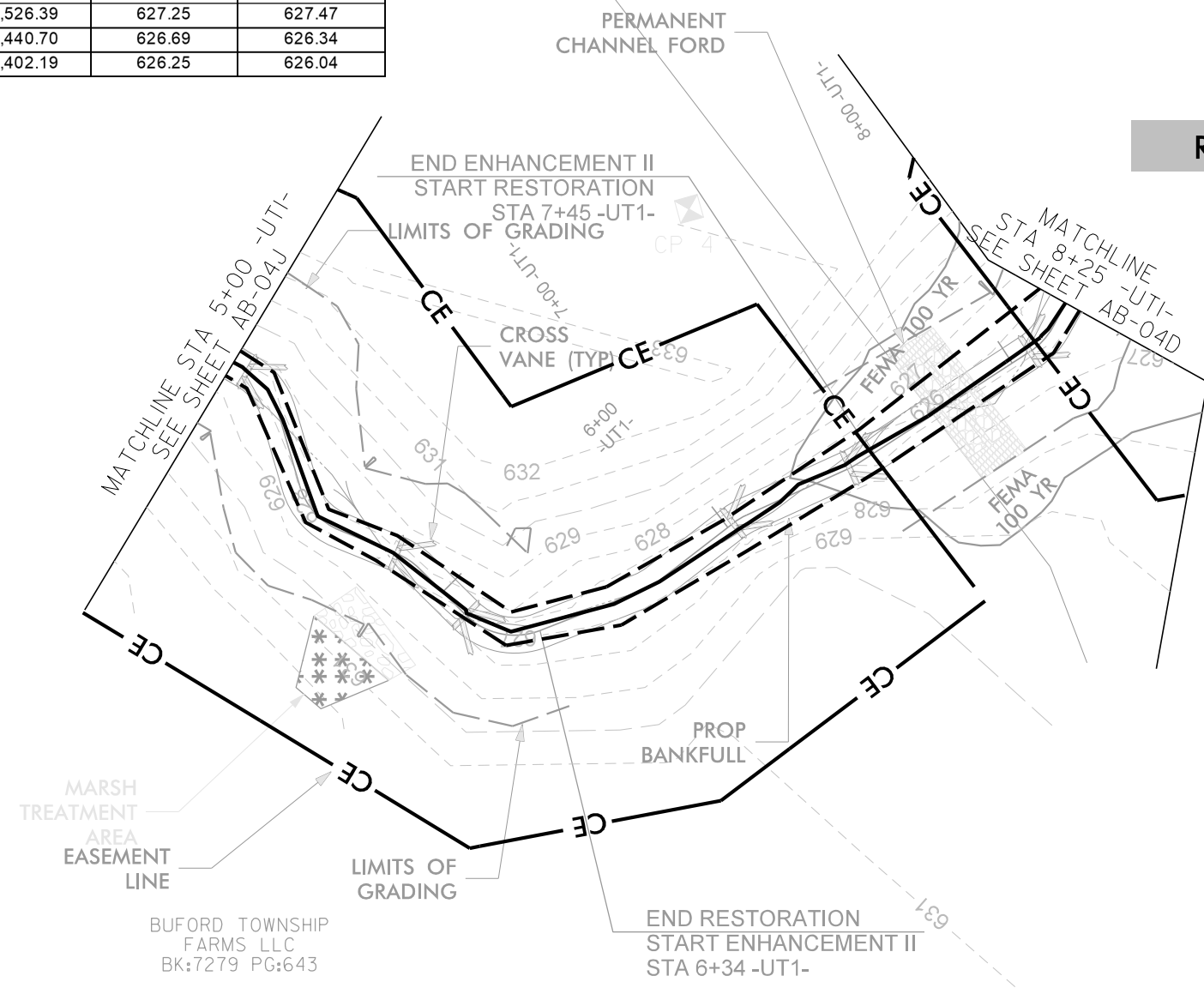

BUFORD TOWNSHIP
FARMS LLC
BK:7279 PG:643

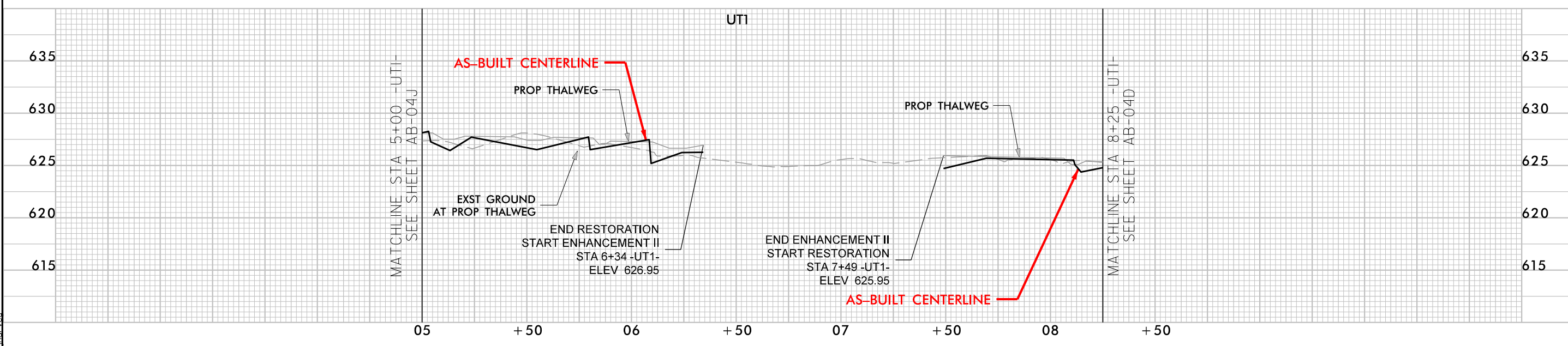

SUNGATE DESIGN GROUP, P.A.
850 GAYNES FARM ROAD
CARY, NC 27513
TEL: (919) 855-2243
ENG FIRM LICENSE NO. C-890

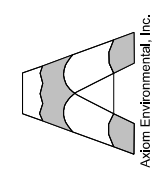

PROJECT # :
DRAWING NAME:
DATE: 2022
DRAWN BY: JRH
REVIEWED BY: JGD
REVISIONS:

NESBIT
UNION COUNTY, NC
AS-BUILT STRUCTURES

SHEET NO.
AB-04K

9/1/2022 Nesbit.rdy_psh_AB-04K.dgn

© 2022 SUNGATE DESIGN GROUP, P.A. THIS DRAWING AND ALL REPRODUCTIONS OF IT ARE THE SOLE PROPERTY OF SDG. REPRODUCTION OR OTHER USES OF THIS DRAWING WITHOUT WRITTEN CONSENT OF SDG IS NOT PERMITTED.

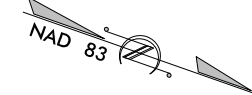
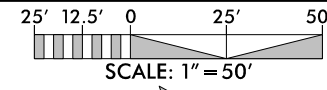

RECORD DRAWING

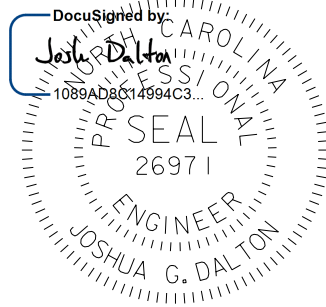

9/1/2022

DATE:
DOCUMENT NOT CONSIDERED FINAL
UNLESS ALL SIGNATURES COMPLETED

HORIZONTAL DATUM: NAD 83 (2011)
VERTICAL DATUM: NAVD 1988

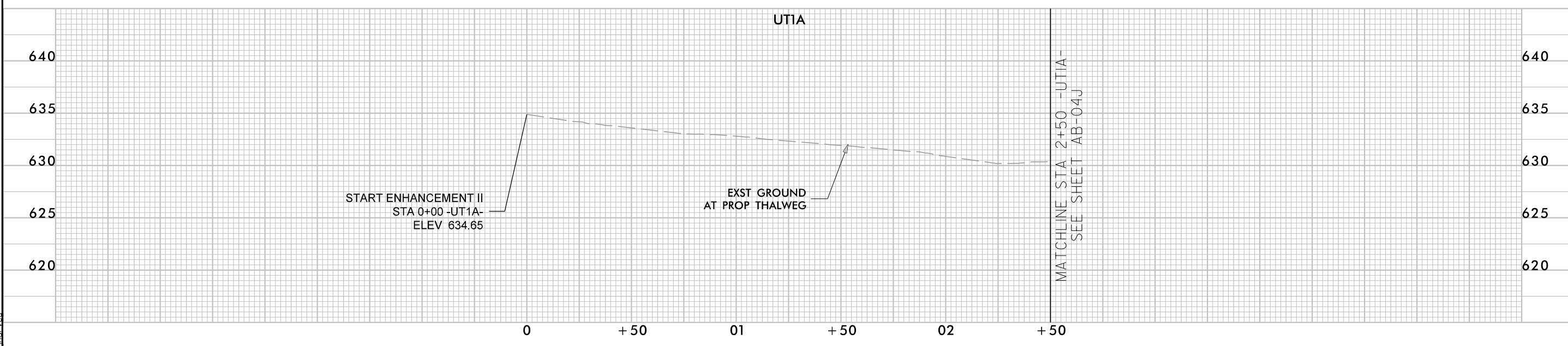
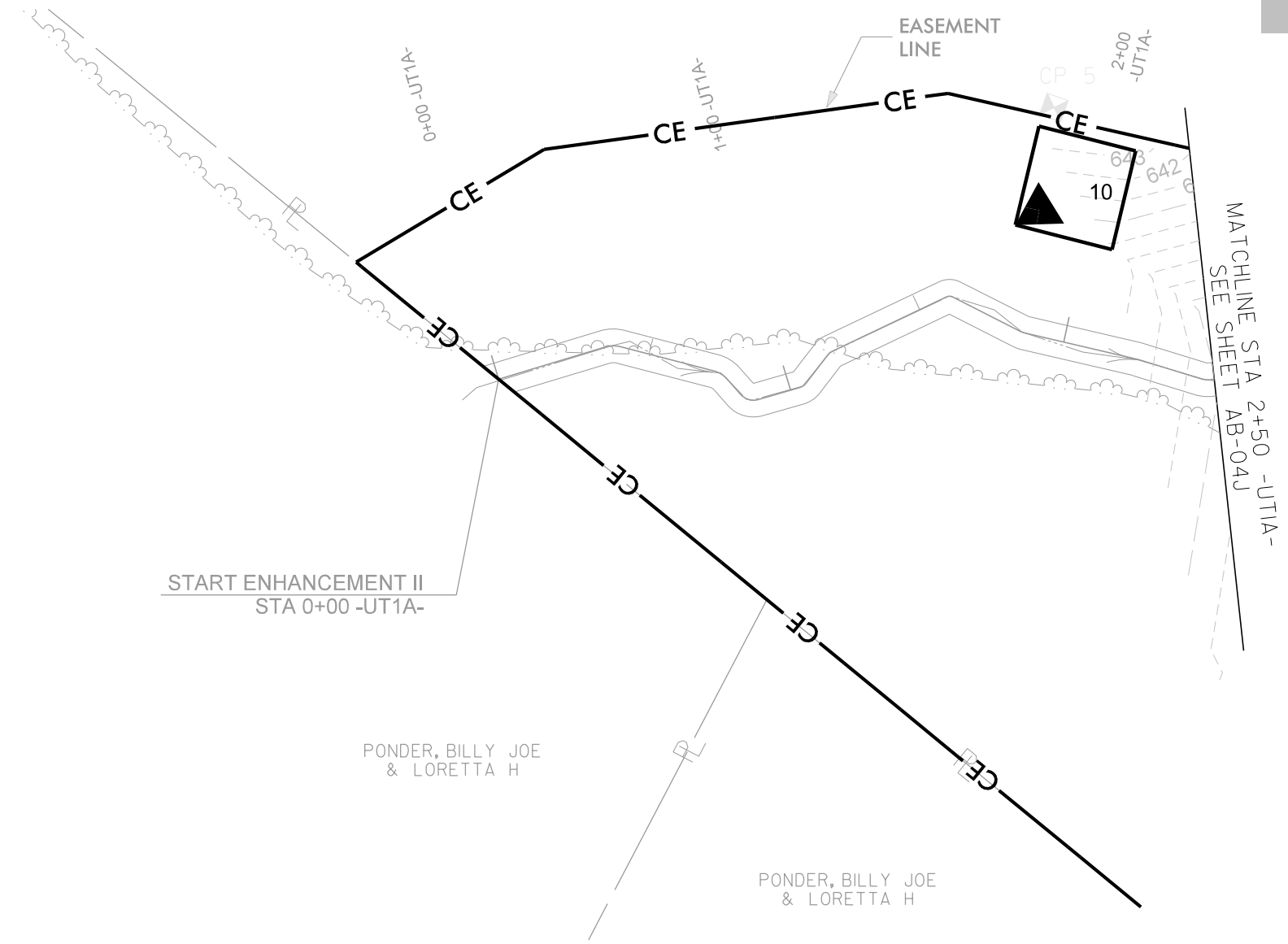

9/1/2022 Nesbit Rdj_psh_AB-04L.dgn

SUNGATE DESIGN GROUP, P.A.
 850 GILES FARM ROAD
 BALECHON, NORTH CAROLINA 27806
 TEL: (919) 856-2243
 ENG FIRM LICENSE NO. C-980

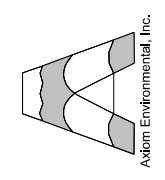

NESBIT
 UNION COUNTY, NC
AS-BUILT STRUCTURES

PROJECT # :
 DRAWING NAME:
 DATE: 2022
 DRAWN BY: JRH
 REVIEWED BY: JGD
 REVISIONS:

SHEET NO.
AB-04L

© 2022 SUNGATE DESIGN GROUP, P.A. THIS DRAWING AND ALL REPRODUCTIONS OF IT ARE THE SOLE PROPERTY OF SDG. REPRODUCTION OR OTHER USES OF THIS DRAWING WITHOUT WRITTEN CONSENT OF SDG IS NOT PERMITTED.

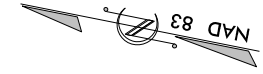
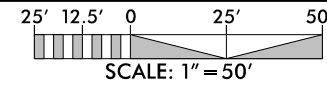

RECORD DRAWING

DocuSigned by:
Joshua Dalton
 1089AD8634994C3...
 NORTH CAROLINA
 PROFESSIONAL
 SEAL
 26971
 ENGINEER
 JOSHUA G. DALTON
 9/1/2022

DATE:
**DOCUMENT NOT CONSIDERED FINAL
 UNLESS ALL SIGNATURES COMPLETED**

**HORIZONTAL DATUM: NAD 83 (2011)
 VERTICAL DATUM: NAVD 1988**

BUFORD TOWNSHIP
 FARMS LLC
 BK:7279 PG:643

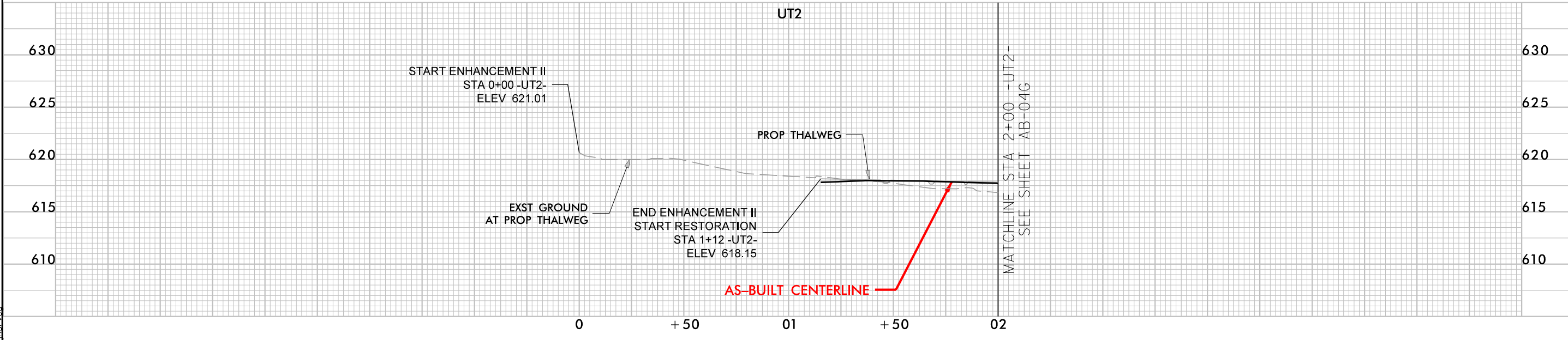
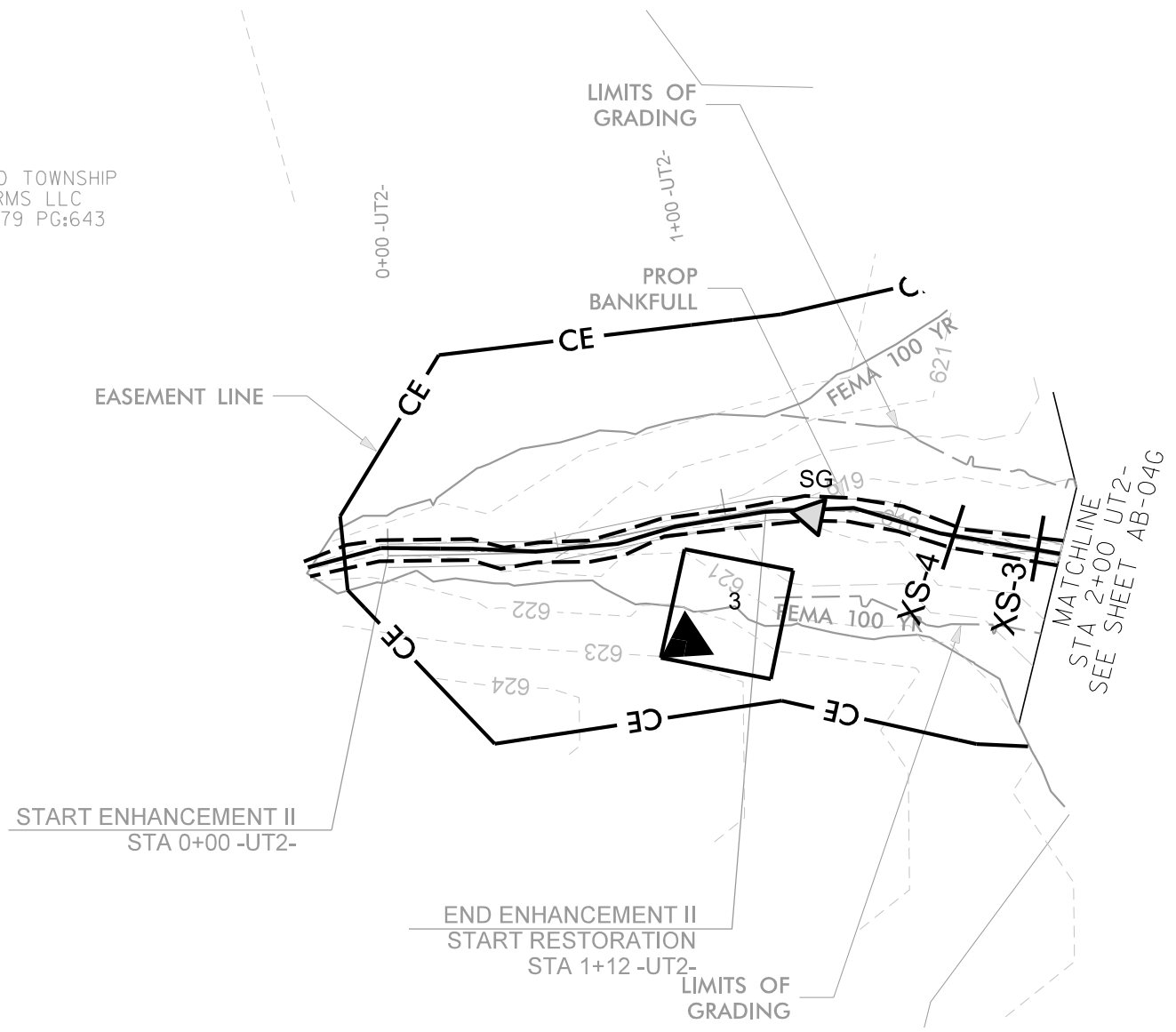

9/1/2022
 Nesbit Rd - psh - AB - 04M.dgn

SUNGATE DESIGN GROUP, P.A.
 850 GILES FARM ROAD
 BAYLEIGH COUNTY, NC 27806
 TEL: (919) 855-2243
 ENG FIRM LICENSE NO. C-980

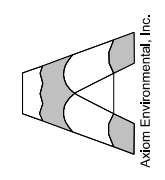

THIS DRAWING AND ALL REPRODUCTIONS OF IT ARE THE SOLE PROPERTY OF SDG. REPRODUCTION OR OTHER USES OF THIS DRAWING WITHOUT WRITTEN CONSENT OF SDG IS NOT PERMITTED.

**NESBIT
 UNION COUNTY, NC
 AS-BUILT STRUCTURES**

PROJECT # :
 DRAWING NAME:
 DATE: 2022
 DRAWN BY: JRH
 REVIEWED BY: JGD
 REVISIONS:

SHEET NO.
AB-04M

DESIGN PLANTING TABLE

Vegetation Association	Piedmont/Mountain Bottomland Forest*		Dry-Mesic Oak-Hickory Forest*		Stream-side Assemblage**		TOTAL
Area (acres)	7.2		5		3.8		16
Species	# planted*	% of total	# planted*	% of total	# planted**	% of total	# planted
River birch (<i>Betula nigra</i>)	245	5	--	--	1550	15	1795
Bitternut hickory (<i>Carya cordiformis</i>)	490	10	--	--	--	--	490
American elm (<i>Ulmus americana</i>)	245	5	170	5	--	--	415
Red bud (<i>Cercis canadensis</i>)	--	--	510	15	--	--	510
Silky dogwood (<i>Cornus amomum</i>)	245	5	--	--	2067	20	2312
Persimmon (<i>Diospyros virginiana</i>)	--	--	510	15	--	--	510
Hackberry (<i>Celtis occidentalis</i>)	490	10	--	--	517	5	1006
Green ash (<i>Fraxinus pennsylvanica</i>)	245	5	--	--	517	5	762
Tulip poplar (<i>Liriodendron tulipifera</i>)	245	5	170	5	517	5	932
Sycamore (<i>Platanus occidentalis</i>)	245	5	170	5	1550	15	1965
Red mulberry (<i>Morus rubra</i>)	--	--	170	5	517	5	687
Water oak (<i>Quercus nigra</i>)	734	15	680	20	--	--	1414
White oak (<i>Quercus alba</i>)	490	10	680	20	1034	10	2203
Red oak (<i>Quercus rubra</i>)	--	--	340	10	--	--	340
Black gum (<i>Nyssa sylvatica</i>)	490	10	--	--	1034	10	1523
Willow oak (<i>Quercus phellos</i>)	245	5	--	--	1034	10	1278
Shumard oak (<i>Quercus shumardii</i>)	490	10	--	--	--	--	490
TOTAL	4896	100	3400	100	10336	100	18632

* Planted at a density of 680 stems/acre.

** Planted at a density of 2720 stems/acre.

AS-BUILT PLANTING TABLE

Vegetation Association	Piedmont/Mountain Bottomland Forest*		Dry-Mesic Oak-Hickory Forest*		Stream-side Assemblage**		TOTAL
Area (acres)	7.2		5.0		3.8		16.0
Species	# planted*	% of total	# planted*	% of total	# planted**	% of total	# planted
River birch (<i>Betula nigra</i>)	250	5	--	--	1750	17	2000
Shagbark hickory (<i>Carya cordiformis</i>)	500	10	--	--	--	--	500
Hackberry (<i>Celtis occidentalis</i>)	400	8	--	--	600	6	1000
Red bud (<i>Cercis canadensis</i>)	--	--	600	18	--	--	600
Silky dogwood (<i>Cornus amomum</i>)	350	7	--	--	2150	21	2500
Persimmon (<i>Diospyros virginiana</i>)	--	--	500	15	--	--	500
Green ash (<i>Fraxinus pennsylvanica</i>)	200	4.5	--	--	700	7	900
Tulip poplar (<i>Liriodendron tulipifera</i>)	200	4.5	150	4	650	6.5	1000
Red mulberry (<i>Morus rubra</i>)	--	--	150	4	350	3	500
Black gum (<i>Nyssa sylvatica</i>)	300	6	--	--	950	9	1250
Sycamore (<i>Platanus occidentalis</i>)	400	8	150	4	1700	16.5	2250
White oak (<i>Quercus alba</i>)	200	4.5	150	4	650	6	1000
Water oak (<i>Quercus nigra</i>)	1000	20	1000	30	--	--	2000
Willow oak (<i>Quercus phellos</i>)	200	4.5	--	--	800	8	1000
Red oak (<i>Quercus rubra</i>)	--	--	500	15	--	--	500
Shumard oak (<i>Quercus shumardii</i>)	600	12	--	--	--	--	600
American elm (<i>Ulmus americana</i>)	300	6	200	6	--	--	500
TOTAL	4900	100	3400	100	10300	100	18600

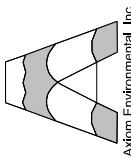

© 2022 SUNGATE DESIGN GROUP, P.A. THIS DRAWING AND ALL REPRODUCTIONS OF IT ARE THE SOLE PROPERTY OF SDG. REPRODUCTION OR OTHER USES OF THIS DRAWING WITHOUT WRITTEN CONSENT OF SDG IS NOT PERMITTED.

NESBIT
UNION COUNTY, NC
AS-BUILT PLANTING LIST

PROJECT # :
DRAWING NAME:
DATE: 2022
DRAWN BY: JRH
REVIEWED BY: JGD
REVISIONS:
SHEET NO. **AB-04N**