



Stantec

2127 AYRSLEY TOWN BLVD
SUITE 300
CHARLOTTE, NC 28273
(P) 704-329-0900
(F) 704-329-0905
www.stantec.com
License No. F-0672

CLIENT:

**ENVIRONMENTAL BANC &
EXCHANGE, LLC**
909 CAPABILITY DR.
RALEIGH, NC 27606
(P) 919-829-9909

AS-BUILT SURVEY OF NORTH FORK MOUNTAIN CREEK STREAM AND WETLAND RESTORATION CATAWBA COUNTY, NORTH CAROLINA

ENVIRONMENTAL BANC & EXCHANGE, LLC
RALEIGH, NORTH CAROLINA
JULY 13, 2012
PROJECT NUMBER: 171300307

SHEET DESCRIPTION

0.0	COVER
1.1	LEGEND AND SYMBOLS
2.2	KEY SHEET
3.3 - 3.11	AS-BUILT PLAN SHEETS
4.12 - 4.13	AS-BUILT TYPICAL SECTION SHEETS
5.14 - 5.18	AS-BUILT PROFILE SHEETS
6.19	AS-BUILT PLANTING PLAN

SITE LOCATION

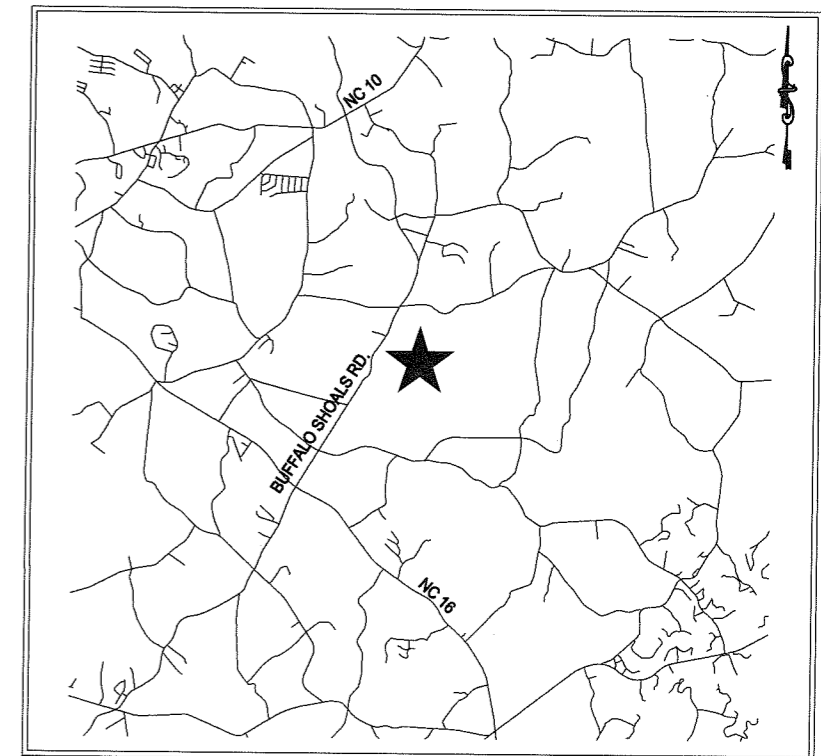

VICINITY MAP NOT TO SCALE

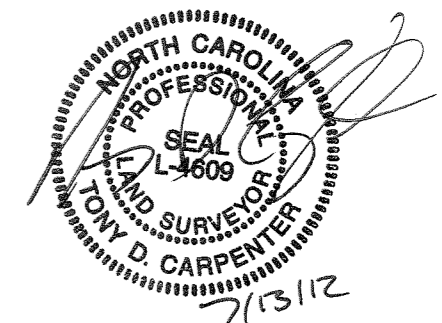

NOTES:

THIS IS A SURVEY OF AS-BUILT CONDITIONS ONLY. THIS INCLUDES SITE TOPOGRAPHY, CHANNEL DEFINITION, AND STREAM STRUCTURE LOCATION. THE PLS VERIFIES ONLY THE LOCATION AND ELEVATION OF THE POINTS COLLECTED AND THE CORRESPONDING ACCURACY OF THE CONTOURS TO DEFINE THE PREVIOUSLY MENTIONED FEATURES.

ALL WETLAND AND VEGETATION INFORMATION HAS BEEN PROVIDED BY THE DESIGNER.

THE AS-BUILT SURVEY WAS CONDUCTED WITH NAVD88 DATUM IN NORTH CAROLINA STATE PLANE (FT) COORDINATE SYSTEM.

CONSERVATION EASEMENT WAS PROVIDED BY OTHERS.

PRE-EXISTING CONTOURS WERE PROVIDED BY OTHERS.

CONVENTIONAL SYMBOLS

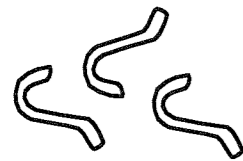

BOULDER CONSTRUCTED RIFFLE

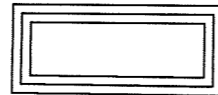

WOOD AND GRAVEL RIFFLE

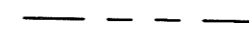

CONSERVATION EASEMENT



LOG STEP POOL

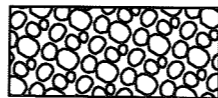

FORD CROSSING

EXISTING INDEX CONTOUR

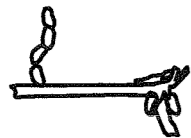

LOG VANE W/
ROCK J-HOOK



EXISTING WETLAND

EXISTING INTERIM CONTOUR



WOODY DEBRIS / BRUSH
TOE PROTECTION / MATTRESS



PROPOSED WETLAND
CREATION

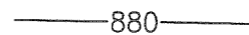

INDEX CONTOUR



PROPOSED WETLAND
RESTORATION



INTERIM CONTOUR



BOULDER CROSS-VANE

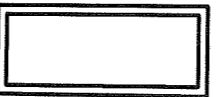

VEGETATION
MONITORING PLOT

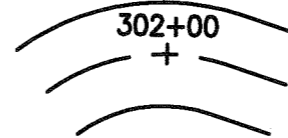

THALWEG



BOULDER CROSS-VANE
W/ STEP



BANKFULL

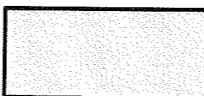

RIPRAP



Stantec Consulting Services Inc.
2127 Ayrley Town Blvd., Suite 300
Charlotte NC U.S.A.
28273
Tel. 704.329.0900
Fax. 704.329.0905
www.stantec.com
License No. F-0672

Stantec

Copyright Reserved
The Contractor shall verify and be responsible for all dimensions. DO NOT scale the drawing - any errors or omissions shall be reported to Stantec without delay.
The Copyright to all designs and drawings are the property of Stantec. Reproduction or use for any purpose other than that authorized by Stantec is forbidden.

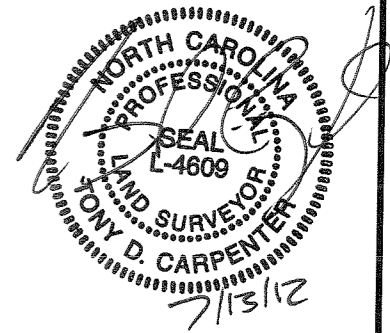

REVISIONS			
NO.	DATE	BY	DESCRIPTION

CERTIFICATION AND SEAL

AS-BUILT

PROJECT NAME
AS-BUILT SURVEY OF NORTH FORK
MOUNTAIN CREEK STREAM RESTORATION
CATAWBA COUNTY, NORTH CAROLINA

DRAWING TITLE
LEGEND AND SYMBOLS

CADD PLOT:	SCALE: N/A	SHEET NO.
VOID PLOT:	DRAWN BY: R.R.P.	1.1
RELEASED TO CONSTRUCTION	DATE: 07-13-12	
	REVIEWED BY: T.T.	



Stantec Consulting Services Inc.
 2127 Ayrley Town Blvd., Suite 300
 Charlotte NC U.S.A.
 28273
 Tel: 704.329.0900
 Fax: 704.329.0905
 www.stantec.com
 License No. F-0672

Stantec

Copyright Reserved
 The Contractor shall verify and be responsible for all dimensions. DO NOT scale the drawing - any errors or omissions shall be reported to Stantec without delay.
 The Copyrights to all designs and drawings are the property of Stantec. Reproduction or use for any purpose other than that authorized by Stantec is forbidden.

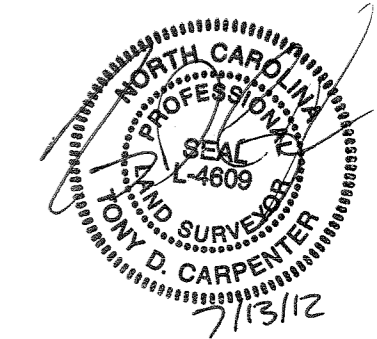

REVISIONS

NO.	DATE	BY	DESCRIPTION

CERTIFICATION AND SEAL

AS-BUILT

PROJECT NAME
 AS-BUILT SURVEY OF NORTH FORK MOUNTAIN CREEK STREAM RESTORATION CATAWBA COUNTY, NORTH CAROLINA

KEY SHEET

CADD PLOT:	SCALE: N/A	SHEET NO.
VOID PLOT:	DRAWN BY: R.R.P.	2.2
RELEASED TO CONSTRUCTION	DATE: 07-13-12	
	REVIEWED BY: T.T.	



BEGIN
 UT 2 REACH 3
 STA: 200+00
 N: 691901.85
 E: 1379502.72

END
 UT 2 REACH 3
 STA: 206+69.71
 N: 691769.92
 E: 1380118.66

BEGIN
 UT 1 REACH 1
 STA: 100+00
 N: 692240.92
 E: 1379849.31

END UT 1 REACH 1
 BEGIN UT 1 REACH 2
 STA: 107+19.70
 N: 691656.95
 E: 1380208.05

END
 NORTH FORK MOUNTAIN CREEK
 REACH 4
 STA: 321+95.4
 N: 690488.28
 E: 1381399.59

END
 UT 1 REACH 2
 STA: 124+17.8
 N: 690509.11
 E: 1381359.18

BEGIN
 NORTH FORK MOUNTAIN CREEK
 REACH 4
 STA: 300+00
 N: 689349.66
 E: 1380047.10

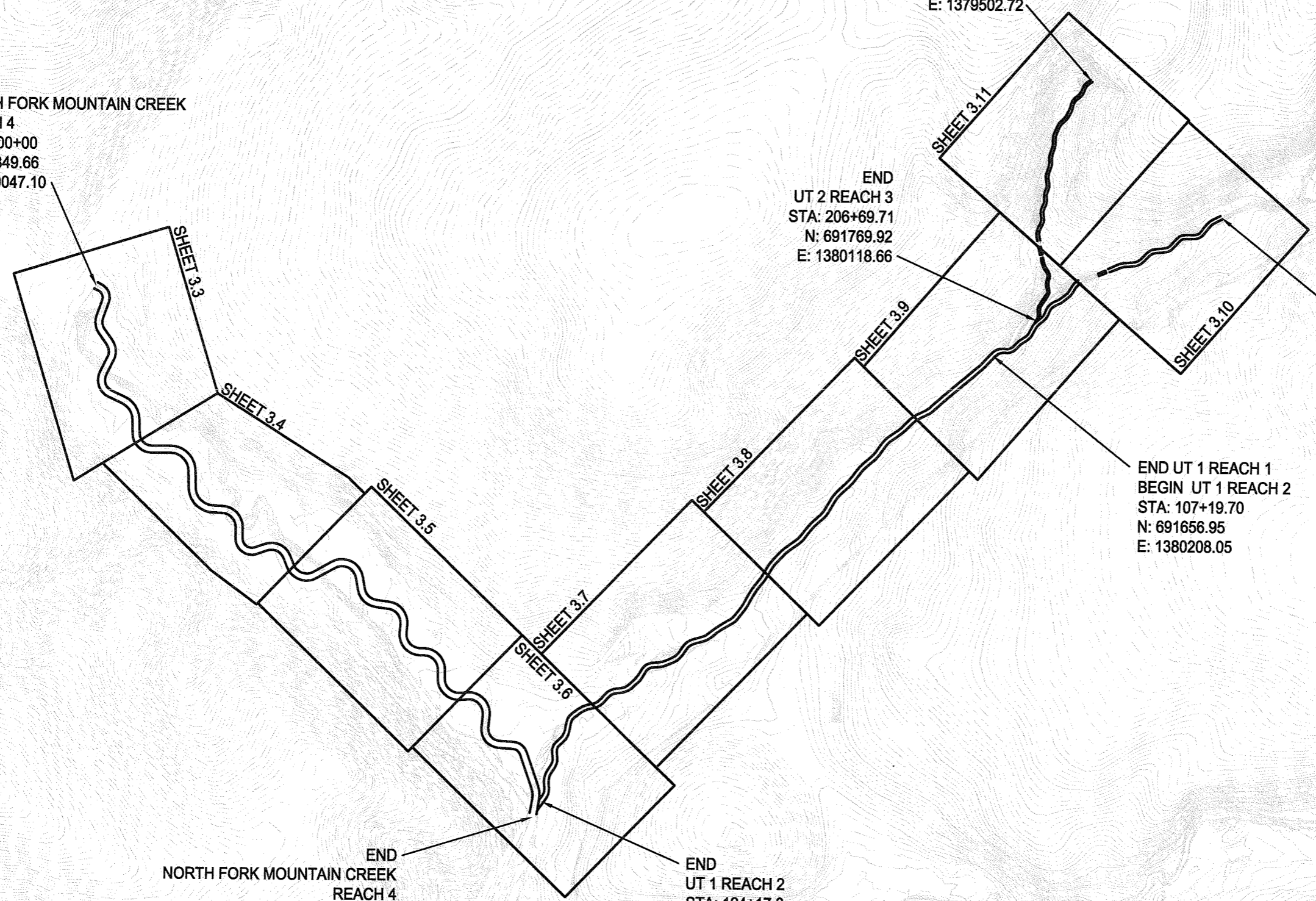

S:\projects\2012\07\13_1_05_P\130713_1_05_P\130713_1_05_P.dwg
 \Users\rrp\OneDrive\Projects\130713_1_05_P\130713_1_05_P.dwg
 \Users\rrp\OneDrive\Projects\130713_1_05_P\130713_1_05_P.dwg



Stantec Consulting Services Inc.
 2127 Ayrley Town Blvd., Suite 300
 Charlotte NC U.S.A.
 28273
 Tel. 704.329.0900
 Fax. 704.329.0905
 www.stantec.com
 License No. F-0672

Stantec

Copyright Reserved

The Contractor shall verify and be responsible for all dimensions. DO NOT scale the drawing - any errors or omissions shall be reported to Stantec without delay.
 The Copyrights to all designs and drawings are the property of Stantec. Reproduction or use for any purpose other than that authorized by Stantec is forbidden.

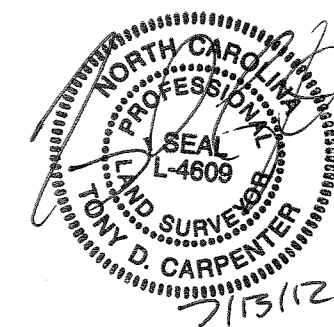

REVISIONS

NO.	DATE	BY	DESCRIPTION

CERTIFICATION AND SEAL

AS-BUILT

PROJECT NAME
 AS-BUILT SURVEY OF NORTH FORK MOUNTAIN CREEK STREAM RESTORATION CATAWBA COUNTY, NORTH CAROLINA

DRAWING TITLE
AS-BUILT PLAN SHEET

CADD PLOT:	SCALE: N/A	SHEET NO.
VOID PLOT:	DRAWN BY: R.R.P.	3.3
RELEASED TO CONSTRUCTION	DATE: 07-13-12	
	REVIEWED BY: T.T.	

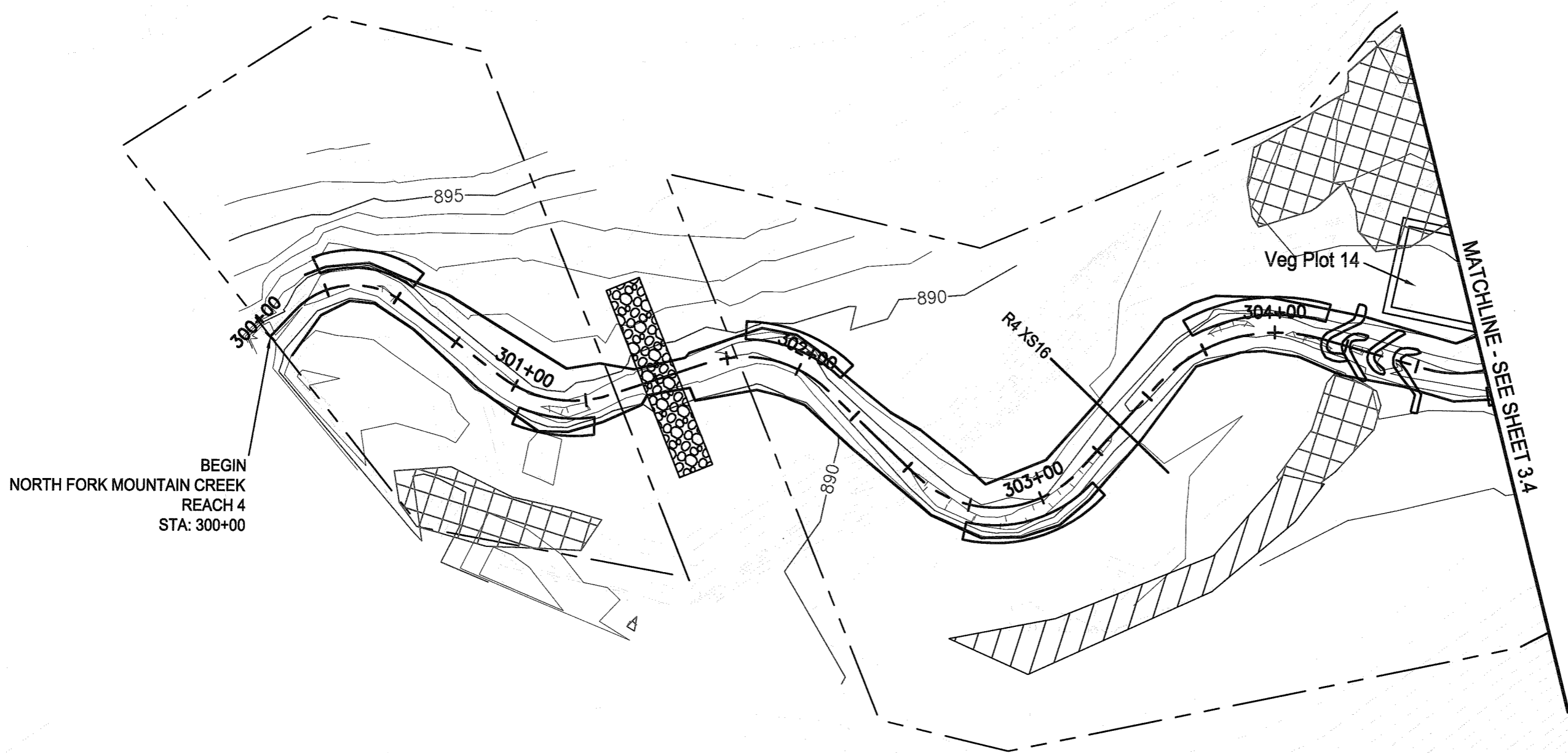

BEGIN
 NORTH FORK MOUNTAIN CREEK
 REACH 4
 STA: 300+00



Sonobase: 2012/07/13 4:38 PM Login: Perty, Richard
 \\V:\2012-07-13\2012-07-13\AS-BUILT\Drawings\Sheet - Files\04.dwg\130713-303.dwg



Stantec Consulting Services Inc.
 2127 Ayrley Town Blvd., Suite 300
 Charlotte NC U.S.A.
 28273
 Tel. 704.329.0900
 Fax. 704.329.0905
 www.stantec.com
 License No. F-0672

Stantec

Copyright Reserved

The Contractor shall verify and be responsible for all dimensions. DO NOT scale the drawing - any errors or omissions shall be reported to Stantec without delay.
 The Copyrights to all designs and drawings are the property of Stantec. Reproduction or use for any purpose other than that authorized by Stantec is forbidden.

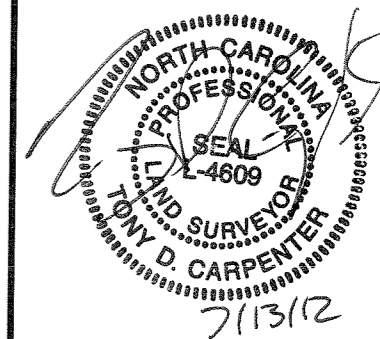

REVISIONS

NO.	DATE	BY	DESCRIPTION

CERTIFICATION AND SEAL

AS-BUILT

PROJECT NAME
 AS-BUILT SURVEY FOR NORTH FORK
 MOUNTAIN CREEK STREAM RESTORATION
 CATAWBA COUNTY, NORTH CAROLINA

DRAWING TITLE
AS-BUILT PLAN SHEET

CADD PLOT:	SCALE: N/A	SHEET NO.
VOID PLOT:	DRAWN BY: R.R.P.	3.4
RELEASED TO CONSTRUCTION	DATE: 07-13-12	
	REVIEWED BY: T.T.	

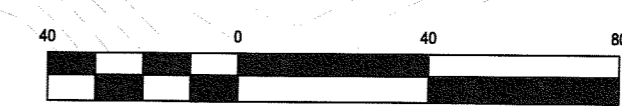
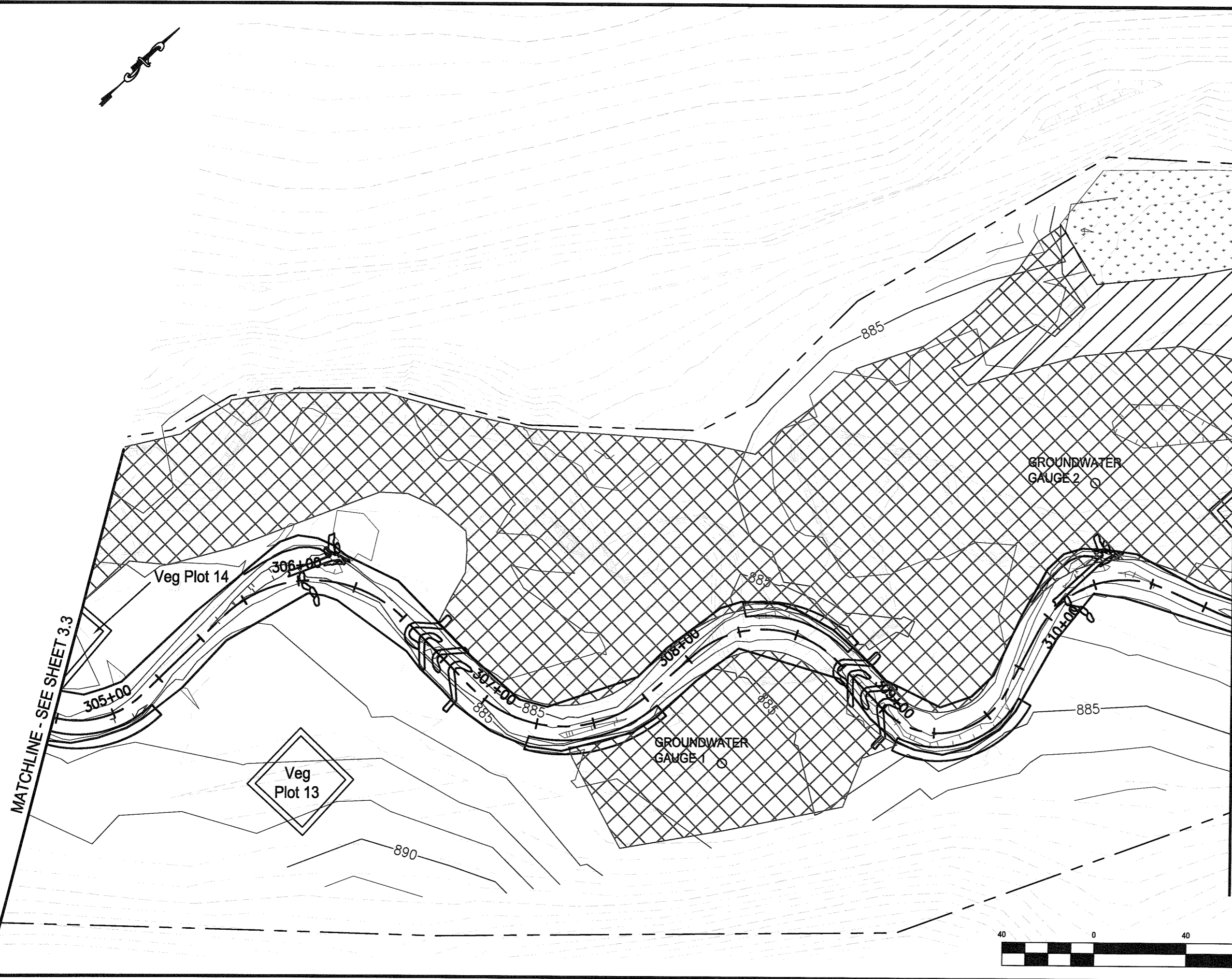

SaveDate: 2012/07/13 4:38 PM Login: Pety, Richard
 \\va1225-101\shared_projects\75613007\cadd\drawing\sheet_files\va_built_awn\3007c-303.dwg



Stantec Consulting Services Inc.
 2127 Ayrley Town Blvd., Suite 300
 Charlotte NC U.S.A.
 28273
 Tel. 704.329.0900
 Fax. 704.329.0905
 www.stantec.com
 License No. F-0672

Stantec

Copyright Reserved
 The Contractor shall verify and be responsible for all dimensions. DO NOT scale the drawing - any errors or omissions shall be reported to Stantec without delay.
 The Copyrights to all designs and drawings are the property of Stantec. Reproduction or use for any purpose other than that authorized by Stantec is forbidden.

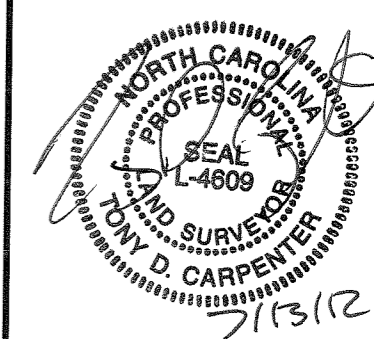

REVISIONS

NO.	DATE	BY	DESCRIPTION

CERTIFICATION AND SEAL

AS-BUILT

PROJECT NAME
 AS-BUILT SURVEY OF NORTH FORK
 MOUNTAIN CREEK STREAM RESTORATION
 CATAWBA COUNTY, NORTH CAROLINA

DRAWING TITLE
AS-BUILT PLAN SHEET

CADD PLOT:	SCALE: N/A	SHEET NO.
VOID PLOT:	DRAWN BY: R.R.P.	3.5
RELEASED TO CONSTRUCTION	DATE: 07-13-12	
	REVIEWED BY: T.T.	

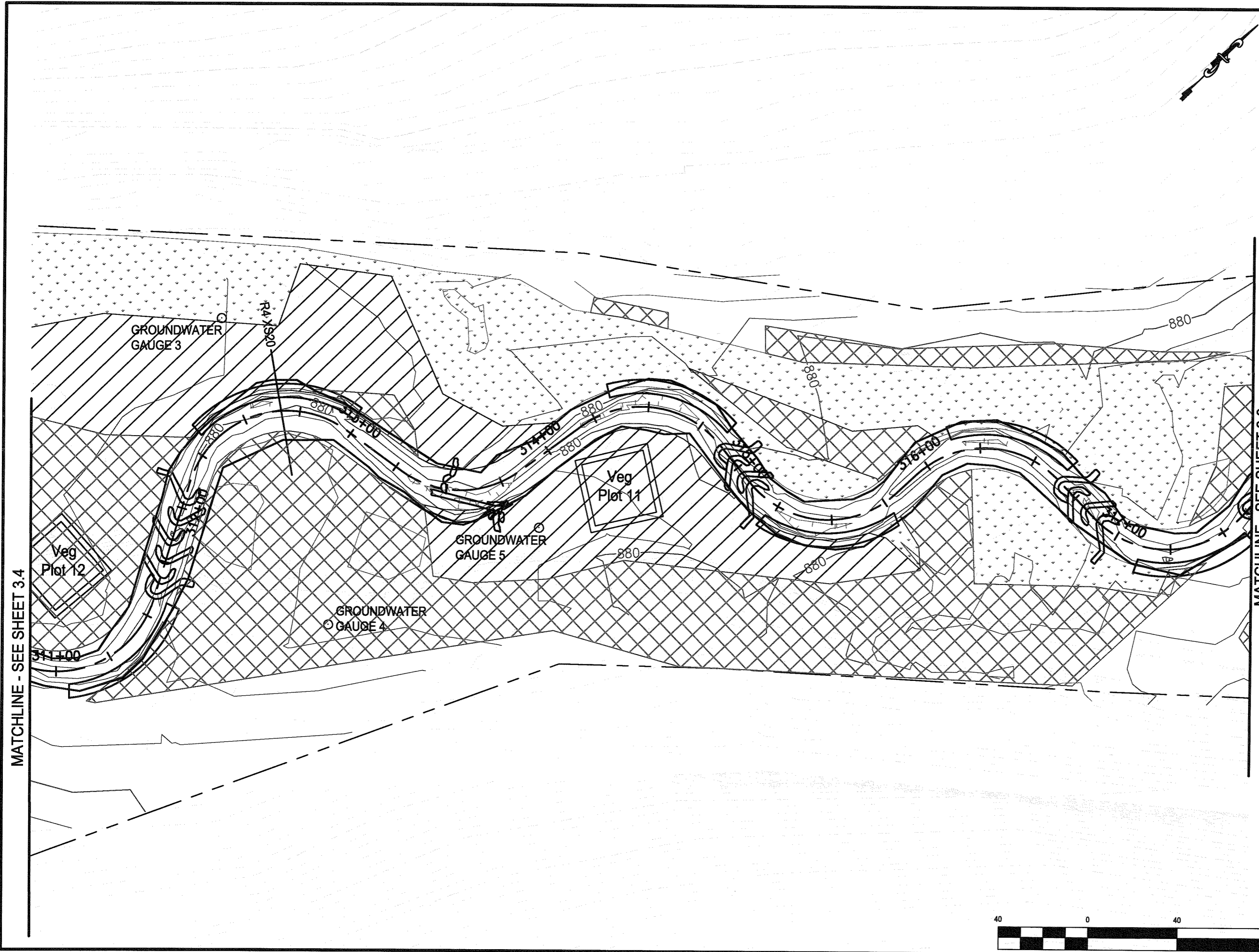

MATCHLINE - SEE SHEET 3.4

MATCHLINE - SEE SHEET 3.6

SaveDate: 2012/07/13 4:38 PM Login: Petty, Richard \\us1225-101\Users\c...project\176613007\civil_drawing\sheet\flex\as-built\asf\13007-3.5.dwg

MATCHLINE - SEE SHEET 3.7

MATCHLINE - SEE SHEET 3.5

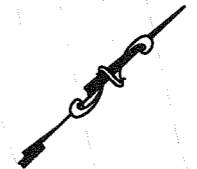
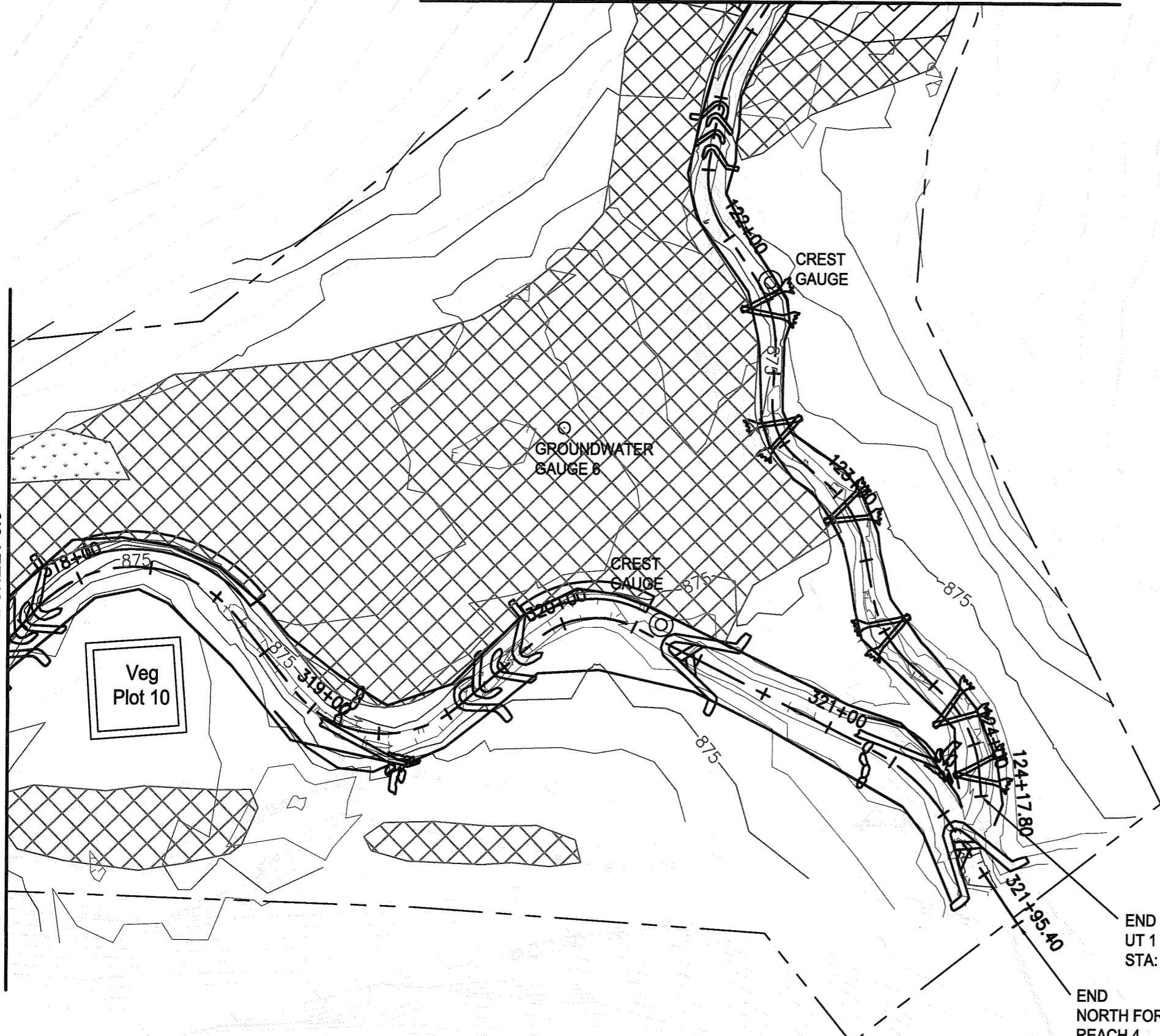

Stantec
 Stantec Consulting Services Inc.
 2127 Ayrley Town Blvd., Suite 300
 Charlotte NC U.S.A.
 28273
 Tel. 704.329.0900
 Fax. 704.329.0905
 www.stantec.com
 License No. F-0672

Copyright Reserved
 The Contractor shall verify and be responsible for all dimensions. DO NOT scale the drawing - any errors or omissions shall be reported to Stantec without delay.
 The Copyrights to all designs and drawings are the property of Stantec. Reproduction or use for any purpose other than that authorized by Stantec is forbidden.

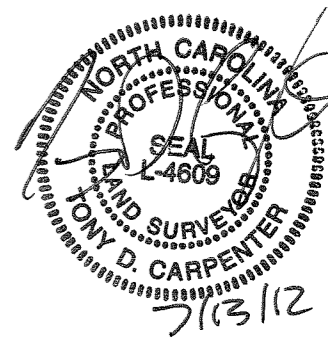

REVISIONS			
NO.	DATE	BY	DESCRIPTION

CERTIFICATION AND SEAL

AS-BUILT

PROJECT NAME
 AS-BUILT SURVEY OF NORTH FORK MOUNTAIN CREEK STREAM RESTORATION CATAWBA COUNTY, NORTH CAROLINA

DRAWING TITLE
AS-BUILT PLAN SHEET

CADD PLOT:	SCALE: N/A	SHEET NO.
VOID PLOT:	DRAWN BY: R.R.P.	3.6
RELEASED TO CONSTRUCTION	DATE: 07-13-12	
	REVIEWED BY: T.T.	

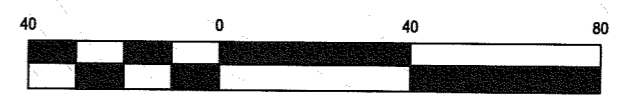

SaveDate: 2012/07/13 4:38 PM Login: Peaty, Richard
 C:\Users\peaty\Documents\Projects\1736\AS-BUILT\Drawings\Sheet_Hatch\as-built.dwg 13072-303.dwg



Stantec Consulting Services Inc.
 2127 Ayrley Town Blvd., Suite 300
 Charlotte NC U.S.A.
 28273
 Tel. 704.329.0900
 Fax. 704.329.0905
 www.stantec.com
 License No. F-0672

Stantec

Copyright Reserved

The Contractor shall verify and be responsible for all dimensions. DO NOT scale the drawing - any errors or omissions shall be reported to Stantec without delay.
 The Copyrights to all designs and drawings are the property of Stantec. Reproduction or use for any purpose other than that authorized by Stantec is forbidden.

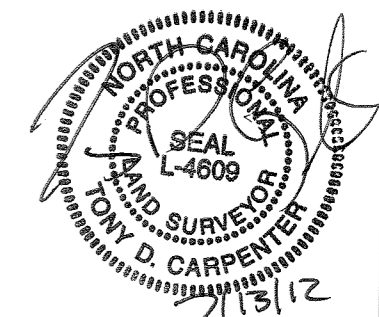

REVISIONS

NO.	DATE	BY	DESCRIPTION

CERTIFICATION AND SEAL

AS-BUILT

PROJECT NAME
 AS-BUILT SURVEY OF NORTH FORK
 MOUNTAIN CREEK STREAM RESTORATION
 CATAWBA COUNTY, NORTH CAROLINA

DRAWING TITLE
AS-BUILT PLAN SHEET

CADD PLOT:	SCALE: N/A	SHEET NO.
VOID PLOT:	DRAWN BY: R.R.P.	3.7
RELEASED TO CONSTRUCTION	DATE: 07-13-12	
	REVIEWED BY: T.T.	

MATCHLINE - SEE SHEET 3.6

MATCHLINE - SEE SHEET 3.8

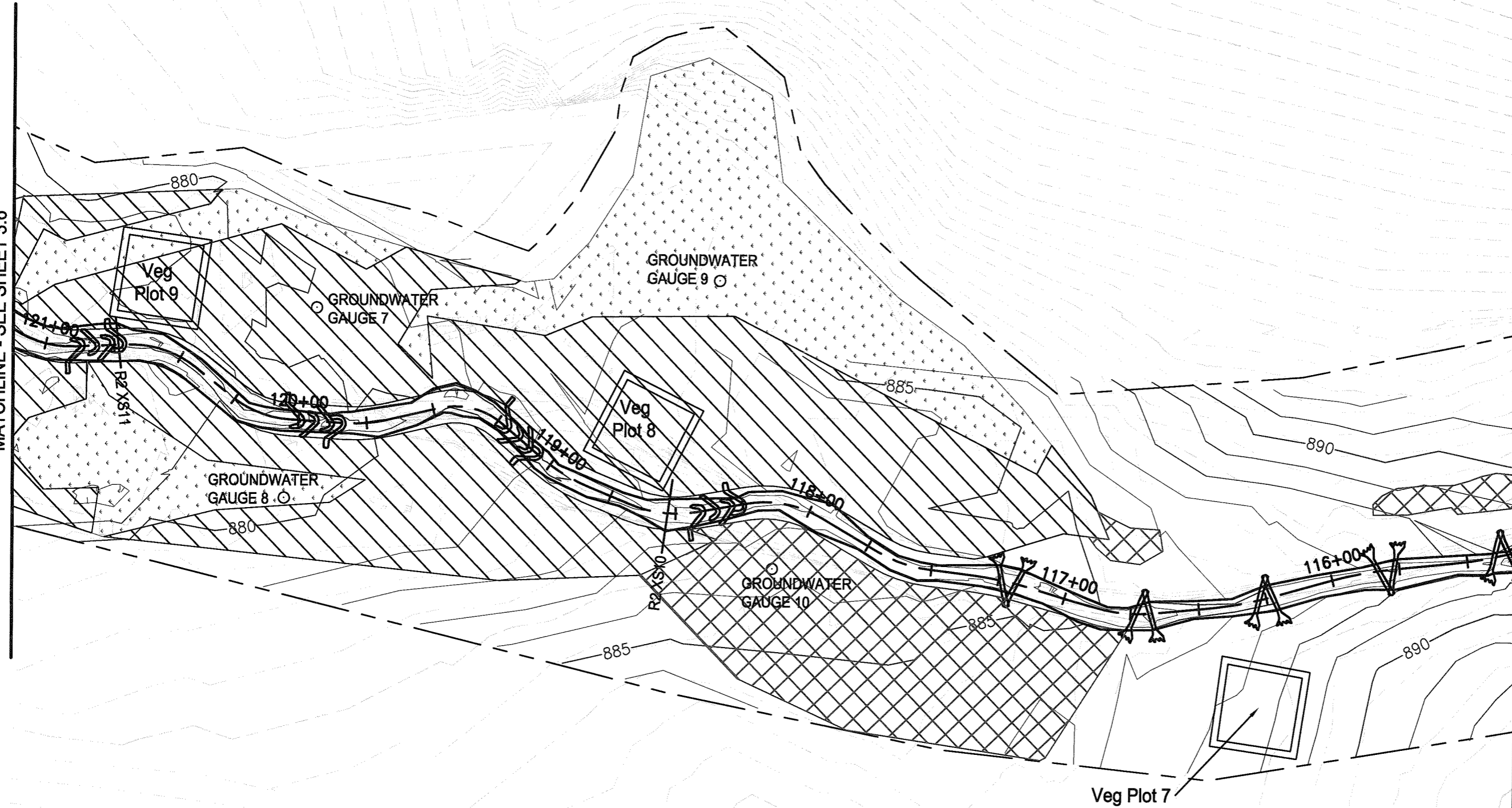

Saved as: 01/27/13 4:38 PM Login: Pelly, Richard
 \\V:\250-01\Work\Projects\12012007\North Fork Mountain Creek Stream Restoration\Drawings\12012007-303.dwg



Stantec

Stantec Consulting Services Inc.
2127 Ayrley Town Blvd., Suite 300
Charlotte NC U.S.A.
28273
Tel: 704.329.0900
Fax: 704.329.0905
www.stantec.com
License No. F-0672

Copyright Reserved

The Contractor shall verify and be responsible for all dimensions. DO NOT scale the drawing - any errors or omissions shall be reported to Stantec without delay.
The Copyrights to all designs and drawings are the property of Stantec. Reproduction or use for any purpose other than that authorized by Stantec is forbidden.

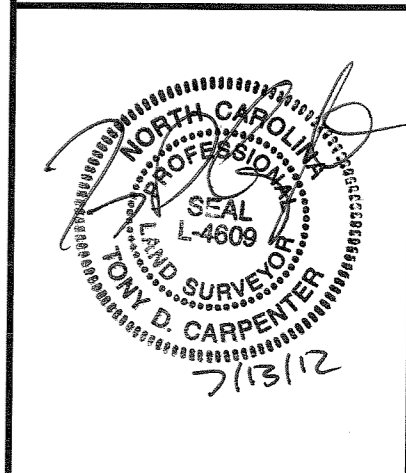

REVISIONS			
NO.	DATE	BY	DESCRIPTION

CERTIFICATION AND SEAL

AS-BUILT

PROJECT NAME
AS-BUILT SURVEY OF NORTH FORK
MOUNTAIN CREEK STREAM RESTORATION
CATAWBA COUNTY, NORTH CAROLINA

DRAWING TITLE
AS-BUILT PLAN SHEET

CADD PLOT:	SCALE: N/A	SHEET NO.
VOID PLOT:	DRAWN BY: R.R.P.	3.8
RELEASED TO CONSTRUCTION	DATE: 07-13-12 REVIEWED BY: T.T.	

MATCHLINE - SEE SHEET 3.7

MATCHLINE - SEE SHEET 3.9

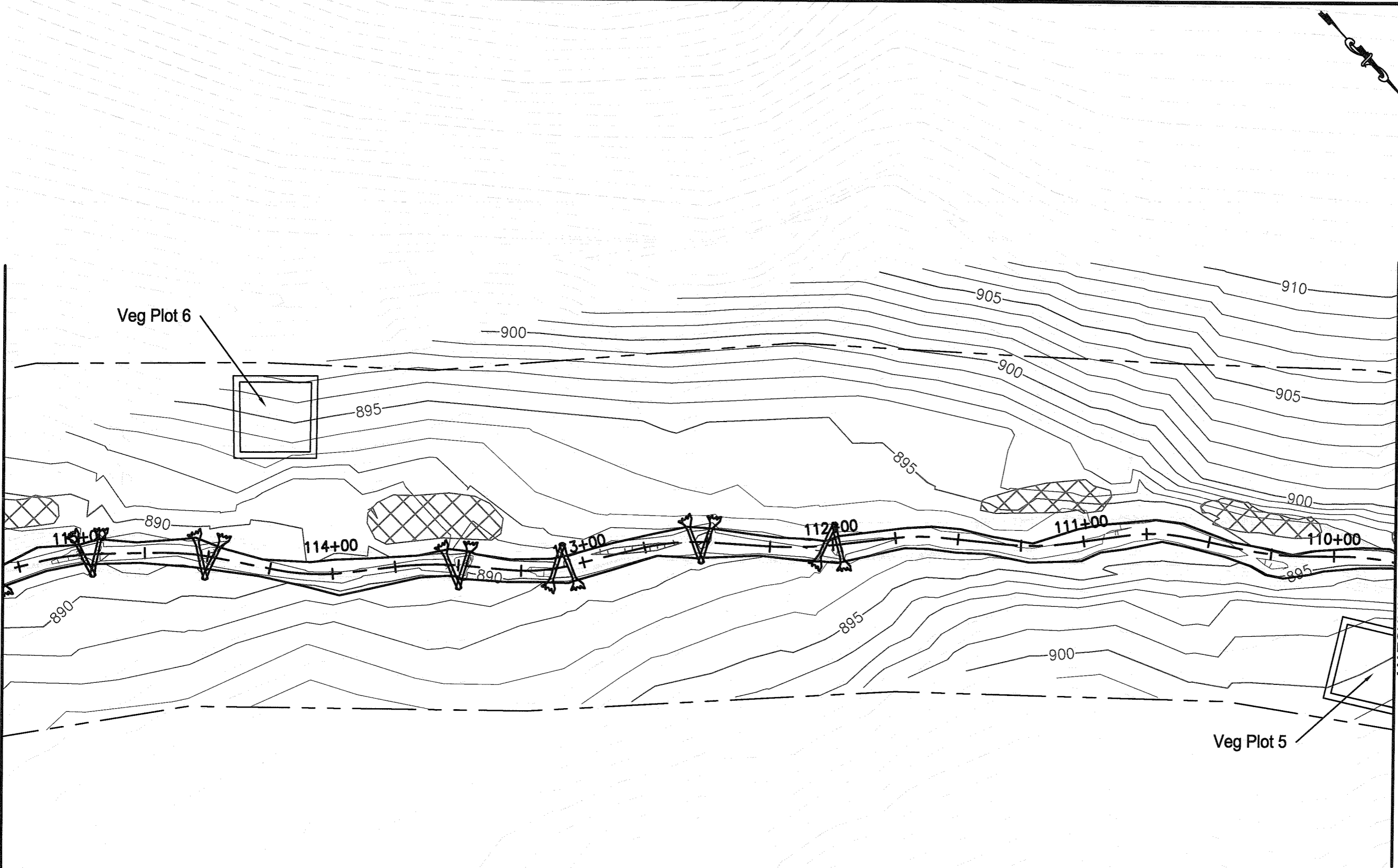

\\saw1225-401\stecrad_projects\125813002\cadd\drawing\sheet_files\as-built\as-built.dwg
4:38 PM 7/13/12

MATCHLINE - SEE SHEET 3.8

MATCHLINE - SEE SHEET 3.11

MATCHLINE - SEE SHEET 3.10

END
UT 2 REACH 3
STA: 206+69.71

Farm Road

END UT 1 REACH 1
BEGIN UT 2 REACH 2
STA: 107+19.70



Stantec Consulting Services Inc.
2127 Ayrley Town Blvd., Suite 300
Charlotte NC U.S.A. 28273
Tel. 704.329.0900
Fax. 704.329.0905
www.stantec.com
License No. F-0672

Stantec

Copyright Reserved
The Contractor shall verify and be responsible for all dimensions. DO NOT scale the drawing - any errors or omissions shall be reported to Stantec without delay.
The Copyright to all designs and drawings are the property of Stantec. Reproduction or use for any purpose other than that authorized by Stantec is forbidden.

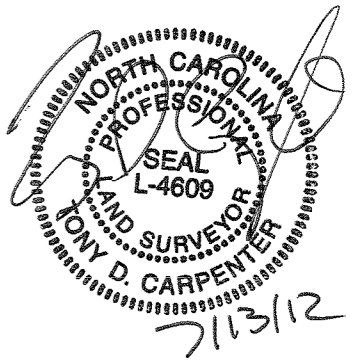

REVISIONS

NO.	DATE	BY	DESCRIPTION

CERTIFICATION AND SEAL

AS-BUILT

PROJECT NAME
AS-BUILT SURVEY OF NORTH FORK
MOUNTAIN CREEK STREAM RESTORATION
CATAWBA COUNTY, NORTH CAROLINA

AS-BUILT PLAN SHEET

CADD PLOT:	SCALE: N/A	SHEET NO.
VOID PLOT:	DRAWN BY: R.R.P.	3.9
RELEASED TO CONSTRUCTION	DATE: 07-13-12	
	REVIEWED BY: I.T.	

SaveDate: 2012/07/13 4:38 PM Login: Petty, Richard
 \\va11225-01\shared_projects\175615007\Civil\Drawing\Sheet\13007c-303.dwg

MATCHLINE - SEE SHEET 3.9

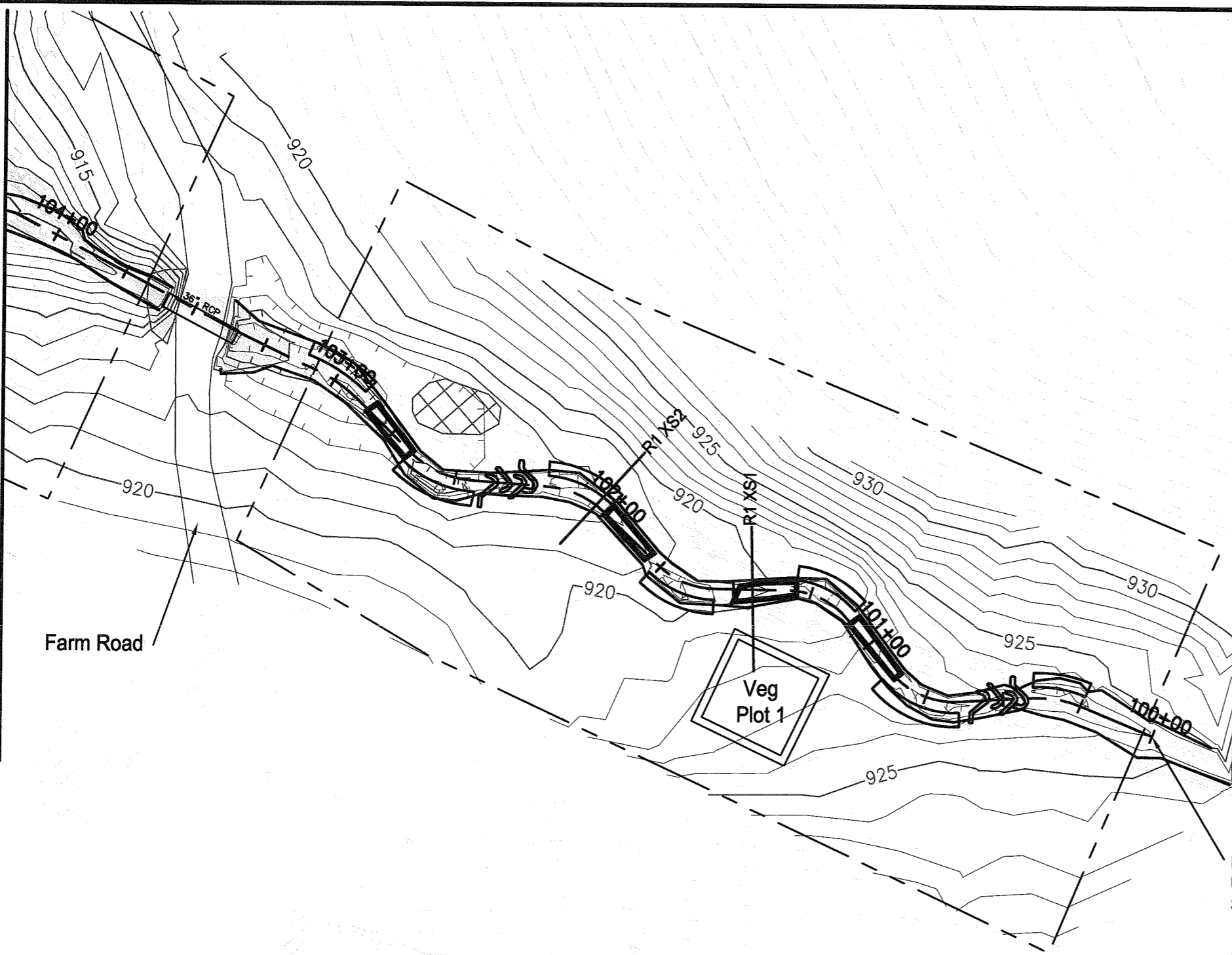

BEGIN
UT 1 REACH 1
STA: 100+00



Stantec Consulting Services Inc.
2127 Ayrley Town Blvd., Suite 300
Charlotte NC U.S.A.
28273
Tel. 704.329.0900
Fax. 704.329.0905
www.stantec.com
License No. 7-0672

Copyright Reserved
The Contractor shall verify and be responsible for all dimensions. DO NOT scale the drawing - any errors or omissions shall be reported to Stantec without delay.
The Copyrights to all designs and drawings are the property of Stantec. Reproduction or use for any purpose other than that authorized by Stantec is forbidden.

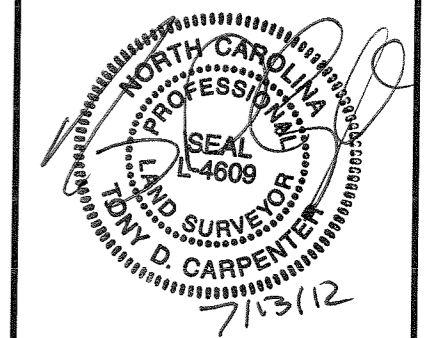

REVISIONS			
NO.	DATE	BY	DESCRIPTION

CERTIFICATION AND SEAL

AS-BUILT

PROJECT NAME
AS-BUILT SURVEY OF NORTH FORK
MOUNTAIN CREEK STREAM RESTORATION
CATAWBA COUNTY, NORTH CAROLINA

DRAWING TITLE
AS-BUILT PLAN SHEET

CADD PLOT:	SCALE: N/A	SHEET NO.
VOID PLOT:	DRAWN BY: R.R.P.	3.10
RELEASED TO CONSTRUCTION	DATE: 07-13-12	
	REVIEWED BY: T.T.	



SaveDate: 2012/07/13 4:38 PM Login: Petty, Richard
 \\s1225-01\shared_projects\17861807\001\drawing\sheet_files\as-built\set\13007r-303.dwg

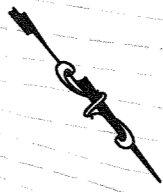

Stantec Consulting Services Inc.
 2127 Ayrley Town Blvd., Suite 300
 Charlotte NC U.S.A.
 28273
 Tel. 704.329.0900
 Fax. 704.329.0905
 www.stantec.com
 License No. F-0672

Stantec

Copyright Reserved
 The Contractor shall verify and be responsible for all dimensions. DO NOT scale the drawing - any errors or omissions shall be reported to Stantec without delay.
 The Copyrights to all designs and drawings are the property of Stantec. Reproduction or use for any purpose other than that authorized by Stantec is forbidden.

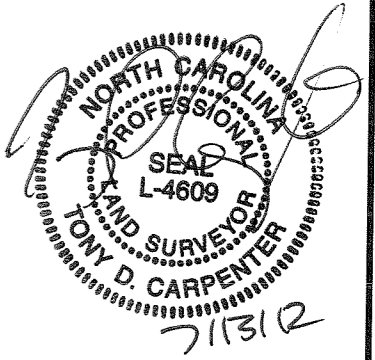

REVISIONS			
NO.	DATE	BY	DESCRIPTION

CERTIFICATION AND SEAL

AS-BUILT

PROJECT NAME
 AS-BUILT SURVEY OF NORTH FORK
 MOUNTAIN CREEK STREAM RESTORATION
 CATAWBA COUNTY, NORTH CAROLINA

DRAWING TITLE
AS-BUILT PLAN SHEET

CADD PLOT:	SCALE: N/A	SHEET NO.
VOID PLOT:	DRAWN BY: R.R.P.	3.11
RELEASED TO CONSTRUCTION	DATE: 07-13-12	
	REVIEWED BY: T.T.	

MATCHLINE - SEE SHEET 3.9



S:\Projects\0712\0713_438_PV_Login_Petty_Richard
 \V\Projects\0712\0713_438_PV_Login_Petty_Richard\Drawings\Sheet_3.11.dwg
 7/13/12 10:00 AM

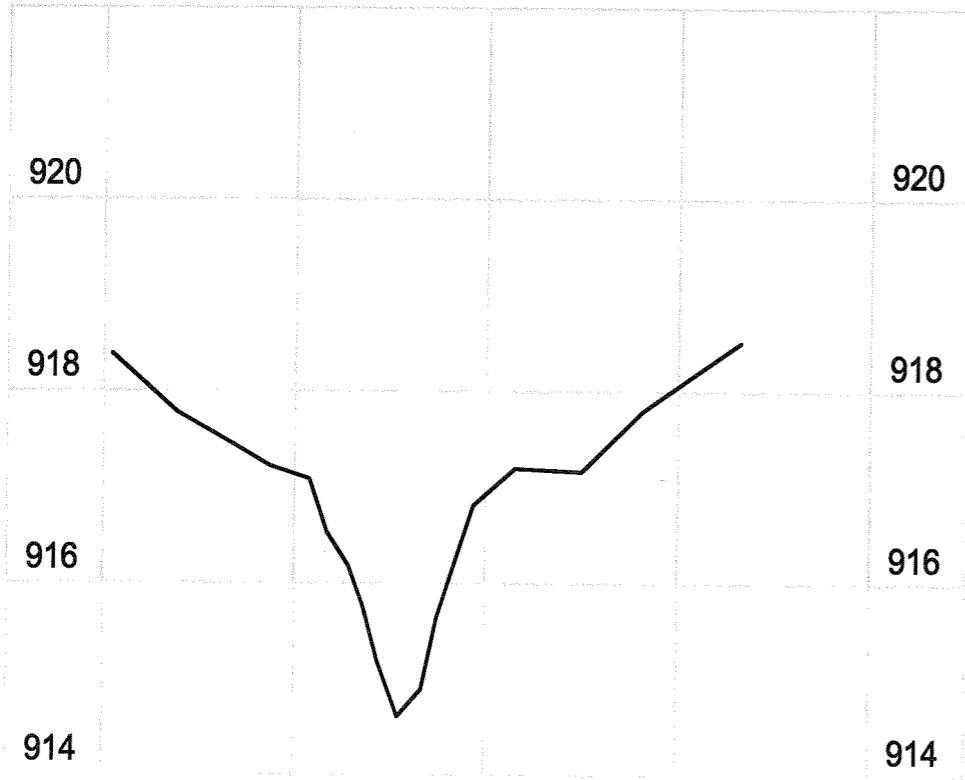

REACH 3 - XS13 - POOL

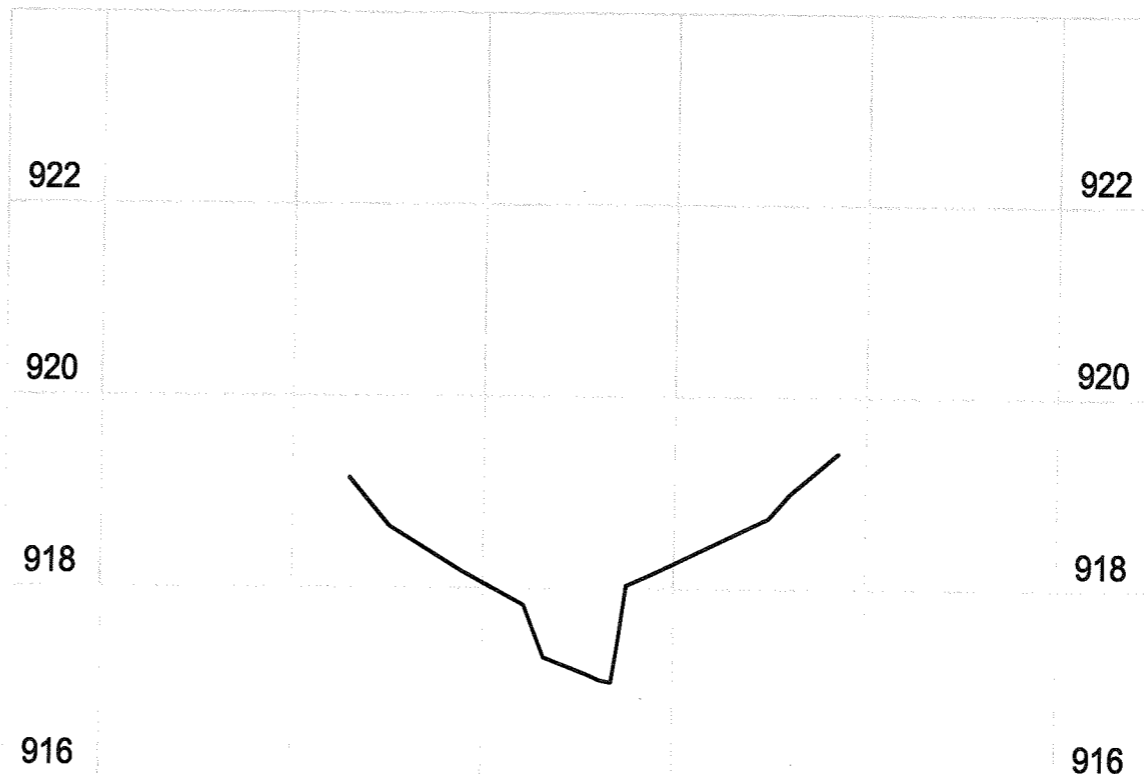

REACH 3 - XS12 - RIFFLE

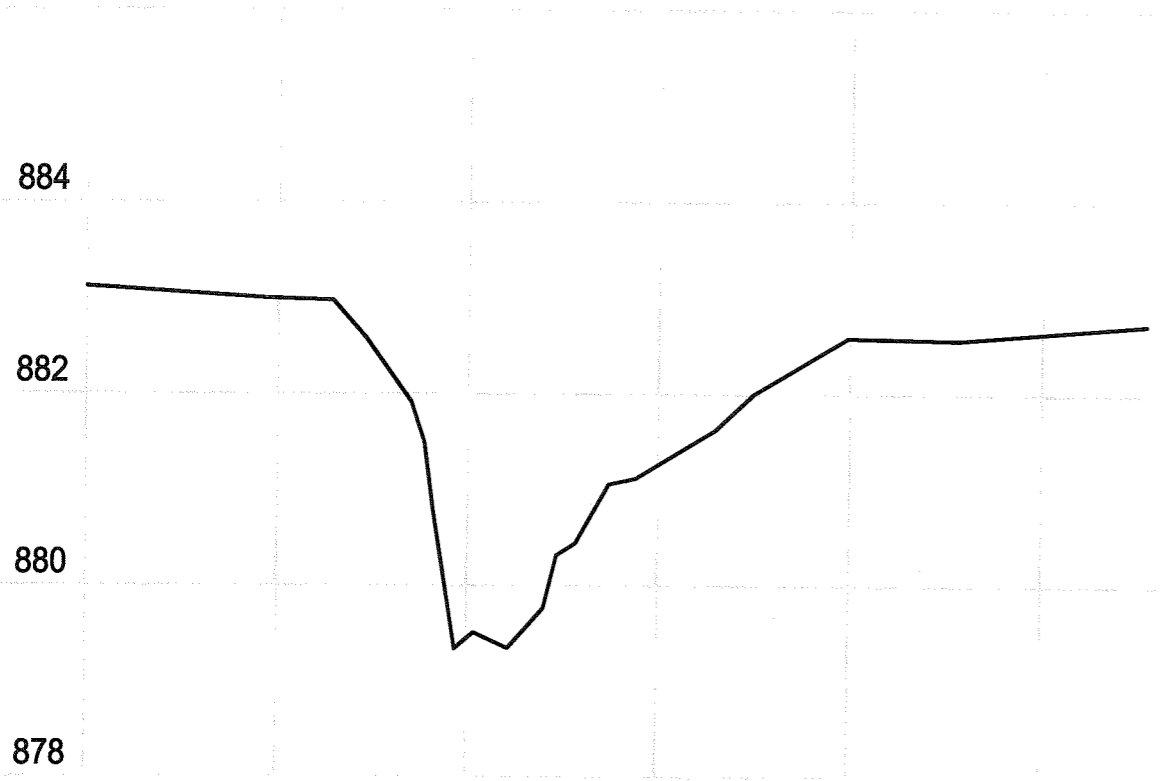

REACH 4 - XS20 - POOL



REACH 4 - XS16 - RIFFLE



Stantec Consulting Services Inc.
 2127 Ayrley Town Blvd., Suite 300
 Charlotte NC U.S.A.
 28273
 Tel. 704.329.0900
 Fax. 704.329.0905
 www.stantec.com
 License No. F-0672

Stantec

Copyright Reserved
 The Contractor shall verify and be responsible for all dimensions. DO NOT scale the drawing - any errors or omissions shall be reported to Stantec without delay.
 The Copyright to all designs and drawings are the property of Stantec. Reproduction or use for any purpose other than that authorized by Stantec is forbidden.

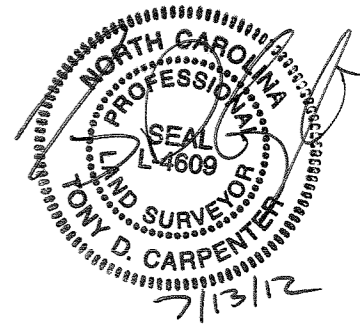

REVISIONS			
NO.	DATE	BY	DESCRIPTION

CERTIFICATION AND SEAL

AS-BUILT

PROJECT NAME
 AS-BUILT SURVEY OF NORTH FORK MOUNTAIN CREEK STREAM RESTORATION CATAWBA COUNTY, NORTH CAROLINA

DRAWING TITLE
AS-BUILT TYPICAL SECTION SHEET

CADD PLOT:	SCALE: N/A	SHEET NO.
VOID PLOT:	DRAWN BY: R.R.P.	4.13
RELEASED TO CONSTRUCTION	DATE: 07-13-12	
	REVIEWED BY: T.T.	

SCALE: 1"=10' HORZ.
 1"= 2' VERT.

SaveDate: 2012/07/13 2:28 PM Login: Pelly, Richard
 \\va1225-01\shared_projects\175813007\civil\drawing\sheet_files\va1225-01\3007-412.dwg

AS-BUILT PROFILE - UT 1 REACH 1 & REACH 2

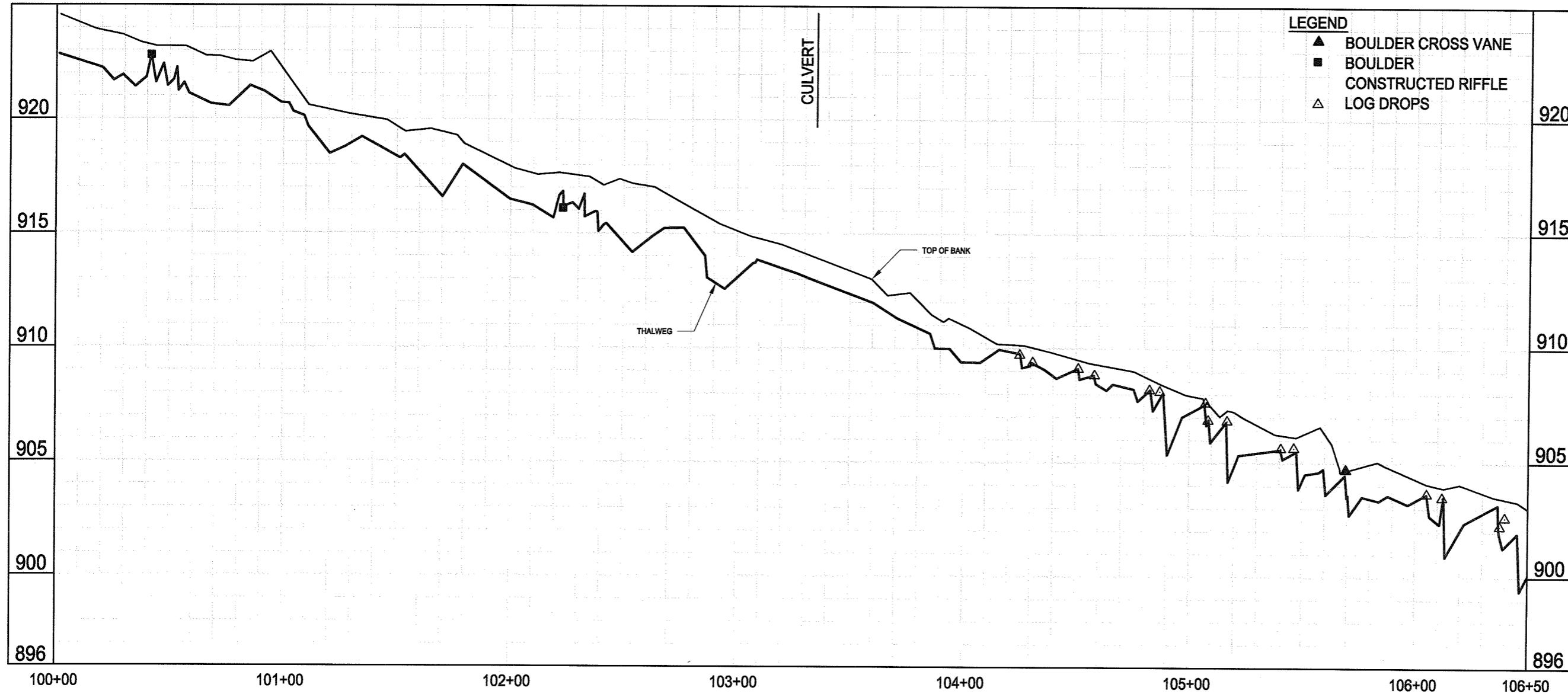

AS-BUILT PROFILE - UT 1 REACH 1 & REACH 2

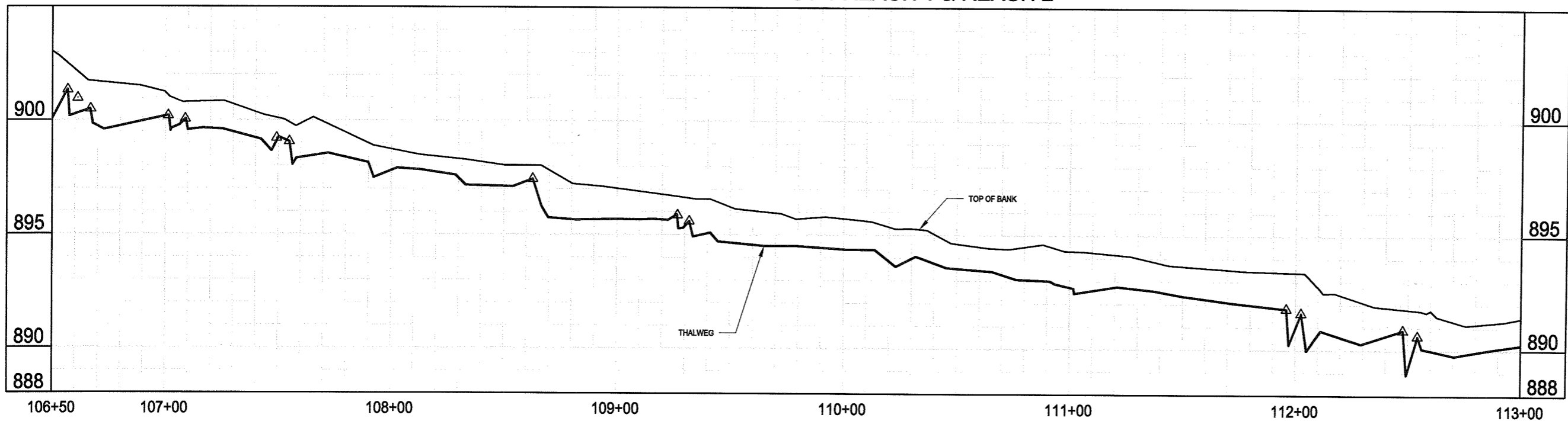

LEGEND

- ▲ BOULDER CROSS VANE
- BOULDER
- CONSTRUCTED RIFFLE
- ▽ LOG DROPS



Stantec

Stantec Consulting Services Inc.
 2127 Ayrley Town Blvd., Suite 300
 Charlotte NC U.S.A.
 28273
 Tel. 704.329.0900
 Fax. 704.329.0905
 www.stantec.com
 License No. F-0672

Copyright Reserved

The Contractor shall verify and be responsible for all dimensions. DO NOT scale the drawing - any errors or omissions shall be reported to Stantec without delay.
 The Copyrights to all designs and drawings are the property of Stantec. Reproduction or use for any purpose other than that authorized by Stantec is forbidden.

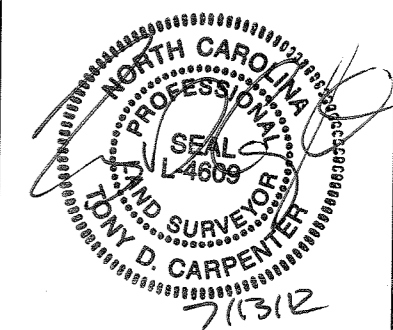

REVISIONS

NO.	DATE	BY	DESCRIPTION

CERTIFICATION AND SEAL

AS-BUILT

PROJECT NAME
 AS-BUILT SURVEY OF NORTH FORK
 MOUNTAIN CREEK STREAM RESTORATION
 CATAWBA COUNTY, NORTH CAROLINA

DRAWING TITLE
AS-BUILT PROFILE SHEET

CADD PLOT:	SCALE: N/A	SHEET NO.
VOID PLOT:	DRAWN BY: R.R.P.	5.14
RELEASED TO CONSTRUCTION	DATE: 07-13-12	
	REVIEWED BY: T.T.	

Savedate: 2012/07/13 2:25 PM Login: Pety, Richard
 \\un1225-10\shared_projects\75613007\Civil\Drawing\Sheet\As-Built\set\30072-514.dwg

AS-BUILT PROFILE - UT 1 REACH 1 & REACH 2

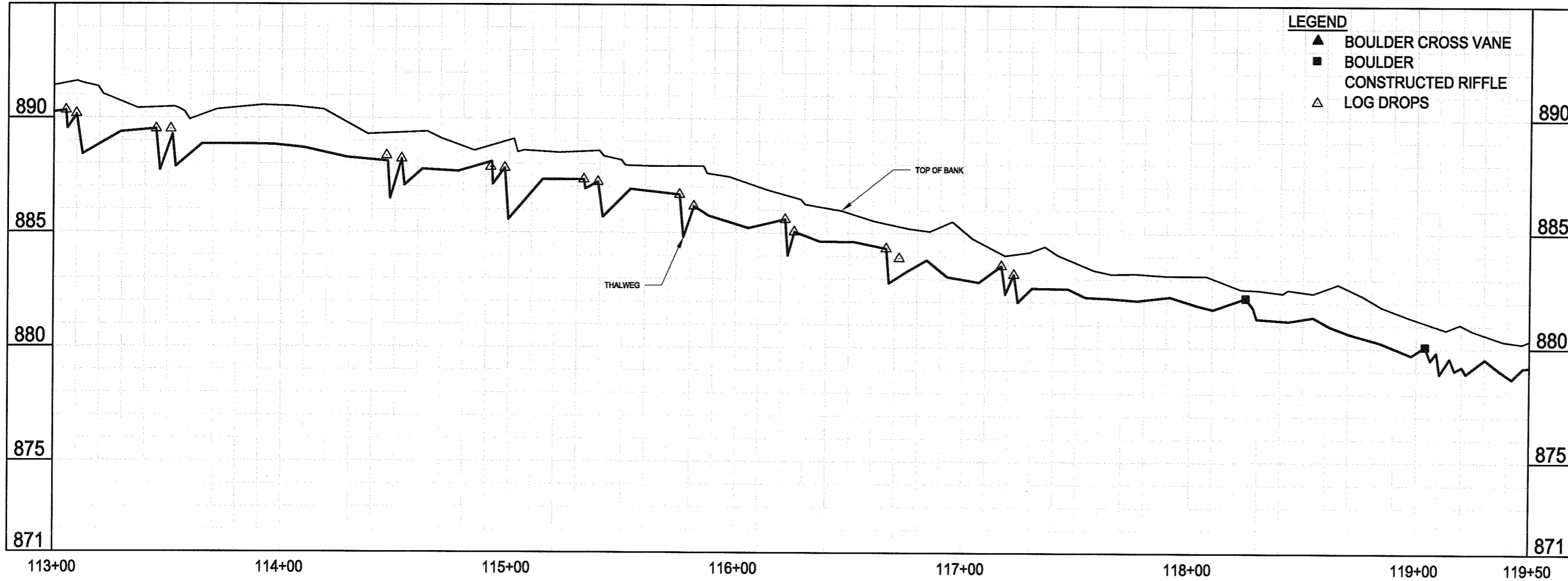

AS-BUILT PROFILE - UT 1 REACH 1 & REACH 2

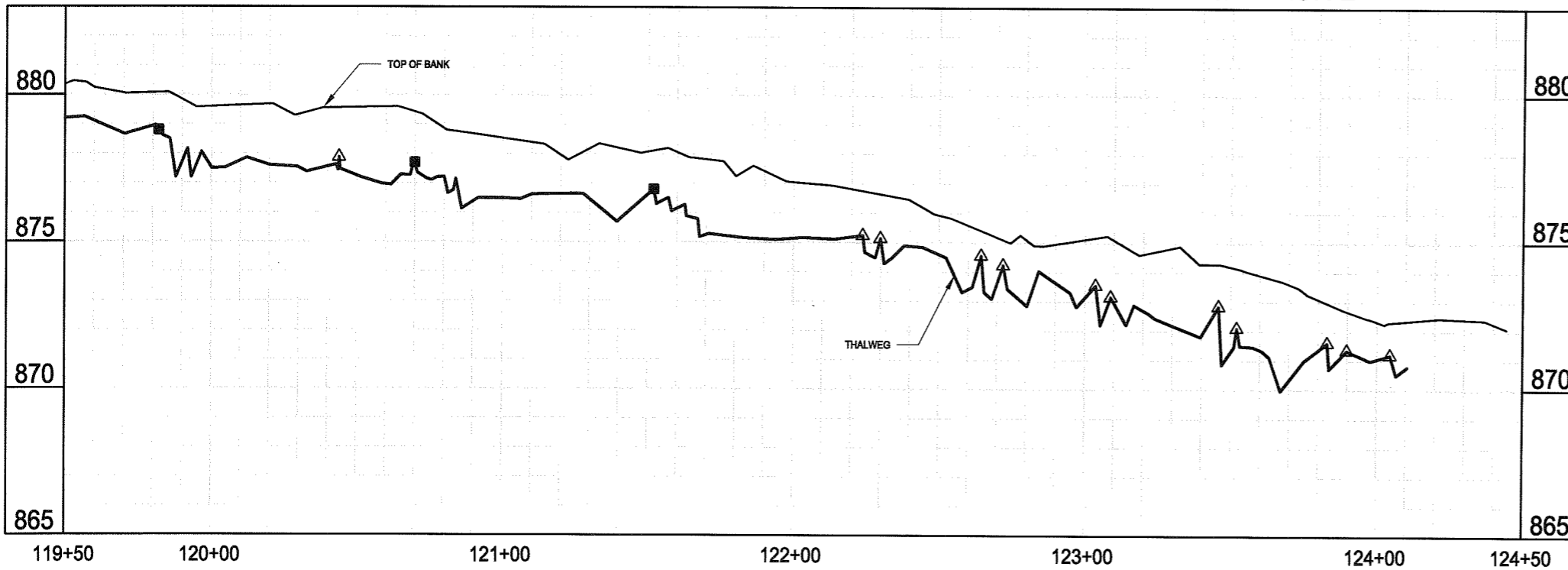

Stantec Consulting Services Inc.
 2127 Ayrley Town Blvd., Suite 300
 Charlotte NC U.S.A. 28273
 Tel. 704.329.0900
 Fax. 704.329.0905
 www.stantec.com
 License No. F-0672

Stantec

Copyright Reserved
 The Contractor shall verify and be responsible for all dimensions. DO NOT scale the drawing - any errors or omissions shall be reported to Stantec without delay.
 The Copyrights to all designs and drawings are the property of Stantec. Reproduction or use for any purpose other than that authorized by Stantec is forbidden.

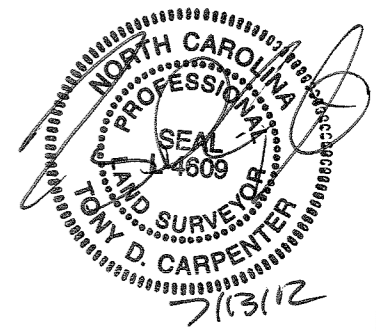

REVISIONS

NO.	DATE	BY	DESCRIPTION

CERTIFICATION AND SEAL

AS-BUILT

PROJECT NAME
 AS-BUILT SURVEY OF NORTH FORK
 MOUNTAIN CREEK STREAM RESTORATION
 CATAWBA COUNTY, NORTH CAROLINA

DRAWING TITLE
AS-BUILT PROFILE SHEET

CADD PLOT:	SCALE: N/A	SHEET NO.
VOID PLOT:	DRAWN BY: R.R.P.	5.15
RELEASED TO CONSTRUCTION	DATE: 07-13-12	
	REVIEWED BY: T.T.	

SaveDate: 2012/07/13 2:25 PM Login: Pecky, Richard
 \\na1225-101\shared_projects\75613007\Civil\Drawings\Sheet\file\as_built\as_built.dwg

AS-BUILT PROFILE - UT 2 REACH 3

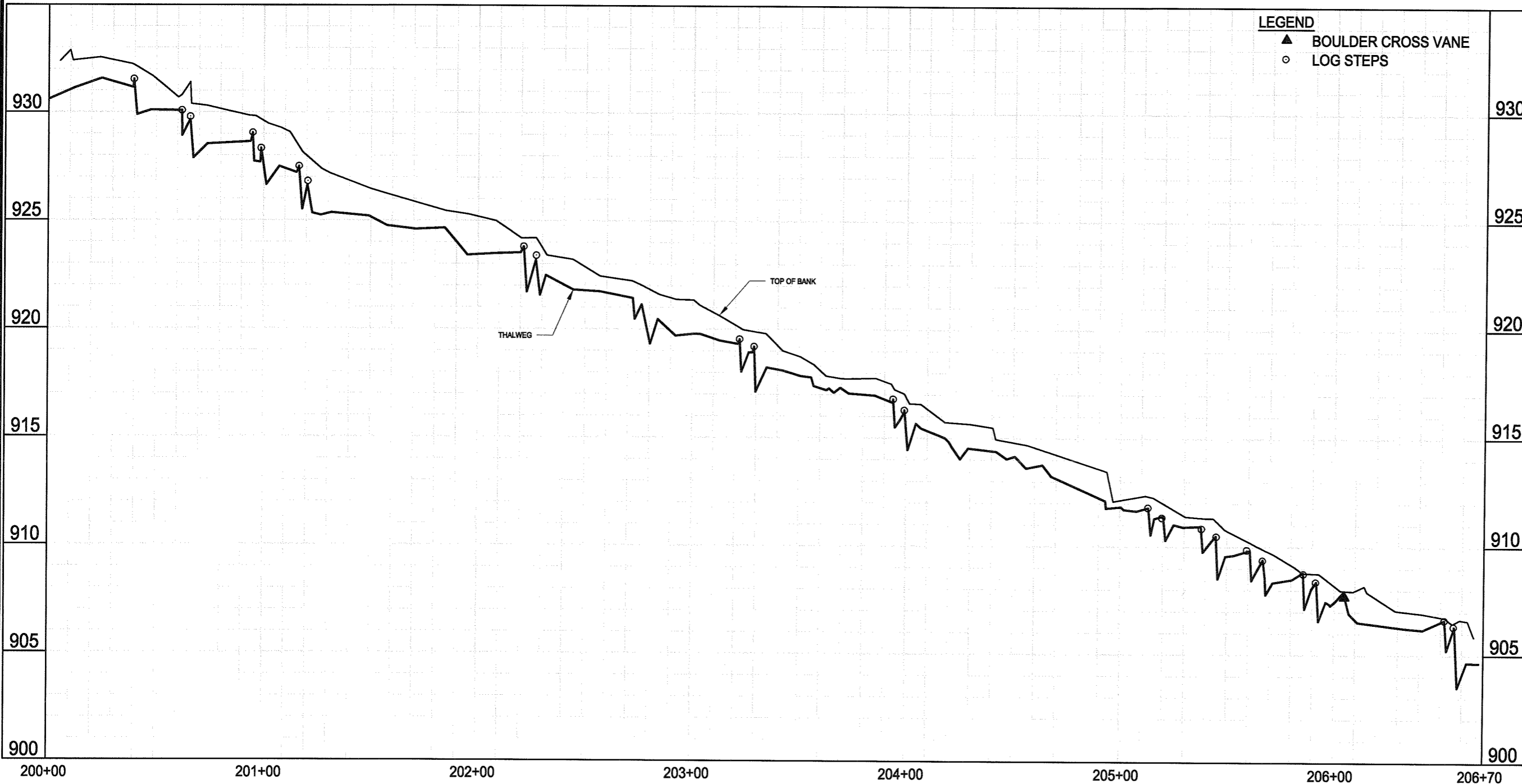

LEGEND
 ▲ BOULDER CROSS VANE
 ○ LOG STEPS



Stantec Consulting Services Inc.
 2127 Amsley Town Blvd., Suite 300
 Charlotte NC U.S.A.
 28273
 Tel. 704.329.0900
 Fax. 704.329.0905
 www.stantec.com
 License No. F-0672

Stantec

Copyright Reserved

The Contractor shall verify and be responsible for all dimensions. DO NOT scale the drawing - any errors or omissions shall be reported to Stantec without delay. The Copyright to all designs and drawings are the property of Stantec. Reproduction or use for any purpose other than that authorized by Stantec is forbidden.

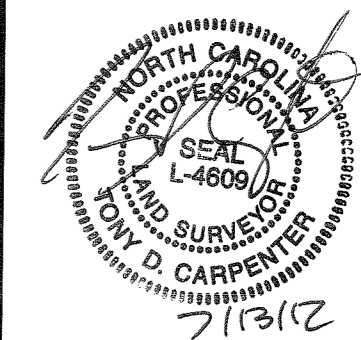

REVISIONS			
NO.	DATE	BY	DESCRIPTION

CERTIFICATION AND SEAL

AS-BUILT

PROJECT NAME
 AS-BUILT SURVEY OF NORTH FORK
 MOUNTAIN CREEK STREAM RESTORATION
 CATAWBA COUNTY, NORTH CAROLINA

DRAWING TITLE
AS-BUILT PROFILE SHEET

CADD PLOT:	SCALE: N/A	SHEET NO.
VOID PLOT:	DRAWN BY: R.R.P.	5.16
RELEASED TO CONSTRUCTION	DATE: 07-13-12	
	REVIEWED BY: T.T.	

Saved: 2012/07/13 2:25 PM Location: \\server\projects\75613007\civil\drawing\sheet\as-built\3007c-514.dwg

AS-BUILT PROFILE - REACH 4

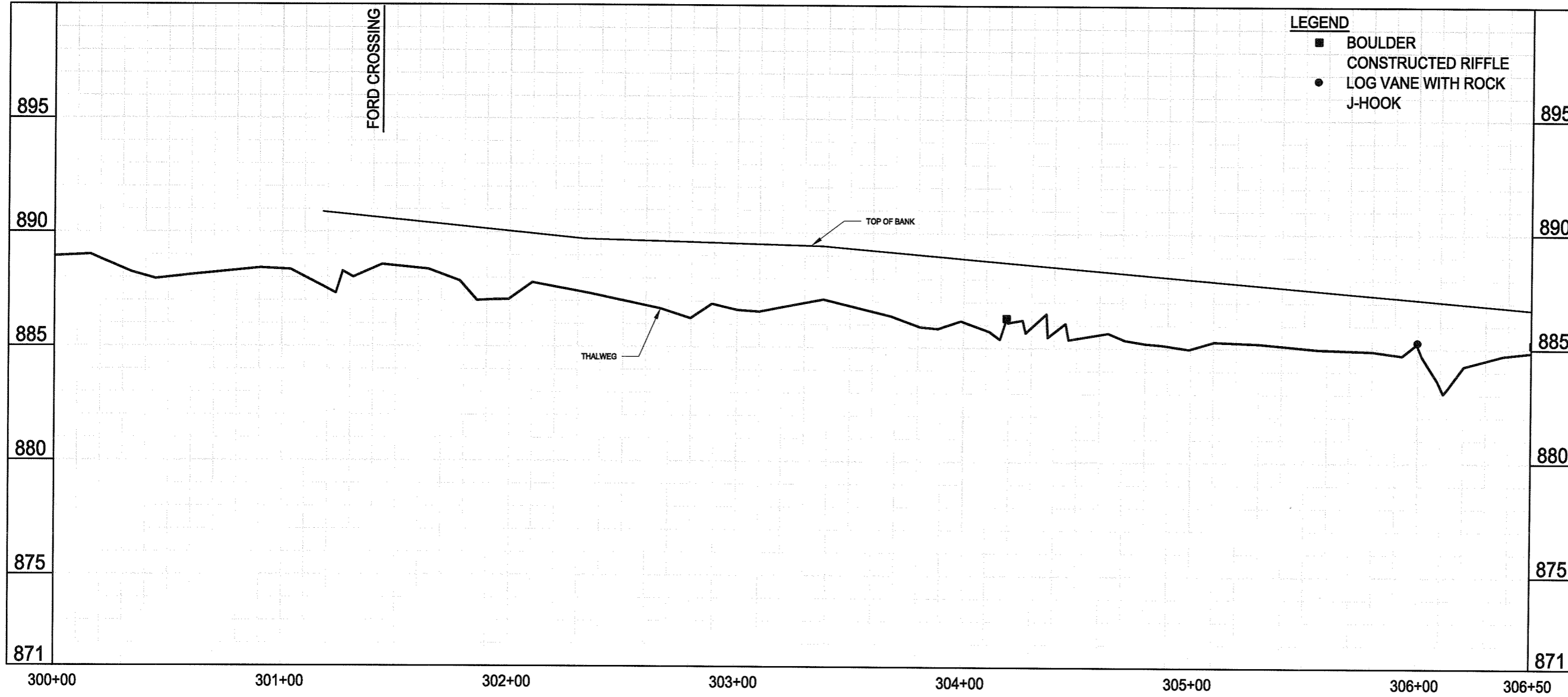

AS-BUILT PROFILE - REACH 4

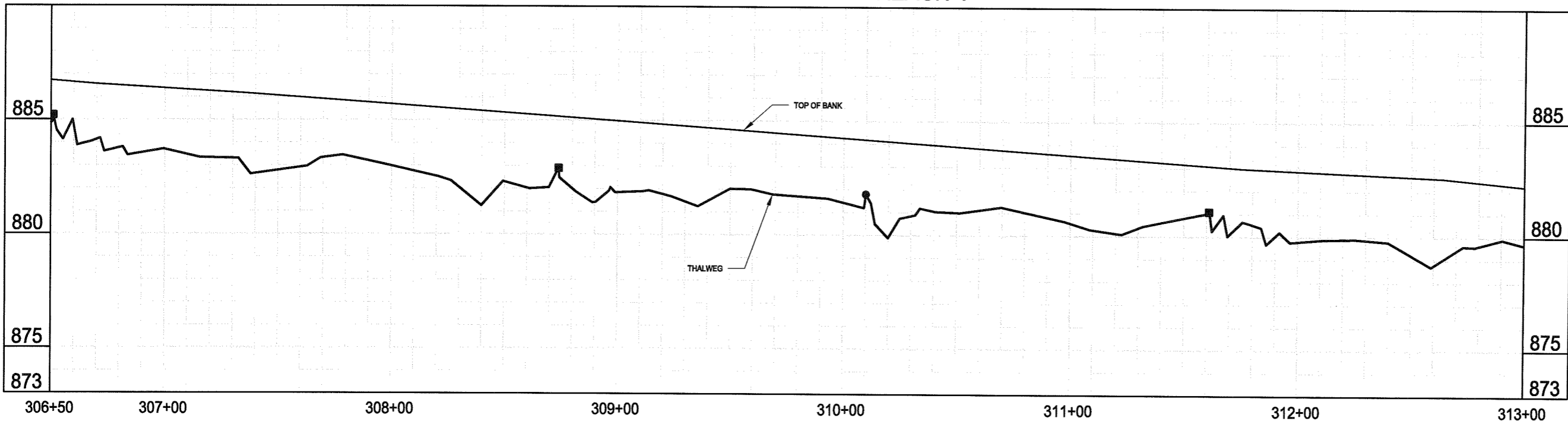

Stantec Consulting Services Inc.
 2127 Ayrley Town Blvd., Suite 300
 Charlotte NC U.S.A.
 28273
 Tel. 704.329.0900
 Fax. 704.329.0905
 www.stantec.com
 License No. F-0672

Stantec

Copyright Reserved
 The Contractor shall verify and be responsible for all dimensions. DO NOT scale the drawing - any errors or omissions shall be reported to Stantec without delay.
 The Copyright to all design and drawings are the property of Stantec. Reproduction or use for any purpose other than that authorized by Stantec is forbidden.

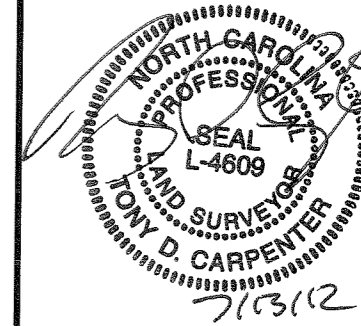

REVISIONS			
NO.	DATE	BY	DESCRIPTION

CERTIFICATION AND SEAL

AS-BUILT

PROJECT NAME
 AS-BUILT SURVEY OF NORTH FORK
 MOUNTAIN CREEK STREAM RESTORATION
 CATAWBA COUNTY, NORTH CAROLINA

DRAWING TITLE
AS-BUILT PROFILE SHEET

CADD PLOT:	SCALE: N/A	SHEET NO.
VOID PLOT:	DRAWN BY: R.R.P.	5.17
RELEASED TO CONSTRUCTION:	DATE: 07-13-12	
	REVIEWED BY: T.T.	

Saved: 2012/07/13 2:25 PM Login: Pelly, Richard
 \\s11225-101\shared_projects\17561307\civil_drawing\sheet_files\as_built\set\3007c-514.dwg

AS-BUILT PROFILE - REACH 4

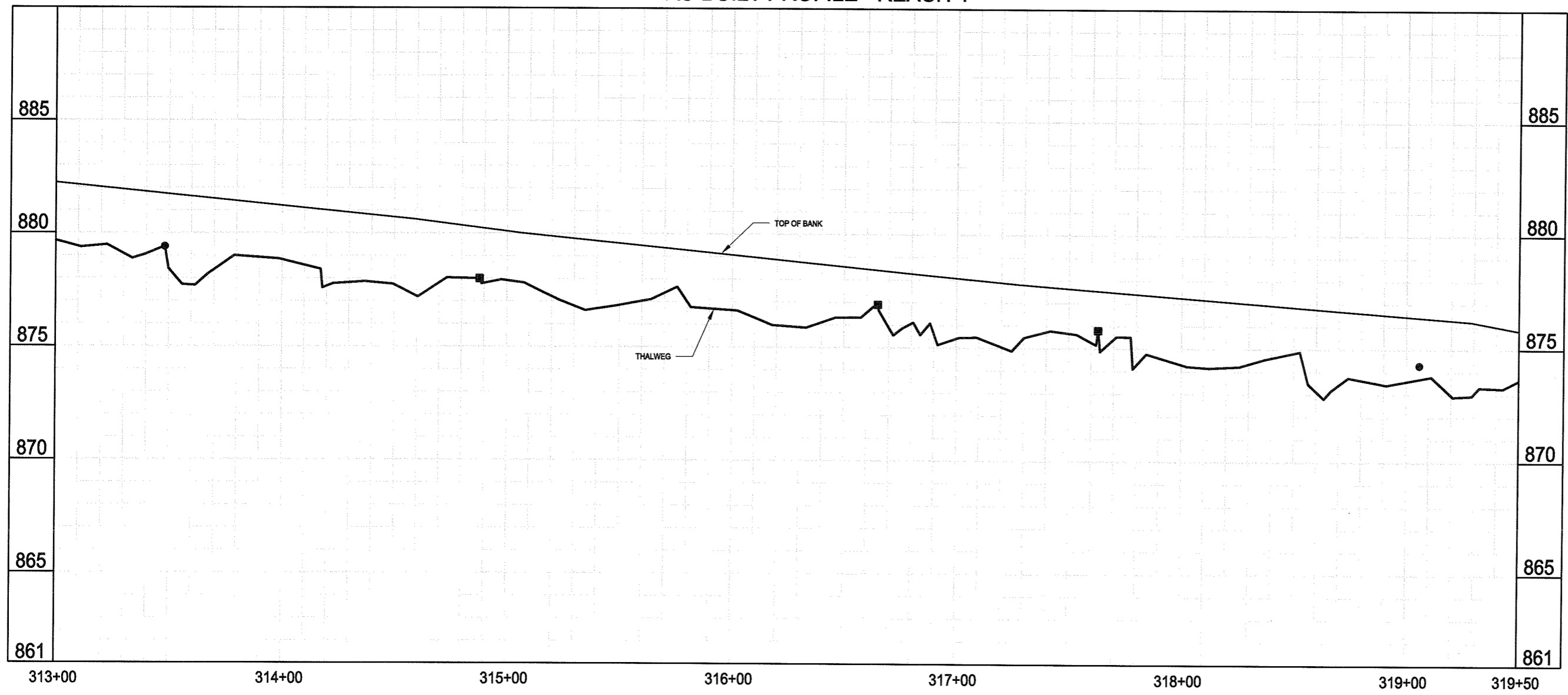

AS-BUILT PROFILE - REACH 4

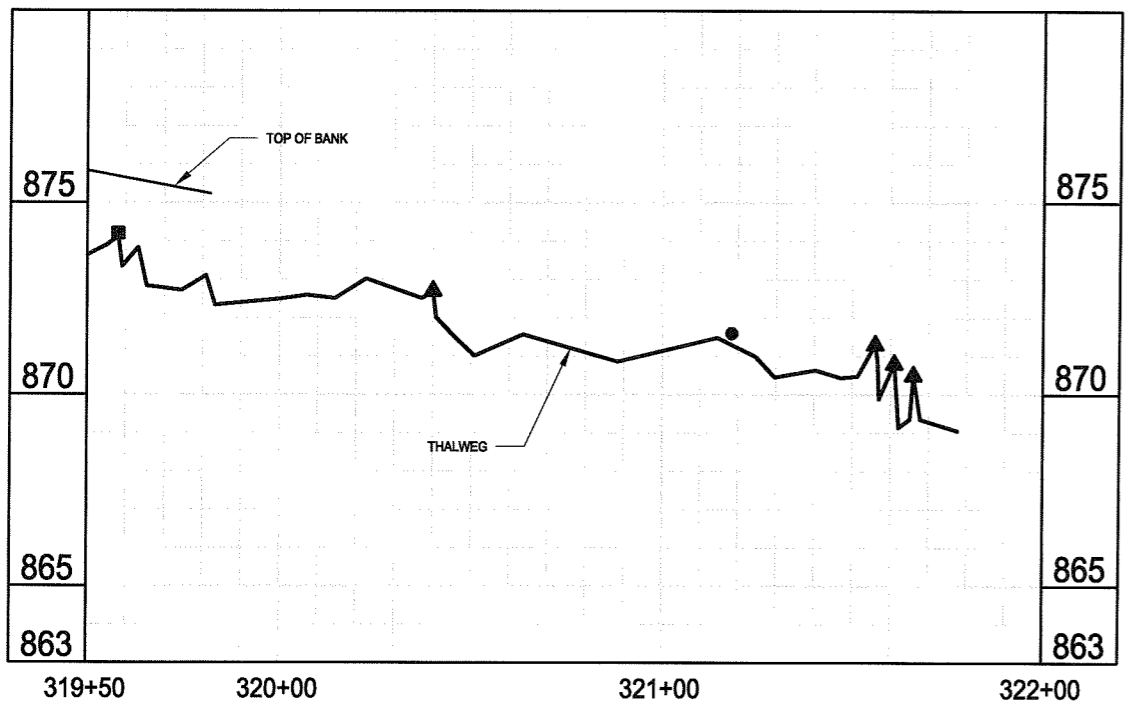

LEGEND

- ▲ BOULDER CROSS VANE
- BOULDER
- ▣ CONSTRUCTED RIFFLE
- LOG VANE WITH ROCK J-HOOK

Stantec Consulting Services Inc.
 2127 Ayrley Town Blvd., Suite 300
 Charlotte NC U.S.A. 28273
 Tel. 704.329.0900
 Fax. 704.329.0905
 www.stantec.com
 License No. F-0672

Copyright Reserved
 The Contractor shall verify and be responsible for all dimensions. DO NOT scale the drawing - any errors or omissions shall be reported to Stantec without delay.
 The Copyrights to all designs and drawings are the property of Stantec. Reproduction or use for any purpose other than that authorized by Stantec is forbidden.

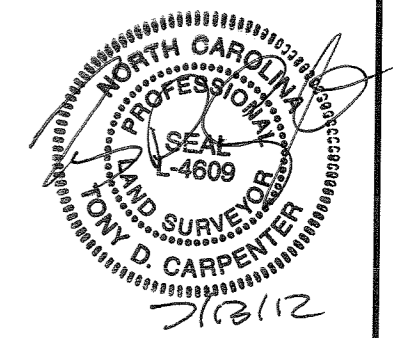

REVISIONS			
NO.	DATE	BY	DESCRIPTION

CERTIFICATION AND SEAL

 AS-BUILT

PROJECT NAME		
AS-BUILT SURVEY OF NORTH FORK MOUNTAIN CREEK STREAM RESTORATION CATAWBA COUNTY, NORTH CAROLINA		
DRAWING TITLE		
AS-BUILT PROFILE SHEET		
CADD PLOT:	SCALE: N/A	SHEET NO.
VOID PLOT:	DRAWN BY: R.R.P.	5.18
RELEASED TO CONSTRUCTION	DATE: 07-13-12	
	REVIEWED BY: T.T.	

SaveDate: 2012/07/13 2:25 PM Login: Percy, Richard
 \\Virt225-101\nterac_projects\7501300\Drawings\Sheet_Lines\As-Built_Lines.dwg 130072-514.dwg

BEGIN
UT 1 REACH 1
STA: 100+00
N: 692240.92
E: 1379849.31

BEGIN
UT 2 REACH 3
STA: 200+00
N: 691901.85
E: 1379502.72

END UT 1 REACH 1
BEGIN UT 1 REACH 2
STA: 107+19.70
N: 691656.95
E: 1380208.05

END
UT 2 REACH 3
STA: 206+69.71
N: 691769.92
E: 1380118.66

END NORTH FORK MOUNTAIN
CREEK REACH 4
STA: 321+95.4
N: 690488.28
E: 1381399.59



END
UT 1 REACH 2
STA: 124+17.8
N: 690509.11
E: 1381359.18

BEGIN
NORTH FORK MOUNTAIN CREEK
REACH 4
STA: 300+00
N: 689349.66
E: 1380047.10

END
NORTH FORK MOUNTAIN CREEK
REACH 4
STA: 321+95.4
N: 690488.28
E: 1381399.59

END
UT 1 REACH 2
STA: 124+17.8
N: 690509.11
E: 1381359.18

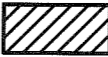
LEGEND

-  UPLAND ZONE
-  FLOODPLAIN ZONE

NOTE:

BOUNDARIES FOR PLANTING ZONES
PROVIDED BY DESIGNER.



Stantec

Copyright Reserved

The Contractor shall verify and be responsible for all dimensions. DO NOT scale the drawing - any errors or omissions shall be reported to Stantec without delay.
The Copyrights to all designs and drawings are the property of Stantec. Reproduction or use for any purpose other than that authorized by Stantec is forbidden.

Stantec Consulting Services Inc.
2127 Ayrley Town Blvd., Suite 300
Charlotte NC U.S.A.
28273
Tel: 704.329.0900
Fax: 704.329.0905
www.stantec.com
License No. F-0672

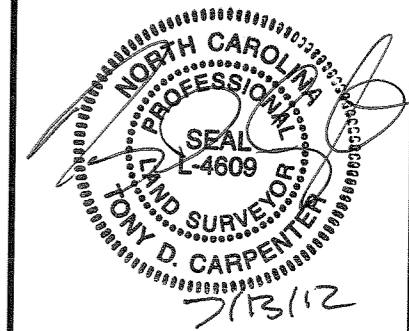

REVISIONS

NO.	DATE	BY	DESCRIPTION

CERTIFICATION AND SEAL

AS-BUILT

PROJECT NAME
AS-BUILT SURVEY OF NORTH FORK
MOUNTAIN CREEK STREAM RESTORATION
CATAWBA COUNTY, NORTH CAROLINA

DRAWING TITLE
AS-BUILT PLANTING PLAN

CADD PLOT:	SCALE: N/A	SHEET NO.
VOID PLOT:	DRAWN BY: R.R.P.	6.19
RELEASED TO CONSTRUCTION	DATE: 07-13-12	
	REVIEWED BY: T.T.	



S:\proj\2012\07\12_11_08_ML_Louis_Rush_Richard
 \proj\2012-10\lboard_projects\175613607\containing\labeld_files\as_built_aml\3007c-619.dwg