

**NOTE:**  
 1' contour lines shown within the conservation easement boundary are derived from field survey.  
 4' contour lines shown outside the easement boundary are from NCDOT LIDAR. There is some elevation discrepancy between the different sets of contours. The LIDAR contours are only shown to provide a general sense of the upland topography.

Monitoring Pin Coordinates: Spring Creek - Project# 92607					
Location	Latitude(N)	Longitude(W)	Location	Latitude(N)	Longitude(W)
<b>Veg. Plots:</b>			<b>Longitudinal Profile:</b>		
92607-VP1	35.79224769°	82.86277965°	begin survey	35.79175928°	82.86357607°
92607-VP2	35.79173579°	82.86333665°	end survey	35.79297343°	82.86205123°
92607-VP3	35.79226422°	82.86224898°	<b>Photo Stations:</b>		
<b>Cross Sections:</b>			PS-1	35.79189434°	82.86371563°
SC-XS1-LB	35.79198122°	82.86340352°	PS-2	35.79214463°	82.86309031°
SC-XS1-BKF	35.79192339°	82.86336330°	PS-3	35.79239349°	82.86254031°
SC-XS1-RB	35.79166882°	82.86318676°	PS-4	35.79259546°	82.86248726°
SC-XS2-LB	35.79209454°	82.86311191°	PS-5	35.79221658°	82.86208135°
SC-XS2-BKF	35.79202130°	82.86307621°	PS-6	35.79192007°	82.86250584°
SC-XS2-RB	35.79176080°	82.86293918°			
SC-XS3-LB	35.79228939°	82.86268101°			
SC-XS3-BKF	35.79216390°	82.86261542°			
SC-XS3-RB	35.79192985°	82.86249045°			
SC-XS4-LB	35.79233717°	82.86257278°			
SC-XS4-BKF	35.79225724°	82.86248017°			
SC-XS4-RB	35.79207738°	82.86227036°			
SC-XS5-LP	35.79237208°	82.86250554°			
SC-XS5-BKF	35.79231252°	82.86241283°			
SC-XS5-RB	35.79215518°	82.86216656°			
SC-XS6-LB	35.79239413°	82.86249859°			
SC-XS6-BKF	35.79236643°	82.86239303°			
SC-XS6-RB	35.79227502°	82.86205657°			
SC-XS7-LB	35.79243932°	82.86248580°			
SC-XS7-BKF	35.79241091°	82.86215819°			
SC-XS7-RB	35.79232943°	82.86203835°			
SC-XS8-LB	35.79292581°	82.86236634°			
SC-XS8-BKF	35.79290274°	82.86213354°			
SC-XS8-RB	35.79286915°	82.86197097°			

### Legend

- Thalweg
- Edge of Water
- Top of Bank
- Bankfull (when not @ TB)
- Existing Fence Line
- Easement Boundary
- Permanent Cross Section
- Veg. Plot
- ▲ EC-# Easement Cap
- ▼ PS-# Photo Station Location
- ▲ Rebar Pin Set

- Root Wad
- Rock J-hook
- Rock Vane
- Log Vane

- Deciduous Tree
- Coniferous Tree

**Large Tree Legend**

1. 12" White Pine	10. 32" Sycamore
2. 18" White Pine	11. 24" Sycamore
3. 14" Black Locust	12. 20" Basswood
4. 24" Sycamore	13. 22" Black Walnut
5. 18" Sycamore	14. 28" Basswood
6. 16" Sycamore	15. Triple Sycamore
7. 24" Sycamore	16. 20" Forked Cherry
8. 24" Sycamore	17. 10" Black Willow
9. 22" Sycamore	18. 10" Black Walnut

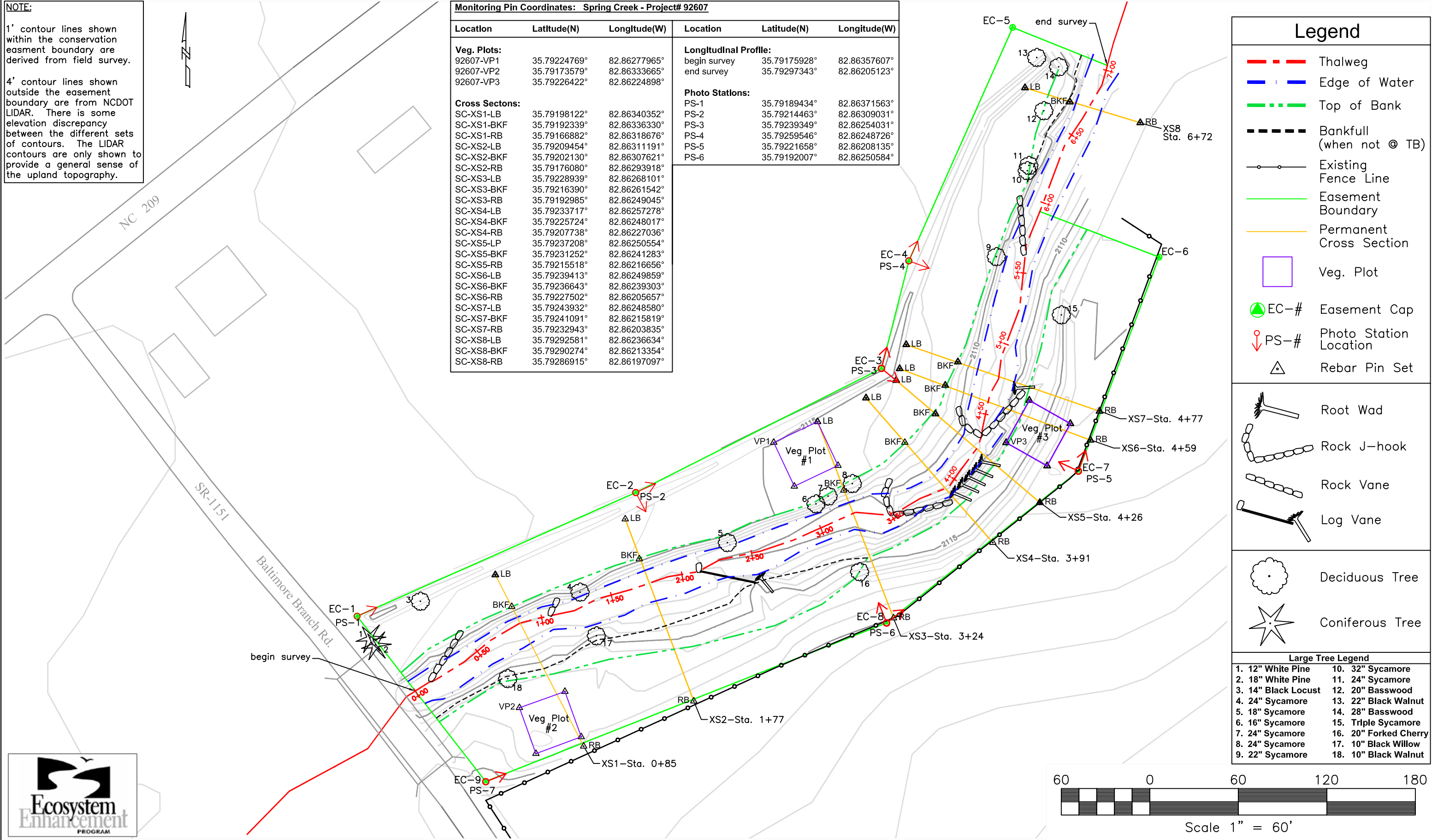

**NORTH CAROLINA WILDLIFE RESOURCES COMMISSION**  
**WATERSHED ENHANCEMENT GROUP**  
 20830 GREAT SMOKY MOUNTAIN EXPRESSWAY  
 WAYNESVILLE, NORTH CAROLINA 28786  
 828.452.6191 Ext.26 OFFICE  
 828.452.7772 FAX

**Spring Creek Project #92607**  
 Madison County Plemmons-Kirkpatrick Site  
**As-Built Survey**

DRAWN BY: JCF	DATE: 01-08
APPROVED:	DATE:
SURVEY BY: CSL, JCF	DATE: 09-06
CAD FILE ID: pkasblt.dwg	

**SHEET**  
**1**  
**OF 1**

FIGURE 2. - Plemmons/Kirkpatrick Mitigation Site, Spring Creek, French Broad River Drainage, Madison County, NC. EEP Project #92607, As-Built Plan View.