

STATE	EEP PROJECT NUMBER	SHEET NO.	TOTAL SHEETS
N.C.	95363	1	3

NO.	DESCRIPTION	DATE

KCI JOB# : 20122265

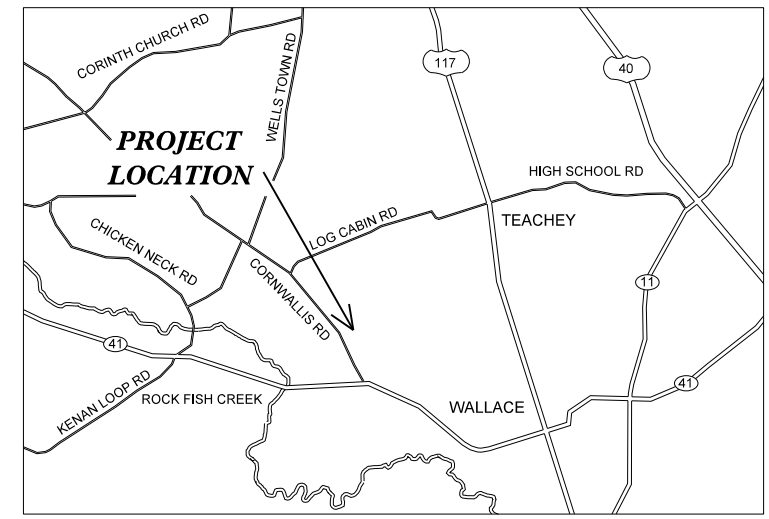

**VICINITY MAP**  
**NOT TO SCALE**

DIRECTIONS FROM RALEIGH:  
PROCEED EAST ON I-40 FOR APPROXIMATELY 70 MILES. TAKE EXIT 369, US-117 S. TAKE A LEFT ONTO US-117 S. TRAVEL APPROXIMATELY 15 MILES AND THEN TAKE A RIGHT ONTO E MAIN ST IN WALLACE, NC. TRAVEL 2 MILES AND TURN RIGHT ONTO CORNWALLIS RD. THE SITE WILL BE ON THE RIGHT APPROXIMATELY 0.4 MILES AHEAD.

STATE OF NORTH CAROLINA  
ECOSYSTEM ENHANCEMENT PROGRAM

**TWIN BAYS**  
**WETLAND RESTORATION SITE**

**DUPLIN COUNTY, NORTH CAROLINA**  
**CAPE FEAR RIVER BASIN**

**ROCK FISH CREEK WATERSHED**  
**03030007090040**

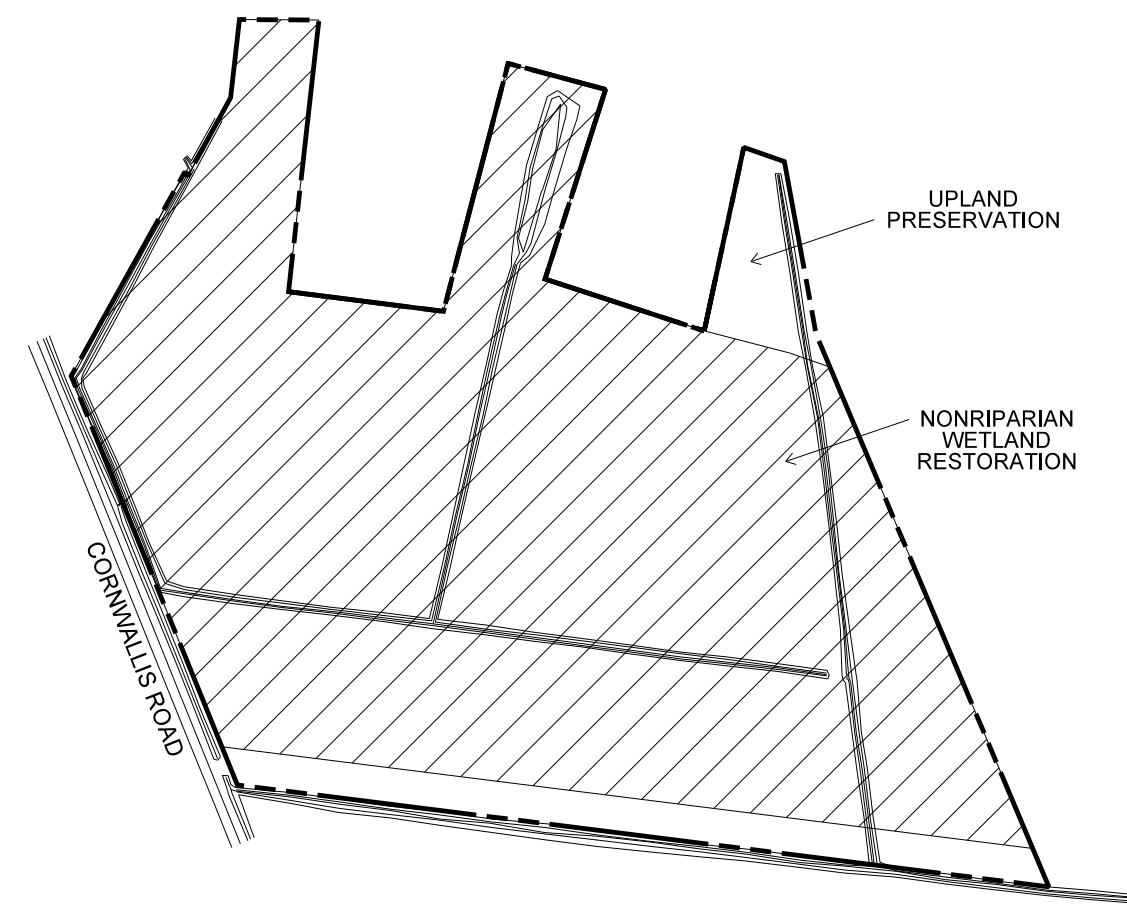

**AS-BUILT PLAN**

- INDEX OF SHEETS**
- 1 AS-BUILT: TITLE SHEET
  - 2 AS-BUILT: SITE PLAN
  - 3 AS-BUILT: PLANTING PLAN

**CONTRACT #: 004739**

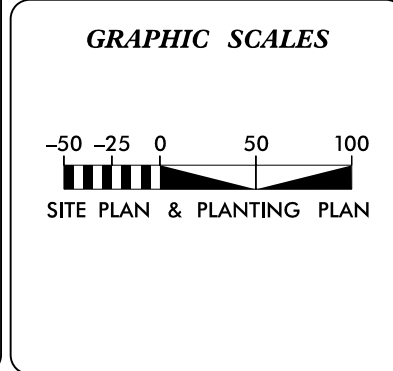

**PROJECT DATA**

NONRIPARIAN WETLAND RESTORATION = 10.6 ACRES

UPLAND PRESERVATION = 0.4 ACRE

Prepared in the Office of:

**KCI Associates**  
of North Carolina, P.A.  
SUITE 220 LANDMARK CENTER II, 4601 SIX FORKS RD., RALEIGH, NC 27609  
ENGINEERS • PLANNERS • ECOLOGISTS

---

GARY M. MRYNCZA, P.E.  
PROJECT ENGINEER

---

JOE PFEIFFER  
WETLAND DESIGN







PROJECT ENGINEER

SIGNATURE: \_\_\_\_\_ P.E.

Prepared for:

JEFF JUREK  
CONTRACT ADMINISTRATOR

SITE PLAN LEGEND

-  EASEMENT LINE
-  PRE-RESTORATION CONTOUR LINES
-  DESIGNED CONTOUR LINES
-  TREE LINE
-  EXISTING OVERHEAD WIRE & POLES
-  ROCK STABILIZED OUTLET
-  FILLED DITCH



SYMBOL	DESCRIPTION	REVISIONS

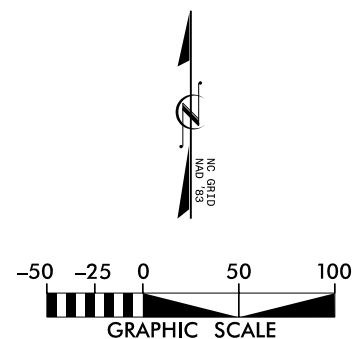
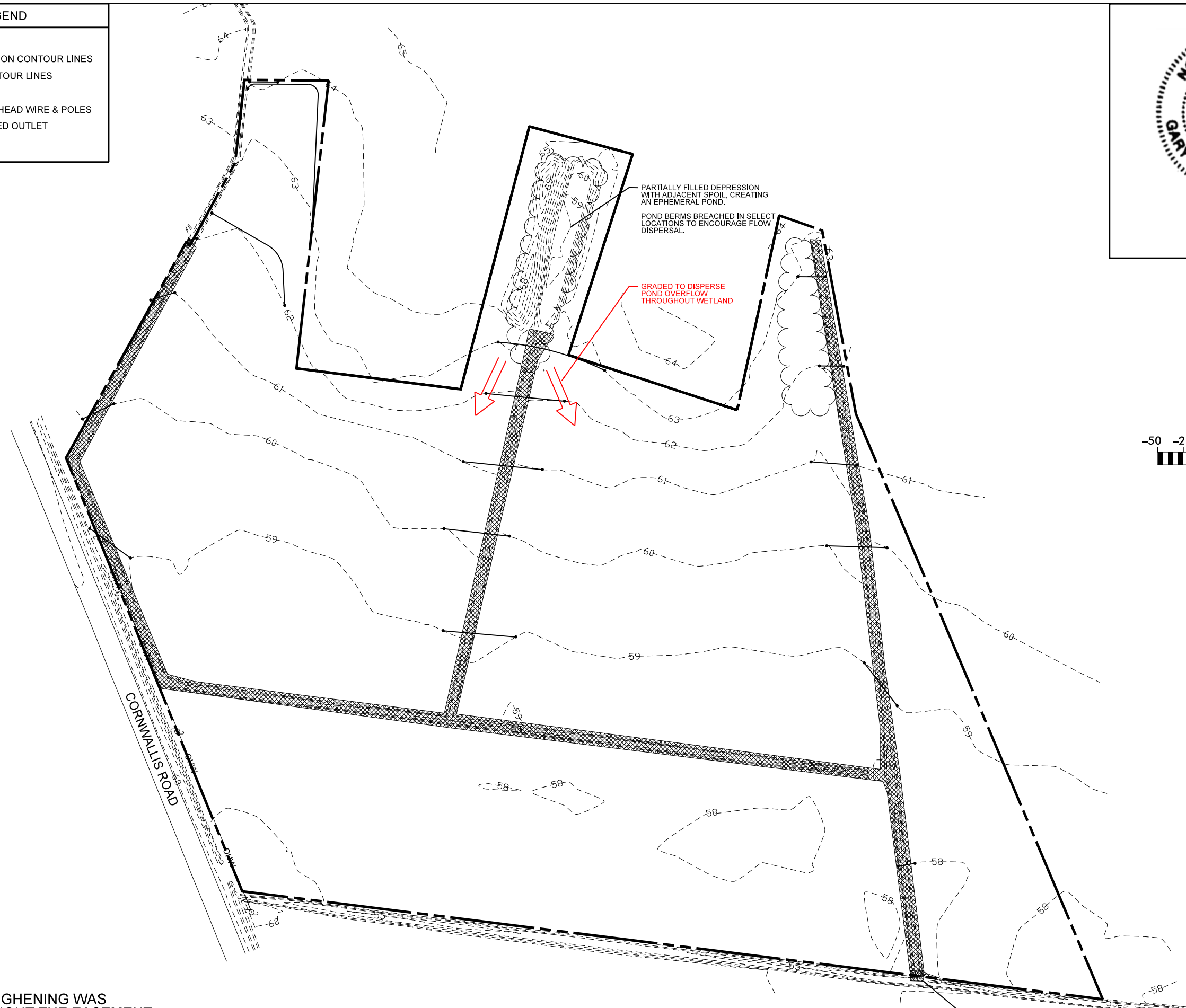

**KCI**  
ASSOCIATES OF NC  
ENGINEERS • PLANNERS • SCIENTISTS  
4601 SIX FORKS ROAD, SUITE 220  
RALEIGH, NORTH CAROLINA 27609

TWIN BAYS  
WETLAND RESTORATION SITE  
WALLACE, DUPLIN COUNTY, NORTH CAROLINA

DATE: APRIL 2014  
SCALE: GRAPHIC

AS-BUILT:  
SITE  
PLAN

SHEET 2 OF 3

NOTE: SURFACE ROUGHENING WAS INSTALLED THROUGHOUT THE EASEMENT TO ALLEVIATE SOIL COMPACTION AND TO ENHANCE SURFACE WATER STORAGE.

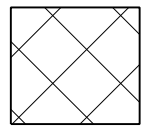
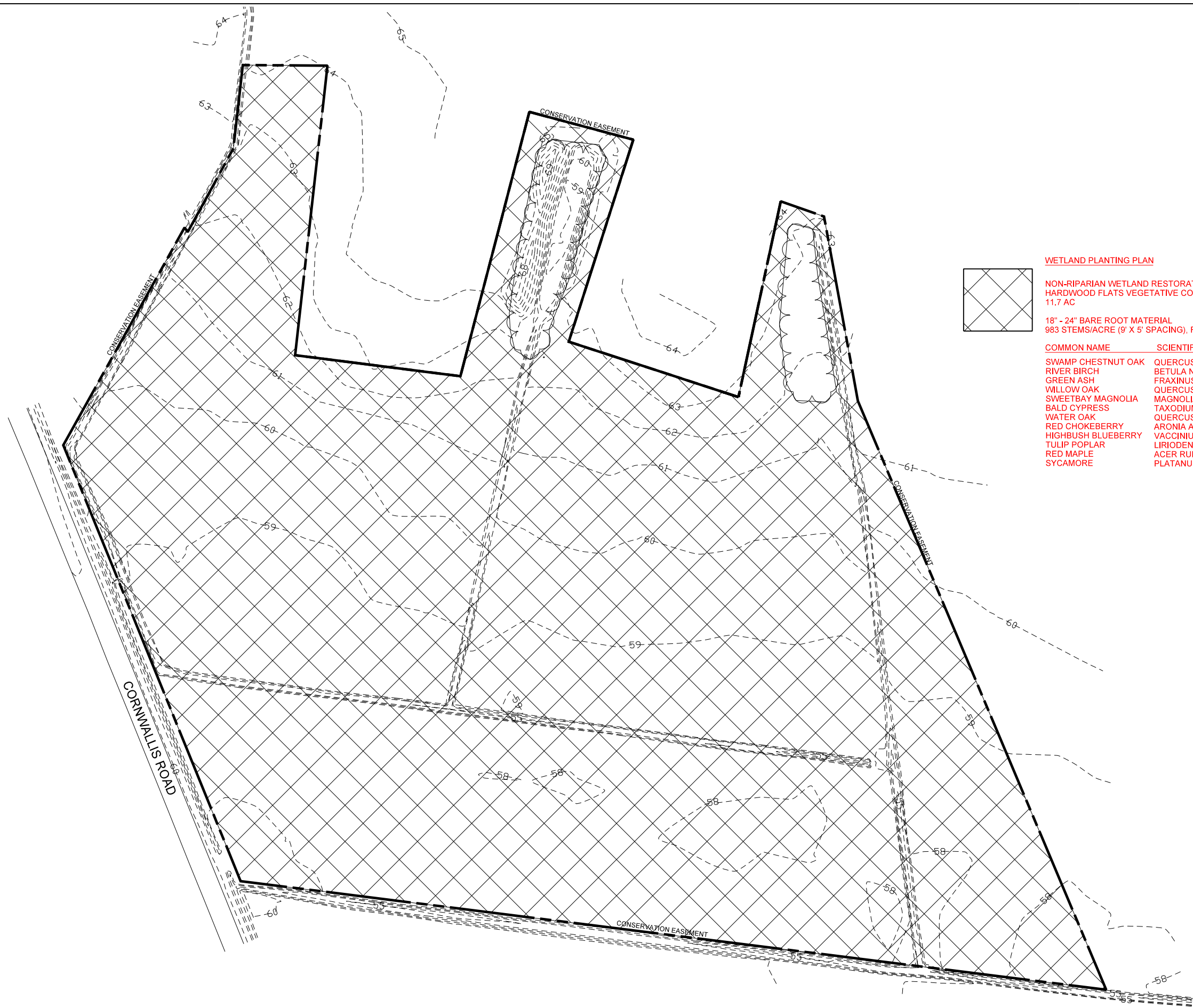

**WETLAND PLANTING PLAN**

NON-RIPARIAN WETLAND RESTORATION  
HARDWOOD FLATS VEGETATIVE COMMUNITY  
11.7 AC

18" - 24" BARE ROOT MATERIAL  
983 STEMS/ACRE (9' X 5' SPACING), RANDOM SPECIES PLACEMENT

COMMON NAME	SCIENTIFIC NAME	WETLAND INDICATOR	% OF TOTAL	# OF PLANTS
SWAMP CHESTNUT OAK	QUERCUS MICHAUXII	FACW	16	1800
RIVER BIRCH	BETULA NIGRA	FACW	16	1800
GREEN ASH	FRAXINUS PENNSYLVANICA	FACW	11	1300
WILLOW OAK	QUERCUS PHELLOS	FACW	11	1300
SWEETBAY MAGNOLIA	MAGNOLIA VIRGINIANA	FACW	9	1000
BALD CYPRESS	TAXODIUM DISTICHUM	OBL	9	1000
WATER OAK	QUERCUS NIGRA	FAC	9	1000
RED CHOKEBERRY	ARONIA ARBUTIFOLIA	FACW	4	500
HIGHBUSH BLUEBERRY	VACCINIUM CORYMBOSUM	FACW	4	500
TULIP POPLAR	LIRIODENDRON TULIPIFERA	FACW	4	500
RED MAPLE	ACER RUBRUM	FACW	3	400
SYCAMORE	PLATANUS OCCIDENTALIS	FACW	3	400
			<b>100</b>	<b>11,500</b>

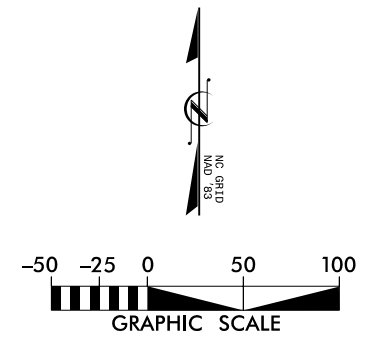

NO.	SYMBOL	DESCRIPTION	REVISIONS



**KCI**  
ASSOCIATES OF NC  
ENGINEERS • PLANNERS • SCIENTISTS  
4601 SIX FORKS ROAD, SUITE 220  
RALEIGH, NORTH CAROLINA 27609

TWIN BAYS  
WETLAND RESTORATION SITE  
WALLACE, DUPLIN COUNTY, NORTH CAROLINA

DATE: APRIL 2014  
SCALE: GRAPHIC  
AS-BUILT:  
PLANTING  
PLAN  
SHEET 3 OF 3