

STATE OF NORTH CAROLINA ECOSYSTEM ENHANCEMENT PROGRAM

UT CLARKE CREEK STREAM AND WETLAND RESTORATION

LOCATION: 5542 HUCKS ROAD, CHARLOTTE, NC

I, DAVID K. ALLEY, CERTIFY THAT THE INFORMATION SHOWN ON THESE PLANS WERE DERIVED FROM AN ACTUAL FIELD SURVEY MADE UNDER MY SUPERVISION, THAT THE RATIO OF PRECISION AS CALCULATED IS 1:10000+. THE PURPOSE OF THIS SURVEY IS FOR TOPOGRAPHIC INFORMATION ONLY. NO BOUNDARY DETERMINATIONS WERE MADE AT THIS TIME.

THIS 12TH DAY OF JULY, 2013.

DKA
N. C. PROFESSIONAL LAND SURVEYOR L-4492

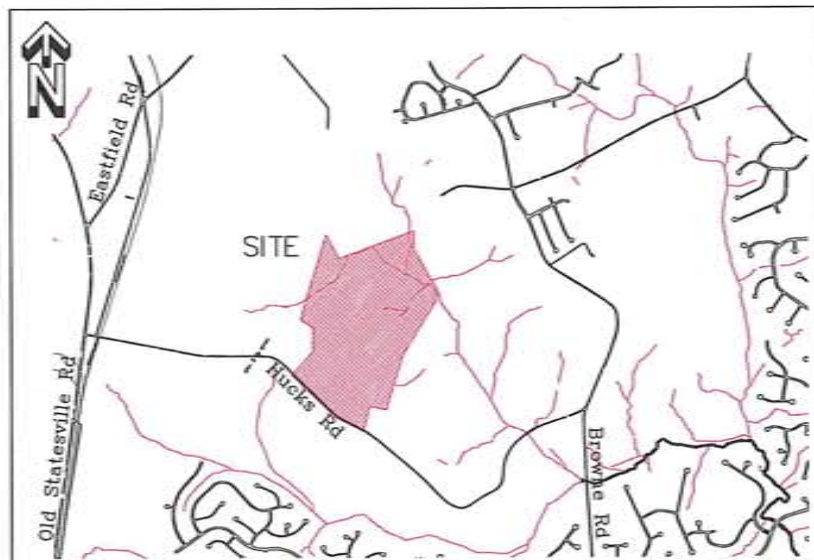

VICINITY MAP

LEGEND:

- BANKFULL
- THALWEG
- WATER SURFACE
- - - CONSTRUCTION LIMITS
- CONTOUR LINE



CONTROL POINT

NOTE: ALL STRUCTURES ARE NOTED ON EACH SHEET.

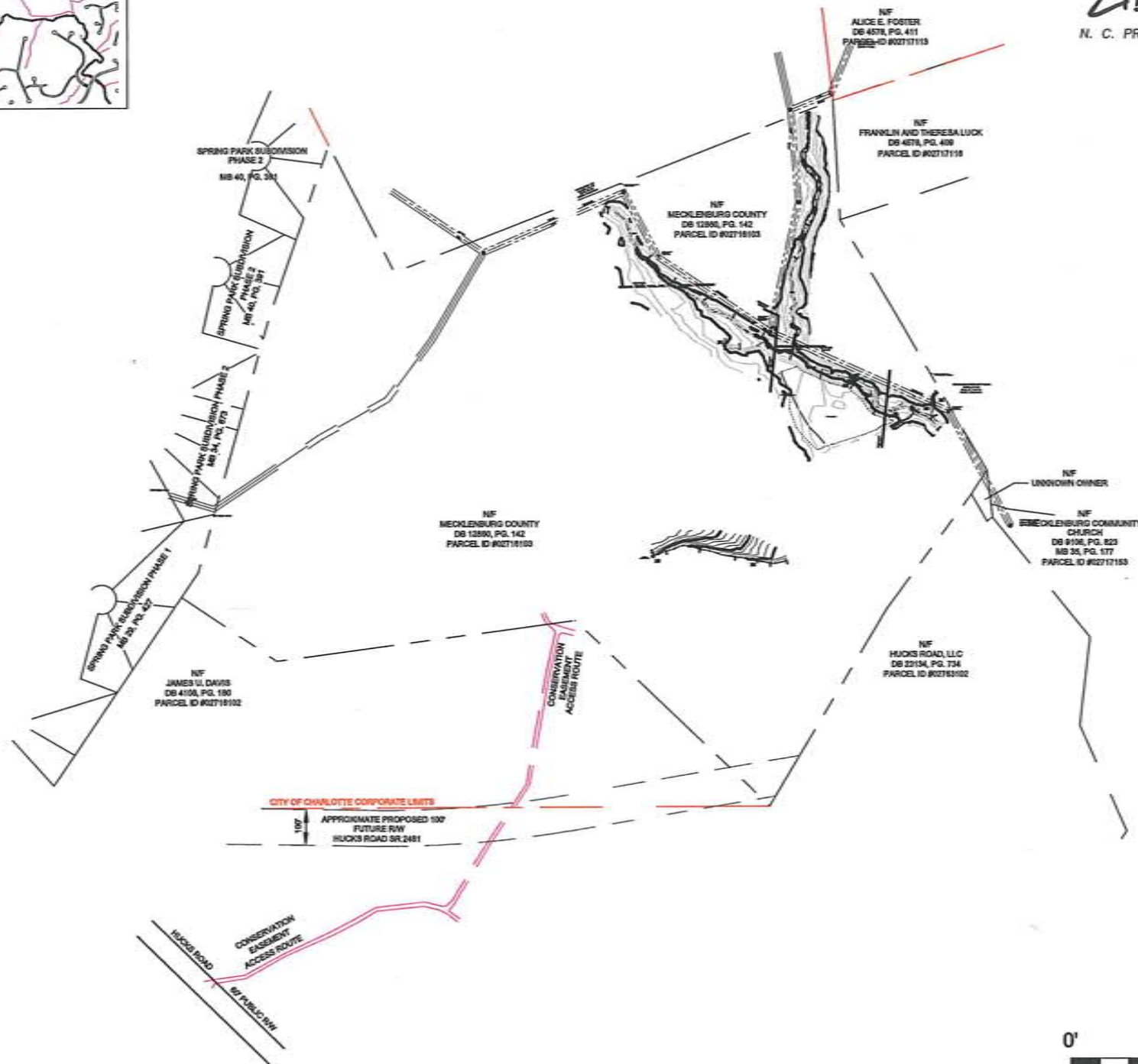

NC Grid Coordinates - NAD83 - NAVD88
Based on the North Carolina VRS Network
Control by GPS Methods using a Trimble SPS985
GPS Receiver running on the State of North Carolina VRS System.
All points shown were acquired as four separate positions at two
different times of day to confirm accuracy.
A minimum of 15 epochs of data were collected for each
occupation.

PNT Easting Northing Elevation

NSE1	1461796.10	589768.07	757.81	60D NAIL SET
NSE2	1461467.96	589961.21	763.81	60D NAIL SET
NSE3	1461256.05	589658.03	751.26	60D NAIL SET
NSE4	1461470.13	588951.72	769.44	60D NAIL SET
NSE5	1461530.32	589283.24	768.11	60D NAIL SET
90588	1458523.71	586168.99	789.19	PKSET
90589	1460492.85	586117.40	778.66	PKSET
90590	1462688.90	586295.88	775.75	PKSET
90611	1462622.11	592219.50	814.45	PKSET
90612	1460372.66	592149.73	842.00	PKSET
90613	1457959.69	592197.90	842.08	PKSET
COR-2	1459915.22	587996.38	814.16	EIP
COR-3	1460973.48	587135.21	801.88	EIP
COR-4	1461092.55	587523.42	788.48	EIP
COR-5	1461494.48	586750.15	789.14	EIP

NOTES:

1. THE PURPOSE OF THIS SURVEY IS TO SHOW AS-BUILT FEATURES.
2. ALL COORDIANATES AND BEARINGS ARE BASED ON NORTH AMERICAN DATUM OF 1983(NSRS2011).
3. ELEVATIONS ARE BASED ON NORTH AMERICAN VERTICAL DATUM OF 1988 (NAVD 88)
4. UNITS OF MEASURE ARE US SURVEY FOOT.
5. CONTOUR INTERVAL = 1 FOOT
6. THE ORIGINAL FIELD WORK WAS COMPLETED ON JUNE 12-14, 2013.



**UT CLARKE STREAM
AND WETLAND RESTORATION**
 Mecklenburg County, NC
 SCO#09-07763-01

Date: June 28, 2013
Job Number: 513012
Project Surveyor: dia
Drawn by: dia
Scale: 1"= 100'

Revisions

**OVERALL
SITE**

Sheet

1 of 10

YOUNGS POND, LLC
 DB 20251, PG. 742
 MB 20, PG. 540
 PARCEL ID #02717110

15' Sanitary Sewer R/W
 as per DB 9688, Pg. 025

Existing Conservation Easement
 as per P8 52, Pg. 585

TOP SS MH = 752.19
 INV IN = 743.94
 INV OUT = 743.84

MECKLENBURG COUNTY
 DB 12860, PG. 142
 PARCEL ID #02716103

MECKLENBURG COUNTY
 DB 12860, PG. 142
 PARCEL ID #02716103

"UT CLARKE CREEK"

Existing Rock Outcrop
 along stream channel from
 Sta. 2+70 to 2+84

TOP SS MH = 749.17
 INV IN = 742.24
 INV OUT = 742.08

15' SANITARY SEWER R/W
 AS PER DB 9688, PG. 025
 6" SS

MATCH LINE
 (Sheet 3)



UT CLARKE STREAM
 AND WETLAND RESTORATION
 Mecklenburg County, NC
 SCO#09-07763-01

Date: June 28, 2013
 Job Number: 513012
 Project Surveyor: dka
 Drawn by: dka
 Scale: 1"=30'

Revisions

AS-BUILT
 SURVEY

MATCH LINE
(Sheet 2)

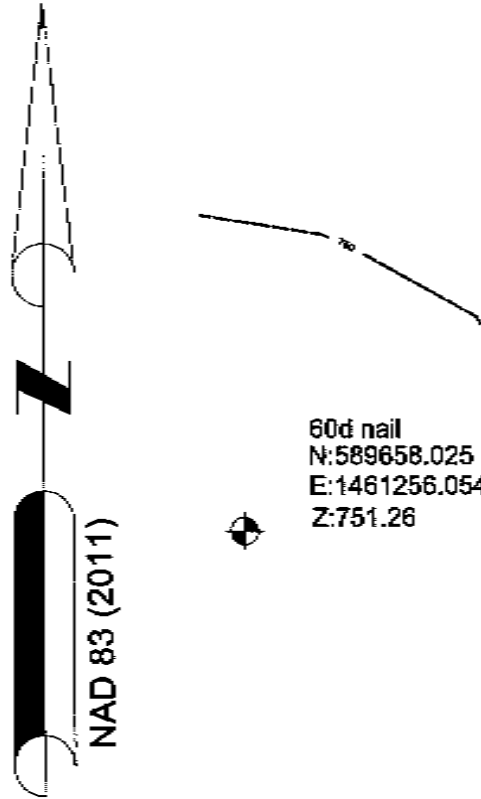

NAD 83 (2011)

60d nail
N:589658.025
E:1461256.054
Z:751.26

MECKLENBURG COUNTY
DB 12860, PG. 142
PARCEL ID #02716103

XS1

Existing Rock Outcrop
along stream channel from
Sta. 4+70 to 4+80

15' SANITARY SEWER R/W
AS PER DB 9088, PG. 025
8" SS

5+00

6+00

"UT CLARKE CREEK"

TOP SS MH = 746.75
INV IN = 734.59
INV IN = 739.75-DROP
INV OUT = 734.45

Existing Rock Outcrop
along stream channel from
Sta. 6+53 to 6+78

7+00

EXISTING
WETLAND AREA "E"

Boulder Sill
Sta. 3+56
Elev.: 745.4'

3+50

4+00

4+78

"UT-5"

MATCH LINE
(Sheet 4)

5/8" rebar
N:589481.760
E:1461600.329
Z:747.90

MECKLENBURG COUNTY
DB 12860, PG. 142
PARCEL ID #02716103

MATCH LINE
(Sheet 6)

NorthState
ENVIRONMENTAL

NorthState Environmental
2883 Lenoxy Street, Winston-Salem, NC 27111
P: 336.725.2210 | F: 336.725.3495
www.nse.com
Firm License #C-0282



UT CLARKE STREAM
AND WETLAND RESTORATION
Mecklenburg County, NC
SCO#09-07763-01

Date: June 28, 2013
Job Number: 513012
Project Surveyor: aka
Drawn by: aka
Scale: 1"=30'

Revisions

AS-BUILT
SURVEY

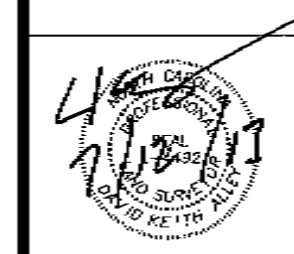

**UT CLARKE STREAM
AND WETLAND RESTORATION, NC**
Mecklenburg County, NC
SCO#09-07763-01

Date: June 28, 2013
Job Number: 513012
Project Surveyor: dia
Drawn by: dia
Scale: 1"=30'
Revisions:

**AS-BUILT
SURVEY**

MECKLENBURG COUNTY
DB 12860, PG. 142
PARCEL ID #02716103

MECKLENBURG COUNTY
DB 12860, PG. 142
PARCEL ID #02716103

MATCH LINE
(Sheet 6)

MATCH LINE
(Sheet 3)

MATCH LINE
(Sheet 5)

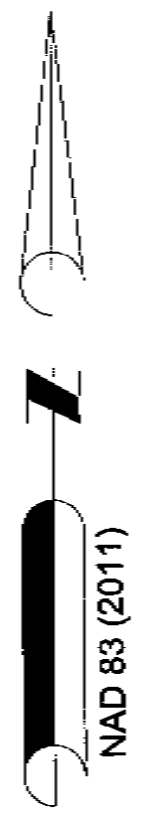

5/8" rebar
N:589481.760
E:1461600.329
Z:747.90

"UT CLARKE CREEK"

XS2

WETLAND AREA "D"

15' SANITARY SEWER R/W
AS PER DB 9868, PG. 025
8" SS

Boulder Toe
Sta. 9+80
Elev.: 739.0'

Boulder Toe
Sta. 9+80
Elev.: 739.4'

Existing Rock Outcrop
along stream channel from
Sta. 9+08 to 9+78

Log Vane
Sta. 10+88
Elev.: 737.8'

8+00

9+00

10+00

11+00

7+75

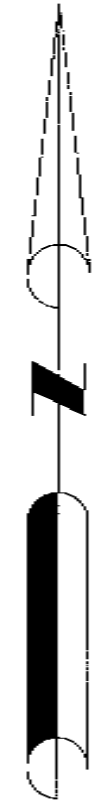

NAD 83 (2011)

**UT CLARKE STREAM
AND WETLAND RESTORATION**
Mecklenburg County, NC
SCO#09-07763-01

Date: June 28, 2013
Job Number: 513012
Project Surveyor: dka
Drawn by: dka
Scale: 1"=30'

Revisions

**AS-BUILT
SURVEY**

Existing Conservation Easement
and Property Line as per PB 52, Pg. 585

MECKLENBURG COUNTY
DB 12860, PG. 142
PARCEL ID #02716103

MECKLENBURG COMMUNITY CHURCH
DB 9106, PG. 823
MB 35, PG. 175 & 177
PARCEL ID #02717139

MATCH LINE
(Sheet 4)

15" SANITARY SEWER RAW
AS PER DB 9688, PG. 025

15" PVC

"UT CLARKE CREEK"

Boulder S18
Sta. 0+52
Elev.: 739.4'

Boulder S11
Sta. 0+75
Elev.: 738.0'

TOP SS MH = 745.23
INV MH = 732.18
INV CUT = 732.05

Log Vane
Sta. 1+38
Elev.: 737.5'

8+47

1+00

8+00
"UT-2B"

12+99

MECKLENBURG COUNTY
DB 12860, PG. 142
PARCEL ID #02716103

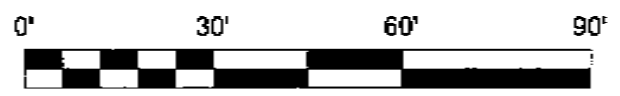

FRANKLIN LUCK
THERESA LUCK
DB 4578, PG. 409
PARCEL ID #02717116

MECKLENBURG COMMUNITY CHURCH
DB 9106, PG. 823
MB 35, PG. 175 & 177
PARCEL ID #02717139

MECKLENBURG COUNTY
DB 12860, PG. 142
PARCEL ID #02716103

NAD 83 (2011)



NorthState
ENVIRONMENTAL

NorthState Environmental
2889 Lowrey Street, Winston-Salem, NC 27101
p. 336.725.2010 | f. 336.725.2405
www.nseems.com
Firm License #D-0288



60d nail
N:589768.074
E:1461796.095
Z:757.81

"UT-1"

XS8

XS3

MATCH LINE
(Sheet 4)

MATCH LINE
(Sheet 7)

MATCH LINE
(Sheet 3)

MATCH LINE
(Sheet 3)

15" SANITARY SEWER R/W
AS PER DB 9688, PG. 025

Existing Rock Outcrop
along stream channel from
Sta. 3+50 to 3+75

Existing Rock Outcrop
along stream channel from
Sta. 4+40 to 5+56

Existing Rock Outcrop
along stream channel from
Sta. 6+30 to 6+85

Log Vane/Root Wad
Sta. 7+20
Elev.: 740.7'

Existing Rock Outcrop
along stream channel from
Sta. 7+45 to 7+65

Constructed
Brush Toe

Date:	June 28, 2013
Job Number:	513012
Project Surveyor:	dia
Drawn by:	dia
Scale:	1"=30'
Revisions:	

UT CLARKE STREAM
AND WETLAND RESTORATION
Mecklenburg County, NC
SCO#09-07763-01

AS-BUILT
SURVEY

Sheet
6 of 10



MECKLENBURG COUNTY
DB 12860, PG. 142
PARCEL ID #02716103

ALICE E. FOSTER
DB 4578, PG. 411
PARCEL ID #02717113

NAD 83 (2011)



FRANKLIN LUCK
THERESA LUCK
DB 4578, PG. 409
PARCEL ID #02717116

MECKLENBURG COUNTY CHURCH
DB 5106, PG. 823
MB 35, PG. 115 & 117
PARCEL ID #02717113

NorthState
ENVIRONMENTAL

NorthState Environmental
2505 Lenoxy Street, Winston-Salem, NC 27101
p. 336.725.2111 | f. 336.725.2406
www.nstae.com
Firm License #0-2268



YOUNGS POND, LLC
DB 20251, PG. 742
MB 20, PG. 540
PARCEL ID #02717110

TOP SS MH = 754.77
INV IN = 742.77
INV OUT = 742.80

Existing Conservation Easement
and Property Line as per FB 52, Pg. 585

15' RW

8" SS

Log Vane/Root Wad
Sta. 2+70
Elev.: 744.4'

Existing Rock Outcrop
at bank/sta. 1+45

"UT-1"

Cross Vane
Sta. 0+65
Elev.: 745.2'

Constructed
fence

12 SS

15' SANITARY SEWER R/W
AS PER DB 9688, PG. 025

TOP SS MH = 762.00
INV IN = 741.12
INV OUT = 741.00

TOP SS MH = 748.32
INV IN = 737.52
INV OUT = 737.42

MECKLENBURG COUNTY
DB 12860, PG. 142
PARCEL ID #02716103

MATCH LINE
(Sheet 6)

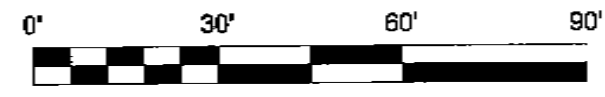

UT CLARKE STREAM
AND WETLAND RESTORATION
Mecklenburg County, NC
SCO#09-07763-01

Date:	June 28, 2013
Job Number:	513012
Project Surveyor:	dia
Drawn by:	dia
Scale:	1"=30'
Revisions:	

AS-BUILT
SURVEY

LEGEND

-  WATER SURFACE
-  BANKFULL
-  THALWEG



MECKLENBURG COUNTY
DB 12860, PG. 142
PARCEL ID #02716103

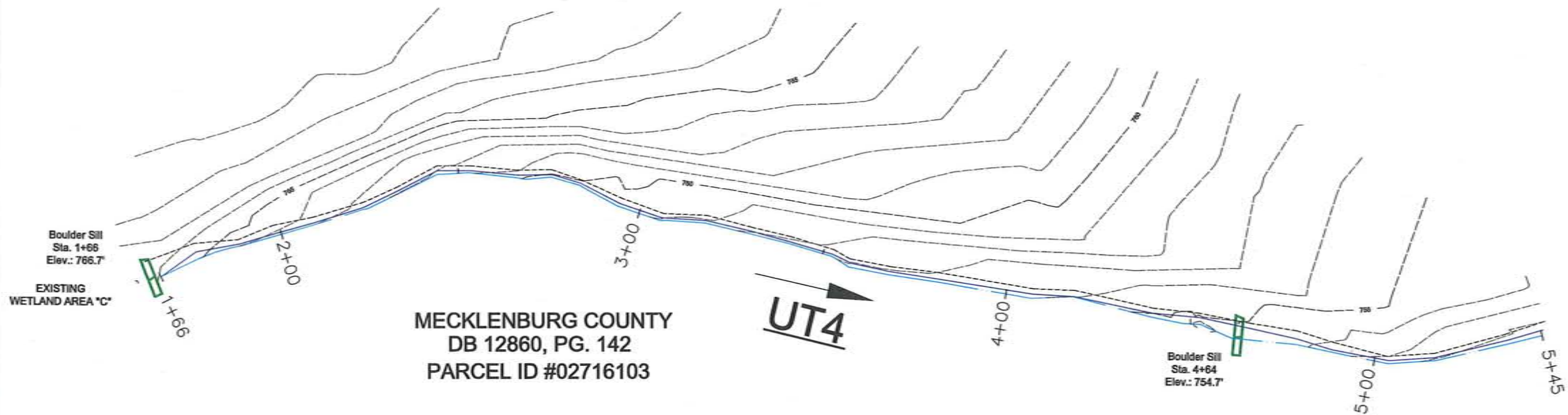

MECKLENBURG COUNTY
DB 12860, PG. 142
PARCEL ID #02716103

NOTE: ONLY THE LEFT SIDE OF UT4 WAS GRADED DURING CONSTRUCTION.
NO GRADING WAS PERFORMED ON THE RIGHT SIDE OF UT4.

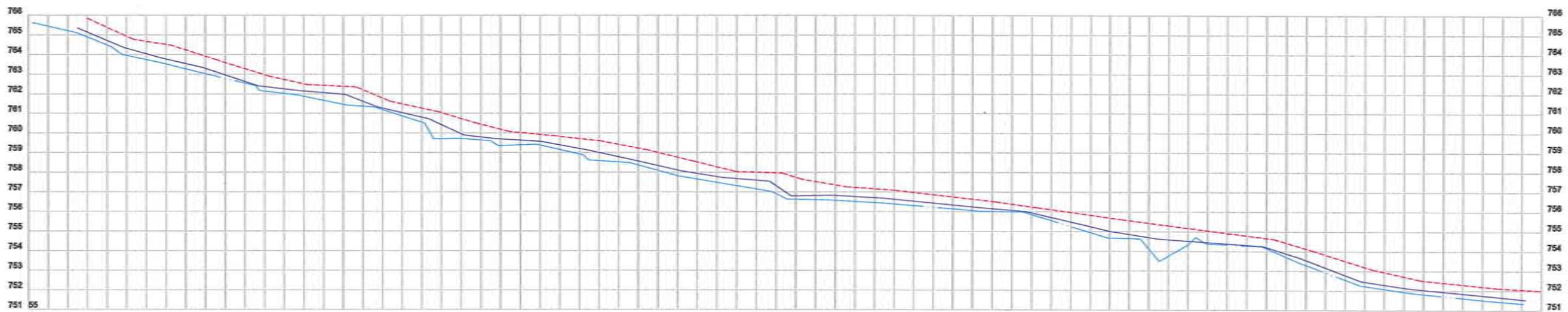

**UT CLARKE STREAM
AND WETLAND RESTORATION**
Mecklenburg County, NC
SCO#09-07763-01

Date: June 28, 2013
Job Number: 513012
Project Surveyor: dka
Drawn by: dka
Scale: 1"=30'

Revisions

**AS-BUILT
SURVEY**

Sheet



PROFILES

UT2A

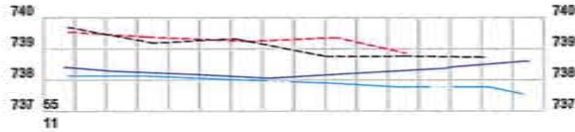

770 775 780 785 790 795 800 805 810 815 820 825 830 835 840 845 850

UT3

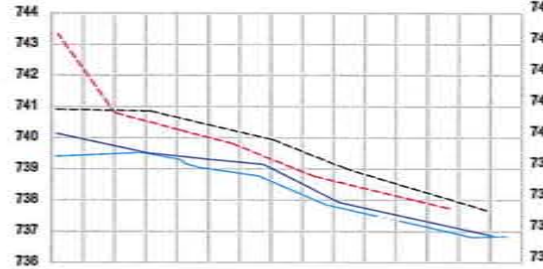

30 35 40 45 50 55 60 65 70 75 80 85 90 95 100 105

UT5

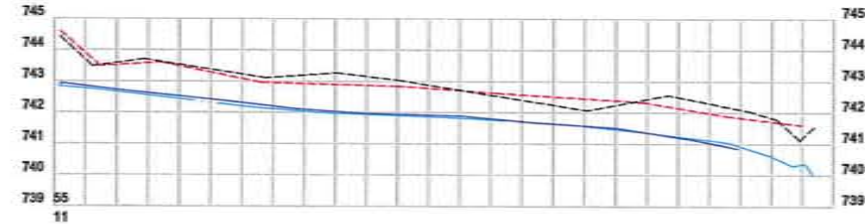

355 360 365 370 375 380 385 390 395 400 405 410 415 420 425 430 435 440 445 450 455 460 465 470 475 480

LEGEND

- WATER SURFACE
- - - - - BANKFULL (RIGHT)
- . - . - BANKFULL (LEFT)
- - - - - THALWEG

- ◇ BANKFULL
- WATER SURFACE



CROSS SECTIONS

UT CLARKE

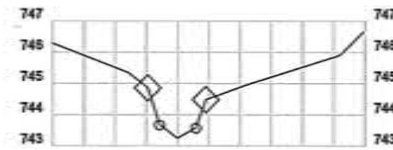

0 5 10 15 20 25 30 35 40 45 50

XS1
STA=4+52

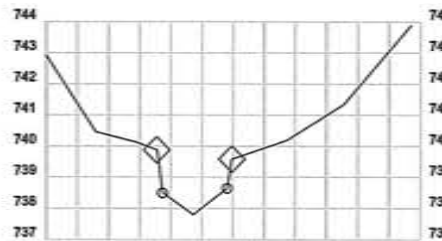

0 5 10 15 20 25 30 35 40 45 50 55 60

XS2
STA=9+34

UT1

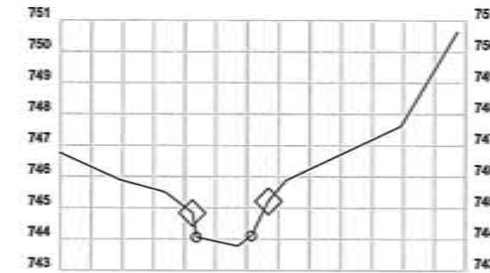

0 5 10 15 20 25 30 35 40 45 50 55 60 65

XS8
STA=4+19

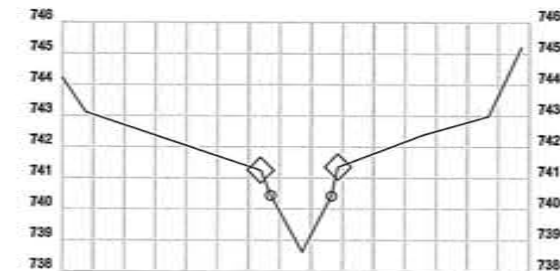

0 5 10 15 20 25 30 35 40 45 50 55 60 65 70 75

XS3
STA=7+26

**UT CLARKE STREAM
AND WETLAND RESTORATION**
 Mecklenburg County, NC
 SCO#09-07763-01

Date: June 28, 2013
Job Number: 513012
Project Surveyor: dia
Drawn by: dia
Scale: 1"=30'

Revisions

**AS-BUILT
SURVEY**

LEGEND

- WATER SURFACE
- BANKFULL (RIGHT)
- BANKFULL (LEFT)
- THALWEG

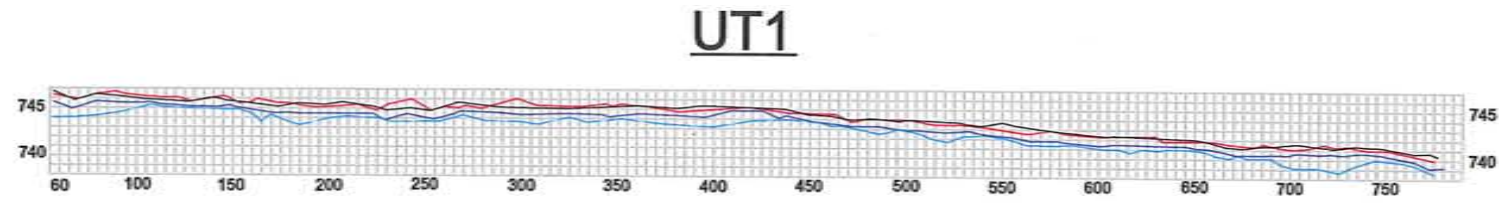

UT CLARKE

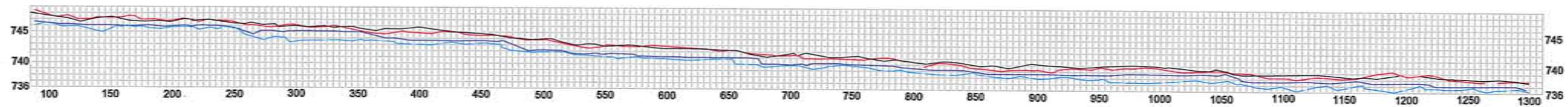

LEGEND

- WATER SURFACE
- BANKFULL (RIGHT)
- BANKFULL (LEFT)
- THALWEG



**UT CLARKE STREAM
AND WETLAND RESTORATION**
Mecklenburg County, NC
SCO#09-07763-01

Date: June 28, 2013
Job Number: 513012
Project Surveyor: dka
Drawn by: dka
Scale: 1"=100'

Revisions

**AS-BUILT
SURVEY**